

STATE OF ILLINOIS  
DEPARTMENT OF TRANSPORTATION

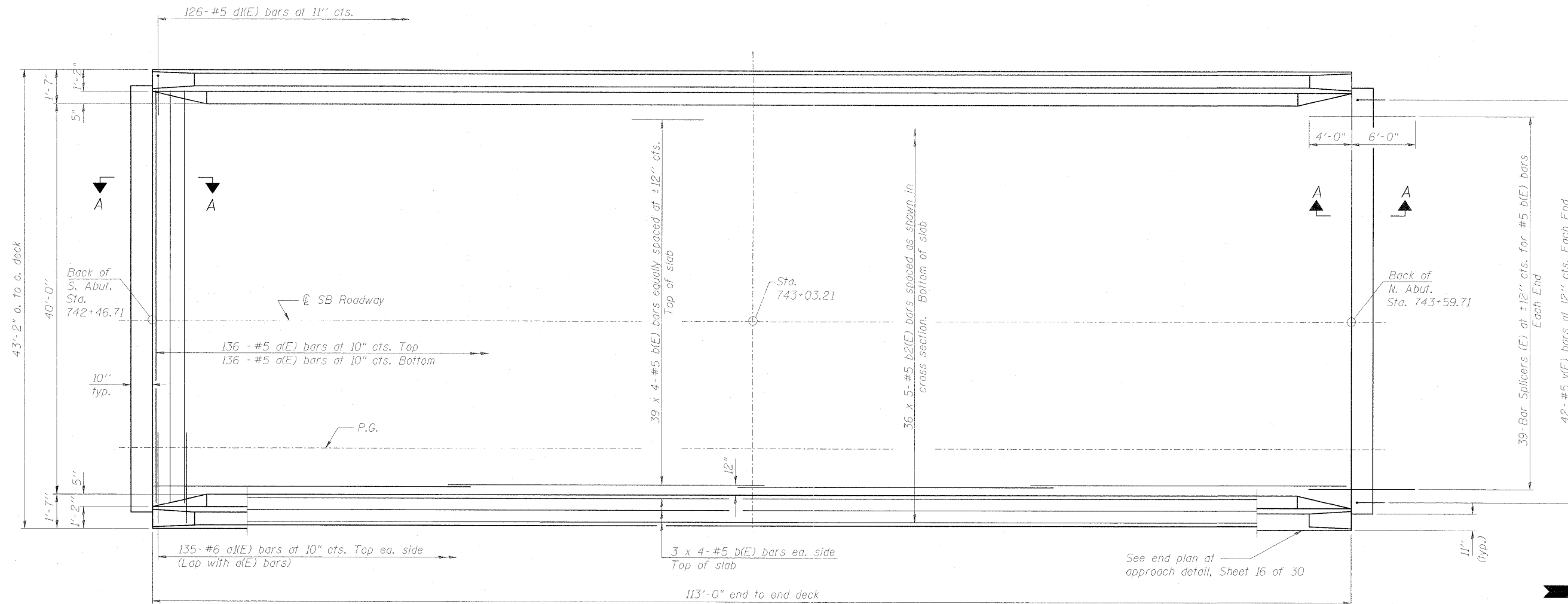

SB DECK PLAN

MIN. BAR LAP

- #5 - 2'-2"
- #6 - 2'-7"

Notes:  
See Sheet 16 of 30 for superstructure details, parapet reinforcement, and Bill of Material.  
See Sheet 21 of 30 for Section A-A.  
Reinforcement bars designated (E) shall be epoxy coated.  
Bars indicated thus 39 x 4-#5 etc. indicates 39 lines of bars with 4 lengths per line.

DECK PLAN - SOUTHBOUND  
STRUCTURE NO. 101-0177

DESIGNED	JAW
CHECKED	JAN
DRAWN	BTD
CHECKED	JAW

SHEET NO. 12 30 SHEETS	F.A.P. RTE. 734	SECTION 77-2B-1, 77-2-2	COUNTY WINNEBAGO	TOTAL SHEETS 530	SHEET NO. 284
	FED. ROAD DIST. NO. ILLINOIS FED. AID PROJECT			CONTRACT NO. 64813	