

70 80 90 100 110 120 130 140 150 160 170 180 190 200 210 220 230 240 250 260 270 280 290 300 310 320 330 340 350 360

DATE	
BY	
FINAL SURVEY	SURVEYED
NOTE BOOK	PLOTTED
NO.	TEMPLATE
	AREAS CHECKED

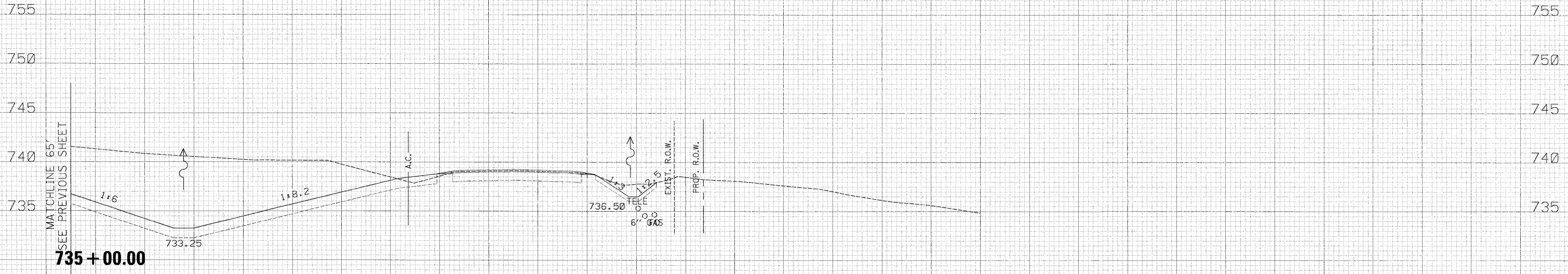

DATE	
BY	
ORIGINAL SURVEY	SURVEYED
NOTE BOOK	PLOTTED
NO.	TEMPLATE
	AREAS CHECKED

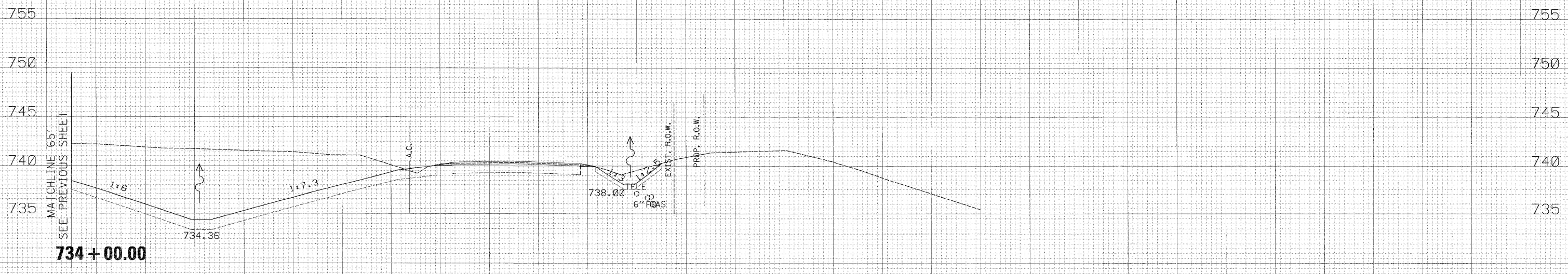

70 80 90 100 110 120 130 140 150 160 170 180 190 200 210 220 230 240 250 260 270 280 290 300 310 320 330 340 350 360

USER NAME = zuikowsd	DESIGNED - RDT	REVISED -
PLLOT SCALE = 10,0000' / IN.	DRAWN - RDT	REVISED -
PLLOT DATE = 2/2/2011	CHECKED - GC	REVISED -
	DATE - 01-14-11	REVISED -

STATE OF ILLINOIS
DEPARTMENT OF TRANSPORTATION

ILLINOIS ROUTE 2
CROSS SECTIONS

SCALE: H: 1" = 10' V: 1" = 5' SHEET NO. 359 OF 530 SHEETS STA. 734+00.00 TO STA. 735+00.00

F.A.P. RTE.	SECTION	COUNTY	TOTAL SHEETS	SHEET NO.
734	77-2-2 & 77-2B-1	WINNEBAGO	530	359
CONTRACT NO. 64813				

ILLINOIS FED. AID PROJECT

1:\projects\11254\segment 1\sheets\civil\section\0264813-shr-xsh-IL2.dgn