

230 220 210 200 190 180 170 160 150 140 130 120 110 100 90 80 70 60 50 40 30 20 10 0 10 20 30 40 50 60

DATE	
BY	
FINAL SURVEY	SUPERVIEWED
NOTE BOOK NO.	PLOTTED
	TEMPLATE
	AREAS CHECKED
	AREAS CHECKED

DATE	
BY	
ORIGINAL SURVEY	SUPERVIEWED
NOTE BOOK NO.	PLOTTED
	TEMPLATE
	AREAS CHECKED
	AREAS CHECKED

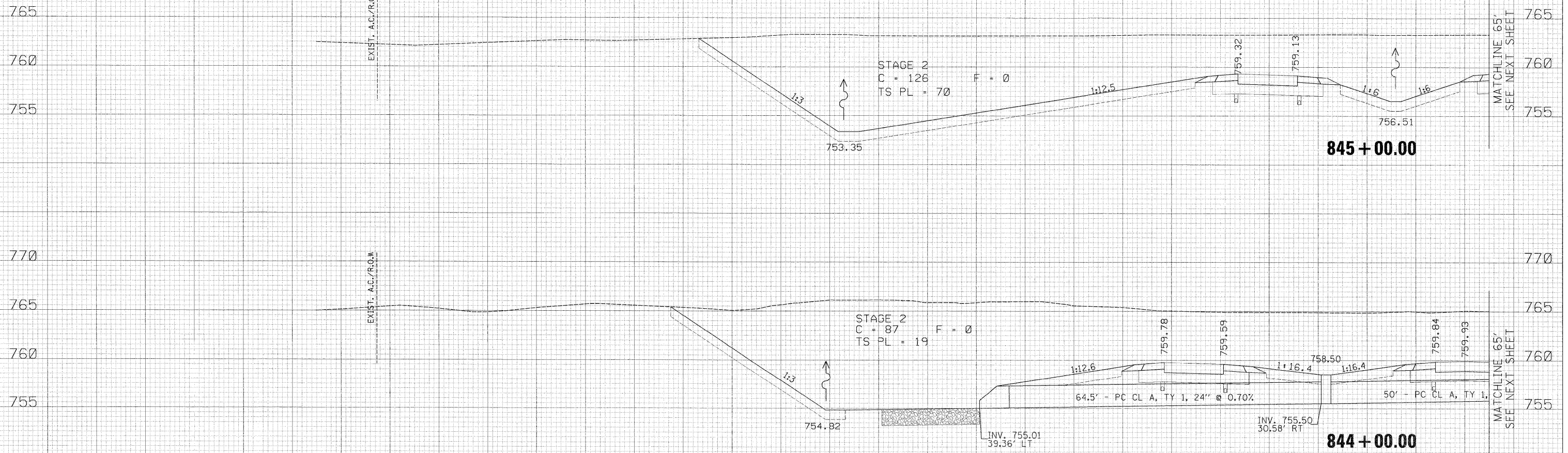

230 220 210 200 190 180 170 160 150 140 130 120 110 100 90 80 70 60 50 40 30 20 10 0 10 20 30 40 50 60

USER NAME = zulkowsd	DESIGNED - RDT	REVISED -
PLOT SCALE = 10,0000' / IN.	DRAWN - RDT	REVISED -
PLOT DATE = 2/2/2011	CHECKED - GC	REVISED -
	DATE - 01-14-11	REVISED -

**STATE OF ILLINOIS
DEPARTMENT OF TRANSPORTATION**

**ILLINOIS ROUTE 2
CROSS SECTIONS**

SCALE: H: 1" = 12', V: 1" = 3' SHEET NO. 466 OF 530 SHEETS STA. 844+00.00 TO STA. 845+06.63

F.A.P. RTE.	SECTION	COUNTY	TOTAL SHEETS	SHEET NO.
734	77-2-2 & 77-2B-1	WINNEBAGO	530	466
			CONTRACT NO. 64813	

ILLINOIS FED. AID PROJECT

z:\projects\11254\segment 1\sheet\civil\section\0264813-sht-xasht-IL2.dgn