

DATE	
BY	
FINAL SURVEY	
PLOTTED	
NOTE BOOK	
NO.	
AREAS CHECKED	

DATE	
BY	
ORIGINAL SURVEY	
PLOTTED	
NOTE BOOK	
NO.	
AREAS CHECKED	

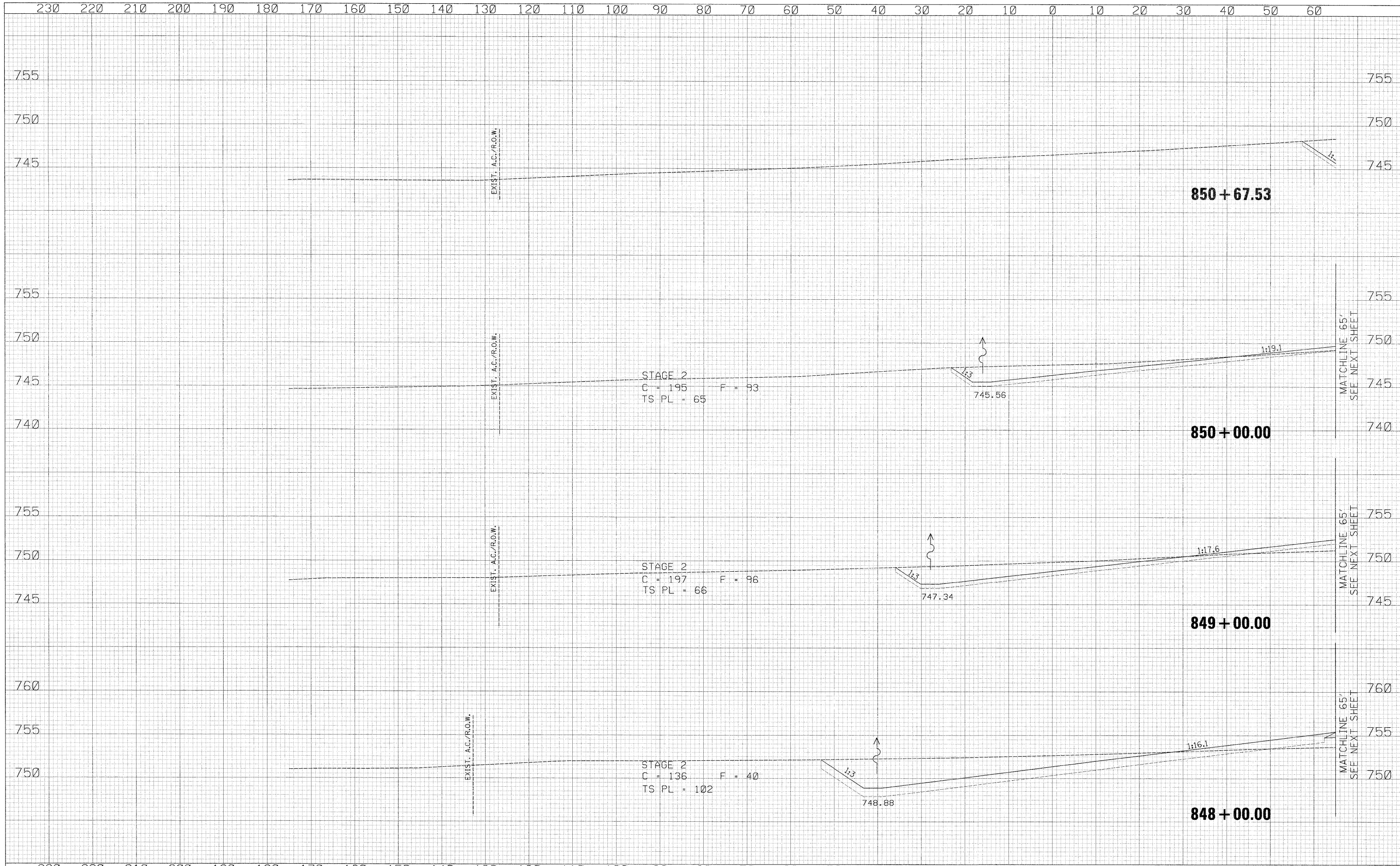

230	220	210	200	190	180	170	160	150	140	130	120	110	100	90	80	70	60	50	40	30	20	10	0	10	20	30	40	50	60																														
USER NAME = zulkowad DESIGNED - RDT DRAWN - RDT CHECKED - GC DATE - 01-14-11												REVISIONS: REVISED - REVISED - REVISED - REVISED -												<b>STATE OF ILLINOIS</b> <b>DEPARTMENT OF TRANSPORTATION</b>												ILLINOIS ROUTE 2 CROSS SECTIONS												F.A.P. RITE: 734 SECTION: 77-2-2 & 77-2B-1 COUNTY: WINNEBAGO TOTAL SHEETS: 530 SHEET NO.: 470 CONTRACT NO.: 64813											
PLOT SCALE = 10.0000' / IN. PLOT DATE = 2/2/2011												SCALE: H:V = 1:10 SHEET NO. 470 OF 530 SHEETS STA. 848+00.00 TO STA. 850+67.53												ILLINOIS FED. AID PROJECT																																			

\\projects\11254\segment 1\sheet\civil\section\0264813-ah-xssht-IL2.dgn