

230 220 210 200 190 180 170 160 150 140 130 120 110 100 90 80 70 60 50 40 30 20 10 0 10 20 30 40 50 60

| | |
|------------------|------|
| FINAL SURVEY NO. | DATE |
| DESIGNED | BY |
| PLOTTED | |
| TEMPLATE | |
| AREAS CHECKED | |

| | |
|---------------------|------|
| ORIGINAL SURVEY NO. | DATE |
| DESIGNED | BY |
| PLOTTED | |
| TEMPLATE | |
| AREAS CHECKED | |

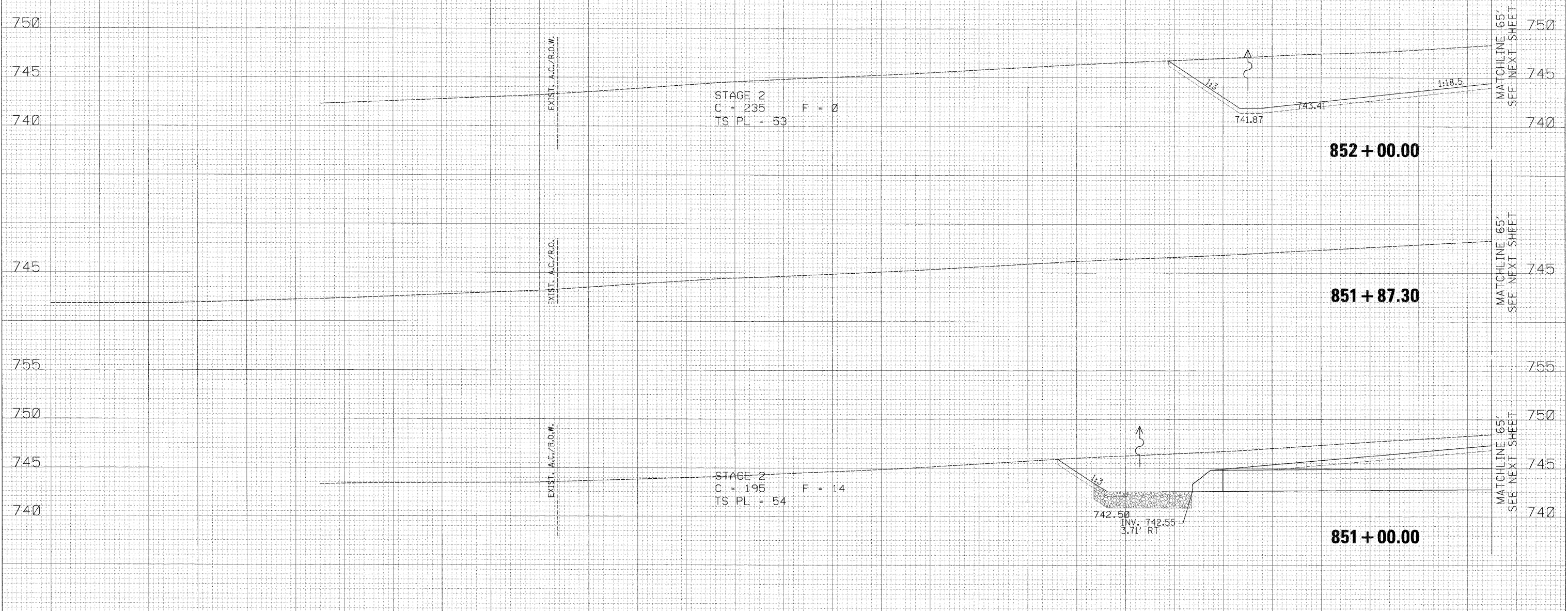

230 220 210 200 190 180 170 160 150 140 130 120 110 100 90 80 70 60 50 40 30 20 10 0 10 20 30 40 50 60

| | | |
|-------------------------------------|-----------------|-----------|
| USER NAME = zulkowad | DESIGNED - RDT | REVISED - |
| PLOT SCALE = 1/8" = 100.0000' / IN. | DRAWN - RDT | REVISED - |
| PLOT DATE = 2/2/2011 | CHECKED - GC | REVISED - |
| | DATE - 01-14-11 | REVISED - |

**STATE OF ILLINOIS
DEPARTMENT OF TRANSPORTATION**

ILLINOIS ROUTE 2
CROSS SECTIONS

SCALE: 1/8" = 100' SHEET NO. 472 OF 530 SHEETS STA. 851+00.00 TO STA. 852+00.00

| F.A.P. RTE. | SECTION | COUNTY | TOTAL SHEETS | SHEET NO. |
|--------------------|------------------|-----------|---------------------------|-----------|
| 734 | 77-2-2 & 77-2B-1 | WINNEBAGO | 530 | 472 |
| CONTRACT NO. 64813 | | | ILLINOIS FED. AID PROJECT | |

\\projects\11254\segment 1\sheet\civil\section\0264813\shht-xssht-IL2.dgn