

DATE	
BY	
FINAL SURVEY	SURVEYED
NOTE BOOK	PLOTTED
NO.	AREAS CHECKED

DATE	
BY	
ORIGINAL SURVEY	SURVEYED
NOTE BOOK	PLOTTED
NO.	AREAS CHECKED

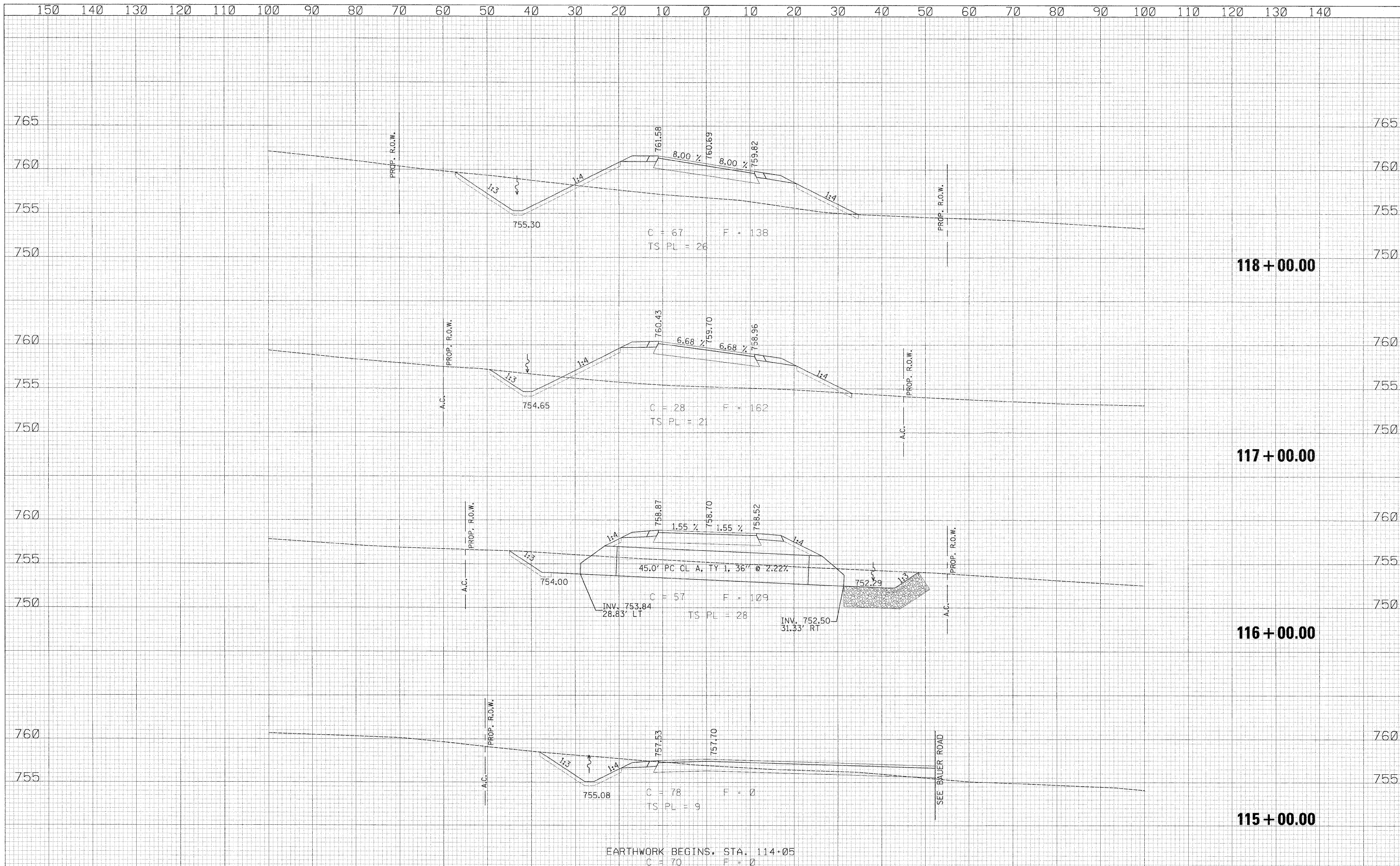

USER NAME = zulkowd	DESIGNED RDT	REVISED -	<b>STATE OF ILLINOIS</b> <b>DEPARTMENT OF TRANSPORTATION</b>	FRONTAGE ROAD A		F.A.P. R.T.E. 734 SECTION 77-2-2 & 77-28-1 COUNTY WINNEBAGO TOTAL SHEETS 530 SHEET NO. 506 CONTRACT NO. 64813 ILLINOIS FED. AID PROJECT
PLOT SCALE = 10.0000' / IN.	DRAWN RDT	REVISED -		CROSS SECTIONS		
PLOT DATE = 2/2/2011	CHECKED GC	REVISED -		SCALE: H <sub>v</sub> 1" = 10', H <sub>h</sub> 1" = 10'		
DATE 01-14-11	DATE 01-14-11	REVISED -		SHEET NO. 506 OF 530 SHEETS    STA. 115+00.00 TO STA. 118+00.00		

I:\projects\11254\segment 1\sheet\civil\section\0264813-sh1-ssht-fr-a.dgn