

DATE	
BY	
SURVEYED	
PLOTTED	
NOTE BOOK	
AREAS CHECKED	
NO.	

DATE	
BY	
SURVEYED	
PLOTTED	
NOTE BOOK	
AREAS CHECKED	
NO.	

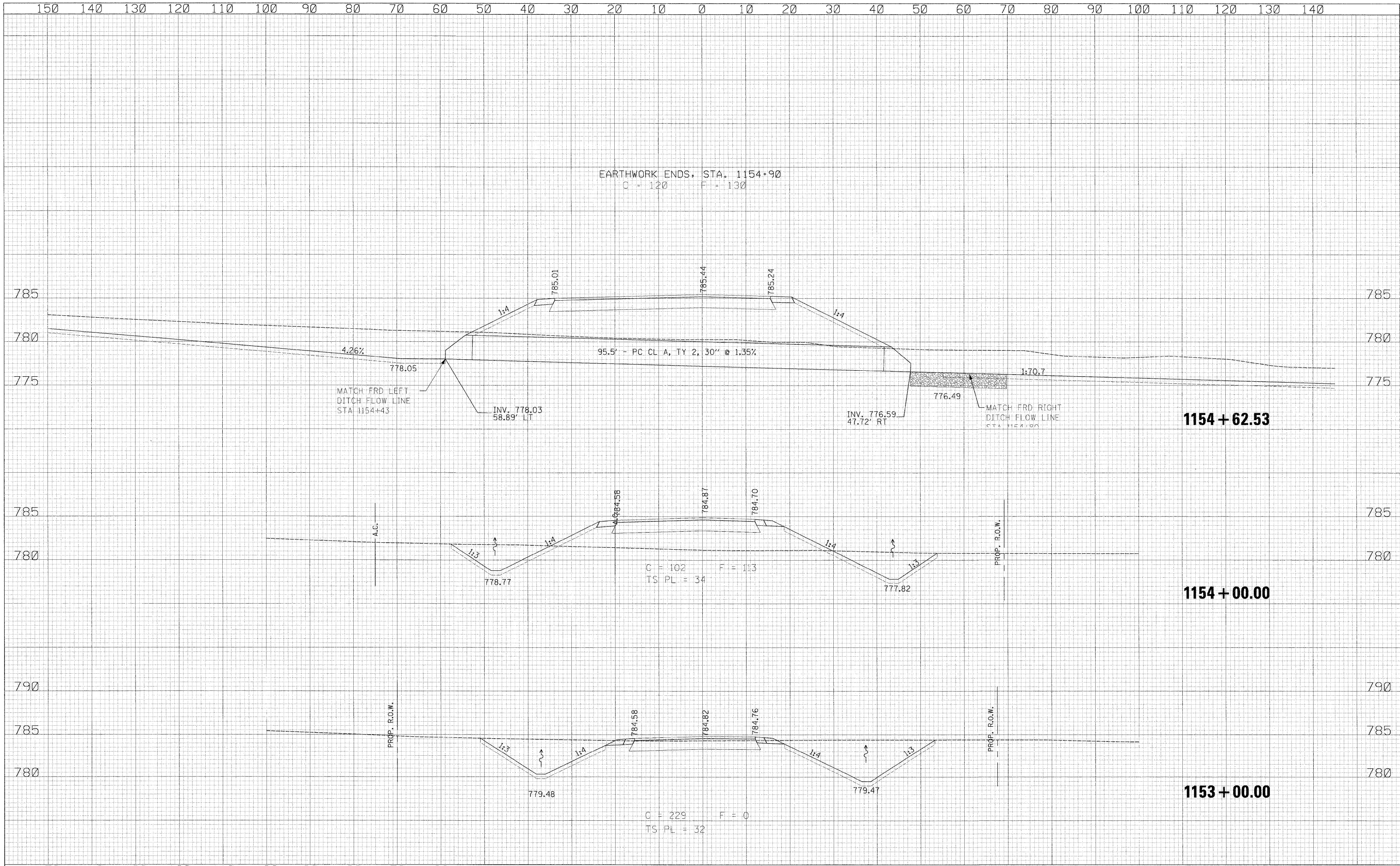

EARTHWORK ENDS, STA. 1154+90
C = 120 F = 130

MATCH FRD LEFT
DITCH FLOW LINE
STA 1154+43

MATCH FRD RIGHT
DITCH FLOW LINE
STA 1154+60

C = 102 F = 113
TS PL = 34

C = 229 F = 0
TS PL = 32

1154 + 62.53

1154 + 00.00

1153 + 00.00

USER NAME = zulkowsd	DESIGNED RDT	REVISED -	<p align="center">STATE OF ILLINOIS DEPARTMENT OF TRANSPORTATION</p> <p align="center">FRONTAGE ROAD D CROSS SECTIONS</p> <p>SCALE: $\frac{1}{4}'' = 10'$ SHEET NO. 526 OF 530 SHEETS STA. 1153+00.00 TO STA. 1155+00.00</p>	F.A.P. RTE. 734	SECTION 77-2-2 & 77-2B-1	COUNTY WINNEBAGO	TOTAL SHEETS 530	SHEET NO. 526
PLDT SCALE = 10.0000' / IN.	DRAWN RDT	REVISED -		CONTRACT NO. 64813		ILLINOIS FED. AID PROJECT		
PLDT DATE = 2/2/2011	CHECKED GC	REVISED -						
DATE 01-14-11		REVISED -						

\\projects\11254\segment 1\sheet\civil\section\0264813-shr-xssht-FR-D.dgn