

DATE	
BY	
DESIGNED	
DRAWN	
CHECKED	
DATE	
SCALE	
SHEET NO.	
TOTAL SHEETS	
COUNTY	
SECTION	
F.A.P. RTE.	

DATE	
BY	
DESIGNED	
DRAWN	
CHECKED	
DATE	
SCALE	
SHEET NO.	
TOTAL SHEETS	
COUNTY	
SECTION	
F.A.P. RTE.	

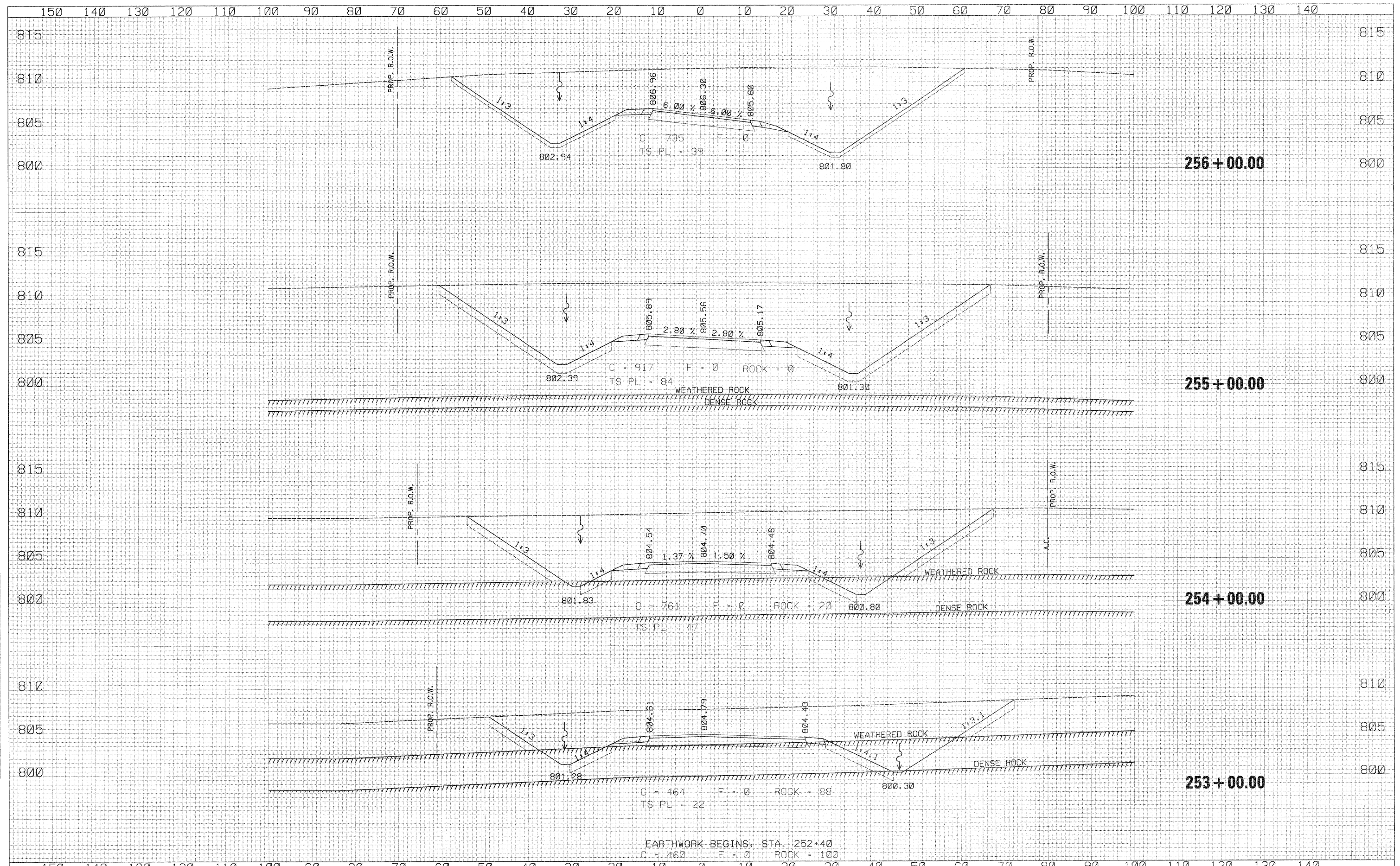

EARTHWORK BEGINS, STA. 252+40
 C = 460 F = 0 ROCK = 100

USER NAME: thompson	DESIGNED RDT	REVISIONS	STATE OF ILLINOIS DEPARTMENT OF TRANSPORTATION	FRONTAGE ROAD E CROSS SECTIONS	F.A.P. RTE. 734	SECTION 77-2-2 & 77-2B-1	COUNTY WINNEBAGO	TOTAL SHEETS 530	SHEET NO. 527
SCALE: H:V = 10:1	DRAWN RDT	REVISIONS			SCALE: H:V = 10:1 SHEET NO. 527 OF 530 SHEETS STA. 253+00.00 TO STA. 256+00.00				
DATE 01-14-11	CHECKED GC	REVISIONS			ILLINOIS FED. AID PROJECT				