

PROP. CURVE 74200  
 PI STA. = 2125+28.22  
 $\Delta = 24^\circ 09' 57''$  (RT)  
 $D = 2^\circ 30' 48''$   
 $R = 2,279.61'$   
 $T = 487.99'$   
 $L = 961.47'$   
 $E = 51.65'$   
 $\theta = \text{N.C.}$   
 $T.R. = \text{N/A}$   
 $S.E. \text{ RUN} = \text{N/A}$   
 $P.C. \text{ STA.} = 2120+40.23$   
 $P.T. \text{ STA.} = 2130+01.70$

PROP. CURVE 74210  
 PI STA. = 2131+87.04  
 $\Delta = 9^\circ 16' 57''$  (RT)  
 $D = 2^\circ 30' 35''$   
 $R = 2,282.97'$   
 $T = 185.33'$   
 $L = 368.87'$   
 $E = 7.51'$   
 $\theta = \text{N.C.}$   
 $T.R. = \text{N/A}$   
 $S.E. \text{ RUN} = \text{N/A}$   
 $P.C. \text{ STA.} = 2130+01.70$   
 $P.T. \text{ STA.} = 2133+71.56$

DATE	BY

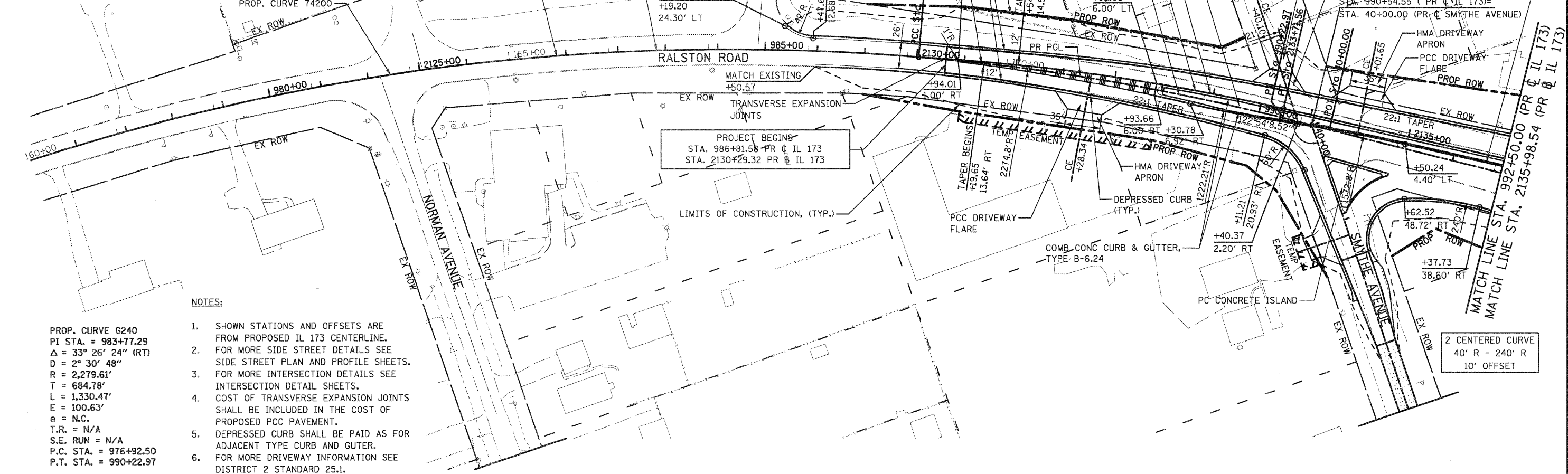

**NOTES:**

PROP. CURVE G240  
 PI STA. = 983+77.29  
 $\Delta = 33^\circ 26' 24''$  (RT)  
 $D = 2^\circ 30' 48''$   
 $R = 2,279.61'$   
 $T = 684.78'$   
 $L = 1,330.47'$   
 $E = 100.63'$   
 $\theta = \text{N.C.}$   
 $T.R. = \text{N/A}$   
 $S.E. \text{ RUN} = \text{N/A}$   
 $P.C. \text{ STA.} = 976+92.50$   
 $P.T. \text{ STA.} = 990+22.97$

1. SHOWN STATIONS AND OFFSETS ARE FROM PROPOSED IL 173 CENTERLINE.
2. FOR MORE SIDE STREET DETAILS SEE SIDE STREET PLAN AND PROFILE SHEETS.
3. FOR MORE INTERSECTION DETAILS SEE INTERSECTION DETAIL SHEETS.
4. COST OF TRANSVERSE EXPANSION JOINTS SHALL BE INCLUDED IN THE COST OF PROPOSED PCC PAVEMENT.
5. DEPRESSED CURB SHALL BE PAID AS FOR ADJACENT TYPE CURB AND GUTTER.
6. FOR MORE DRIVEWAY INFORMATION SEE DISTRICT 2 STANDARD 25.1.

DATE	BY

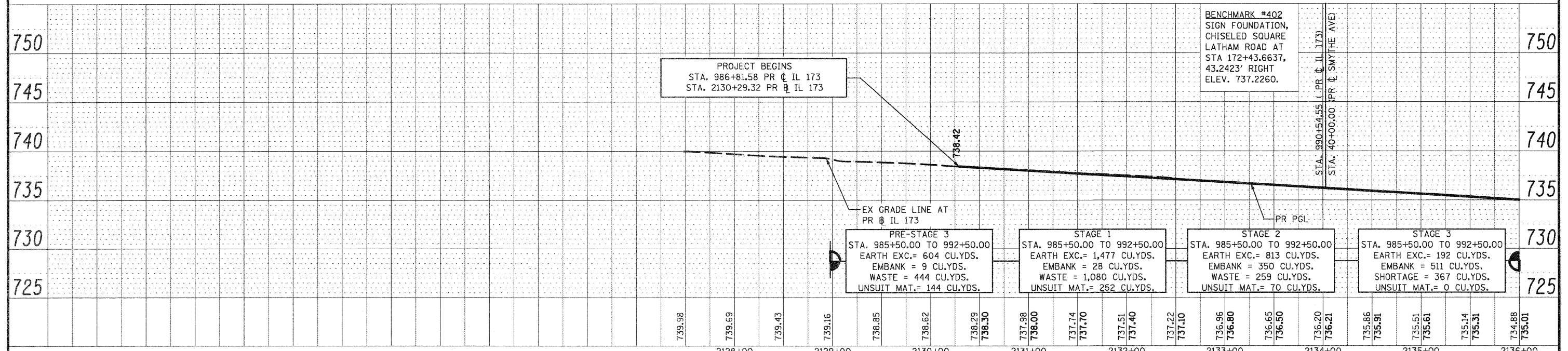

FILE NAME = 0264987-sh-t-pln-pr-f-01.dgn	USER NAME = 320209071	DESIGNED - LOM	REVISED -	<b>STATE OF ILLINOIS DEPARTMENT OF TRANSPORTATION</b>	<b>PLAN AND PROFILE RALSTON ROAD</b>	F.A.P. RTE. = 303	SECTION = 129K-1	COUNTY = WINNEBAGO	TOTAL SHEETS = 401	SHEET NO. = 61	
PLOT SCALE = 100.0000' / IN.	CHECKED - PDK	DATE = 01-19-2011	REVISED -			SCALE: 1" = 40'	SHEET NO. OF SHEETS = 1 OF 2	STA. 986+81.58 TO STA. 992+50.00	FED. ROAD DIST. NO. 2	ILLINOIS FED. AID PROJECT	CONTRACT NO. 64987
PLOT DATE = 1/18/2011	DATE = 01-19-2011	REVISED -	REVISED -								