

MATCH LINE 853+00.00

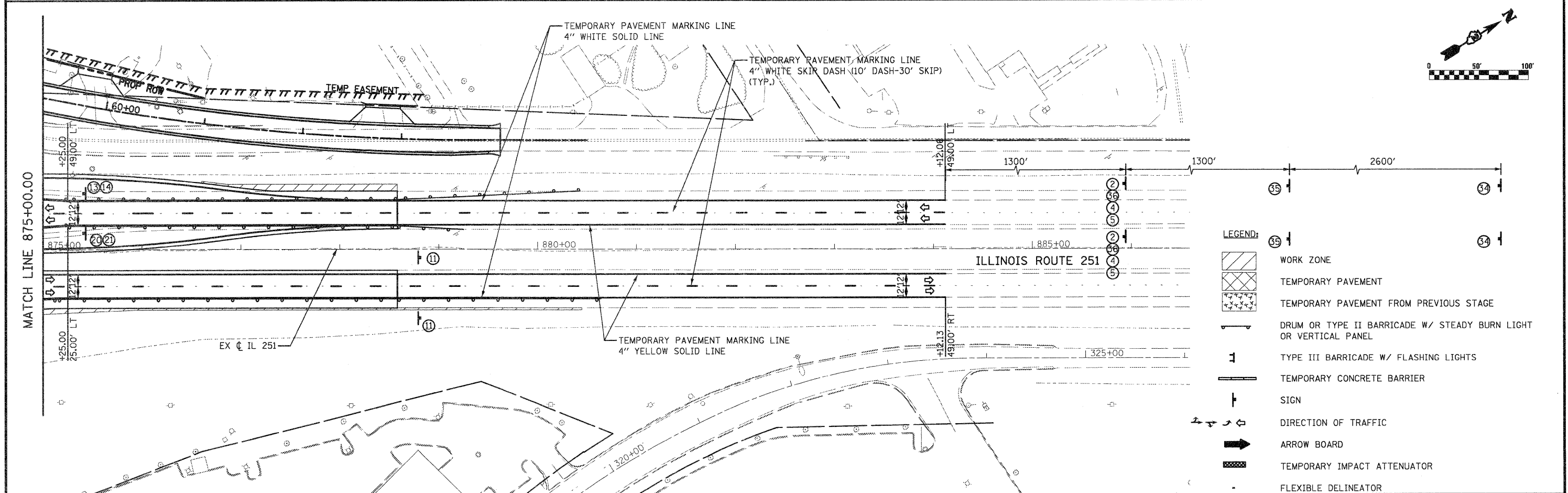

- LEGEND:**
- WORK ZONE
  - TEMPORARY PAVEMENT
  - TEMPORARY PAVEMENT FROM PREVIOUS STAGE
  - DRUM OR TYPE II BARRICADE W/ STEADY BURN LIGHT OR VERTICAL PANEL
  - TYPE III BARRICADE W/ FLASHING LIGHTS
  - TEMPORARY CONCRETE BARRIER
  - SIGN
  - DIRECTION OF TRAFFIC
  - ARROW BOARD
  - TEMPORARY IMPACT ATTENUATOR
  - FLEXIBLE DELINEATOR

FILE NAME = D264987-ahf-staging-485.dgn	USER NAME = 3202090971	DESIGNED - LOM	REVISED -	<b>STATE OF ILLINOIS DEPARTMENT OF TRANSPORTATION</b>	<b>STAGING AND TRAFFIC CONTROL PLAN STAGE 4A ILLINOIS ROUTE 251</b>				F.A.P. RTE. 303	SECTION 129K-1	COUNTY WINNEBAGO	TOTAL SHEETS 401	SHEET NO. 145
PLOT SCALE = 100.0000' / IN.		CHECKED - PDK	REVISED -		SCALE:      SHEET NO.      OF      SHEETS      STA. 840+00.00 TO STA. 868+00.00				CONTRACT NO. 64987				
PLOT DATE = 1/18/2011		DATE - 01-19-2011	REVISED -						FED. ROAD DIST. NO. 2 ILLINOIS FED. AID PROJECT				