

- NOTES:
1. FOR MORE DRAINAGE INFORMATION SEE PROPOSED DRAINAGE PLANS.
  2. PERIMETER EROSION BARRIER IS LOCATED ON TEMP. EASEMENT/PERM. EASEMENT/R.O.W. LINE AS SHOWN ON THE PLANS.
  3. FOR MORE STAGE CONSTRUCTION INFORMATION SEE STAGING AND TRAFFIC CONTROL PLANS.

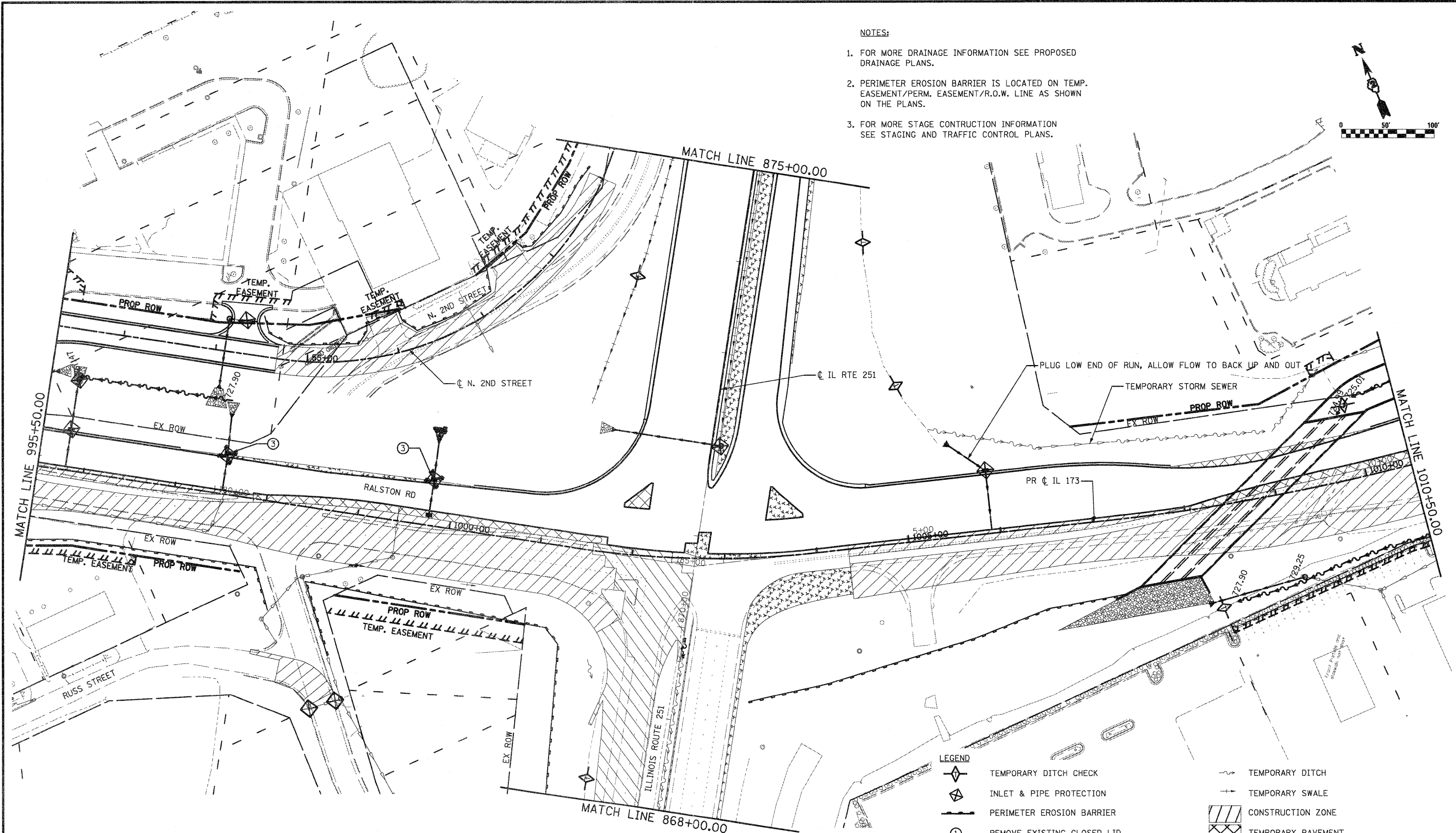
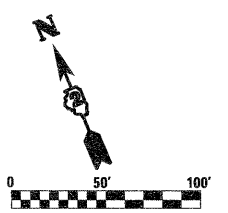

- LEGEND**
- TEMPORARY DITCH CHECK
  - INLET & PIPE PROTECTION
  - PERIMETER EROSION BARRIER
  - REMOVE EXISTING CLOSED LID FROM TYPE 1 FRAME AND REPLACE W/ OPEN LID, ADJUST RIM TO GRADE
  - REMOVE TOP OF EXISTING INLET AND COVER W/ STEEL PLATE
  - TEMPORARY STEEL PLATE ON PROPOSED STRUCTURE
  - TEMPORARY DITCH
  - TEMPORARY SWALE
  - CONSTRUCTION ZONE
  - TEMPORARY PAVEMENT
  - TEMPORARY PAVEMENT FROM PREVIOUS STAGE
  - PERMANENT DITCH
  - EXISTING STORM SEWER
  - TEMPORARY/PROPOSED STORM SEWER

FILE NAME = D264987-ah-eros2A2.dgn	USER NAME = 3282090971	DESIGNED - LOM	REVISED -
		DRAWN - MD	REVISED -
	PLOT SCALE = 1/80,000" / IN.	CHECKED - PDK	REVISED -
	PLOT DATE = 1/18/2011	DATE - 01-19-2011	REVISED -

**STATE OF ILLINOIS  
DEPARTMENT OF TRANSPORTATION**

**STORM WATER POLLUTION PREVENTION PLAN  
& TEMPORARY DRAINAGE  
STAGE 2A**

F.A.P. RTE. 303	SECTION 129K-1	COUNTY WINNEBAGO	TOTAL SHEETS 401	SHEET NO. 191
CONTRACT NO. 64987				