

(C2) PIPE CULVERT, CLASS D, TYPE 1  
EQUIVALENT ROUND-SIZE, 15"  
34 LF @ 0.50%

(C1) STA. 677+85.8, 38.0' LT  
END SECTION, EOV RS, 15"  
N INV = 642.36

(C2) STA. 678+23.4, 38.0' LT  
END SECTION, EOV RS, 15"  
S INV = 642.55

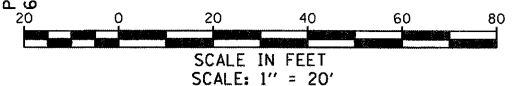
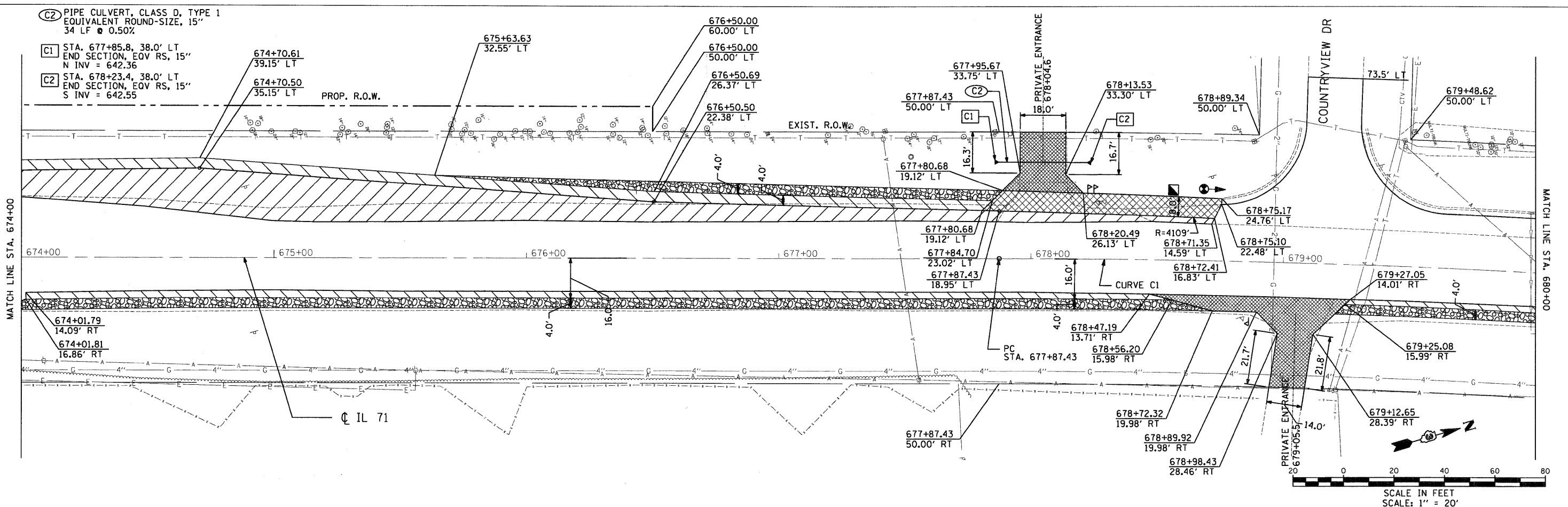

**CURVE C1**  
PI STA. = 687+75.69  
 $\Delta = 27^\circ 08' 43''$  (RT)  
D =  $1^\circ 23' 59''$   
R = 4,093.50'  
T = 988.25'  
L = 1,939.39'  
E = 117.60'  
S.E. = 2.3%  
P.C. STA. = 677+87.43  
P.T. STA. = 697+26.83

**IL-71 STANDARD SECTIONS:**

- PAVEMENT RESURFACING  
HMA SURFACE COURSE, MIX "D", N70; 1-1/2"
- PAVEMENT WIDENING  
HMA SURFACE COURSE, MIX "D", N70; 1-1/2"  
HMA BASE COURSE WIDENING; 11-1/2"  
SUB-BASE GRANULAR MATERIAL, TYPE A; 6"
- HOT-MIX ASPHALT SHOULDERS  
HMA SURFACE COURSE, MIX "D", N70; 1-1/2"  
HMA BINDER COURSE, IL-19.0, N70; 6-1/2"  
SUB-BASE GRANULAR MATERIAL, TYPE C (SEE GENERAL NOTES)  
SUB-BASE GRANULAR MATERIAL, TYPE A; 6"
- TEMPORARY PAVEMENT  
HMA SURFACE COURSE, MIX "D", N70; 1-1/2"  
HMA BINDER COURSE, IL-19.0, N70; 8"
- PAVED ENTRANCE AND MAILBOX TURNOUT  
HMA SURFACE COURSE, MIX "D", N70; 2"  
SUB-BASE GRANULAR MATERIAL, TYPE A; 6"
- AGGREGATE SHOULDER / ENTRANCE, TYPE B; 8"

- ① STEEL PLATE BEAM GUARDRAIL, TYPE A, 6 FT POSTS
- ② TRAFFIC BARRIER TERMINAL, TYPE 1 (SPECIAL) FLARED

**NOTES:**  
1. TEMPORARY PAVEMENT NORTH OF STA. 680+65.5  
SHALL NOT INCLUDE HMA SURFACE COURSE.

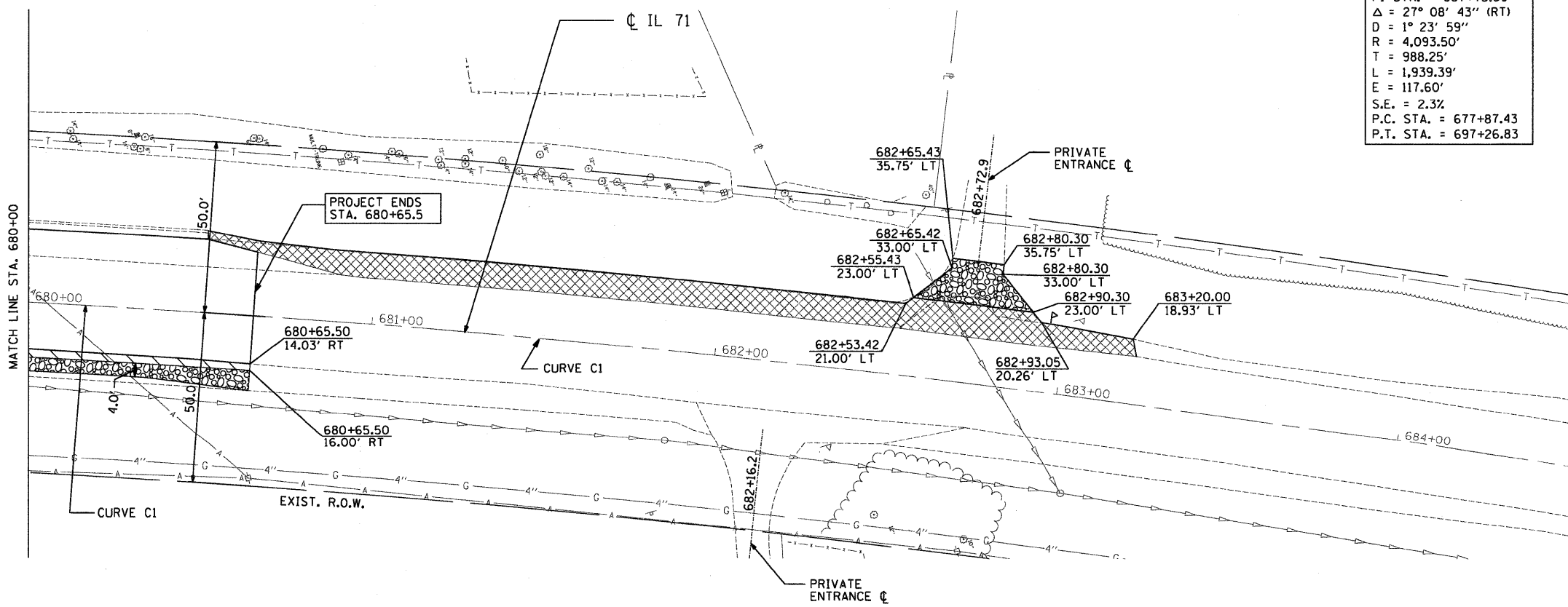

I:\jobs\2007\20073028-08\cadd\site\vdgn\00\_0366955-snt-plan-03.dgn  
 3/31/2011 12:05:53 PM

FILE NAME =	USER NAME = .USER.	DESIGNED - JWB	REVISED -	<b>STATE OF ILLINOIS DEPARTMENT OF TRANSPORTATION</b>	<b>FAP 311 (IL 71) AT VAN EMMON / RESERVATION ROADS ROADWAY PLAN</b>	F.A.P. RTE.	SECTION	COUNTY	TOTAL SHEETS	SHEET NO.	
		DRAWN - JWB	REVISED -			311	(1)-1IN TS	KENDALL	92	29	
PLOT SCALE = 20.0000 "/> <td></td> <td>CHECKED - RS</td> <td>REVISED -</td> <td colspan="6" style="text-align: center;">SCALE: 1" = 20 FT SHEET NO. -- OF -- SHEETS STA. 674+00 TO STA. 683+00</td>		CHECKED - RS	REVISED -			SCALE: 1" = 20 FT SHEET NO. -- OF -- SHEETS STA. 674+00 TO STA. 683+00					
PLOT DATE = 3/31/2011		DATE - 03/31/2011	REVISED -			ILLINOIS FED. AID PROJECT CONTRACT NO. 66955					