

INDEX OF SHEETS

- 1. COVER SHEET
- 2. GENERAL NOTES
- 3. SUMMARY OF QUANTITIES
- 4 - 5. TYPICAL SECTIONS
- 6. SCHEDULES
- 7. PAVEMENT MARKING
- 8. GREAT SAUK TRAIL REST AREA SOUTHBOUND SITE PLAN
- 9 - 10. PLAN DETAILS

STANDARDS

- 000001-06 STANDARD SYMBOLS, ABBREVIATIONS AND PATTERNS
- 001006 DECIMAL OF AN INCH AND OF A FOOT
- 420001-07 PAVEMENT JOINTS
- 424001-05 CURB RAMPS FOR SIDEWALK
- 442201-03 CLASS C AND D PATCHES
- 635001-01 DELINEATORS
- 635011-02 REFLECTOR MARKER AND MOUNTING DETAILS
- 701101-02 OFF-ROAD OPERATIONS MULTILANE, 15' (4.5 m) TO 24" (600 mm) FROM PAVEMENT EDGE
- 701106-02 OFF-ROAD OPERATIONS, MULTILANE, MORE THAN 15' (4.5 m) AWAY
- 701451-01 RAMP CLOSURE FREEWAY/EXPRESSWAY
- 701901-01 TRAFFIC CONTROL DEVICES

STATE OF ILLINOIS
DEPARTMENT OF TRANSPORTATION
DIVISION OF HIGHWAYS
**PROPOSED
HIGHWAY PLANS**

FAI ROUTE 80 (I-80)
SECTION (06-4)RA-5

**REST AREA REPAIR AND RENOVATION
BUREAU COUNTY**
C-93-087-11

F.A.I. RTE.	SECTION	COUNTY	TOTAL SHEETS	SHEET NO.
80	(06-4)RA-5	BUREAU	10	1
		ILLINOIS	CONTRACT NO. 66B21	

D-93-068-11

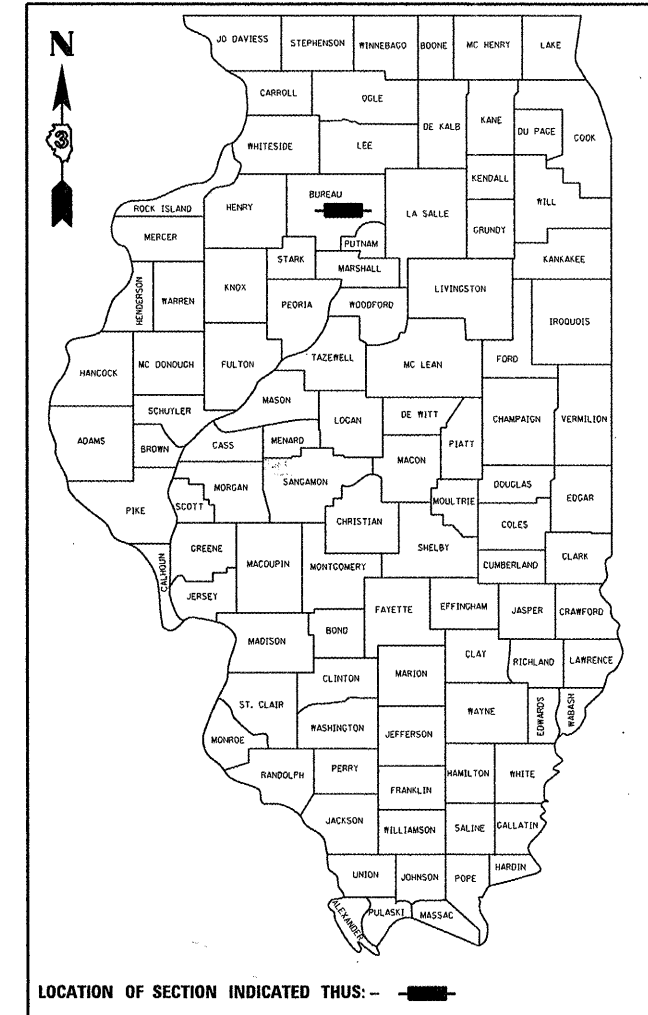

LOCATION OF SECTION INDICATED THIS: - [shaded box] -

RURAL - INTERSTATE

FAI RTE. 80 (I-80) 2009	EB REST AREA 2009
ADT 15600	ADT 1200
P.V. 54.48%	P.V. 47.92%
S.U. 3.85%	S.U. 18.75%
M.U. 41.67%	M.U. 33.33%

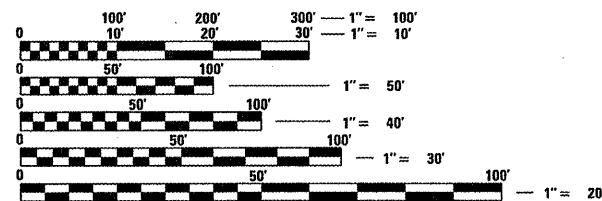

FULL SIZE PLANS HAVE BEEN PREPARED USING STANDARD ENGINEERING SCALES. REDUCED SIZED PLANS WILL NOT CONFORM TO STANDARD SCALES. IN MAKING MEASUREMENTS ON REDUCED PLANS, THE ABOVE SCALES MAY BE USED.

J.U.L.I.E.
JOINT UTILITY LOCATION INFORMATION FOR EXCAVATION
1-800-892-0123
OR 811

PROJECT LOCATION
FAI ROUTE 80
GREAT SAUK TRAILS
EASTBOUND REST AREA

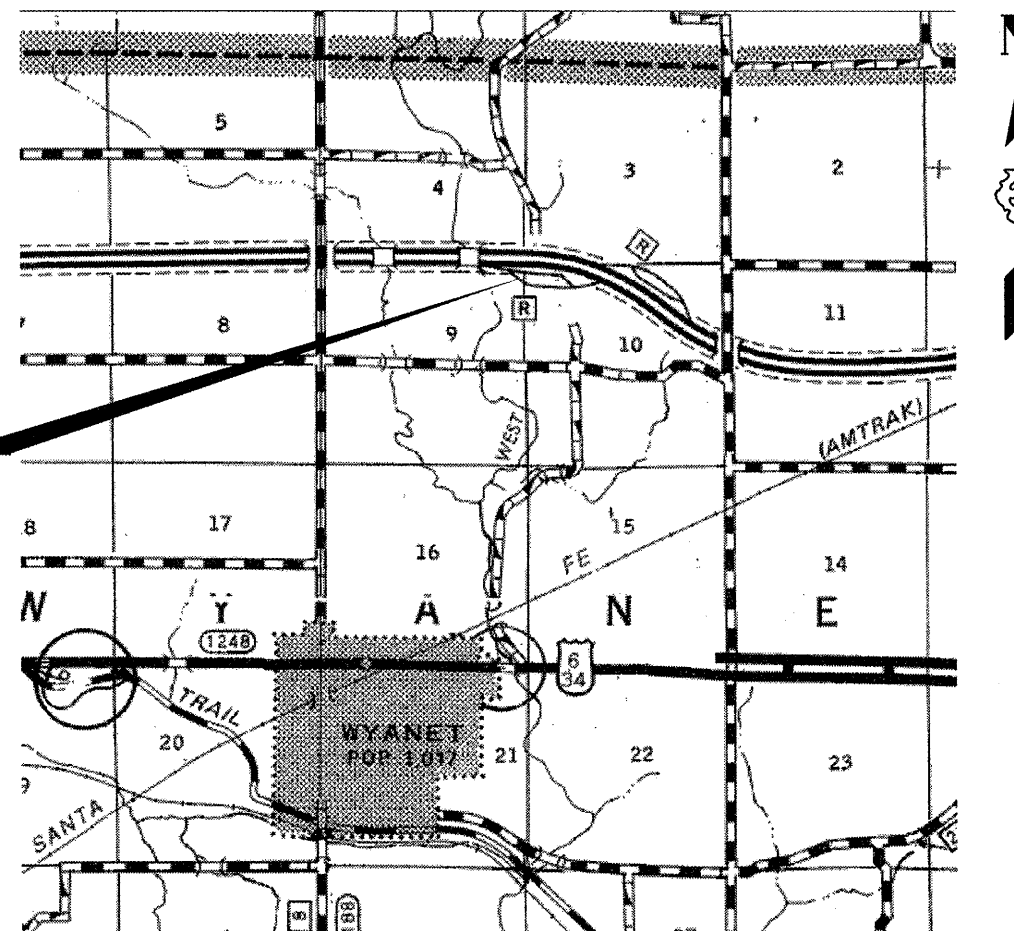

PROJECT ENGINEER: JOE KANNEL P.E.
UNIT CHIEF: RON WOODSHANK
TOWNSHIP: WYANET
CONTRACT NO. 66B21

STATE OF ILLINOIS
DEPARTMENT OF TRANSPORTATION
DIVISION OF HIGHWAYS

SUBMITTED 4-25 20 11
Eric S. Tharler
DEPUTY DIRECTOR OF HIGHWAYS, REGION ENGINEER

May 13 20 11
Scott E. Stitt P.E.
ENGINEER OF DESIGN AND ENVIRONMENT

May 13 20 11
Christine M. Reed
DIRECTOR OF HIGHWAYS, CHIEF ENGINEER

**PRINTED BY THE AUTHORITY
OF THE STATE OF ILLINOIS**

GENERAL NOTES

PLAN DIMENSIONS AND DETAILS RELATIVE TO EXISTING PLANS ARE SUBJECT TO NOMINAL CONSTRUCTION VARIATIONS. THE CONTRACTOR SHALL FIELD VERIFY EXISTING DIMENSIONS AND DETAILS AFFECTING NEW CONSTRUCTION AND MAKE NECESSARY APPROVED ADJUSTMENTS PRIOR TO CONSTRUCTION OR ORDERING OF MATERIALS. SUCH VARIATIONS SHALL NOT BE CAUSE FOR ADDITIONAL COMPENSATION FOR A CHANGE IN SCOPE OF WORK; HOWEVER, THE CONTRACTOR WILL BE PAID FOR THE QUANTITY ACTUALLY FURNISHED AT THE UNIT PRICE BID FOR THE WORK.

THE THICKNESS OF HMA SHOWN ON THE PLANS IS THE NOMINAL THICKNESS. DEVIATIONS FROM THE NOMINAL THICKNESS WILL BE PERMITTED WHEN SUCH DEVIATIONS OCCUR DUE TO IRREGULARITIES IN THE EXISTING SURFACE OR BASE ON WHICH THE HMA IS PLACED.

THE ENGINEER WILL BE THE SOLE JUDGE CONCERNING CURING TIME FOR THE VARIOUS HMA LIFTS.

FOR STABILIZATION, ALL TYPE III BARRICADES SHALL REQUIRE A MINIMUM OF FOUR SAND BAGS PER BARRICADE.

ABANDONED UNDERGROUND UTILITIES THAT CONFLICT WITH CONSTRUCTION SHALL BE DISPOSED OF OUTSIDE THE LIMITS OF THE RIGHT OF WAY ACCORDING TO ARTICLE 202.03 OF THE STANDARD SPECIFICATIONS AND AS DIRECTED BY THE ENGINEER. THIS WORK WILL NOT BE PAID FOR SEPARATELY, BUT SHALL BE INCLUDED IN THE COST OF EARTH EXCAVATION.

ANY REFERENCE TO A STANDARD IN THESE PLANS SHALL BE INTERPRETED TO MEAN THE EDITION AS INDICATED BY THE SUBNUMBER SHOWN IN THE LIST OF STANDARDS OR THE COPY INCLUDED IN THESE PLANS.

THE CONTRACTOR'S ATTENTION IS DIRECTED TO THE PRESENCE OF DEPARTMENT-OWNED UNDERGROUND ELECTRICAL CABLE WITHIN THE LIMITS OF THE PROPOSED IMPROVEMENT. THE CONTRACTOR SHALL REQUEST THE ILLINOIS DEPARTMENT OF TRANSPORTATION IN OTTAWA (815-434-8417) TO LOCATE THE UNDERGROUND FACILITIES, PROVIDING A MINIMUM OF 72 HOURS NOTICE. THE DEPARTMENT IS NOT A MEMBER OF THE JOINT UTILITY LOCATING INFORMATION FOR EXCAVATORS (JULIE) SYSTEM.

ALL DAMAGE TO DEPARTMENT OWNED UNDERGROUND FACILITIES, CAUSED BY THE CONTRACTOR SHALL BE REPAIRED TO THE SATISFACTION OF THE DEPARTMENT AT THE CONTRACTOR'S EXPENSE. THIS SHALL INCLUDE ALL TEMPORARY REPAIRS REQUIRED TO KEEP THE FACILITY OPERATIONAL WHILE MATERIAL IS BEING OBTAINED TO MAKE PERMANENT REPAIRS. SPLICING OF ELECTRIC CABLE SHALL NOT BE ALLOWED. ELECTRIC CABLE SHALL BE REPLACED FROM POLE TO POLE OR CONTROLLER.

THE CONTRACTOR SHALL CONTACT JULIE AT LEAST 48 HOURS PRIOR TO EXCAVATION TO DETERMINE WHICH UTILITIES ARE IN THE AREA.

COMMITMENTS

NONE 02/22/2011

	POLYMER HOT-MIX ASPHALT SURFACE CSE.
PG GRADE	SBS PG70-22
DESIGN AIR	4.0%
VOIDS	Ø N90
MIXTURE COMPOSITION	IL 9.5
FRICTION AGGREGATE	MIXTURE C
DENSITY CONTROL METHOD	CORES

DATE: 4-25-11

PREPARED BY: Don Bonish
DISTRICT STUDIES & PLANS ENGINEER

EXAMINED BY: Wayne L. Kelly
DISTRICT CONSTRUCTION ENGINEER

Bruce A. Huch
DISTRICT MATERIALS ENGINEER

Bruce A. Huch
DISTRICT OPERATIONS ENGINEER

FILE NAME =	USER NAME = patelij	DESIGNED - RON WOODSHANK	REVISED -	STATE OF ILLINOIS DEPARTMENT OF TRANSPORTATION	GENERAL NOTES	F.A.I. RTE.	SECTION	COUNTY	TOTAL SHEETS	SHEET NO.
ct:\pw\work\p\dot\patelij\02257878\0366821-sht-details.DGN	DRAWN - RON WOODSHANK	REVISED -	80			06-41RA-5	BUREAU	10	2	
PLOT SCALE = 100.0000' / 1"	CHECKED -	REVISED -	CONTRACT NO. 66B21							
PLOT DATE = 4/21/2011	DATE -	REVISED -	ILLINOIS FED. AID PROJECT							
				SCALE: _____ SHEET NO. 1 OF 1 SHEETS STA. _____ TO STA. _____						

CODE NO.	ITEM	UNIT	TOTAL QUANTITY	CONSTR. CODE
				STATE FUNDS
				100% STATE
				ROADWAY
				0005
				RURAL
40600115	POLYMERIZED BITUMINOUS MATERIALS (PRIME COAT)	GALLON	857	857
40600400	MIXTURE FOR CRACKS, JOINTS, AND FLANGEWAYS	TON	15	15
40603520	POLYMERIZED HOT-MIX ASPHALT SURFACE COURSE, MIX "C", N90	TON	612	612
42400200	PORTLAND CEMENT CONCRETE SIDEWALK 5 INCH	SQ FT	300	300
42400800	DETECTABLE WARNINGS	SQ FT	40	40
44000155	HOT-MIX ASPHALT SURFACE REMOVAL, 1 1/2"	SQ YD	4755	4755
44000500	COMBINATION CURB AND GUTTER REMOVAL	FOOT	90	90
44000600	SIDEWALK REMOVAL	SQ FT	300	300
44213200	SAW CUTS	FOOT	2211	2211
44200970	CLASS B PATCHES, TYPE II, 10 INCH	SQ YD	88	88
44200974	CLASS B PATCHES, TYPE III, 10 INCH	SQ YD	141	141
44200976	CLASS B PATCHES, TYPE IV, 10 INCH	SQ YD	652	652
44213100	PAVEMENT FABRIC	SQ YD	1034	1034
44213204	TIE BARS 3/4"	EACH	1163	1163
44201299	DOWEL BARS 1 1/2"	EACH	1074	1074
48102100	AGGREGATE WEDGE SHOULDER, TYPE B	TON	19	19
60605000	COMBINATION CONCRETE CURB AND GUTTER, TYPE B-6.24	FOOT	90	90
63500105	DELINEATORS	EACH	80	80
67100100	MOBILIZATION	L SUM	1	1
70100820	TRAFFIC CONTROL AND PROTECTION, STANDARD 701451	L SUM	1	1
* 78005100	EPOXY PAVEMENT MARKING - LETTERS AND SYMBOLS	SQ FT	9.2	9.2
* 78005110	EPOXY PAVEMENT MARKING - LINE 4"	FOOT	3208	3208
Z0037310	PAVEMENT PATCHING (FULL DEPTH)	SQ YD	152	152

*SPECIALITY ITEMS

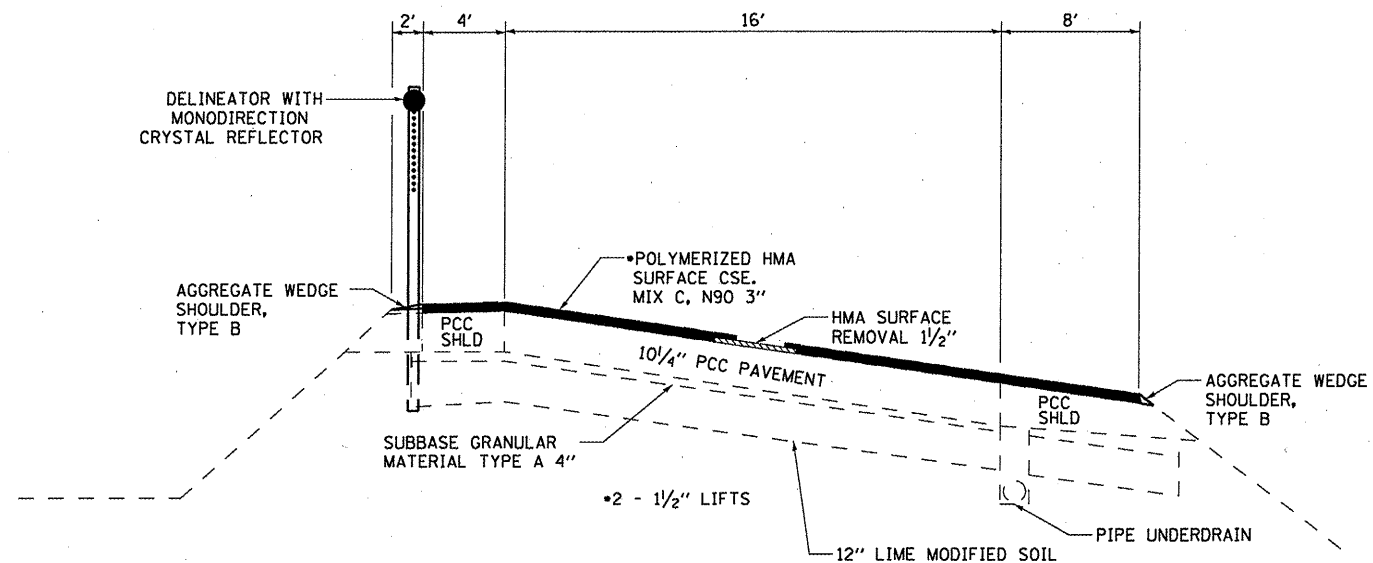

**TYPICAL SECTION
RAMP**

STA. 691+95 TO STA. 695+82

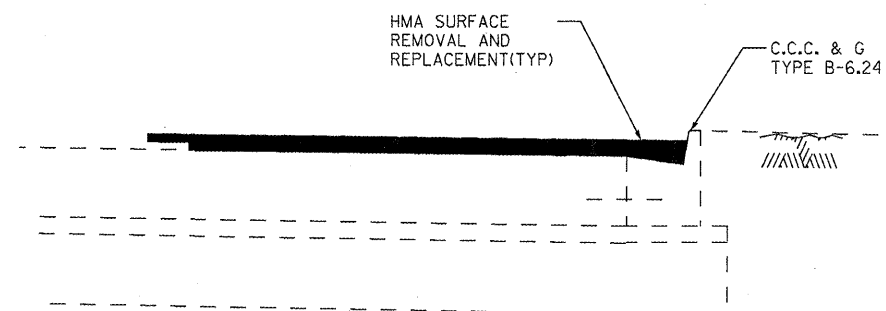

DETAIL A

THE CONTRACTOR SHALL EXERCISE CARE WHEN REMOVING HMA FROM THE GUTTER PAN. REPAIRS TO DAMAGED GUTTER PAN OR CURB DUE TO THE CONTRACTORS HMA REMOVAL OPERATIONS WILL BE PAID FOR AT THE CONTRACTORS EXPENSE. (TYP)

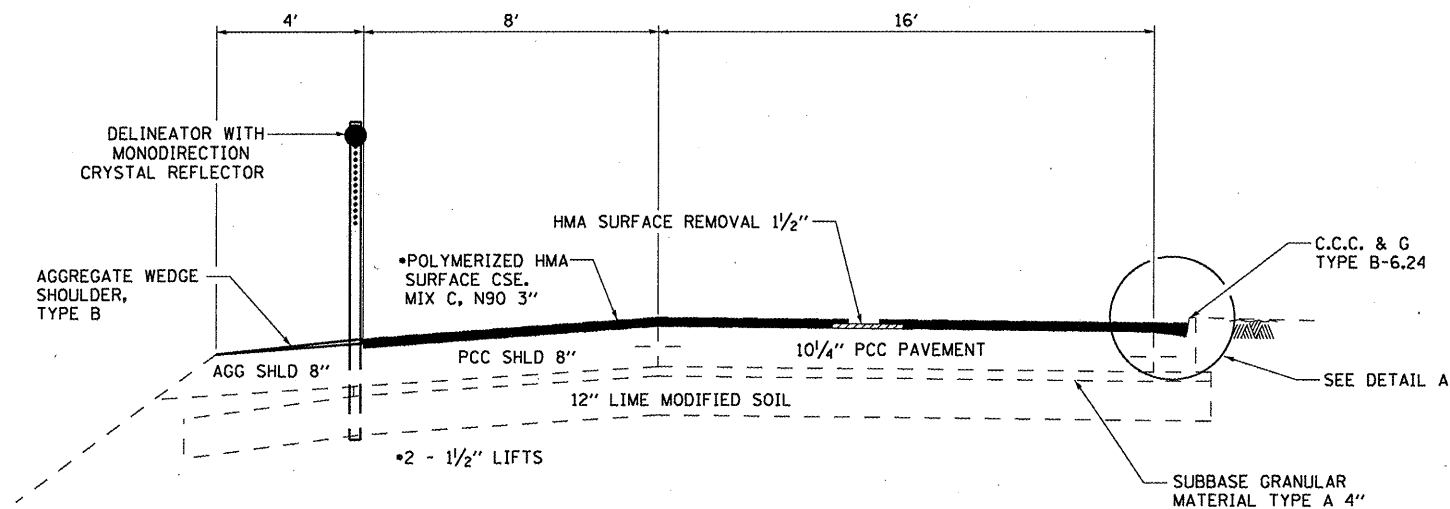

**TYPICAL SECTION
TRUCK LANE**

STA. 695+82 TO STA. 700+00

FILE NAME = c:\pwwork\pwidat\potelyj\d0257878\036821-sht-details.DGN	USER NAME = potelyj	DESIGNED - RON WOODSHANK	REVISED - _____	STATE OF ILLINOIS DEPARTMENT OF TRANSPORTATION	TYPICAL SECTIONS		F.A.I. RTE. 80	SECTION 106-41RA-5	COUNTY BUREAU	TOTAL SHEETS 10	SHEET NO. 4
	PLOT SCALE = 100.0000' / 1in.	CHECKED - _____	REVISED - _____		SCALE: _____	SHEET NO. 1 OF 2 SHEETS	STA. _____ TO STA. _____	CONTRACT NO. 66B21		ILLINOIS FED. AID PROJECT	
PLOT DATE = 4/21/2011	DATE - _____	REVISED - _____	REVISED - _____								

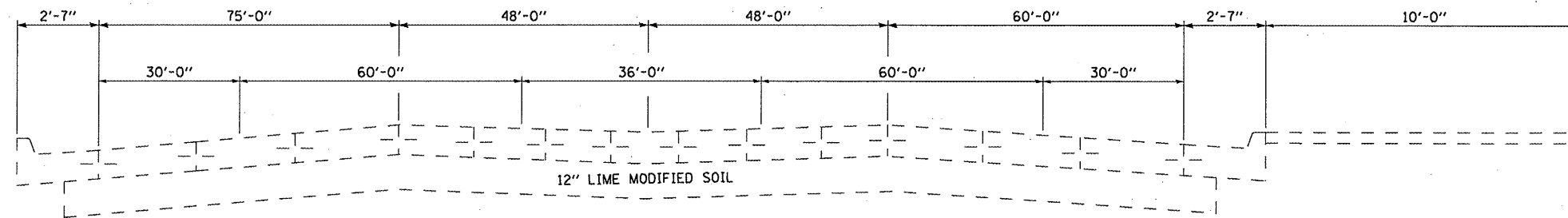

**TYPICAL SECTION
TRUCK PARKING LOT**

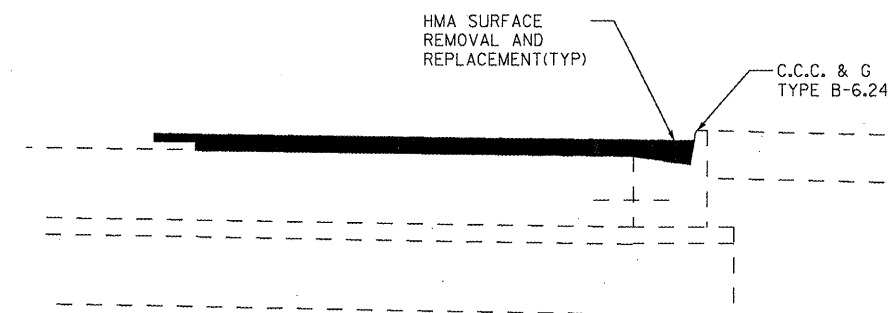

DETAIL B

THE CONTRACTOR SHALL EXERCISE CARE WHEN REMOVING HMA FROM THE GUTTER PAN. REPAIRS TO DAMAGED GUTTER PAN OR CURB DUE TO THE CONTRACTORS HMA REMOVAL OPERATIONS WILL BE PAID FOR AT THE CONTRACTORS EXPENSE. (TYP)

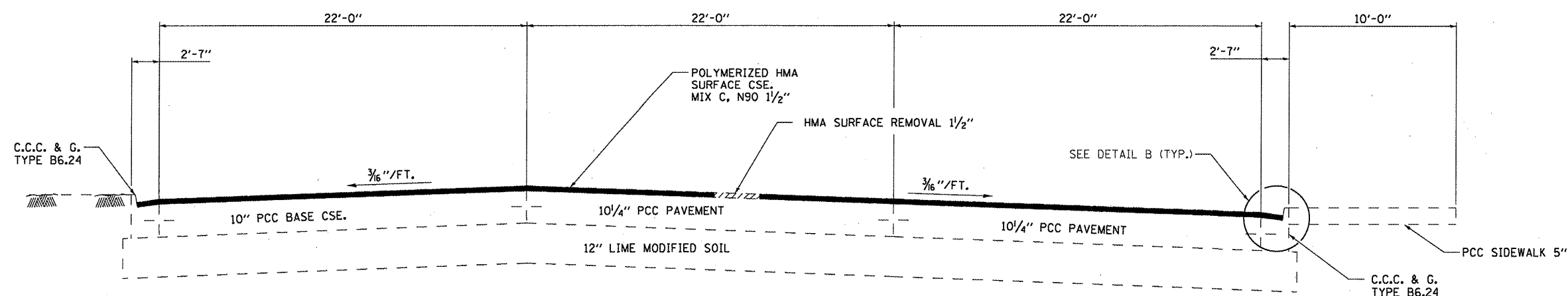

**TYPICAL SECTION
CAR PARKING LOT**

FILE NAME =	USER NAME = potelyj	DESIGNED - RON WOODSHANK	REVISED -	STATE OF ILLINOIS DEPARTMENT OF TRANSPORTATION	TYPICAL SECTIONS		F.A.I. RTE.	SECTION	COUNTY	TOTAL SHEETS	SHEET NO.	
cr:\pw_work\pwidot\potelyj\0257878\0368	21-sht-details.DGN	DRAWN - RON WOODSHANK	REVISED -		SCALE: _____	SHEET NO. 2 OF 2 SHEETS	STA. _____ TO STA. _____	80	106-41RA-5	BUREAU	10	5
	PLOT SCALE = 100.0000' / 1in.	CHECKED -	REVISED -					CONTRACT NO. 66B21				
	PLOT DATE = 4/21/2011	DATE -	REVISED -					ILLINOIS FED. AID PROJECT				

SCHEDULE - PAVEMENT PATCHING								
LOCATION	CLASS B PATCHING TYPE II 10"	CLASS B PATCHING TYPE III 10"	CLASS B PATCHING TYPE IV 10"	PAVEMENT PATCHING (FULL DEPTH)	DOWEL BARS	SAW CUTS	PAVEMENT FABRIC	TIE BARS
	SO YD	SO YD	SO YD	SO YD	EACH	FEET	SO YD	EACH
TRUCK PARKING LOT								
P1			26		26	60	26	26
P2	5				3	22	5	20
P3		19			26	53	19	20
P4	6				7	16	6	20
P5			38		13	54	38	15
P6	12				15	18	12	22
P7			31		29	67	31	30
P8	15				19	33	15	22
P9		25			28	44	25	24
P10	9				8	20	9	24
P11		22			18	54	22	31
P12			28		28	64	28	28
P13	15				13	38	15	30
P14		21			23	55	21	25
P15			27		28	62	27	26
P16			27		28	62	27	26
P17			29		28	64	29	28
P18			28		28	64	28	28
P19		17			28	35	17	16
P20			28		28	48	28	28
P21			28		28	48	28	28
P22			28		28	48	28	28
P23		20			18	38	20	28
P24			27		28	62	27	26
P25			26		26	62	26	24
P26			26		26	49	26	24
P27			25		28	60	25	24
P28			25		28	46	25	24
P29			23		28	58	23	22
P30			25		28	28	25	24
P31			23		26	58	23	22
P32			25		28	30	25	24
P33			23		26	46	23	22
P34			30		28	66	30	30
P35			30		28	49	30	30
P36		18			24	52	18	21
P37			26		28	61	26	26
P38	15				10	66	15	44
P39	11				28	28	11	8
CAR PARKING LOT				152	158	325	152	195
TOTAL	88	141	652	152	1074	2211	1034	1163

SCHEDULE - PAVEMENT MARKING			
LOCATION	EPOXY PAVEMENT MARKING L & S	EPOXY PAVEMENT MARKING LINE 4"	
	SO FT	FEET	
	WHITE	YELLOW	WHITE
STA. 691+95 TO STA. 700+00		808	390
CAR PARKING (ENTRANCE)			318
CAR PARKING LOT			1312
HANDICAP PARKING	9.2		380
SUBTOTAL	9.2	808	2400
TOTAL	9.2	3208	

SCHEDULE - DELINEATORS		
LOCATION	DELINEATORS	
	STA. TO STA.	EACH
STA. 691+95 TO STA. 700+00		80
TOTAL		80

SCHEDULE - AGG WEDGE SHLD TYPE B		
LOCATION	TONS	
	STA. TO STA.	TONS
STA. 691+95 TO STA. 695+82		8
STA. 695+82 TO STA. 700+00		8
STA. 695+82 TO STA. 500+00		3
TOTAL		19

SCHEDULE - HMA RESURFACING				
LOCATION	HMA SURFACE REMOVAL 1 1/2"	MIXTURE FOR CRACKS JOINT AND FLANGWAYS	POLYMERIZED BITUMINOUS MATERIALS (PRIME COAT)	POLYMERIZED HMA SURFACE CSE. MIX C, N90
	SO YD	TON	GAL	TON
STA. 691+95 TO STA. 700+00	2348	5	423	394
CAR PARKING (ENTRANCE)	382	5	69	48
CAR PARKING LOT	2025	5	365	170
TOTAL	4755	15	857	612

SCHEDULE - HANDICAP PARKING						
LOCATION	COMBINATION CURB & GUTTER REMOVAL	COMBINATION CONCRETE CURB & GUTTER TYPE B-6.24	SIDEWALK REMOVAL	PORTLAND CEMENT CONCRETE SIDEWALK 5"	DETECTABLE WARNINGS	TIE BARS 3/4"
	FOOT	FOOT	EACH	EACH	SO FT	EACH
HANDICAP PARKING	90	90	300	300	40	36
TOTAL	90	90	300	300	40	36

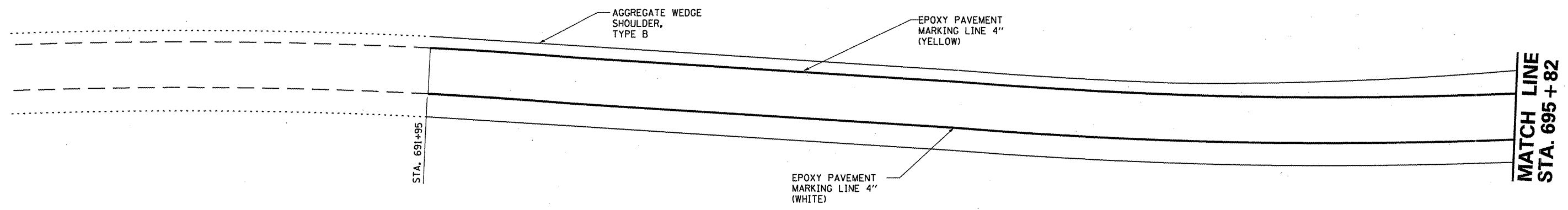

PLAN

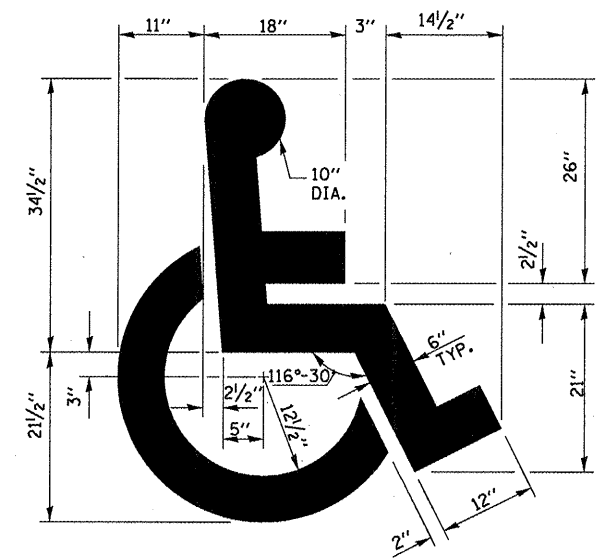

TYPICAL DETAIL FOR PAINTING HANDICAP MARKINGS

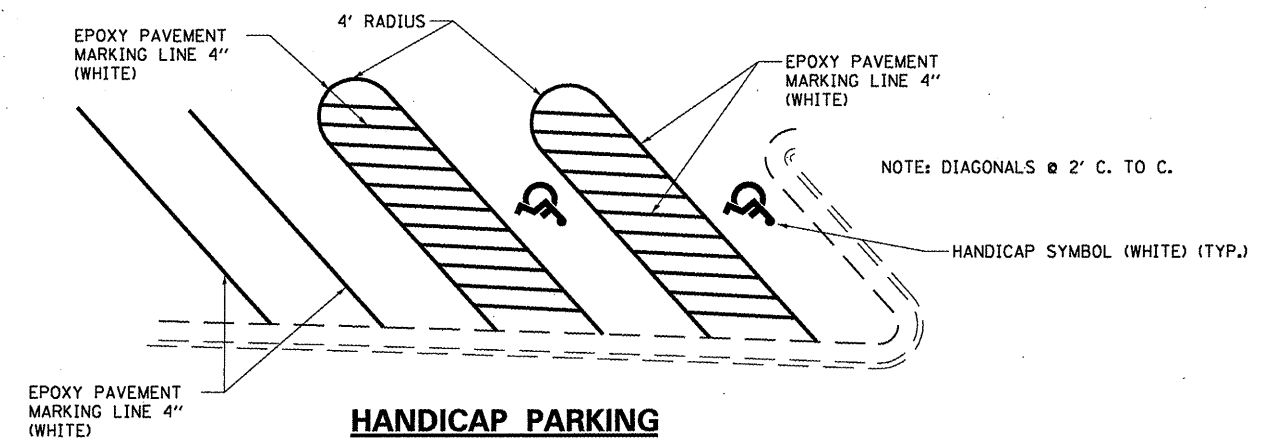

HANDICAP PARKING

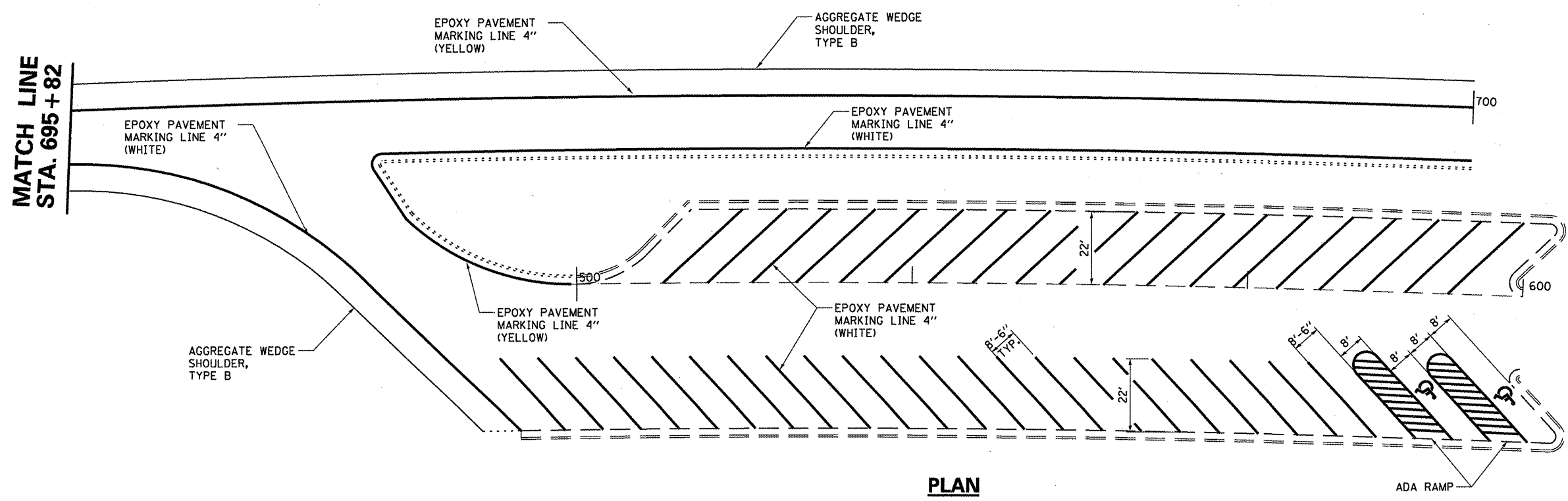

PLAN



FILE NAME =	USER NAME = petelj	DESIGNED - RON WOODSHANK	REVISED -	STATE OF ILLINOIS DEPARTMENT OF TRANSPORTATION	PAVEMENT MARKING		F.A.I. RTE.	SECTION	COUNTY	TOTAL SHEETS	SHEET NO.
ca\pw_work\pwidot\petelj\0257878\0368	21-shd-details.DGN	DRAWN - RON WOODSHANK	REVISED -		80	(06-4)RA-5	BUREAU	10	7		
PLOT SCALE = 1/8" = 1' / in.	CHECKED -	REVISOR -	REVISED -		SCALE: _____ SHEET NO. 1 OF 1 SHEETS STA. _____ TO STA. _____			CONTRACT NO. 66B21			
PLOT DATE = 4/21/2011	DATE -	REVISOR -	REVISED -		ILLINOIS FED. AID PROJECT						

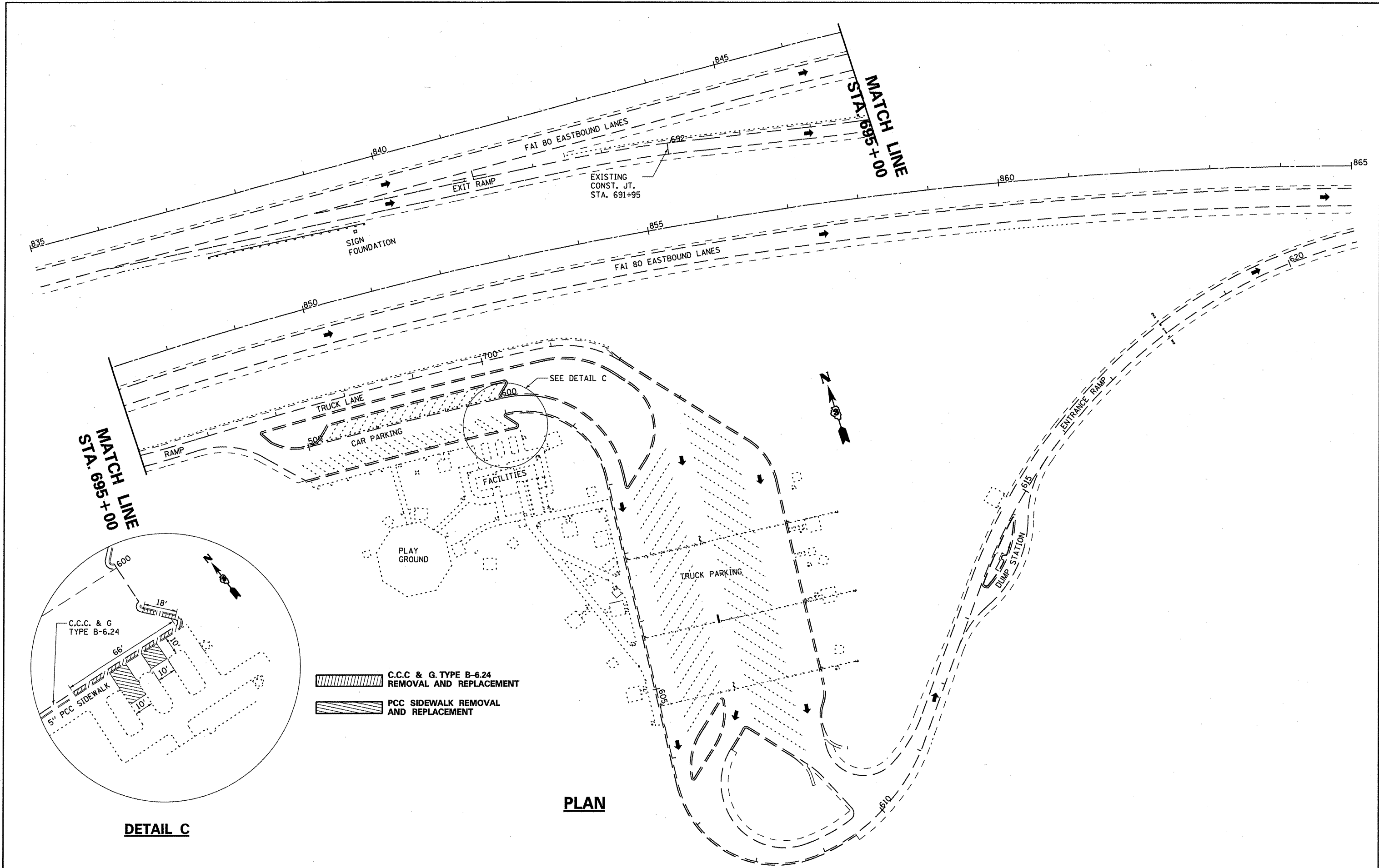

FILE NAME =	USER NAME = potelyj	DESIGNED - RON WOODSHANK	REVISED -	STATE OF ILLINOIS DEPARTMENT OF TRANSPORTATION	GREAT SAUK TRAIL REST AREA EASTBOUND SITE PLAN		F.A.I. RTE.	SECTION	COUNTY	TOTAL SHEETS	SHEET NO.
ea:\pw_work\pwidot\potelyj\d0257878\0368	21-sht-details.DGN	DRAWN - RON WOODSHANK	REVISED -		80	(06-4)RA-5	BUREAU	10	8		
PLOT SCALE = 1/8" = 1' / in.	CHECKED -	REVISOR -	REVISED -		CONTRACT NO. 66B21						
PLOT DATE = 4/21/2011	DATE -	REVISOR -	REVISED -		ILLINOIS FED. AID PROJECT						
				SCALE: _____	SHEET NO. 1 OF 1 SHEETS	STA. _____ TO STA. _____					

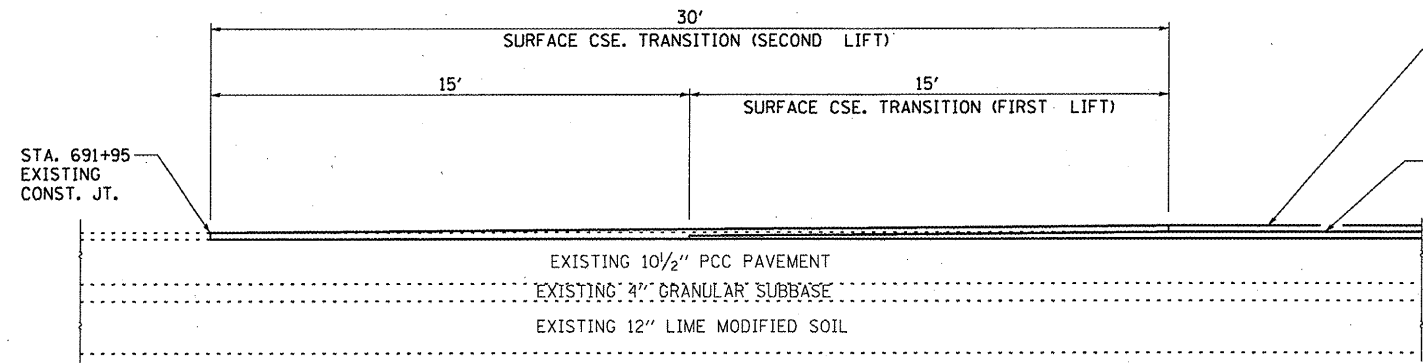

SECTION A-A

STA. 691+95
EXISTING
CONST. JT.

POLYMERIZED
HMA SURFACE CSE.
MIX C, N90 1 1/2"
(2ND LIFT)

POLYMERIZED
HMA SURFACE CSE.
MIX C, N90 1 1/2"
(1ST LIFT)

EXISTING 10 1/2" PCC PAVEMENT
EXISTING 4" GRANULAR SUBBASE
EXISTING 12" LIME MODIFIED SOIL

STA. 695+00
MATCH LINE

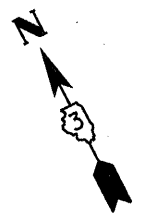
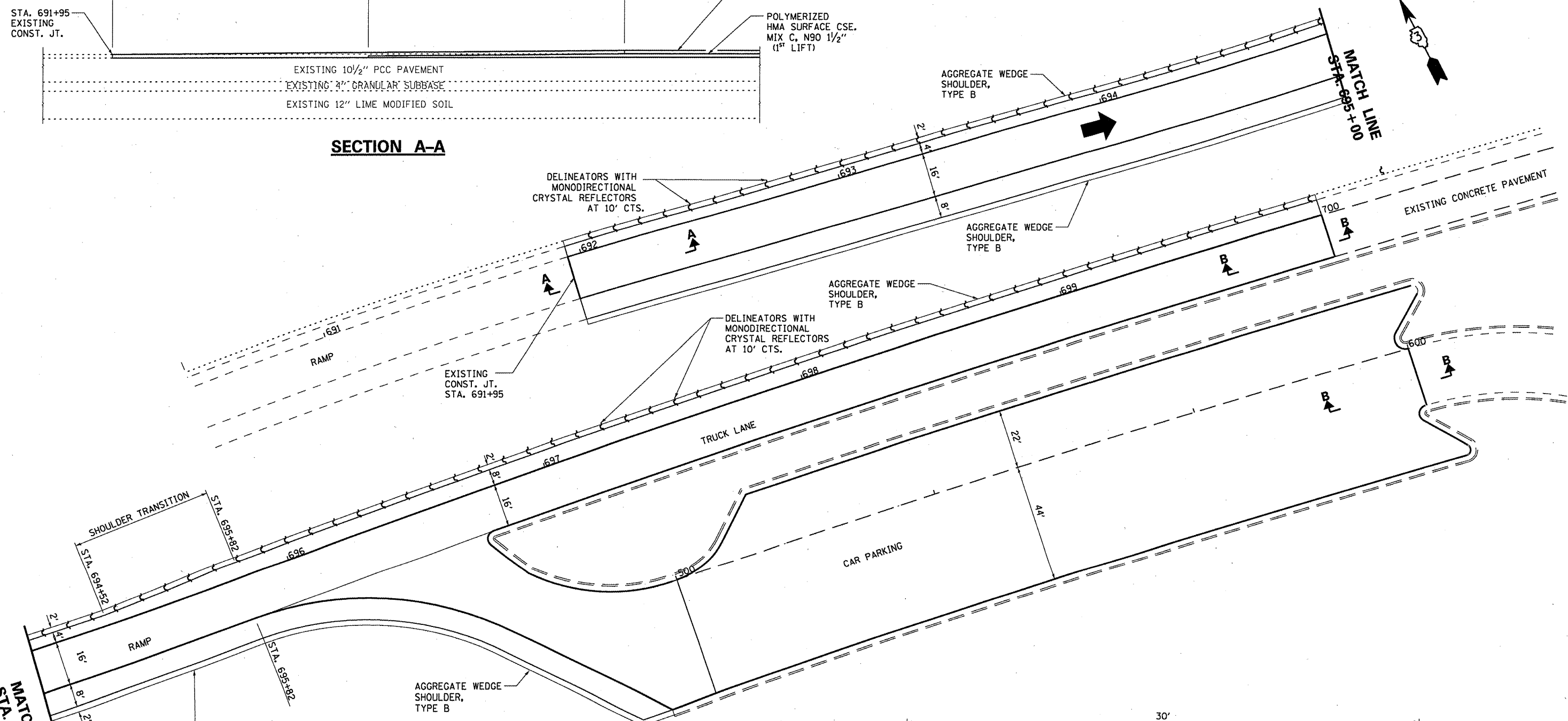

SHOULDER TRANSITION
STA. 694+52
STA. 695+82

RAMP
STA. 695+82

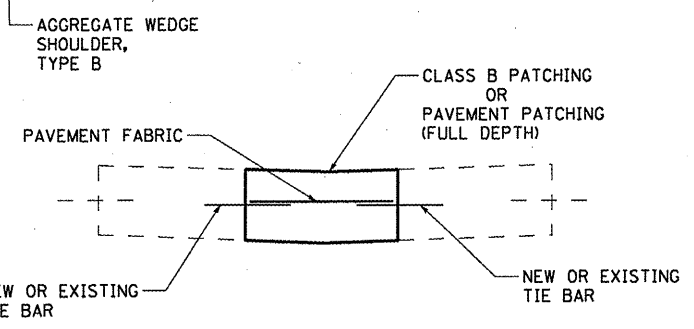

PATCHING DETAIL

POLYMERIZED
HMA SURFACE CSE.
MIX C, N90 1 1/2"
(2ND LIFT)

POLYMERIZED
HMA SURFACE CSE.
MIX C, N90 1 1/2"
(1ST LIFT)

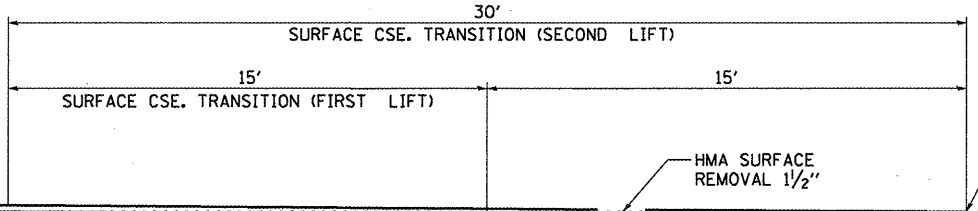

SECTION B-B

STA. 700+00
END TRUCK LANE
OR
STA. 600+00
BEGIN LANE (EXIT)

FILE NAME =	USER NAME = potelijj	DESIGNED - RON WOODSHANK	REVISED -
ct:\pv\work\pwwid\potelijj\d0257878\0366821-ahd-details.dgn		DRAWN - RON WOODSHANK	REVISED -
PLOT SCALE = 100.0000' / in.		CHECKED -	REVISED -
PLOT DATE = 4/21/2011		DATE -	REVISED -

**STATE OF ILLINOIS
DEPARTMENT OF TRANSPORTATION**

SCALE: _____		SHEET NO. 1 OF 2 SHEETS		STA. _____ TO STA. _____	
--------------	--	-------------------------	--	--------------------------	--

F.A.I. RTE.	SECTION	COUNTY	TOTAL SHEETS	SHEET NO.
80	106-41RA-5	BUREAU	10	9
			CONTRACT NO. 66B21	
ILLINOIS FED. AID PROJECT				

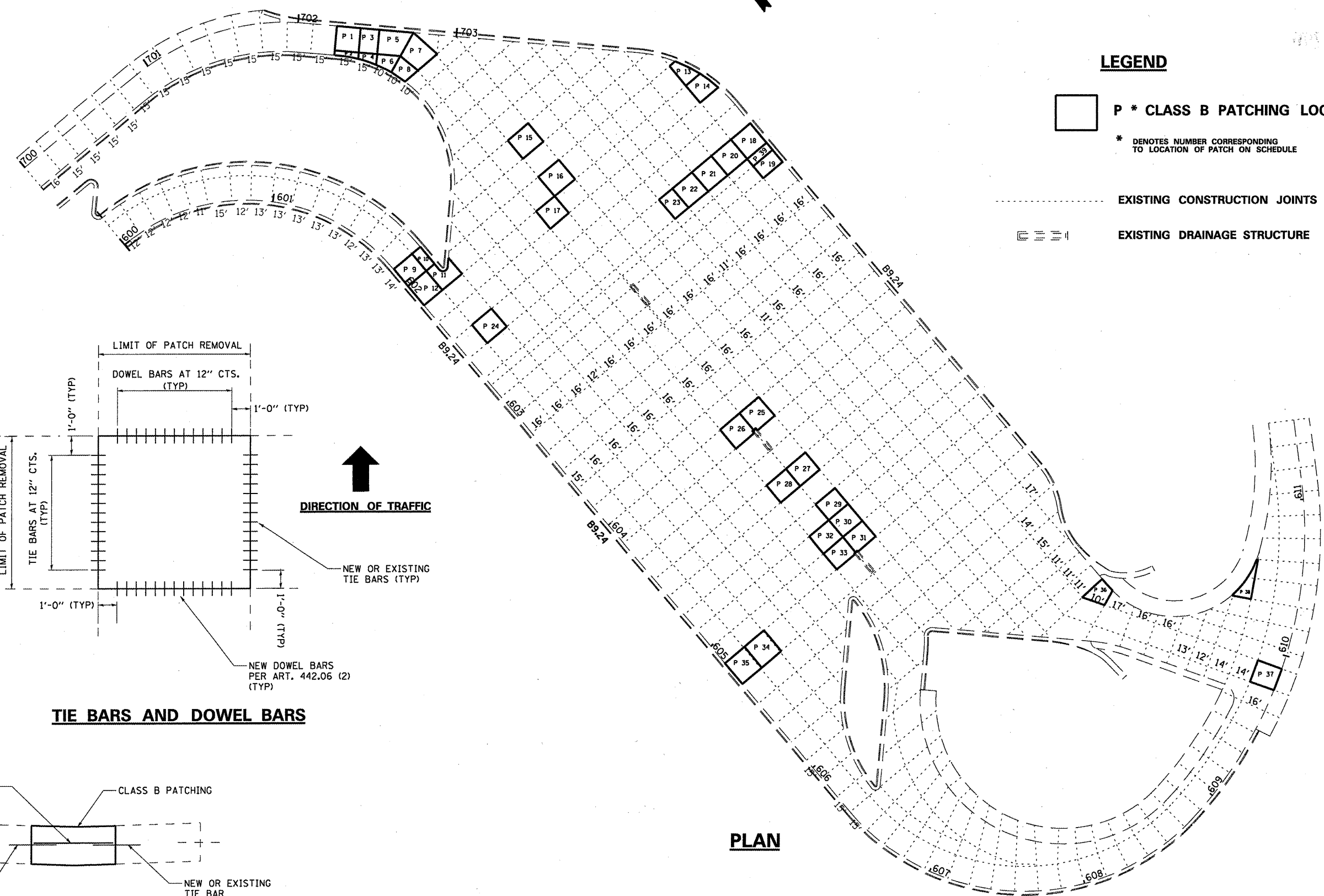
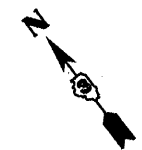

LEGEND

P * CLASS B PATCHING LOCATION

* DENOTES NUMBER CORRESPONDING TO LOCATION OF PATCH ON SCHEDULE

EXISTING CONSTRUCTION JOINTS

EXISTING DRAINAGE STRUCTURE

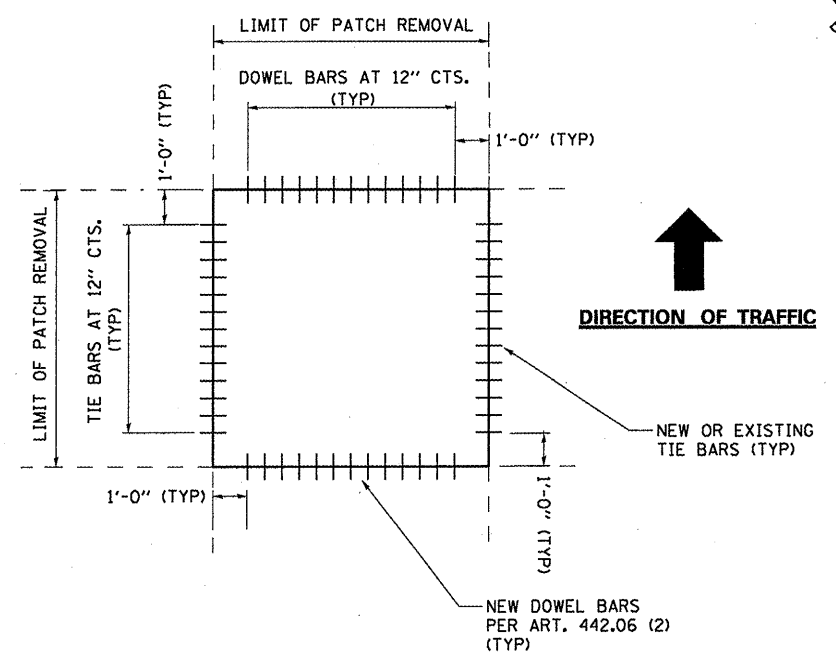

TIE BARS AND DOWEL BARS

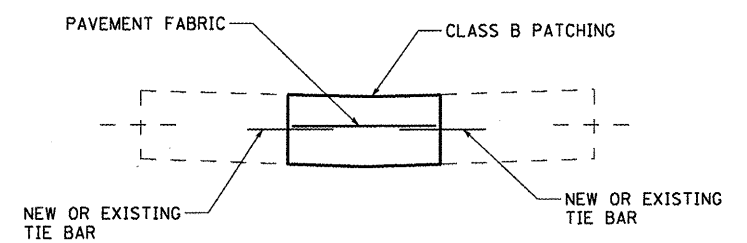

PATCHING DETAIL

PLAN

FILE NAME =	USER NAME = potelyj	DESIGNED - RON WOODSHANK	REVISED -
c:\pvc\work\pvc\potelyj\0257878\0366	21-shr-details.DGN	DRAWN - RON WOODSHANK	REVISED -
	PLOT SCALE = 100.0000' / 1"	CHECKED -	REVISED -
	PLOT DATE = 4/21/2011	DATE -	REVISED -

**STATE OF ILLINOIS
DEPARTMENT OF TRANSPORTATION**

PLAN DETAILS	
SCALE: _____	SHEET NO. 2 OF 2 SHEETS
STA. _____	TO STA. _____

F.A.I. RTE. 80	SECTION (06-4)RA-5	COUNTY BUREAU	TOTAL SHEETS 10	SHEET NO. 10
CONTRACT NO. 66B21			ILLINOIS FED. AID PROJECT	