

EXISTING PAVEMENT SAWING DETAIL

(AGAINST BITUMINOUS SHOULDER)

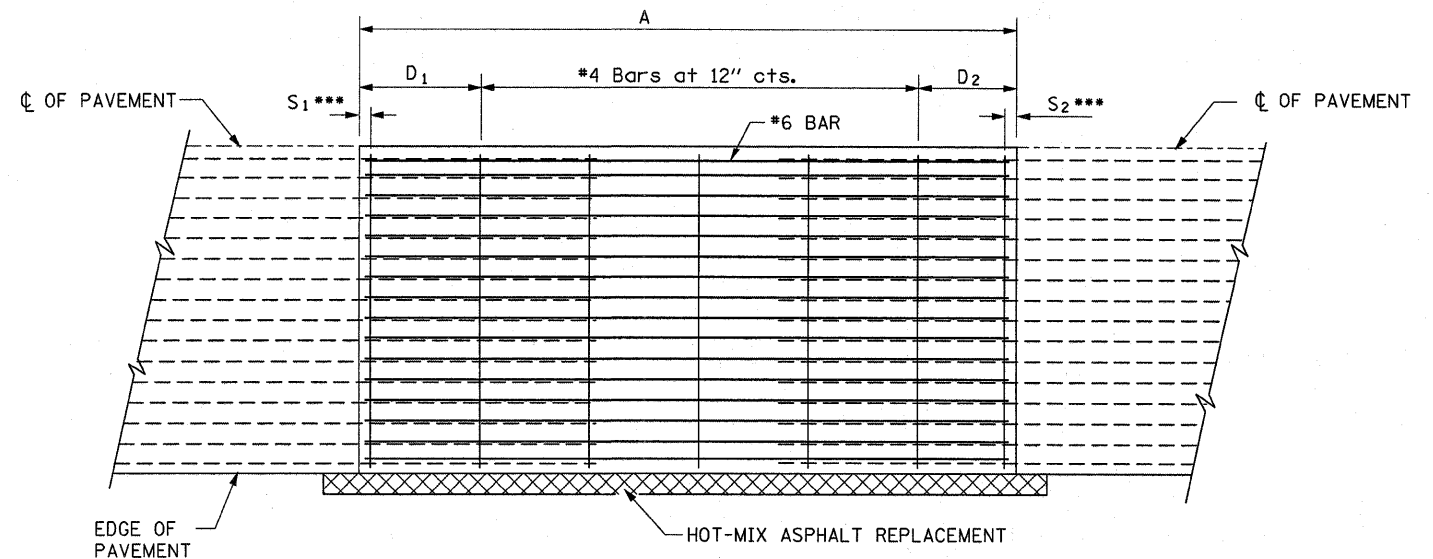

PROPOSED PAVEMENT DETAIL

(AGAINST BITUMINOUS SHOULDER)

EXISTING LONGITUDINAL REINFORCEMENT BARS	A (min.)	B (min.)	C (min.)
No. 6	6'-0"	24"	19"

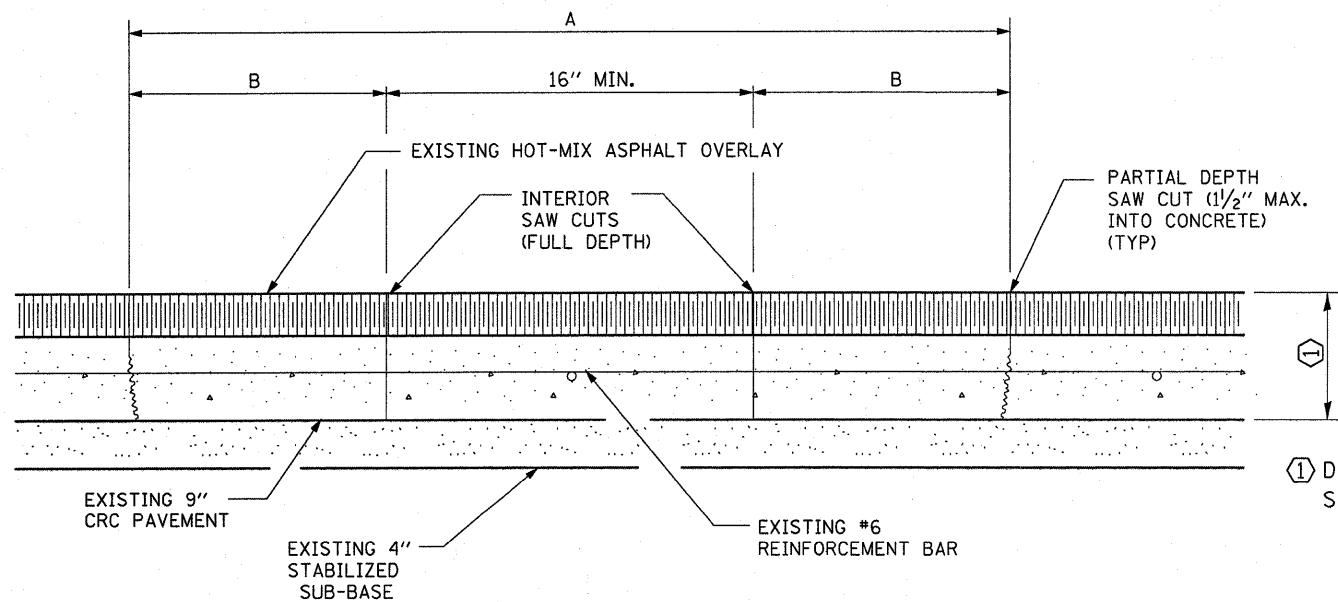

EXISTING PAVEMENT

SAW CUTTING DETAIL

① DEPTH VARIES
SEE TYPICAL SECTIONS

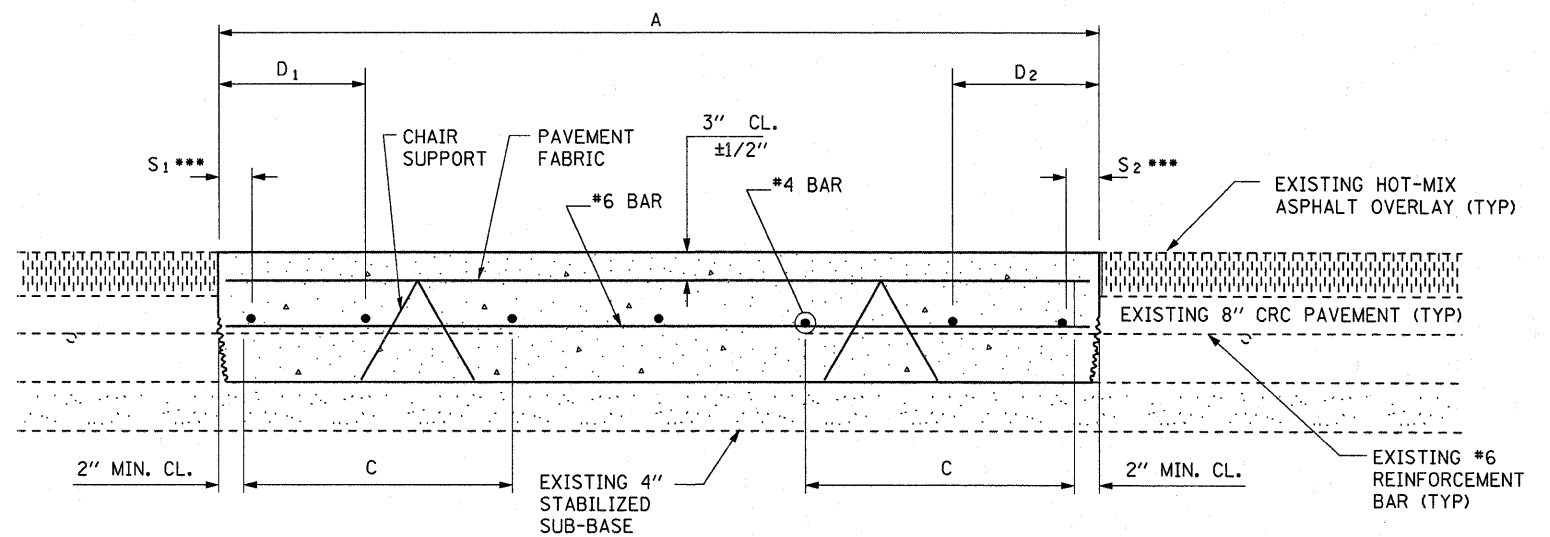

PROPOSED CLASS A PATCHING DETAIL

NOTES:

- * EVERY 3rd INTERSECTION MUST BE TIED
- ** LAP NEW REINFORCEMENT WITH EXISTING LONGITUDINAL REINFORCEMENT
- *** VARIABLES: WHERE S_1 AND S_2 ARE $2\frac{1}{2}$ " MIN. AND 12" MAX. $D_1 = 2(S_1)$ AND $D_2 = 2(S_2)$

FILE NAME =	USER NAME = braboygc	DESIGNED - RON WOODSHANK	REVISED -	STATE OF ILLINOIS DEPARTMENT OF TRANSPORTATION	CLASS A PATCHING DETAILS WITH HMA OVERLAY	F.A.I. RTE.	SECTION	COUNTY	TOTAL SHEETS	SHEET NO.
c:\pwork\pwork\dot\braboygc\d0264585\036839-shd-details.dgn	DRAWN - RON WOODSHANK	REVISED -	55			D3 PATCHING 2012-4	LIVINGSTON	11	10	
PLDT SCALE = 50,0000' / IN.	CHECKED -	REVISED -	CONTRACT NO. 66B39							
PLDT DATE = Apr 02, 2011 - 06:45:24 PM	DATE -	REVISED -	ILLINOIS							
				SCALE: _____ SHEET NO. 1 OF 1 SHEETS STA. _____ TO STA. _____						