







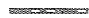

**LEGEND**

-  WORK AREA
-  TYPE III BARRICADE WITH FLASHING LIGHTS
-  TEMPORARY CONCRETE BARRIER
-  DRUM WITH STEADY BURN MONODIRECTIONAL LIGHT
-  DIRECTION INDICATOR BARRICADE WITH STEADY BURN MONODIRECTIONAL LIGHT
-  TYPE II BARRICADE WITH STEADY BURN MONODIRECTIONAL LIGHT
-  SIGN
-  VERTICAL PANEL (BACK TO BACK)
-  ARROW BOARD

SHADE-LOHMANN BRIDGE

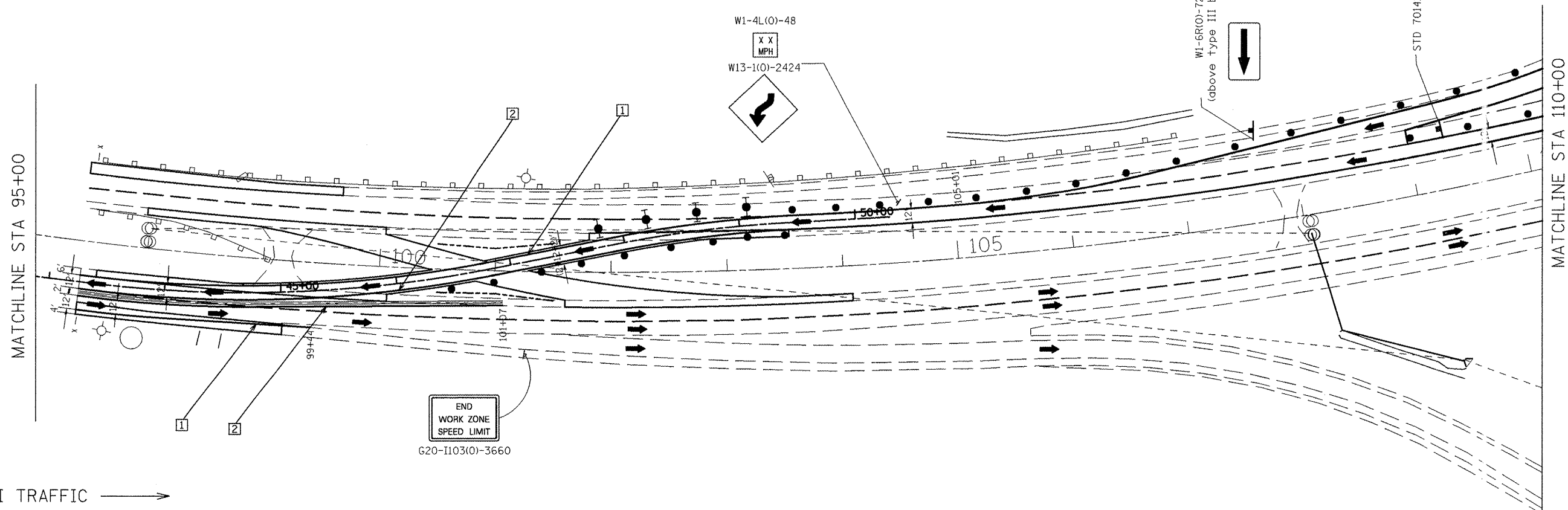

← CONTINUE STAGE I TRAFFIC →

**TEMPORARY PAVEMENT MARKING LEGEND**

- 1 PAVEMENT MARKING TAPE, TYPE III - LINE 4" (SOLID WHITE)
- 2 PAVEMENT MARKING TAPE, TYPE III - LINE 4" (SOLID YELLOW)

FILE NAME = Stage I sheets East & West.dgn	USER NAME = lababidism	DESIGNED -	REVISED -
		DRAWN -	REVISED -
	PLOT SCALE = 100.0000' / IN.	CHECKED -	REVISED -
	PLOT DATE = 2/9/2011	DATE -	REVISED -

**STATE OF ILLINOIS  
DEPARTMENT OF TRANSPORTATION**

<b>MAINTENANCE OF TRAFFIC PLAN STAGE I</b>			
SCALE:	SHEET NO. OF SHEETS	STA. TO STA.	

F.A.I. RTE. 474	SECTION (72, 9015B)I-2	COUNTY PEO-TAZ	TOTAL SHEETS 129	SHEET NO. 26
CONTRACT NO. 68069				ILLINOIS FED. AID PROJ. 7