

BILL OF MATERIAL

Item	Unit	Quantity
Hot-Mix Asphalt Wearing Surface Removal, Deck	Sq. Yc.	894
Bridge Deck Scarification, 3/4"	Sq. Yc.	894
Bridge Deck Latex Concrete Overlay, 2 1/4"	Sq. Yc.	874
Plug Existing Deck Drains	Each	36
Floor Drains	Each	34
Structural Steel Repair	Pound	1,150
Bolt Replacement	Each	20
*Deck Slab Repair (Full Depth Type I)	Sq. Yc.	9.1

* At Floor Drain Replacement Locations

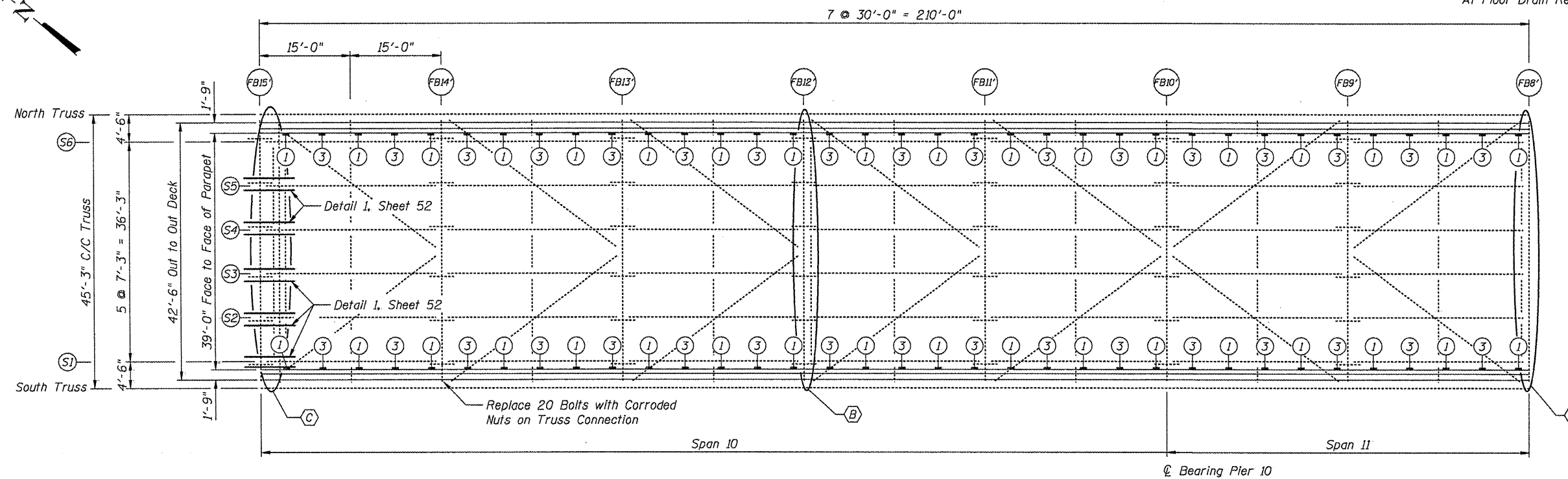
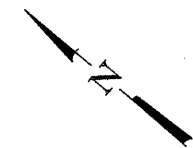

PARTIAL FRAMING PLAN SPANS 10 & 11

Eastbound Lanes

LEGEND

- ① Plug Existing Floor Drains
- ③ Remove Existing Floor Drain and Install new 6" Drain
- ⓑ Replace Existing Relief Joints with Preformed Joint Strip Seal.
- ⓒ Replace Existing Finger Joints with Preformed Joint Strip Seal.

FILE NAME =	USER NAME = *USER*	DESIGNED - JAN	REVISED -	STATE OF ILLINOIS DEPARTMENT OF TRANSPORTATION	GENERAL PLAN & REPAIR LOCATION: EASTBOUND SPANS 10 & 11 FB15' TO FB8' S.N. 090-0108	F.A.I. RTE.	SECTION	COUNT	TOTAL SHEETS	SHEET NO.	
FILEL#		CHECKED - BTO	REVISED -			474		PEORIA & TAYLOR	129	56	
	PLOT SCALE = *SCALE*	DRAWN - MJK	REVISED -			CONTRACT NO. 68069					
	PLOT DATE = *DATE*	CHECKED - JAN	REVISED -			ILLINOIS FED. AID PROJ. CT					