

DATE	
BY	
SUBMITTED	
PLOTTED	
GRADES CHECKED	
STRUCTURE NOTATION CHECKED	
NOTE BOOK NO.	
CADD FILE NAME	

DATE	
BY	
SUBMITTED	
PLOTTED	
GRADES CHECKED	
STRUCTURE NOTATION CHECKED	
NOTE BOOK NO.	
CADD FILE NAME	

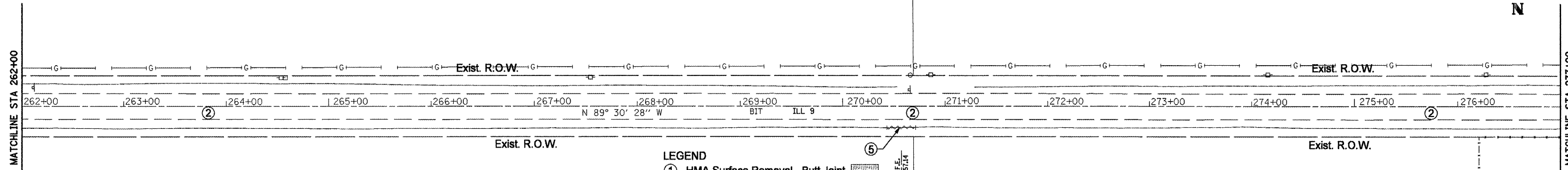

- LEGEND**
- ① HMA Surface Removal - Butt Joint
  - ② HMA Surface Removal 1½"
  - ③ Guardrail Removal
  - ④ Concrete Headwall Removal
  - ⑤ Pipe Culvert Removal
  - ⑥ Gutter Removal (Special)
  - ⑦ Removal of Existing Structure
  - ⑧ Concrete Removal
  - ⑨ Tree Removal (Acre)
  - ⑩ Class D Patch, 14"
  - ⑪ Women Wire Fence Removal x-x-x
  - ⑫ Pavement Removal

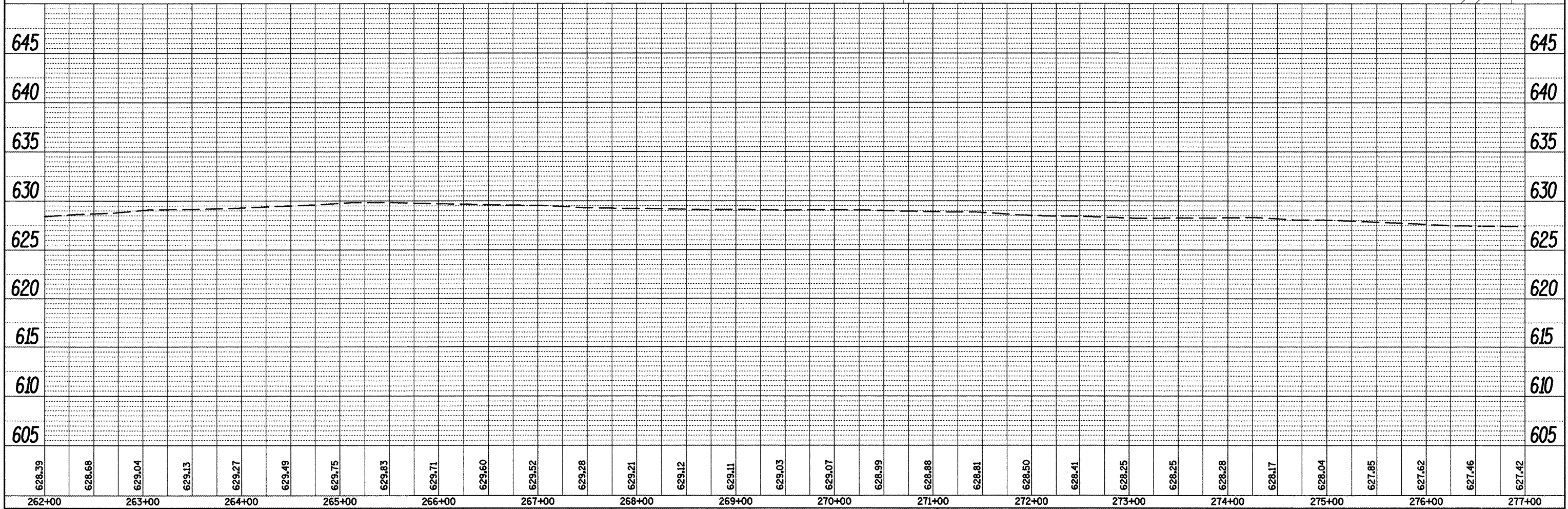
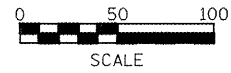

FILE NAME = Removal Plans2.dgn	USER NAME = mandezp.j	DESIGNED -	REVISED -	<b>STATE OF ILLINOIS DEPARTMENT OF TRANSPORTATION</b>	<b>EXISTING &amp; REMOVAL PLANS</b>		F.A.P. RTE. 685	SECTION **	COUNTY *	TOTAL SHEETS 329	SHEET NO. 42	
	PLOT SCALE = 100.0000' / IN.	CHECKED -	REVISED -		SCALE:	SHEET NO. OF SHEETS	STA. TO STA.	CONTRACT NO. 68599				
	PLOT DATE = 3/25/2011	DATE -	REVISED -		ILLINOIS FED. AID PROJECT							
** (37,38)RS-3,39RS-5(38)1 * Fulton, McDonough												