

MEDIAN INLET BOX REMOVAL - 1 EACH
STA 1606+98.29

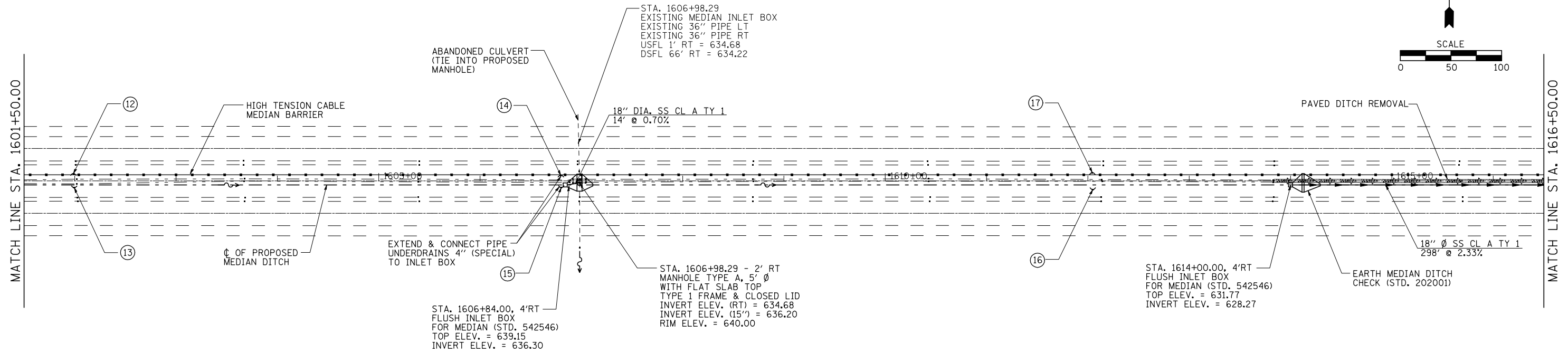

PLAN	SURVEYED	DATE
	PLOTTED	
	CHECKED	
	BY	
	NO.	

PROFILE	SURVEYED	DATE
	PLOTTED	
	CHECKED	
	BY	
	NO.	

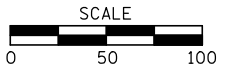
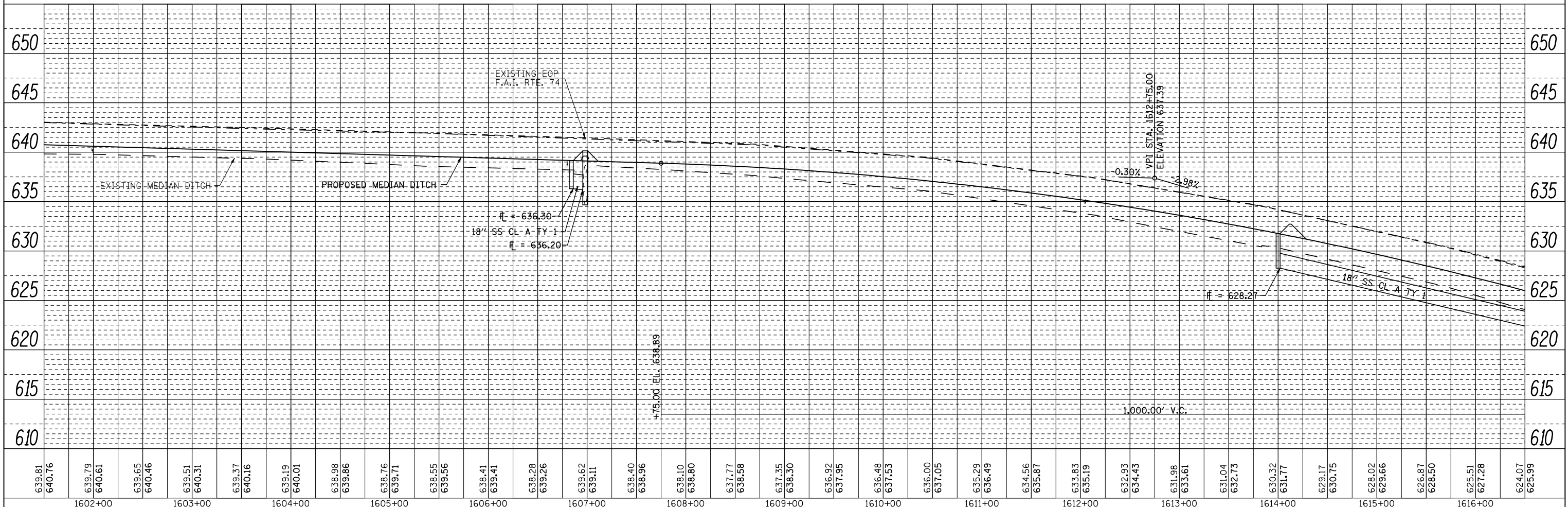

FILE NAME =	USER NAME = #USER#	DESIGNED -	REVISED -	STATE OF ILLINOIS DEPARTMENT OF TRANSPORTATION	PLAN & PROFILE F.A.I. 74	F.A.I. RTE. 74	SECTION HSIP FY2011-4	COUNTY VERMILION	TOTAL SHEETS 88	SHEET NO. 12		
FILEL		DRAWN -	REVISED -			SCALE:	SHEET NO. 3 OF 13 SHEETS	STA. 1601+50.00 TO STA. 1616+50.00	CONTRACT NO. 70910			
		CHECKED -	REVISED -			ILLINOIS FED. AID PROJECT						
		DATE -	REVISED -									