

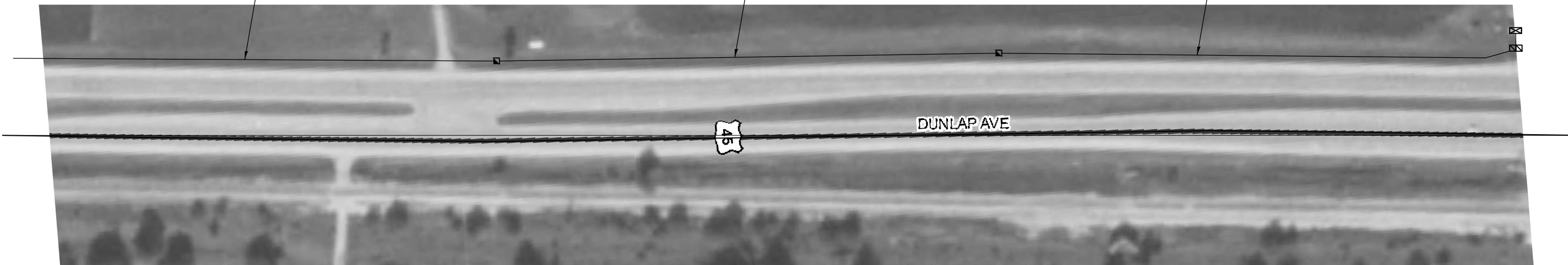

613' PVC - 2" - T
 1 FO 62.5/125 12SM 12MM
 1 NO. 12 1C, XLP

613' PVC - 2" - T
 1 FO 62.5/125 12SM 12MM
 1 NO. 12 1C, XLP

613' PVC - 2" - T
 1 FO 62.5/125 12SM 12MM
 1 NO. 12 1C, XLP
 DRILL EXIST. HH- 1 EA.



2 @ 2' EXIST. PVC - 4"
 ADD: 2 FO 62.5/125 12SM 12MM
 1 NO. 12 1C, XLP

EXIST. TYPE 4 CABINET *
 TRANSCEIVER - FO - 1 EACH

510' PVC - 2" - T
 1 FO 62.5/125 12SM 12MM
 1 NO. 12 1C, XLP
 DRILL EXIST. HH- 1 EA.

510' PVC - 2" - T
 1 FO 62.5/125 12SM 12MM
 1 NO. 12 1C, XLP

480' PVC - 2" - T
 40' PVC - 2" - P
 1 FO 62.5/125 12SM 12MM
 1 NO. 12 1C, XLP

27' EXIST. PVC - 4"
 ADD: 1 FO 62.5/125 12SM 12MM
 1 NO. 12 1C, XLP

AIRPORT RD.

71' EXIST. PVC - 3"
 ADD: 1 FO 62.5/125 12SM 12MM
 1 NO. 12 1C, XLP

* PROVIDE 50' OF FIBER OPTIC CABLE SLACK
 IN BOTTOM OF EXIST. CABINET FOR FUTURE
 CABINET RELOCATION.

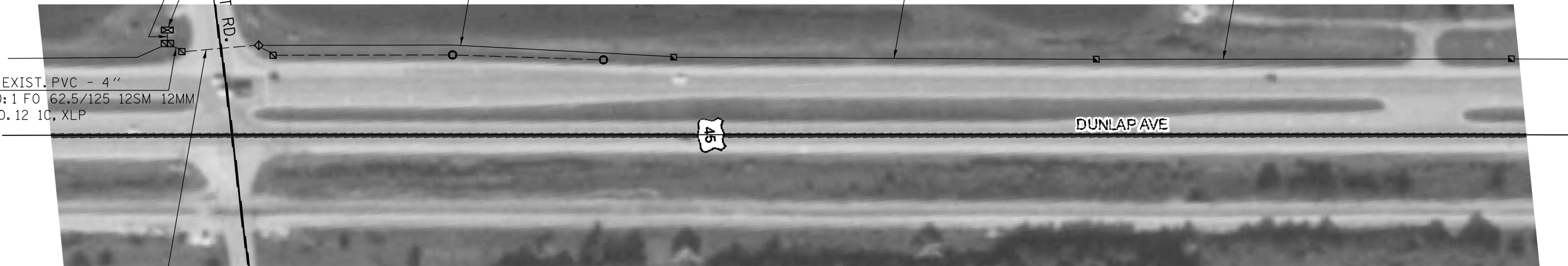

FILE NAME =	USER NAME = biggsrd	DESIGNED -	REVISED -
ei:\pw\work\p1dot\biggsrd\d0261371\0570011-sht-US45_P1en.dgn		DRAWN -	REVISED -
	PLOT SCALE = 40.0000' / in.	CHECKED -	REVISED -
	PLOT DATE = 4/12/2011	DATE -	REVISED -

**STATE OF ILLINOIS
 DEPARTMENT OF TRANSPORTATION**

US 45 (NEIL ST.)

SCALE: SHEET NO. OF SHEETS STA. TO STA.

F.A. RTE.	SECTION	COUNTY	TOTAL SHEETS	SHEET NO.
VAR.	FY2011 INTERCONNECT	Champaign	34	25
			CONTRACT NO.	70911
ILLINOIS FED. AID PROJECT				