

DATE	
BY	
SURVEYED	CHECKED
ALIGNED	CHECKED
RT. OF WAY	CHECKED
NOTE BOOK	
NO.	
PLAN	
NO.	

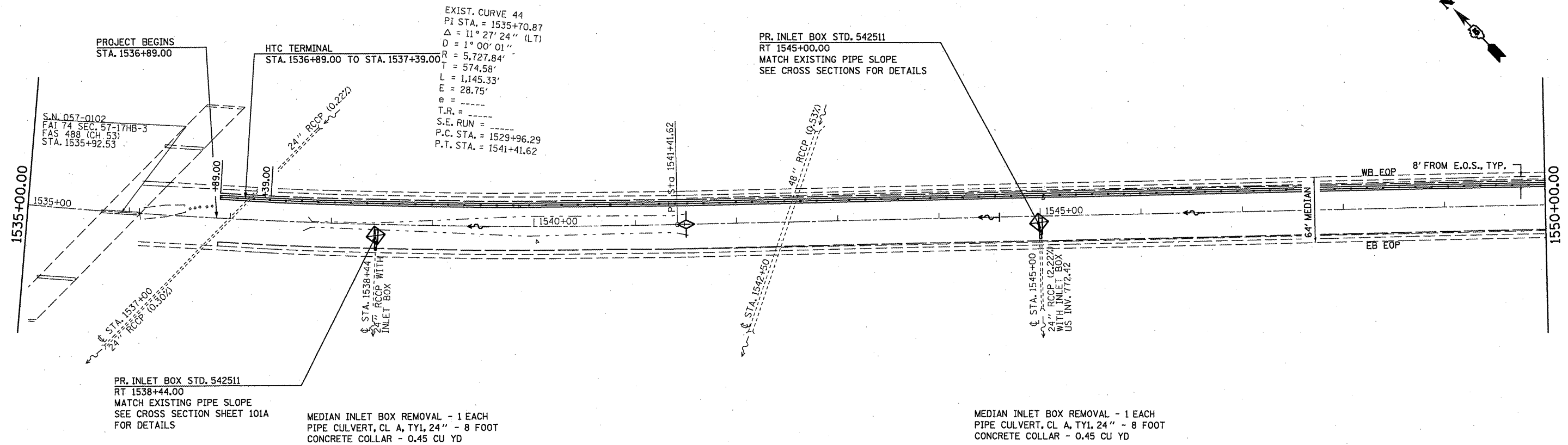

EXIST. CURVE 44
 PI STA. = 1535+70.87
 $\Delta = 11^\circ 27' 24''$ (LT)
 $D = 1^\circ 00' 01''$
 $R = 5,727.84'$
 $T = 574.58'$
 $L = 1,145.33'$
 $E = 28.75'$
 $e =$
 $T.R. =$
 $S.E. RUN =$
 $P.C. STA. = 1529+96.29$
 $P.T. STA. = 1541+41.62$

PR. INLET BOX STD. 542511
 RT 1545+00.00
 MATCH EXISTING PIPE SLOPE
 SEE CROSS SECTIONS FOR DETAILS

PR. INLET BOX STD. 542511
 RT 1538+44.00
 MATCH EXISTING PIPE SLOPE
 SEE CROSS SECTION SHEET 101A
 FOR DETAILS

MEDIAN INLET BOX REMOVAL - 1 EACH
 PIPE CULVERT, CL A, TY1, 24" - 8 FOOT
 CONCRETE COLLAR - 0.45 CU YD

MEDIAN INLET BOX REMOVAL - 1 EACH
 PIPE CULVERT, CL A, TY1, 24" - 8 FOOT
 CONCRETE COLLAR - 0.45 CU YD

LEGEND

800
795
790
785
780
775
770
765
760

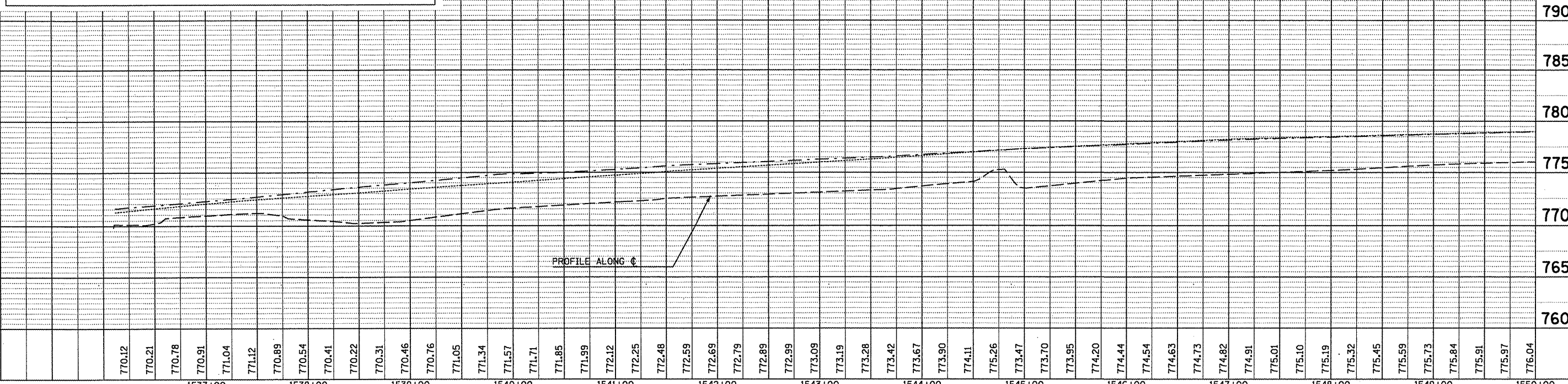
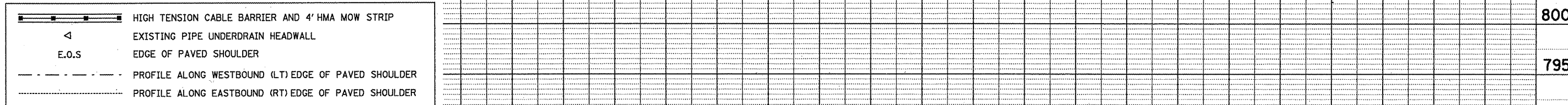

DATE	
BY	
SURVEYED	CHECKED
PLotted	CHECKED
BLANK	NOTED
STRUCTURE	NOTATION CHRG
PROF. FILE	
NO.	

FILE NAME =	USER NAME = keysrb	DESIGNED -	REVISED -	<p>STATE OF ILLINOIS DEPARTMENT OF TRANSPORTATION</p> <p>REVISION SHEET 6-6-11</p> <p>SCALE: SHEET NO. OF SHEETS STA. TO STA.</p>	F.A.T. RTE.	SECTION	COUNTY	TOTAL SHEETS	SHEET NO.
8:\pwork\pwork\keysrb\0261049\0570927	ahp\p\prf_50.dgn	DRAWN -	REVISED -		74	FY11 HSIP-5	MCLEAN	101	8
PLOT SCALE = 1/8" = 1' / in.		CHECKED -	REVISED -		CONTRACT NO. 70927				
PLOT DATE = 5/5/2011		DATE -	REVISED -		ILLINOIS FED. AID PROJECT				