

PLAN	SURVEYED	BY	DATE
	PLOTTED		
	CHECKED		
	AT		
	FILE NAME		
	NO.		

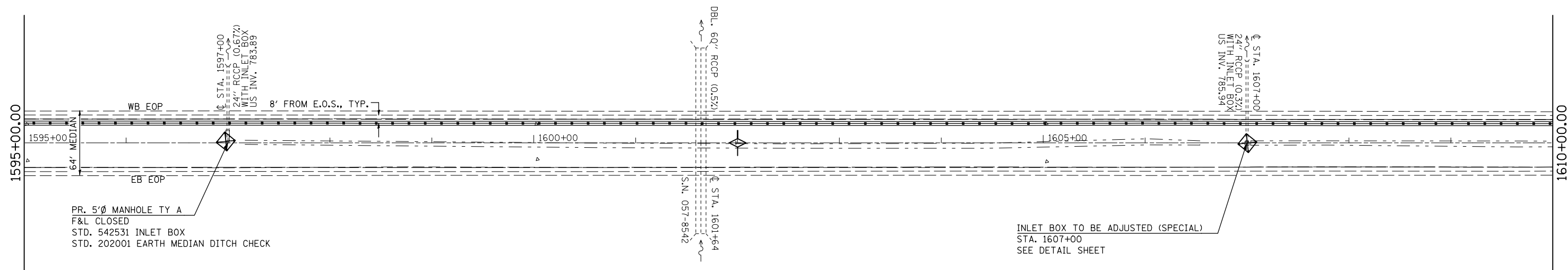

PR. 5'Ø MANHOLE TY A
F&L CLOSED
STD. 542531 INLET BOX
STD. 202001 EARTH MEDIAN DITCH CHECK

INLET BOX TO BE ADJUSTED (SPECIAL)
STA. 1607+00
SEE DETAIL SHEET

MEDIAN INLET BOX REMOVAL - 1 EACH
PIPE CULVERT, CL A, TY1, 24" - 12 FOOT
CONCRETE COLLAR - 0.45 CU YD

PROFILE	SURVEYED	BY	DATE
	PLOTTED		
	CHECKED		
	AT		
	FILE NAME		
	NO.		

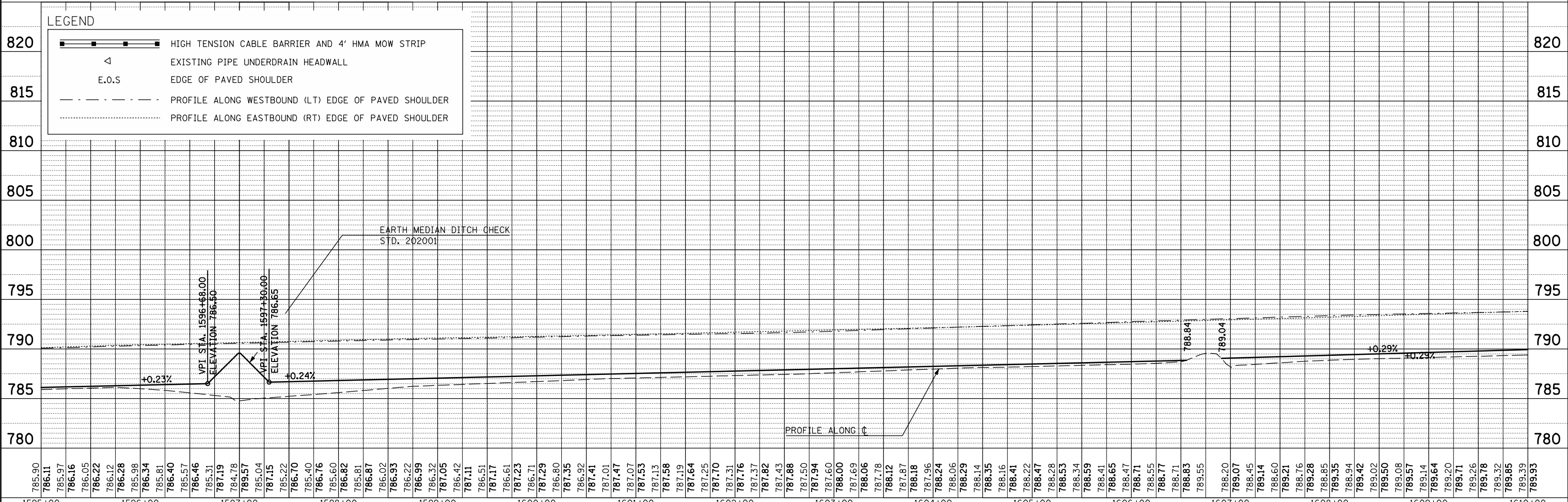

FILE NAME =	USER NAME = keyarb	DESIGNED -	REVISED -
ct:\pw\work\p\w\dot\keys\b\d0261049\0570927	shh-plnpr-f_50.dgn	DRAWN -	REVISED -
	PLOT SCALE = 100.0000' / IN.	CHECKED -	REVISED -
	PLOT DATE = 3/25/2011	DATE -	REVISED -

**STATE OF ILLINOIS
DEPARTMENT OF TRANSPORTATION**

PLAN AND PROFILE

SCALE: SHEET NO. OF SHEETS STA. TO STA.

F.A.I. RTE.	SECTION	COUNTY	TOTAL SHEETS	SHEET NO.
74	FY11 HSIP-5	MCLEAN	101	12
CONTRACT NO. 70927				
ILLINOIS FED. AID PROJECT				