

F.A.P. RTE.	SECTION	COUNTY	TOTAL SHEETS	SHEET NO.
310	69-3(3HB)	MORGAN	793	1

CONTRACT NO. 72667

793 + 5 = 798

D-96-538-02

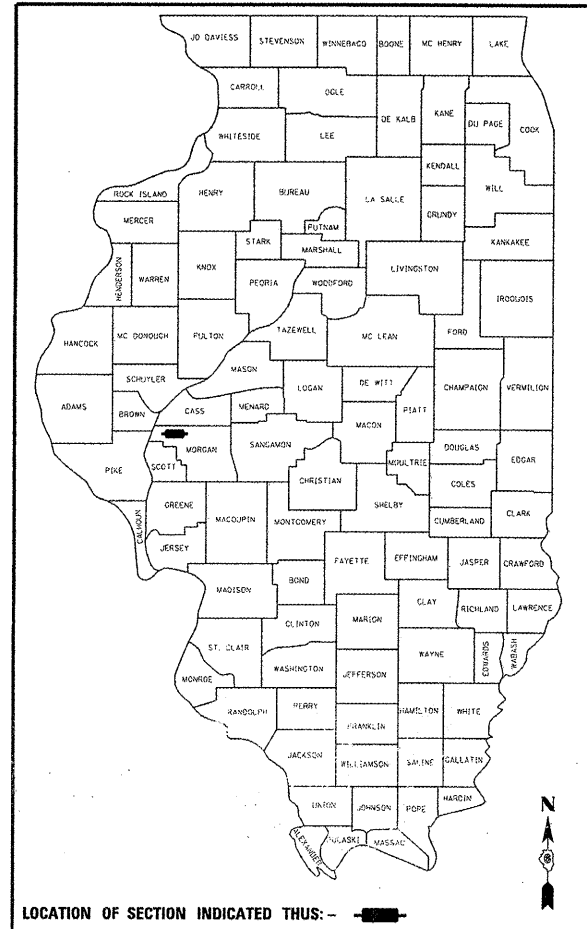

LOCATION OF SECTION INDICATED THIS: —

STATE OF ILLINOIS
DEPARTMENT OF TRANSPORTATION
DIVISION OF HIGHWAYS

**PROPOSED
HIGHWAY PLANS**

FAP ROUTE 310 (US 67 /IL 104)
SECTION 69-3(3HB)
PROJECT NHF-HPP-0310(145)
PAVING AND STRUCTURE PLANS
MORGAN COUNTY
C-96-037-08

FOR INDEX OF SHEETS, SEE SHEET NO. 2
FOR LIST OF STANDARDS, SEE SHEET NO. 2

DESIGN DESIGNATION:
FAP 310
ARTERIAL
ADT=15,200 (2020)
% SU=3
% MU=13

END IMPROVEMENT
STA 1145+73.37, 94.45' RT FAP 310

END SECTION 69-3
STA 1133+50.00 (WBL)
STA 1140+00.00 (EBL)

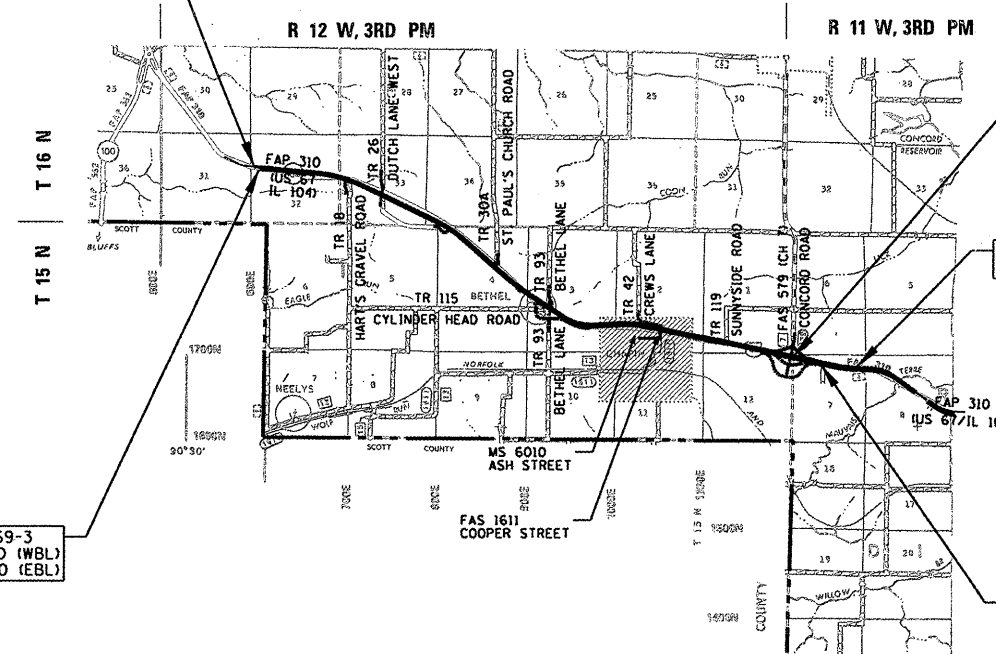

PROPOSED STRUCTURE CARRYING
CONCORD ROAD OVER FAP 310
STA 807+81.68
S.N. 069-0513
2 SPAN, P.P.C.I. BEAM (COMPOSITE)
INTEGRAL ABUTMENTS
202'-0" BK. TO BK. ABUTMENT

BEGIN IMPROVEMENT
STA 762+05.00 FAP 310

BEGIN SECTION 69-3
STA 800+00.00 (WBL)
STA 800+00.00 (EBL)

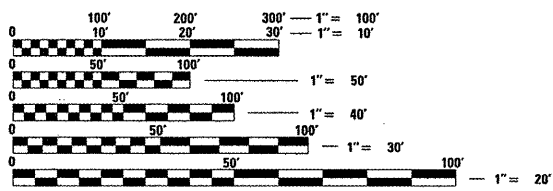

FULL SIZE PLANS HAVE BEEN PREPARED USING STANDARD
ENGINEERING SCALES. REDUCED SIZED PLANS WILL NOT
CONFORM TO STANDARD SCALES. IN MAKING MEASUREMENTS
ON REDUCED PLANS, THE ABOVE SCALES MAY BE USED.

J.U.L.I.E.
JOINT UTILITY LOCATION INFORMATION FOR EXCAVATION
1-800-892-0123

CONTRACT NO. 72667

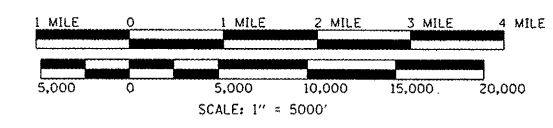

LOCATION MAP
LENGTH OF SECTION 69-3 = 34,000.00' = 6.439 MILES
LENGTH OF IMPROVEMENT = 38,368.37' = 7.267 MILES

STATE OF ILLINOIS
DEPARTMENT OF TRANSPORTATION
DIVISION OF HIGHWAYS
SUBMITTED *March 30 20 11*
Roger L. Orndall
DEPUTY DIRECTOR OF HIGHWAYS, REGION ENGINEER
May 13 20 11
Scott E. Stitt, P.E.
Acting ENGINEER OF DESIGN AND ENVIRONMENT
May 13 20 11
Charlotte M. Reed
DIRECTOR OF HIGHWAYS, CHIEF ENGINEER

PRINTED BY THE AUTHORITY
OF THE STATE OF ILLINOIS

3/24/2011

P:\07files\070100\WorkOrder\0_CAD\Drawings\Front Sheets\Cover.dgn

PROJECT ENGINEER: JOHN MCCANNICARO (217) 782-6990
SQUAD LEADER: VINCE MADONIA (217) 785-9046