

F.A.P. RTE.	SECTION	COUNTY	TOTAL SHEETS	SHEET NO.
310	69-3(3HB)	MORGAN	793	99
STA.		TO STA.		
FED. ROAD DIST. NO.		ILLINOIS FED. AID PROJECT		

1:09:30 PM  
Mar-29-2011 01:09:30PM

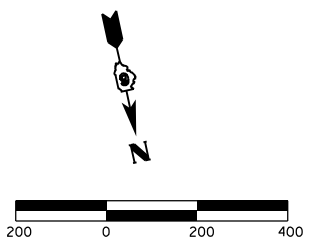

**LEGEND**

- STAGE I CONSTRUCTION
- TYPE III BARRICADES WITH R11-2 (4830) "ROAD CLOSED"
- TYPE III BARRICADES WITH R11-4 (4830) "ROAD CLOSED TO THRU TRAFFIC"
- VP-1L (1236) "VERTICAL PANELS"
- DIRECTION OF TRAFFIC

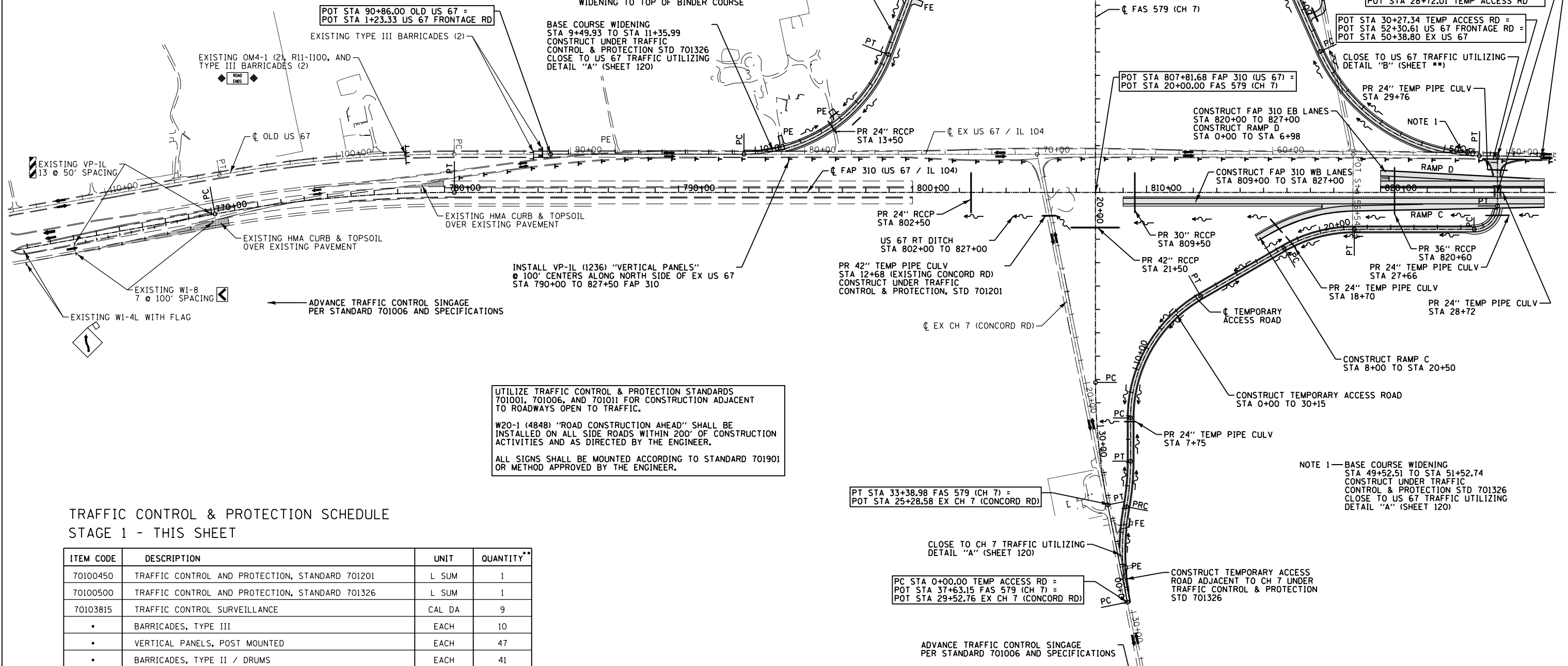

UTILIZE TRAFFIC CONTROL & PROTECTION STANDARDS 701001, 701006, AND 701011 FOR CONSTRUCTION ADJACENT TO ROADWAYS OPEN TO TRAFFIC.

W20-1 (4848) "ROAD CONSTRUCTION AHEAD" SHALL BE INSTALLED ON ALL SIDE ROADS WITHIN 200' OF CONSTRUCTION ACTIVITIES AND AS DIRECTED BY THE ENGINEER.

ALL SIGNS SHALL BE MOUNTED ACCORDING TO STANDARD 701901 OR METHOD APPROVED BY THE ENGINEER.

**TRAFFIC CONTROL & PROTECTION SCHEDULE  
STAGE 1 - THIS SHEET**

ITEM CODE	DESCRIPTION	UNIT	QUANTITY**
70100450	TRAFFIC CONTROL AND PROTECTION, STANDARD 701201	L SUM	1
70100500	TRAFFIC CONTROL AND PROTECTION, STANDARD 701326	L SUM	1
70103815	TRAFFIC CONTROL SURVEILLANCE	CAL DA	9
	• BARRICADES, TYPE III	EACH	10
	• VERTICAL PANELS, POST MOUNTED	EACH	47
	• BARRICADES, TYPE II / DRUMS	EACH	41

- ITEM WILL NOT BE MEASURED AND PAID FOR SEPARATELY. THE COST WILL BE INCLUDED IN THE CONTRACT UNIT BID PRICES OF THE TRAFFIC CONTROL PAY ITEMS IN THE CONTRACT.
- \*\* - QUANTITY MAY BE ADJUSTED ACCORDING TO SITE CONDITIONS AND AS DIRECTED BY THE ENGINEER.

SEE SHEET 125 FOR STAGE CONSTRUCTION PAVEMENT MARKING SCHEDULE

REVISIONS	
NAME	DATE

ILLINOIS DEPARTMENT OF TRANSPORTATION

**TRAFFIC CONTROL & STAGING  
STAGE I - 761+00 TO 827+50  
FAP 310 (US 67/IL 104)  
SHEET 1 OF 27**

DATE 7/09

DRAWN BY SEB  
CHECKED BY