

F.A.P. RTE.	SECTION	COUNTY	TOTAL SHEETS	SHEET NO.
310	69-3(3HB)	MORGAN	793	101
STA. TO STA.		ILLINOIS FED. AID PROJECT		
FED. ROAD DIST. NO.				

1:09:43 PM
Mar-29-2011 01:09:43 PM

LEGEND

- STAGE 2 CONSTRUCTION
- STAGE 2 PAVEMENT REMOVAL
- TYPE III BARRICADES WITH R11-2 (4830) "ROAD CLOSED"
- TYPE III BARRICADES WITH R11-4 (4830) "ROAD CLOSED TO THRU TRAFFIC"
- EXISTING VP-IL (1236) "VERTICAL PANELS"
- PROPOSED VP-IL (1236) "VERTICAL PANELS"
- DIRECTION OF TRAFFIC

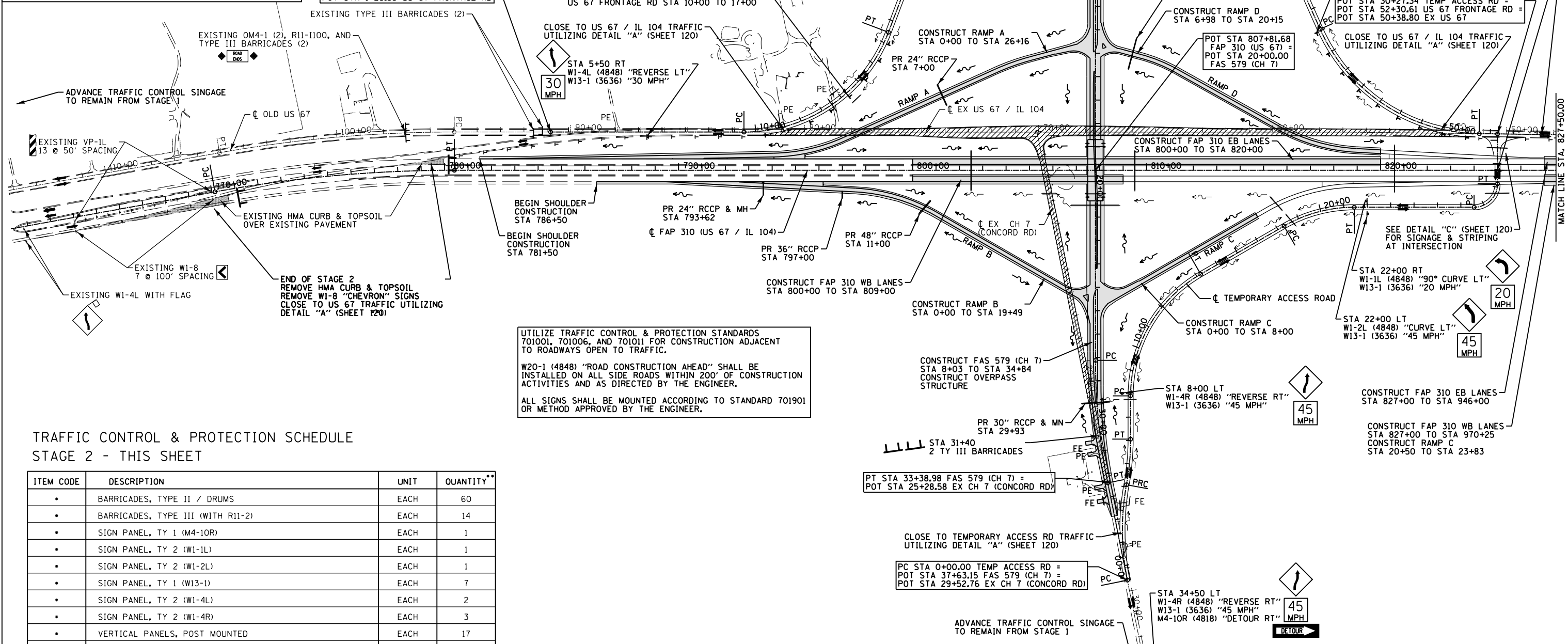
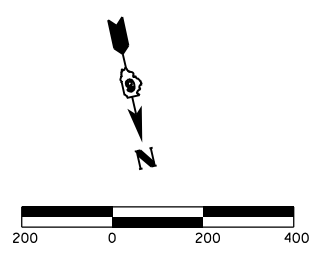

UTILIZE TRAFFIC CONTROL & PROTECTION STANDARDS 701001, 701006, AND 701011 FOR CONSTRUCTION ADJACENT TO ROADWAYS OPEN TO TRAFFIC.

W20-1 (4848) "ROAD CONSTRUCTION AHEAD" SHALL BE INSTALLED ON ALL SIDE ROADS WITHIN 200' OF CONSTRUCTION ACTIVITIES AND AS DIRECTED BY THE ENGINEER.

ALL SIGNS SHALL BE MOUNTED ACCORDING TO STANDARD 701901 OR METHOD APPROVED BY THE ENGINEER.

TRAFFIC CONTROL & PROTECTION SCHEDULE STAGE 2 - THIS SHEET

ITEM CODE	DESCRIPTION	UNIT	QUANTITY**
•	BARRICADES, TYPE II / DRUMS	EACH	60
•	BARRICADES, TYPE III (WITH R11-2)	EACH	14
•	SIGN PANEL, TY 1 (M4-10R)	EACH	1
•	SIGN PANEL, TY 2 (W1-1L)	EACH	1
•	SIGN PANEL, TY 2 (W1-2L)	EACH	1
•	SIGN PANEL, TY 1 (W13-1)	EACH	7
•	SIGN PANEL, TY 2 (W1-4L)	EACH	2
•	SIGN PANEL, TY 2 (W1-4R)	EACH	3
•	VERTICAL PANELS, POST MOUNTED	EACH	17
•	WOOD POSTS, 4 x 4	EACH	8

- ITEM WILL NOT BE MEASURED AND PAID FOR SEPARATELY. THE COST WILL BE INCLUDED IN THE CONTRACT UNIT BID PRICES OF THE TRAFFIC CONTROL PAY ITEMS IN THE CONTRACT.
- ** - QUANTITY MAY BE ADJUSTED ACCORDING TO SITE CONDITIONS AND AS DIRECTED BY THE ENGINEER.

SEE SHEET 125 FOR STAGE CONSTRUCTION PAVEMENT MARKING SCHEDULE

REVISIONS	
NAME	DATE

ILLINOIS DEPARTMENT OF TRANSPORTATION

TRAFFIC CONTROL & STAGING
STAGE 2 - 761+00 TO 827+50
FAP 310 (US 67/IL 104)
SHEET 3 OF 27

DATE 7/09

DRAWN BY SEB
CHECKED BY