

F.A.P. RTE.	SECTION	COUNTY	TOTAL SHEETS	SHEET NO.
310	69-3(3HB)	MORGAN	793	109
STA.		TO STA.		
FED. ROAD DIST. NO.		ILLINOIS	FED. AID PROJECT	

THE CONTRACTOR SHALL CLOSE TR 93 A MINIMUM OF 30 CALENDAR DAYS TO THROUGH TRAFFIC. TR 93 MAY BE OPENED TO THROUGH TRAFFIC ONCE A MINIMUM OF 6 INCHES OF HMA BASE COURSE HAS BEEN PLACED.

LEGEND

- STAGE 3 CONSTRUCTION
- STAGE 3 PAVEMENT REMOVAL
- AGGREGATE FOR TEMPORARY ACCESS
- TYPE III BARRICADES WITH R11-2 (4830) "ROAD CLOSED"
- TYPE III BARRICADES WITH R11-4 (4830) "ROAD CLOSED TO THRU TRAFFIC"
- PROPOSED VP-1L (1236) "VERTICAL PANELS"
- DIRECTION OF TRAFFIC

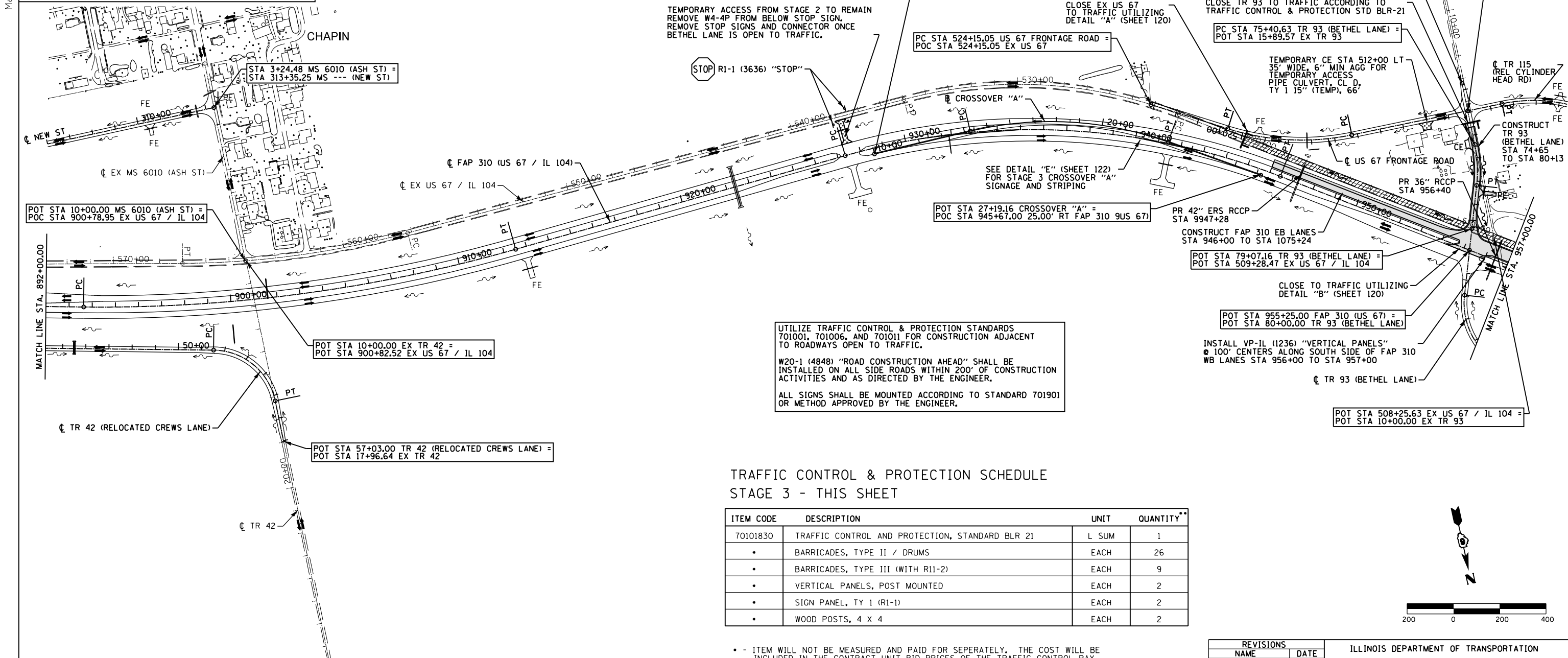

**TRAFFIC CONTROL & PROTECTION SCHEDULE
STAGE 3 - THIS SHEET**

ITEM CODE	DESCRIPTION	UNIT	QUANTITY**
70101830	TRAFFIC CONTROL AND PROTECTION, STANDARD BLR 21	L SUM	1
•	BARRICADES, TYPE II / DRUMS	EACH	26
•	BARRICADES, TYPE III (WITH R11-2)	EACH	9
•	VERTICAL PANELS, POST MOUNTED	EACH	2
•	SIGN PANEL, TY 1 (R1-1)	EACH	2
•	WOOD POSTS, 4 X 4	EACH	2

- - ITEM WILL NOT BE MEASURED AND PAID FOR SEPERATELY. THE COST WILL BE INCLUDED IN THE CONTRACT UNIT BID PRICES OF THE TRAFFIC CONTROL PAY ITEMS IN THE CONTRACT.
- ** - QUANTITY MAY BE ADJUSTED ACCORDING TO SITE CONDITIONS AND AS DIRECTED BY THE ENGINEER.

SEE SHEET 125 FOR STAGE CONSTRUCTION PAVEMENT MARKING SCHEDULE

REVISIONS

NAME	DATE

ILLINOIS DEPARTMENT OF TRANSPORTATION
**TRAFFIC CONTROL & STAGING
 STAGE 3 - 892+00 TO 957+00
 FAP 310 (US 67/IL 104)
 SHEET 11 OF 27**

DATE 8/09
 DRAWN BY SEB
 CHECKED BY

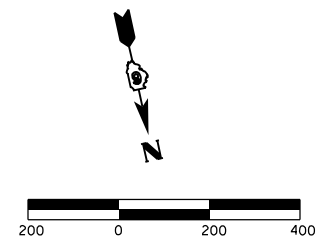

1:10:34 PM
 Mar-29-2011 01:10:34PM
 \$FILE\$