

F.A.P. RTE.	SECTION	COUNTY	TOTAL SHEETS	SHEET NO.
310	69-3(3HB)	MORGAN	793	183
STA.		TO STA.		
FED. ROAD DIST. NO.		ILLINOIS FED. AID PROJECT		

SEC 7, T 15 N, R 11 W, 3rd PM

ROBERTA A. WERRIES  
PARCEL NO. 6084106

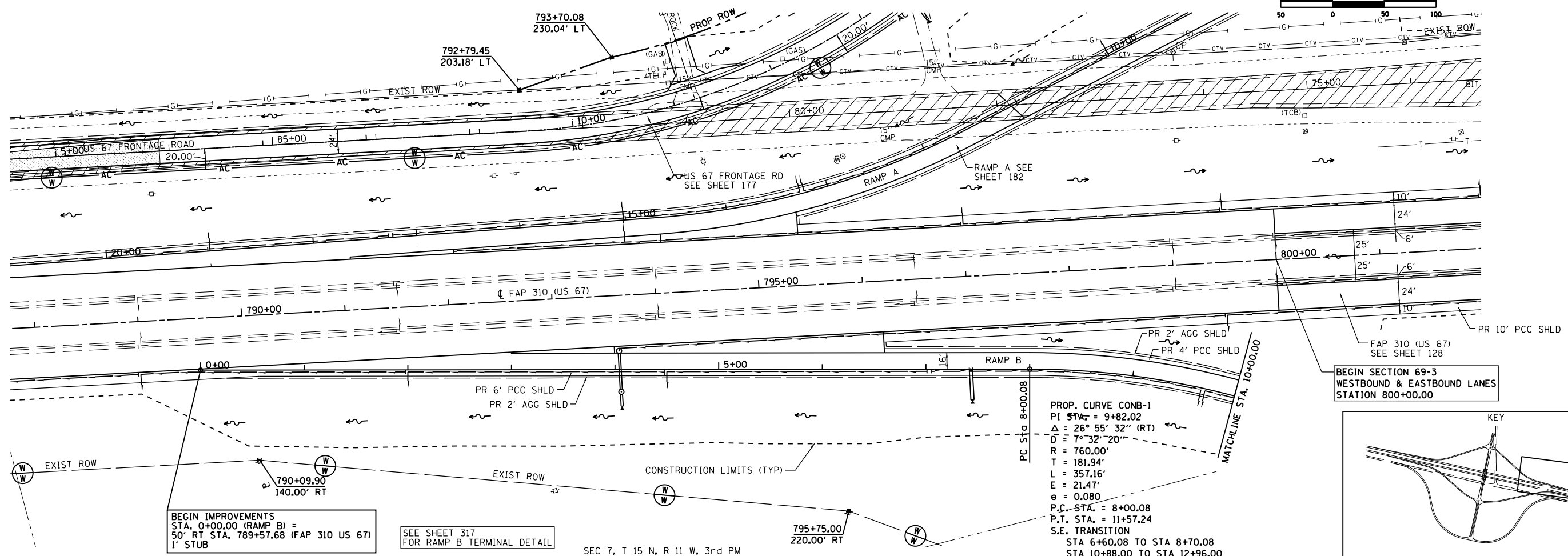

BEGIN SECTION 69-3  
WESTBOUND & EASTBOUND LANES  
STATION 800+00.00

BEGIN IMPROVEMENTS  
STA. 0+00.00 (RAMP B) =  
50' RT STA. 789+57.68 (FAP 310 US 67)  
1' STUB

SEE SHEET 317  
FOR RAMP B TERMINAL DETAIL

PROP. CURVE CONB-1  
PI STA. = 9+82.02  
 $\Delta = 26^\circ 55' 32''$  (RT)  
D = 7° 32' 20"  
R = 760.00'  
T = 181.94'  
L = 357.16'  
E = 21.47'  
e = 0.080  
P.C. STA. = 8+00.08  
P.T. STA. = 11+57.24  
S.E. TRANSITION  
STA 6+60.08 TO STA 8+70.08  
STA 10+88.00 TO STA 12+96.00

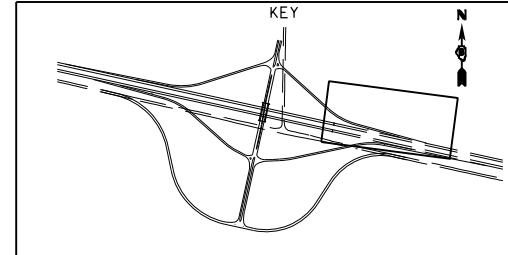

SEC 7, T 15 N, R 11 W, 3rd PM

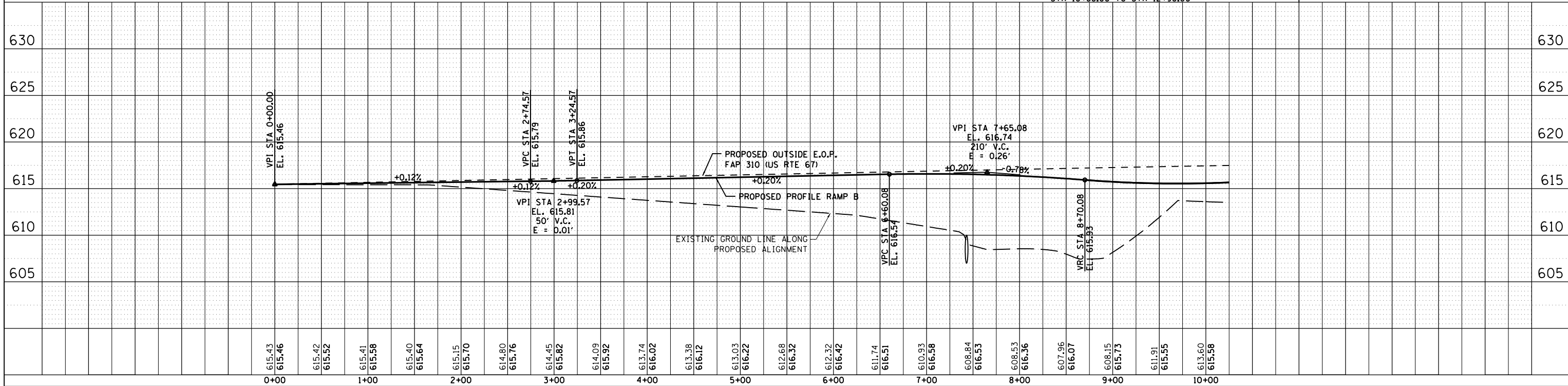

SECTION 69-3(3HB)

MORGAN COUNTY

PLAN	DATE
BY	
DATE	
BY	
DATE	
BY	
DATE	
BY	
DATE	

PROFILE	DATE
BY	
DATE	
BY	
DATE	
BY	
DATE	
BY	
DATE	

1:18:08 PM

1:18:08 PM

\$FILE\$