

F.A.P. RTE.	SECTION	COUNTY	TOTAL SHEETS	SHEET NO.
310	69-3(3HB)	MORGAN	793	184
STA.		TO STA.		
FED. ROAD DIST. NO.		ILLINOIS FED. AID PROJECT		

1:18:14 PM

PLAN	DATE
SURVEYED	
PLOTTED	
CHECKED	
BY	
NO. OF WAY CHECKED	
CADD FILE NAME	

PROFILE	DATE
SURVEYED	
PLOTTED	
CHECKED	
BY	
NOTATION CHKD	

\$FILE\$

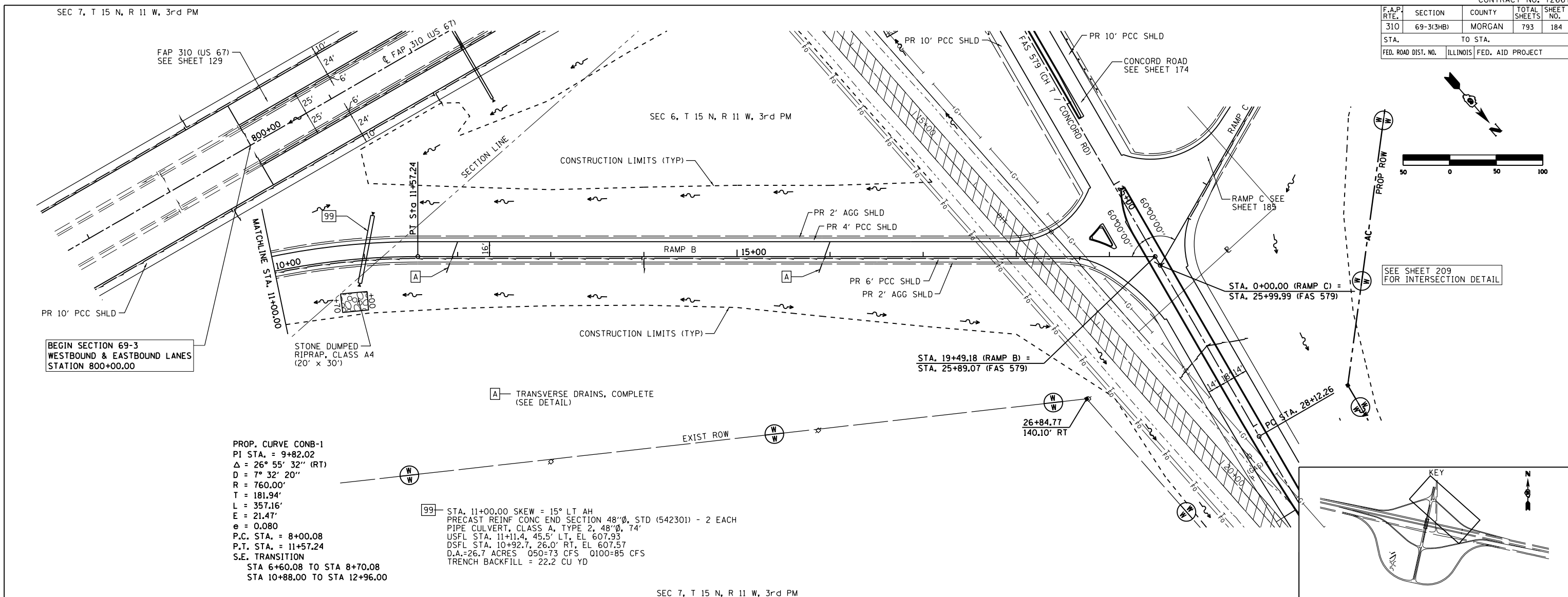

PROP. CURVE CONB-1
 PI STA. = 9+82.02
 $\Delta = 26^\circ 55' 32''$ (RT)
 $D = 7^\circ 32' 20''$
 $R = 760.00'$
 $T = 181.94'$
 $L = 357.16'$
 $E = 21.47'$
 $e = 0.080$
 P.C. STA. = 8+00.08
 P.T. STA. = 11+57.24
 S.E. TRANSITION
 STA 6+60.08 TO STA 8+70.08
 STA 10+88.00 TO STA 12+96.00

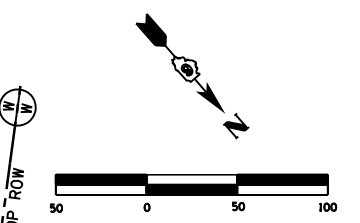

SEE SHEET 209 FOR INTERSECTION DETAIL

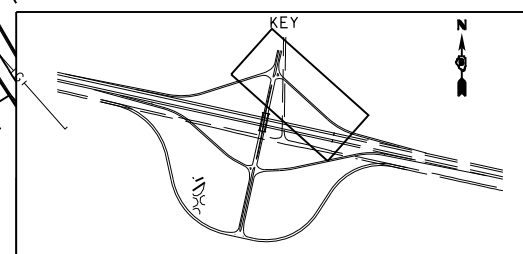

SEC 7, T 15 N, R 11 W, 3rd PM

