

F.A.P. RTE.	SECTION	COUNTY	TOTAL SHEETS	SHEET NO.
310	69-3(3HB)	MORGAN	793	210
STA.		TO STA.		
FED. ROAD DIST. NO.		ILLINOIS	FED. AID PROJECT	

8:45:32 AM
Mar-30-2011 08:45:32AM

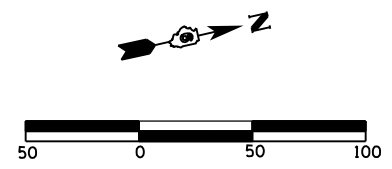
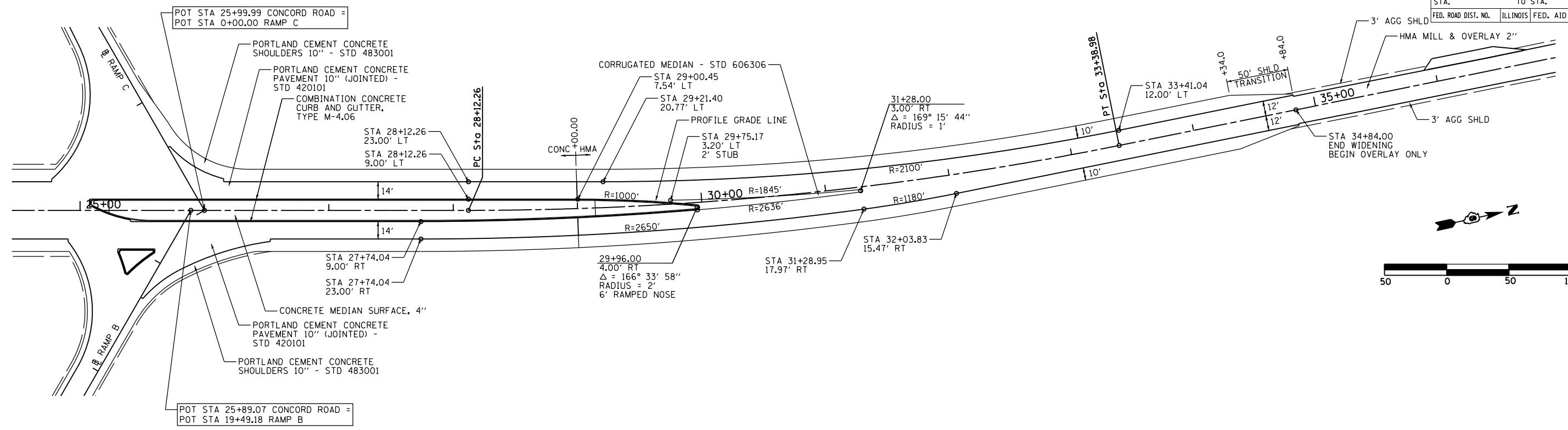

CONCORD ROAD STATION	OFFSET TO LEFT EDGE & ELEVATION						OFFSET TO RIGHT EDGE & ELEVATION					
	OUTSIDE PAVEMENT		C&G TY M-4.06		CORRUGATED MEDIAN		C&G TY M-4.06		CORRUGATED MEDIAN		OUTSIDE PAVEMENT	
	OFFSET	ELEVATION	OFFSET	ELEVATION	OFFSET	ELEVATION	OFFSET	ELEVATION	OFFSET	ELEVATION	OFFSET	ELEVATION
27+70.00	23.00' LT	628.33	9.00' LT	628.65	-	-	9.00' RT	629.07	-	-	23.00' RT	629.39
27+75.00	23.00' LT	628.16	9.00' LT	628.50	-	-	9.00' RT	628.93	-	-	23.00' RT	629.27
27+80.00	23.00' LT	627.99	9.00' LT	628.34	-	-	8.99' RT	628.79	-	-	22.99' RT	629.14
27+85.00	23.00' LT	627.82	9.00' LT	628.19	-	-	8.98' RT	628.65	-	-	22.98' RT	629.02
27+90.00	23.00' LT	627.65	9.00' LT	628.03	-	-	8.95' RT	628.51	-	-	22.95' RT	628.89
27+95.00	23.00' LT	627.48	9.00' LT	627.87	-	-	8.92' RT	628.37	-	-	22.92' RT	628.76
28+00.00	23.00' LT	627.30	9.00' LT	627.71	-	-	8.87' RT	628.23	-	-	22.87' RT	628.63
28+05.00	23.00' LT	627.13	9.00' LT	627.55	-	-	8.82' RT	628.08	-	-	22.82' RT	628.50
28+10.00	23.00' LT	626.95	9.00' LT	627.38	-	-	8.75' RT	627.93	-	-	22.76' RT	628.37
28+15.00	23.00' LT	626.77	9.00' LT	627.22	-	-	8.68' RT	627.79	-	-	22.68' RT	628.23
28+20.00	22.99' LT	626.60	8.99' LT	627.06	-	-	8.61' RT	627.63	-	-	22.61' RT	628.10
28+25.00	22.97' LT	626.42	8.97' LT	626.89	-	-	8.54' RT	627.48	-	-	22.54' RT	627.96
28+30.00	22.94' LT	626.24	8.94' LT	626.72	-	-	8.46' RT	627.33	-	-	22.47' RT	627.82
28+35.00	22.90' LT	626.05	8.90' LT	626.56	-	-	8.39' RT	627.18	-	-	22.39' RT	627.68
28+40.00	22.86' LT	625.87	8.86' LT	626.39	-	-	8.32' RT	627.02	-	-	22.32' RT	627.53
28+45.00	22.80' LT	625.69	8.80' LT	626.22	-	-	8.24' RT	626.86	-	-	22.25' RT	627.39
28+50.00	22.73' LT	625.50	8.73' LT	626.05	-	-	8.17' RT	626.70	-	-	22.17' RT	627.24
28+55.00	22.66' LT	625.32	8.66' LT	625.87	-	-	8.10' RT	626.54	-	-	22.10' RT	627.10
28+60.00	22.57' LT	625.13	8.57' LT	625.70	-	-	8.02' RT	626.38	-	-	22.03' RT	626.95
28+65.00	22.48' LT	624.94	8.48' LT	625.53	-	-	7.95' RT	626.21	-	-	21.95' RT	626.79
28+70.00	22.38' LT	624.75	8.37' LT	625.35	-	-	7.88' RT	626.04	-	-	21.88' RT	626.64
28+75.00	22.26' LT	624.57	8.26' LT	625.18	-	-	7.80' RT	625.88	-	-	21.81' RT	626.49
28+80.00	22.14' LT	624.38	8.14' LT	625.01	-	-	7.73' RT	625.72	-	-	21.73' RT	626.34
28+85.00	22.01' LT	624.20	8.00' LT	624.84	-	-	7.66' RT	625.55	-	-	21.66' RT	626.19
28+90.00	21.87' LT	624.02	7.86' LT	624.67	-	-	7.58' RT	625.39	-	-	21.58' RT	626.04
28+95.00	21.72' LT	623.84	7.71' LT	624.50	-	-	7.51' RT	625.22	-	-	21.51' RT	625.88
29+00.00	21.56' LT	623.68	7.55' LT	624.34	-	-	7.43' RT	625.04	-	-	21.44' RT	625.70
29+05.00	21.39' LT	623.52	7.37' LT	624.18	-	-	7.36' RT	624.87	-	-	21.36' RT	625.53
29+10.00	21.21' LT	623.35	7.16' LT	624.01	-	-	7.29' RT	624.69	-	-	21.29' RT	625.35
29+15.00	21.02' LT	623.19	6.91' LT	623.85	-	-	7.21' RT	624.52	-	-	21.21' RT	625.17
29+20.00	20.83' LT	623.03	6.63' LT	623.69	-	-	7.14' RT	624.34	-	-	21.14' RT	625.00
29+25.00	20.62' LT	622.86	6.31' LT	623.54	-	-	7.06' RT	624.17	-	-	21.06' RT	624.82
29+30.00	20.42' LT	622.70	5.96' LT	623.38	-	-	6.99' RT	623.99	-	-	20.99' RT	624.65
29+35.00	20.22' LT	622.54	5.57' LT	623.23	-	-	6.91' RT	623.82	-	-	20.92' RT	624.47
29+40.00	20.03' LT	622.38	5.15' LT	623.08	-	-	6.84' RT	623.64	-	-	20.84' RT	624.30
29+45.00	19.83' LT	622.21	4.69' LT	622.93	-	-	6.76' RT	623.46	-	-	20.77' RT	624.12
29+50.00	19.64' LT	622.06	4.20' LT	622.79	4.43' LT X	622.78	6.69' RT	623.30	-	-	20.69' RT	623.96
29+55.00	19.45' LT	621.91	3.67' LT	622.65	4.18' LT X	622.63	6.61' RT	623.14	-	-	20.62' RT	623.79
29+60.00	19.26' LT	621.76	3.11' LT	622.52	3.93' LT X	622.48	6.54' RT	622.97	-	-	20.54' RT	623.63
29+65.00	19.08' LT	621.61	2.52' LT	622.39	3.69' LT X	622.34	6.46' RT	622.82	-	-	20.47' RT	623.47
29+70.00	18.89' LT	621.47	1.88' LT	622.27	3.45' LT X	622.20	6.39' RT	622.66	-	-	20.39' RT	623.32
29+75.00	18.71' LT	621.33	1.22' LT	622.15	3.21' LT X	622.05	6.31' RT	622.50	-	-	20.32' RT	623.16
29+80.00	18.54' LT	621.18	0.51' LT	622.03	2.98' LT	621.91	6.24' RT	622.35	-	-	20.24' RT	623.01
29+85.00	18.36' LT	621.04	0.22' RT	621.92	2.75' LT	621.78	6.16' RT	622.19	-	-	20.16' RT	622.85
29+90.00	18.19' LT	620.90	1.00' RT	621.80	2.53' LT	621.64	6.09' RT	622.04	-	-	20.09' RT	622.70
29+95.00	18.02' LT	620.77	1.81' RT	621.70	2.31' LT	621.50	6.01' RT	621.90	-	-	20.01' RT	622.55
30+00.00	17.85' LT	620.63	-	-	2.10' LT	621.37	-	-	5.94' RT	621.75	19.94' RT	622.41

TABLE CONTINUED ON NEXT SHEET

REVISIONS	
NAME	DATE

ILLINOIS DEPARTMENT OF TRANSPORTATION
 GEOMETRIC DETAILS
 CONCORD ROAD
 TRANSITIONAL APPROACH
 FAP 310 (US 67/IL 104)
 SHEET 5 OF 23
 DRAWN BY SEB
 CHECKED BY
 DATE 9/09

\$ FILE \$