

8:45:45 AM

Mar-30-2011 08:45:45AM

\$FILE\$

Table with columns: FAP 310 (US 67), COOPER STREET, ELEVATION. Rows A1 to A21.

Table with columns: FAP 310 (US 67), COOPER STREET, ELEVATION. Rows F1 to F8.

Table with columns: FAP 310 (US 67), COOPER STREET, ELEVATION. Rows B1 to B16.

Summary table with columns: F.A.P. RTE., SECTION, COUNTY, TOTAL SHEETS, SHEET NO. Values: 310, 69-3(3HB), MORGAN, 793, 213.

PROP. CURVE MLE15BR2
PI STA. = 903+14.32
D = 16° 30' 00" (LT)
Δ = 0° 52' 23"
R = 6,561.67'
T = 951.40'
L = 1,889.62'
E = 68.61'
e = 0.031
P.C. STA. = 893+62.92
P.T. STA. = 912+52.55
S.E. TRANSITION
STA 892+24.00 TO STA 894+09.00
STA 912+06.00 TO STA 913+91.00

COOPER STREET C & EOP ELEVATIONS table with columns: STATION, OFFSET, ELEVATION, OFFSET, ELEVATION. Rows 448+56.24 to 449+47.32.

COOPER STREET C & EOP ELEVATIONS table with columns: STATION, OFFSET, ELEVATION, OFFSET, ELEVATION. Rows 448+56.24 to 449+52.46.

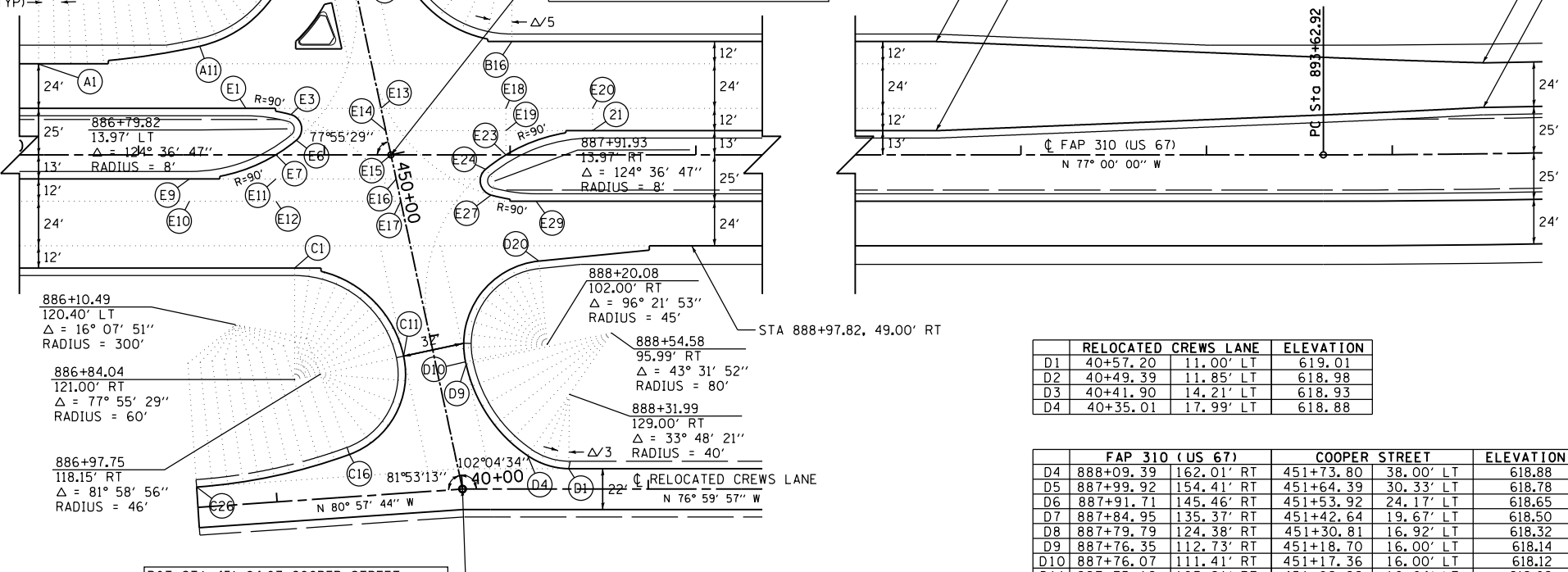
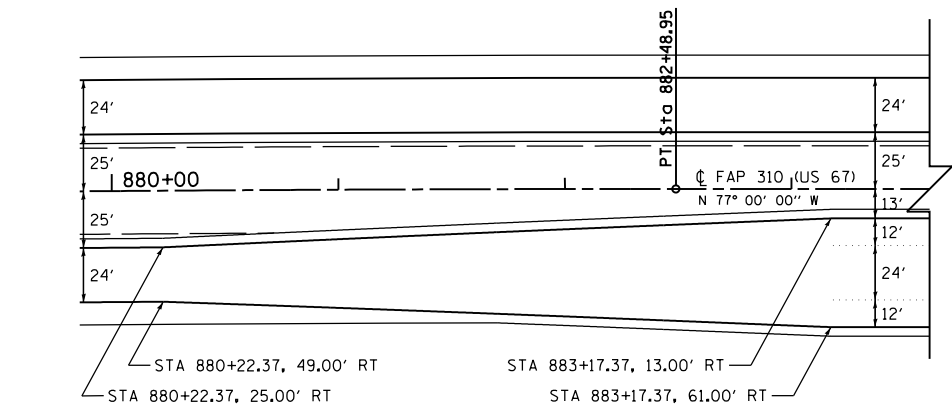

Table with columns: FAP 310 (US 67), ELEVATION. Rows E1 to E29.

RELOCATED CREWS LANE ELEVATION table with columns: STATION, ELEVATION. Rows C16 to C26.

RELOCATED CREWS LANE ELEVATION table with columns: STATION, ELEVATION. Rows D1 to D4.

Table with columns: FAP 310 (US 67), COOPER STREET, ELEVATION. Rows D4 to D20.

Table with columns: FAP 310 (US 67), COOPER STREET, ELEVATION. Rows C1 to C16.

COOPER STREET C & EOP ELEVATIONS table with columns: STATION, OFFSET, ELEVATION, OFFSET, ELEVATION. Rows 450+46.69 to 451+70.68.

COOPER STREET C & EOP ELEVATIONS table with columns: STATION, OFFSET, ELEVATION, OFFSET, ELEVATION. Rows 450+53.53 to 451+76.24.

ISLAND DETAIL

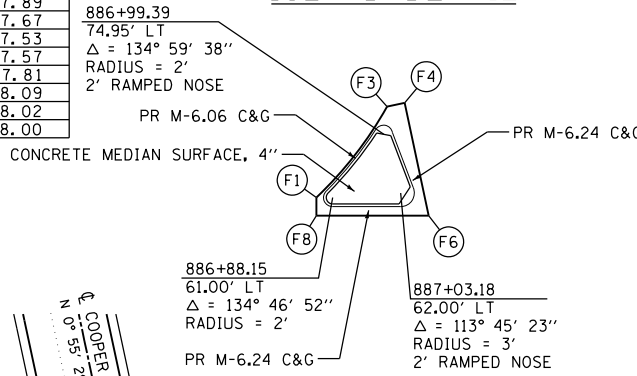

PROP. CURVE MLE15AR2
PI STA. = 876+76.40
Δ = 2° 00' 00" (RT)
D = 0° 10' 29"
R = 32,808.32'
T = 572.67'
L = 1,145.22'
E = 5.00'
e = NC
P.C. STA. = 871+03.73
P.T. STA. = 882+48.95

885+46.18
449.00' LT
Δ = 12° 30' 55"
RADIUS = 400'

886+18.77
121.96' LT
Δ = 89° 33' 36"
RADIUS = 65'

Δ/10 (TYP)

886+10.49
120.40' LT
Δ = 16° 07' 51"
RADIUS = 300'

886+84.04
121.00' RT
Δ = 77° 55' 29"
RADIUS = 60'

886+97.75
118.15' RT
Δ = 81° 58' 56"
RADIUS = 46'

POT STA 451+84.07 COOPER STREET =
PI STA 40+00.00 RELOCATED CREWS LANE

COOPER STREET C & EOP ELEVATIONS

COOPER STREET C & EOP ELEVATIONS

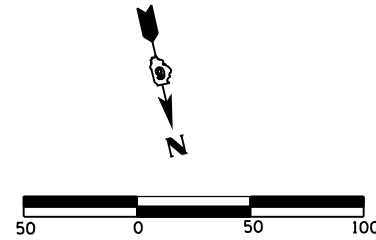
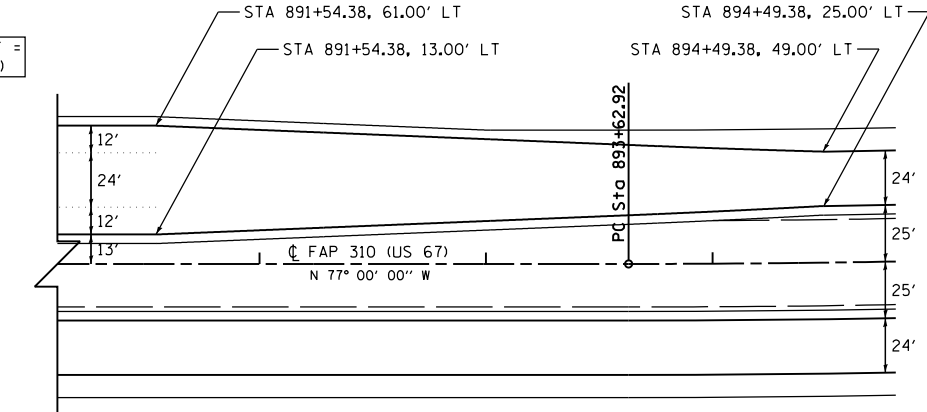

REVISIONS table with columns: NAME, DATE.

ILLINOIS DEPARTMENT OF TRANSPORTATION
GEOMETRIC DETAILS
INTERSECTION OF FAP 310
COOPER ST & CREWS LANE
FAP 310 (US 67/IL 104)
SHEET 8 OF 23

DATE 6/06
DRAWN BY EBB
CHECKED BY