

F.A.P. RTE.	SECTION	COUNTY	TOTAL SHEETS	SHEET NO.
310	69-3(3HB)	MORGAN	793	214
STA.		TO STA.		
FED. ROAD DIST. NO.		ILLINOIS	FED. AID PROJECT	

	COOPER STREET		NEW STREET		ELEVATION
A1	443+46.83	12.00' LT	300+13.18	72.97' LT	614.99
A2	443+56.31	12.75' LT	300+13.78	63.48' LT	614.87
A3	443+65.55	15.00' LT	300+15.87	54.20' LT	614.72
A4	443+74.33	18.67' LT	300+19.41	45.37' LT	614.50
A5	443+82.41	23.69' LT	300+24.29	37.20' LT	614.24
A6	443+89.60	29.92' LT	300+30.40	29.92' LT	614.02
A7	443+95.71	37.20' LT	300+37.59	23.69' LT	613.87
A8	444+00.59	45.37' LT	300+45.67	18.67' LT	613.79
A9	444+04.13	54.20' LT	300+54.45	15.00' LT	613.71
A10	444+06.22	63.48' LT	300+63.69	12.75' LT	613.63
A11	444+06.82	72.97' LT	300+73.17	12.00' LT	613.55

	NEW STREET		ASH STREET		ELEVATION
C1	312+65.17	12.00' LT	3+13.37	70.23' RT	619.17
C2	312+74.48	12.73' LT	3+12.53	60.93' RT	619.24
C3	312+83.56	14.89' LT	3+10.25	51.88' RT	619.31
C4	312+92.20	18.44' LT	3+06.59	43.28' RT	619.37
C5	313+00.19	23.28' LT	3+01.65	35.36' RT	619.43
C6	313+07.32	29.30' LT	2+95.53	28.30' RT	619.49
C7	313+13.44	36.36' LT	2+88.40	22.28' RT	619.54
C8	313+18.38	44.28' LT	2+80.41	17.44' RT	619.59
C9	313+22.04	52.88' LT	2+71.77	13.89' RT	619.63
C10	313+24.32	61.93' LT	2+62.69	11.73' RT	619.67
C11	313+25.16	71.23' LT	2+53.38	11.00' RT	619.68

STATION	OFFSET	ELEVATION	OFFSET	ELEVATION
300+12.20	12.00' LT	614.44	0.00' LT	614.36
300+25.00	12.00' LT	614.20	0.00' LT	614.19
300+50.00	12.00' LT	613.82	0.00' LT	613.94
300+73.17	12.00' LT	613.55	0.00' LT	613.79

STATION	OFFSET	ELEVATION	OFFSET	ELEVATION
312+65.17	12.00' LT	619.17	0.00' LT	619.41
312+75.00	12.00' LT	619.26	0.00' LT	619.46
313+00.00	12.00' LT	619.49	0.00' LT	619.58
313+24.41	12.00' LT	619.72	0.00' LT	N/A

STATION	OFFSET	ELEVATION	OFFSET	ELEVATION
2+50.00	11.00' RT	619.68	0.00' RT	620.02
2+75.00	11.00' RT	619.68	0.00' RT	619.99
3+00.00	11.00' RT	619.69	0.00' RT	619.95
3+12.62	11.00' RT	619.72	0.00' RT	619.94

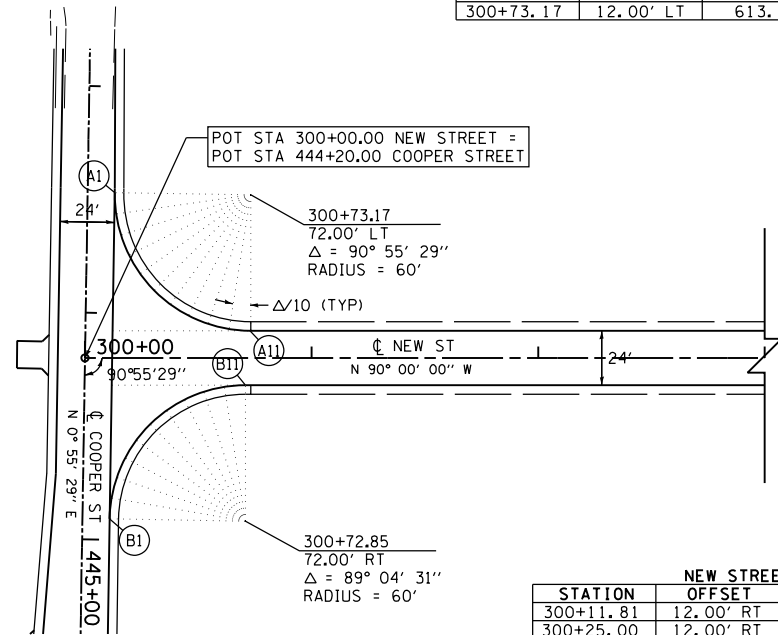

STATION	OFFSET	ELEVATION	OFFSET	ELEVATION
300+11.81	12.00' RT	614.30	0.00' RT	N/A
300+25.00	12.00' RT	614.09	0.00' RT	614.19
300+50.00	12.00' RT	613.76	0.00' RT	613.94
300+70.85	12.00' RT	613.56	0.00' RT	613.80

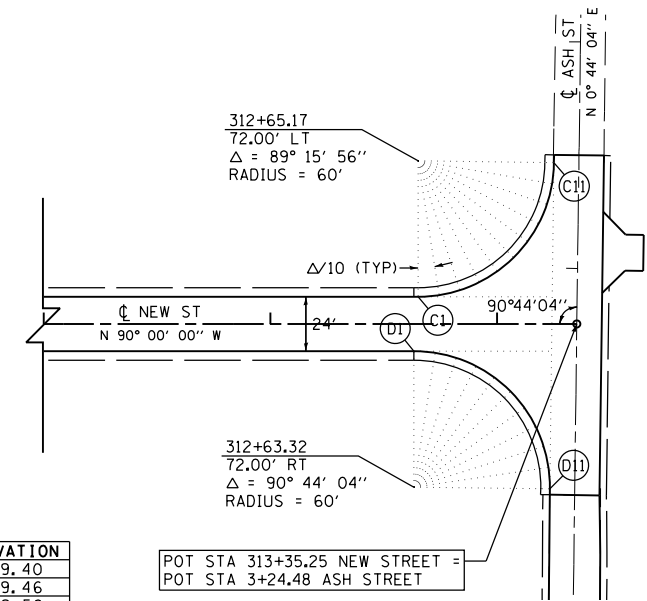

STATION	OFFSET	ELEVATION	OFFSET	ELEVATION
312+63.32	12.00' RT	619.16	0.00' RT	619.40
312+75.00	12.00' RT	619.26	0.00' RT	619.46
313+00.00	12.00' RT	619.47	0.00' RT	619.58
313+24.10	12.00' RT	619.68	0.00' RT	619.70

	COOPER STREET		NEW STREET		ELEVATION
B1	444+90.85	12.00' LT	300+10.85	71.03' RT	614.27
B2	444+81.56	12.72' LT	300+11.73	61.75' RT	614.24
B3	444+72.49	14.88' LT	300+14.03	52.72' RT	614.21
B4	444+63.87	18.41' LT	300+17.70	44.16' RT	614.12
B5	444+55.89	23.23' LT	300+22.65	36.27' RT	614.02
B6	444+48.76	29.23' LT	300+28.76	29.23' RT	613.92
B7	444+42.65	36.26' LT	300+35.89	23.23' RT	613.84
B8	444+37.70	44.16' LT	300+43.87	18.41' RT	613.77
B9	444+34.03	52.72' LT	300+52.49	14.88' RT	613.70
B10	444+31.73	61.75' LT	300+61.56	12.72' RT	613.63
B11	444+30.85	71.03' LT	300+70.85	12.00' RT	613.56

	NEW STREET		ASH STREET		ELEVATION
D1	312+63.32	12.00' RT	3+37.40	71.77' RT	619.16
D2	312+72.79	12.75' RT	3+38.03	62.30' RT	619.22
D3	312+82.01	14.99' RT	3+40.14	53.05' RT	619.28
D4	312+90.77	18.65' RT	3+43.69	44.24' RT	619.33
D5	312+98.84	23.64' RT	3+48.58	36.11' RT	619.38
D6	313+06.02	29.85' RT	3+54.69	28.85' RT	619.43
D7	313+12.13	37.11' RT	3+61.88	22.64' RT	619.47
D8	313+17.03	45.24' RT	3+69.95	17.65' RT	619.52
D9	313+20.57	54.05' RT	3+78.70	13.98' RT	619.56
D10	313+22.69	63.30' RT	3+87.93	11.75' RT	619.60
D11	313+23.32	72.77' RT	3+97.39	11.00' RT	619.60

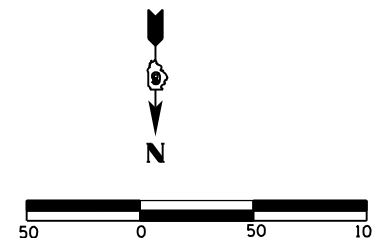

NAME	DATE

ILLINOIS DEPARTMENT OF TRANSPORTATION
 GEOMETRIC DETAILS
 INTERSECTION OF NEW ST
 COOPER ST & ASH ST
 FAP 310 (US 67/IL 104)
 SHEET 9 OF 23

DATE 6/06
 DRAWN BY EBB
 CHECKED BY