

F.A.P. RTE.	SECTION	COUNTY	TOTAL SHEETS	SHEET NO.
310	69-3(3HB)	MORGAN	793	215
STA.		TO STA.		
FED. ROAD DIST. NO.	ILLINOIS	FED. AID PROJECT		

8:45:56 AM

Mar-30-2011 08:45:56AM

	EX US 67/IL 104		ASH STREET		ELEVATION
A1	565+13.24	12.27' RT	9+76.41	80.91' RT	620.69
A2	565+02.98	13.13' RT	9+77.06	70.67' RT	620.71
A3	564+93.00	15.69' RT	9+75.95	60.47' RT	620.70
A4	564+83.59	19.89' RT	9+73.13	50.60' RT	620.66
A5	564+75.02	25.60' RT	9+68.66	41.36' RT	620.56
A6	564+67.51	32.66' RT	9+62.68	33.02' RT	620.43
A7	564+61.31	40.88' RT	9+55.37	25.81' RT	620.25
A8	564+56.58	50.02' RT	9+46.94	19.96' RT	620.06
A9	564+53.48	59.81' RT	9+37.64	15.63' RT	619.87
A10	564+52.11	69.99' RT	9+27.73	12.95' RT	619.68
A11	564+52.52	80.24' RT	9+17.51	12.00' RT	619.49

	EX US 67/IL 104		ASH STREET		ELEVATION
B1	564+32.32	127.61' RT	8+73.10	13.63' LT	619.00
B2	564+30.83	118.68' RT	8+82.13	13.93' LT	619.03
B3	564+29.07	109.81' RT	8+91.15	14.50' LT	619.10
B4	564+27.05	100.99' RT	9+00.15	15.34' LT	619.18
B5	564+24.76	92.23' RT	9+09.11	16.45' LT	619.27
B6	564+22.22	83.54' RT	9+18.04	17.84' LT	619.35
B7	564+19.42	74.93' RT	9+26.93	19.49' LT	619.44
B8	564+16.37	66.40' RT	9+35.76	21.40' LT	619.54
B9	564+13.08	57.97' RT	9+44.53	23.59' LT	619.68
B10	564+09.54	49.63' RT	9+53.23	26.03' LT	619.85
B11	564+05.77	41.40' RT	9+61.85	28.74' LT	620.06
B12	563+99.72	31.69' RT	9+72.20	33.53' LT	620.37
B13	563+91.64	23.58' RT	9+81.20	40.55' LT	620.68
B14	563+81.95	17.48' RT	9+88.37	49.42' LT	620.95
B15	563+71.15	13.69' RT	9+93.35	59.68' LT	621.08
B16	563+59.78	12.41' RT	9+95.86	70.81' LT	621.15

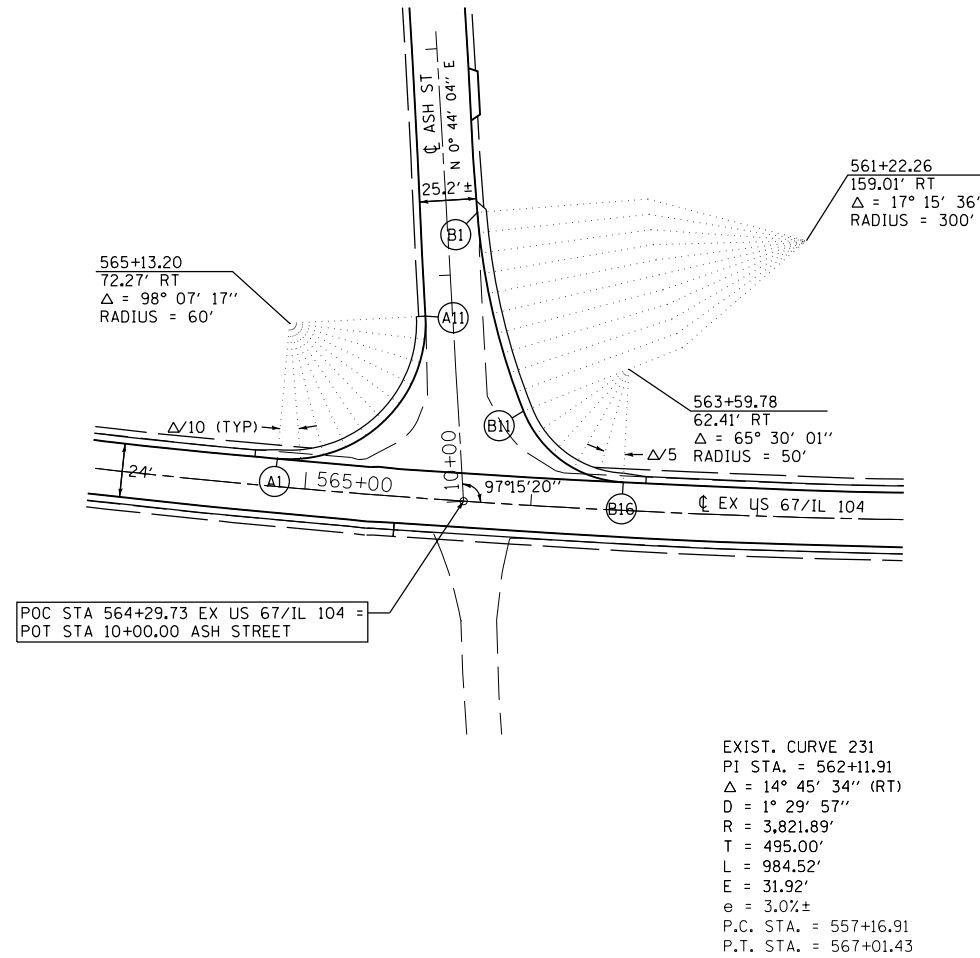

\$FILE\$

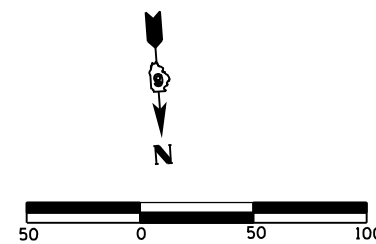

REVISIONS	
NAME	DATE

ILLINOIS DEPARTMENT OF TRANSPORTATION
 GEOMETRIC DETAILS
 INTERSECTION OF EX US 67
 ASH ST
 FAP 310 (US 67/IL 104)
 SHEET 10 OF 23
 DRAWN BY EBB
 CHECKED BY
 DATE 6/06