

F.A.P. RTE.	SECTION	COUNTY	TOTAL SHEETS	SHEET NO.
310	69-3(3HB)	MORGAN	793	232
STA.		TO STA.		
FED. ROAD DIST. NO.	ILLINOIS	FED. AID PROJECT		

PAVEMENT JOINT LEGEND

- LONGITUDINAL CONSTRUCTION OR SAWED JOINT (STD 420001)
- TRANSVERSE CONTRACTION JOINT (STD 420001)
- PAVEMENT FABRIC (STD 420701)

8:47:45 AM

Mar-30-2011 08:47:45AM

\$FILE\$

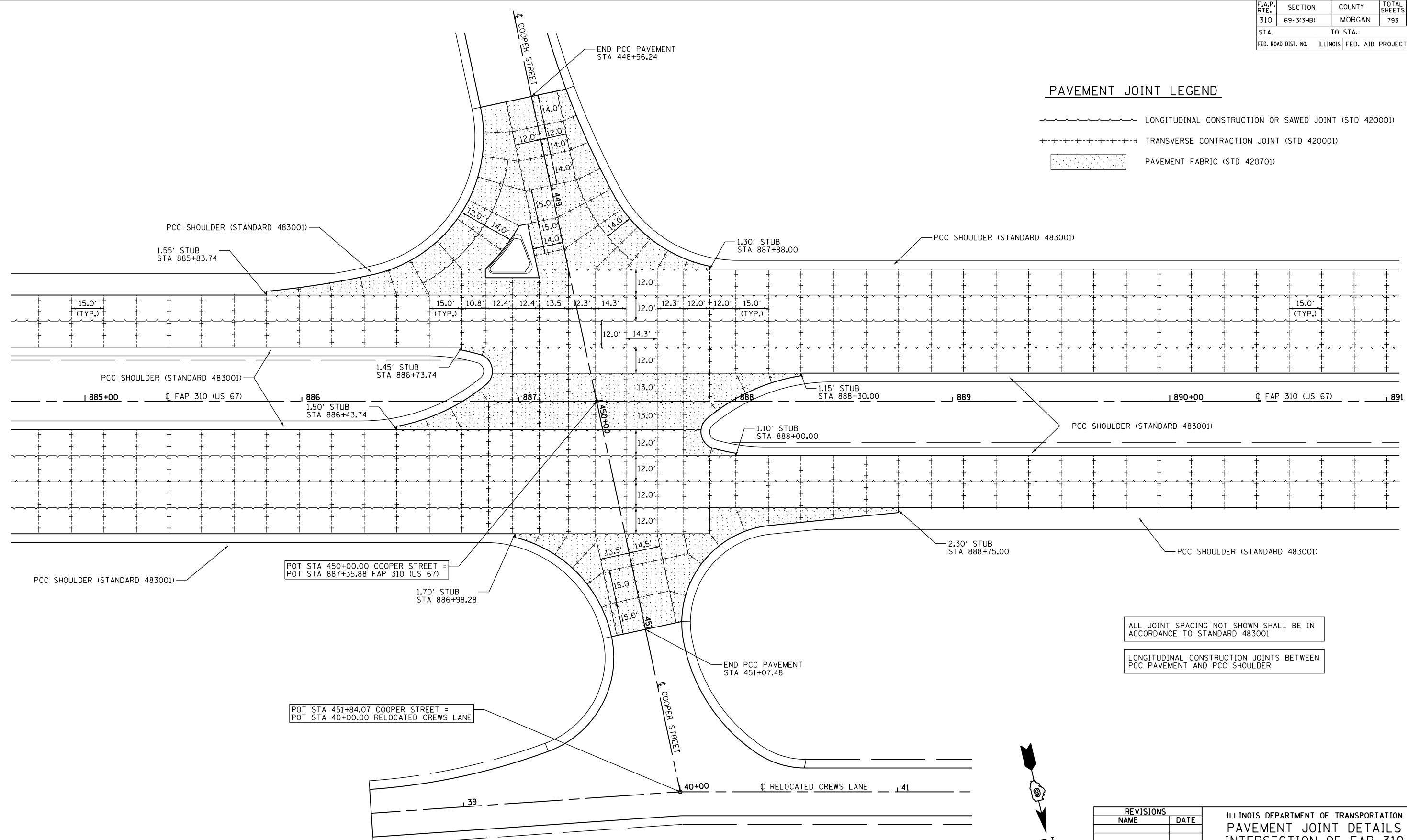

ALL JOINT SPACING NOT SHOWN SHALL BE IN ACCORDANCE TO STANDARD 483001

LONGITUDINAL CONSTRUCTION JOINTS BETWEEN PCC PAVEMENT AND PCC SHOULDER

REVISIONS	
NAME	DATE

ILLINOIS DEPARTMENT OF TRANSPORTATION
 PAVEMENT JOINT DETAILS
 INTERSECTION OF FAP 310
 COOPER ST & CREWS LANE
 FAP 310 (US 67/IL 104)
 SHEET 4 OF 13

DATE 7/06
 DRAWN BY EBB
 CHECKED BY

