

DELINEATOR SYMBOLS

- T - SINGLE
- ≡ - DOUBLE

**Concord
Arenzville
1 MILE**

STA 880+00.00
LT, 36' OFF EOP
PR SIGN #01
(SEE DETAILS)

STA 578+75.00
CENTERLINE
R11-I108 (3636)
.2-OM4-1 (1818)
"ROAD ENDS"
w/ 2- OBJECT MARKERS

STA 449+00.00
RT, 12' OFF EOP
R1-1 (3636)
R1-I100 (3018)
"STOP"
"CROSS TRAFFIC
DOES NOT STOP"

STA 584+00.00
LT, 20' OFF EOP
W8-I108 (3636)
"ROAD ENDS 500 FT"

STA 888+50.00
LT & RT, 20' OFF EOP
R5-1 (3636)
"DO NOT ENTER"

STA 883+40.00
LT & RT, 20' OFF EOP
R5-1A (3624)
"WRONG WAY"

STA 887+00.00
STA 886+60.00
STA 888+00.00
TYPICAL SIDE STREET
YIELD SIGN INSTALLATION

STA 886+25.00
LT & RT, 20' OFF EOP
R5-1 (3636)
"DO NOT ENTER"

STA 38+75.00
LT, 12' OFF EOP
R11-I100 (3636)
"ROAD ENDS"
SIGN # (SEE DETAILS)
"PRIVATE DRIVE"

STA 39+58.10
STA 40+53.04
R1-1 (3636)
"STOP"

STA 887+85.00
TYPICAL SIDE STREET
STOP SIGN INSTALLATION

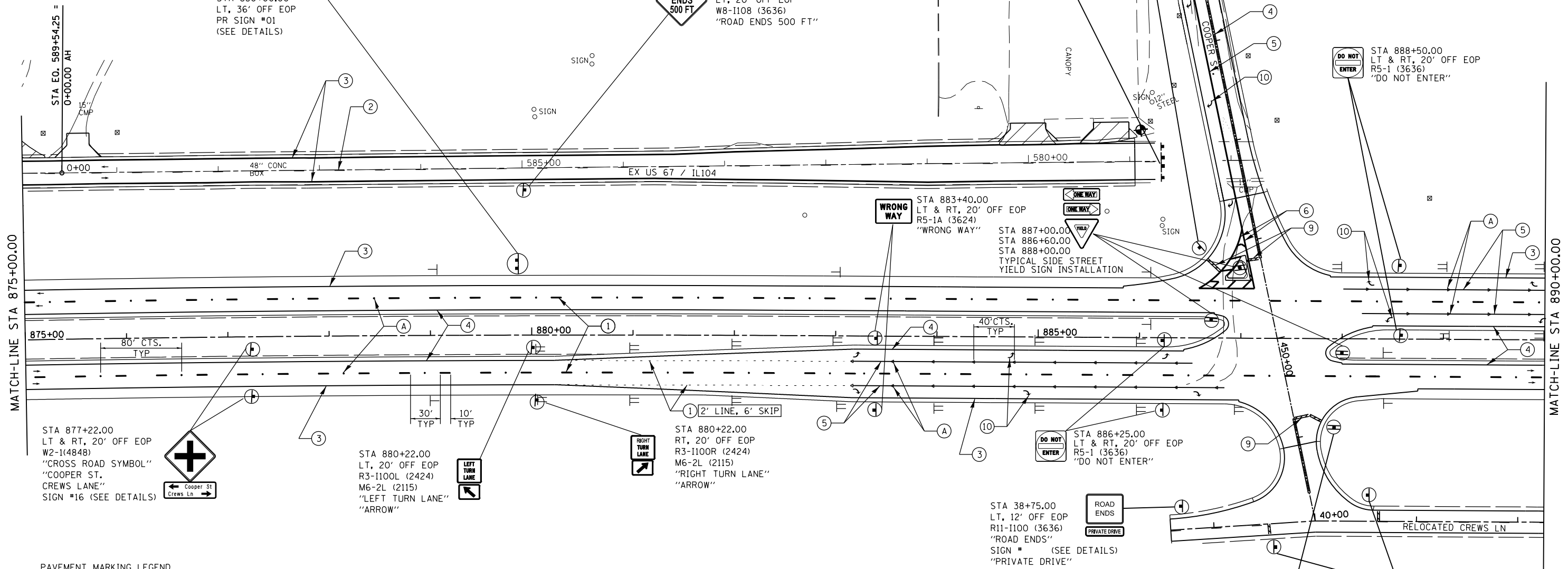

PAVEMENT MARKING LEGEND

- (A) PR RAISED REFLECTIVE PAVEMENT MARKERS, ONE-WAY CRYSTAL
- (B) PR RAISED REFLECTIVE PAVEMENT MARKERS, ONE-WAY AMBER
- (C) PR RAISED REFLECTIVE PAVEMENT MARKERS, TWO-WAY AMBER
- (1) PR URETHANE PAVEMENT MARKING- LINE 5" (WHITE SKIP DASH)
- (2) PR URETHANE PAVEMENT MARKING- LINE 5" (YELLOW SKIP DASH)
- (3) PR URETHANE PAVEMENT MARKING- LINE 5" (SOLID WHITE)
- (4) PR URETHANE PAVEMENT MARKING-LINE 5" (SOLID YELLOW)
- (5) PR URETHANE PAVEMENT MARKING- LINE 6" (SOLID WHITE)
- (6) PR PREFORMED PLASTIC PAVEMENT MARKING- LINE 8" (SOLID WHITE)
- (7) PR PREFORMED PLASTIC PAVEMENT MARKING- LINE 12" (SOLID WHITE)
- (8) PR PREFORMED PLASTIC PAVEMENT MARKING- LINE 12" (SOLID YELLOW)
- (9) PR PREFORMED PLASTIC PAVEMENT MARKING- LINE 24" (SOLID WHITE)
- (10) PR PREFORMED PLASTIC PAVEMENT MARKING- LETTERS & SYMBOLS (LARGE ARROWS= 15.6 SF/EACH)

TYPICAL SIDE STREET
STOP SIGN INSTALLATION

- R6-1L (3612) "ONE WAY LT"
BACK TO BACK
- R61R (3612) "ONE WAY RT"
- R1-1 (3636) "STOP"
- R6-3A (2418) "DIVIDED HIGHWAY"
- INSTALL ON 2 TELESCOPING STEEL POST

TYPICAL SIDE STREET
YIELD SIGN INSTALLATION

- R6-1L (3612) "ONE WAY LT"
BACK TO BACK
- R61R (3612) "ONE WAY RT"
- R1-2 (3636) "YIELD"
- INSTALL ON 2 TELESCOPING STEEL POST

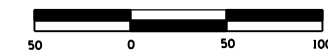

FILE NAME =	USER NAME = Sparksgw	DESIGNED -	REVISED -	STATE OF ILLINOIS DEPARTMENT OF TRANSPORTATION	STRIPING & SIGNING PLAN SHEETS FAP 310 (US 67)				F.A.P. RTE.	SECTION	COUNTY	TOTAL SHEETS	SHEET NO.		
ei:\pwwork\pwwidat\sparksgw\10264881\Sigs...	mainline_lb.v8.dgn	DRAWN -	REVISED -		SCALE:	SHEET NO.	OF	SHEETS	STA.	TO STA.	310	69-3	MORGAN	793	251
	PLOT SCALE = 100.0000' / 1in.	CHECKED -	REVISED -								CONTRACT NO. 72667				
	PLOT DATE = Mar-30-2011 08:49:07AM	DATE -	REVISED -								FED. ROAD DIST. NO. ILLINOIS FED. AID PROJECT				