

DELINEATOR SYMBOLS

- T - SINGLE
- TT - DOUBLE

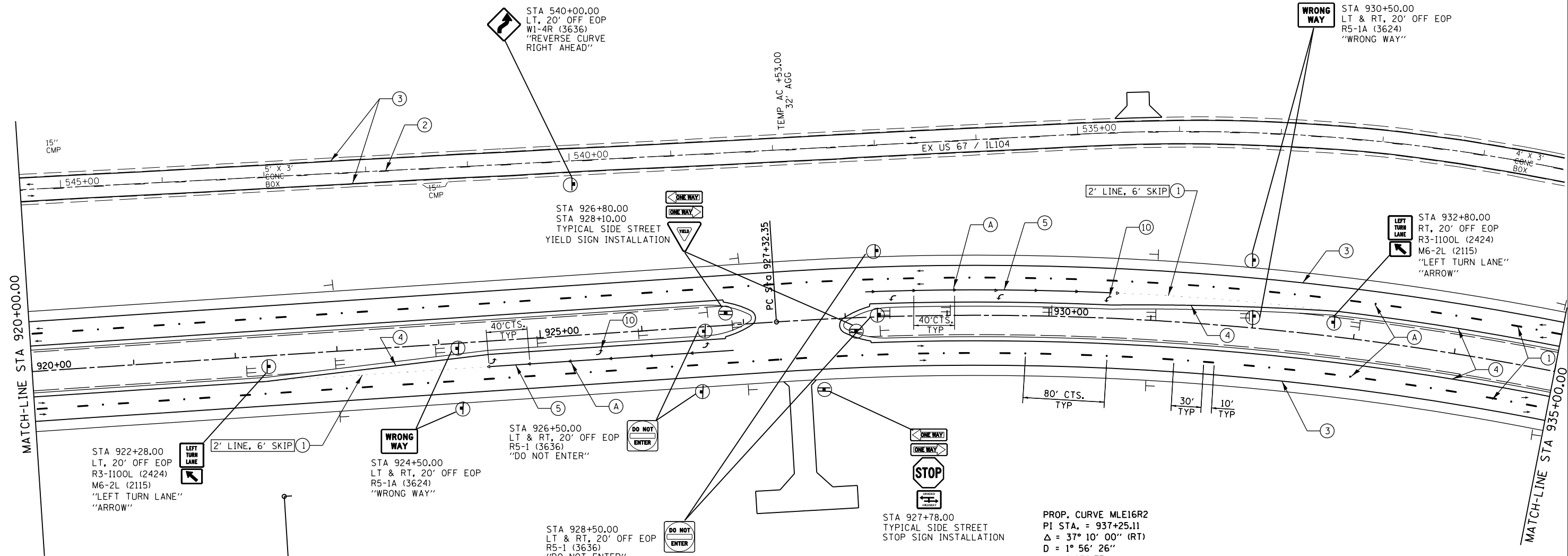

PAVEMENT MARKING LEGEND

- (A) PR RAISED REFLECTIVE PAVEMENT MARKERS, ONE-WAY CRYSTAL
- (B) PR RAISED REFLECTIVE PAVEMENT MARKERS, ONE-WAY AMBER
- (C) PR RAISED REFLECTIVE PAVEMENT MARKERS, TWO-WAY AMBER
- (1) PR URETHANE PAVEMENT MARKING- LINE 5" (WHITE SKIP DASH)
- (2) PR URETHANE PAVEMENT MARKING- LINE 5" (YELLOW SKIP DASH)
- (3) PR URETHANE PAVEMENT MARKING- LINE 5" (SOLID WHITE)
- (4) PR URETHANE PAVEMENT MARKING- LINE 5" (SOLID YELLOW)
- (5) PR URETHANE PAVEMENT MARKING- LINE 6" (SOLID WHITE)
- (6) PR URETHANE PAVEMENT MARKING- LINE 8" (SOLID WHITE)
- (7) PR URETHANE PAVEMENT MARKING- LINE 12" (SOLID WHITE)
- (8) PR URETHANE PAVEMENT MARKING- LINE 12" (SOLID YELLOW)
- (9) PR PREFORMED PLASTIC PAVEMENT MARKING- LINE 24" (SOLID WHITE)
- (10) PR PREFORMED PLASTIC PAVEMENT MARKING- LETTERS & SYMBOLS (LARGE ARROWS= 15.6 SF/EACH)

TYPICAL SIDE STREET STOP SIGN INSTALLATION

	R6-1L (3612) "ONE WAY LT" BACK TO BACK
	R61R (3612) "ONE WAY RT"
	R1-1 (3636) "STOP"
	R6-3A (2418) "DIVIDED HIGHWAY"
INSTALL ON 2 TELESCOPING STEEL POST	

TYPICAL SIDE STREET YIELD SIGN INSTALLATION

	R6-1L (3612) "ONE WAY LT" BACK TO BACK
	R61R (3612) "ONE WAY RT"
	R1-2 (3636) "YIELD"
INSTALL ON 2 TELESCOPING STEEL POST	

