

1:29:03 PM

May-19-2011 01:29:03PM

\$FILE\$

CONTRACT NO. 72667

F.A.P. RTE.	SECTION	COUNTY	TOTAL SHEETS	SHEET NO.
310	69-3(3HB)	MORGAN	793	308
STA.		TO STA.		
FED. ROAD DIST. NO.		ILLINOIS FED. AID PROJECT		

LIGHT POLE LOCATIONS

POLE	STATION	OFFSET
1A 1B	7+60	55' LT
2	9+50	45' LT
3	11+40	45' LT
4	13+30	45' LT
5A 5B	15+20	55' LT
6	17+05	45' LT
7	18+90	40' LT
8	21+05	40' RT

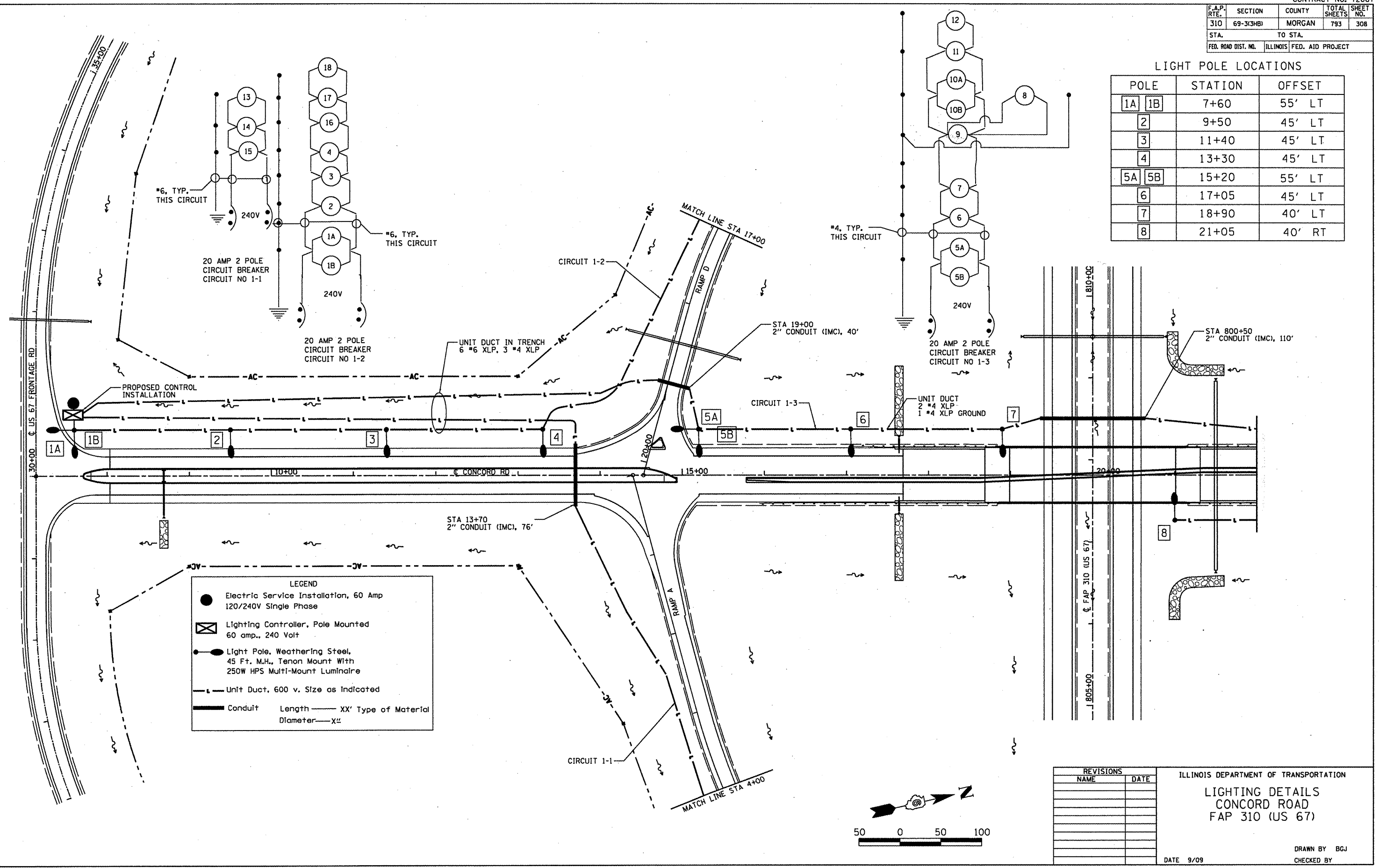

LEGEND

- Electric Service Installation, 60 Amp 120/240V Single Phase
- ⊗ Lighting Controller, Pole Mounted 60 amp., 240 Volt
- Light Pole, Weathering Steel, 45 Ft. M.H., Tenon Mount With 250W HPS Multi-Mount Luminaire
- Unit Duct, 600 v. Size as Indicated
- Conduit Length — XX' Type of Material Diameter — X"

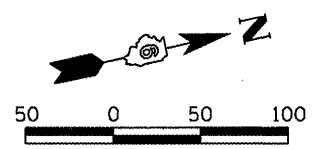

REVISIONS	
NAME	DATE

ILLINOIS DEPARTMENT OF TRANSPORTATION
LIGHTING DETAILS
CONCORD ROAD
FAP 310 (US 67)

DATE 9/09
 DRAWN BY BGI
 CHECKED BY