

9:38:41 AM

Mar-30-2011 09:38:41AM

\$FILE\$

CONTRACT NO. 72667

F.A.P. RTE.	SECTION	COUNTY	TOTAL SHEETS	SHEET NO.
310	69-3(3HB)	MORGAN	793	314
STA.		TO STA.		
FED. ROAD DIST. NO.		ILLINOIS FED. AID PROJECT		

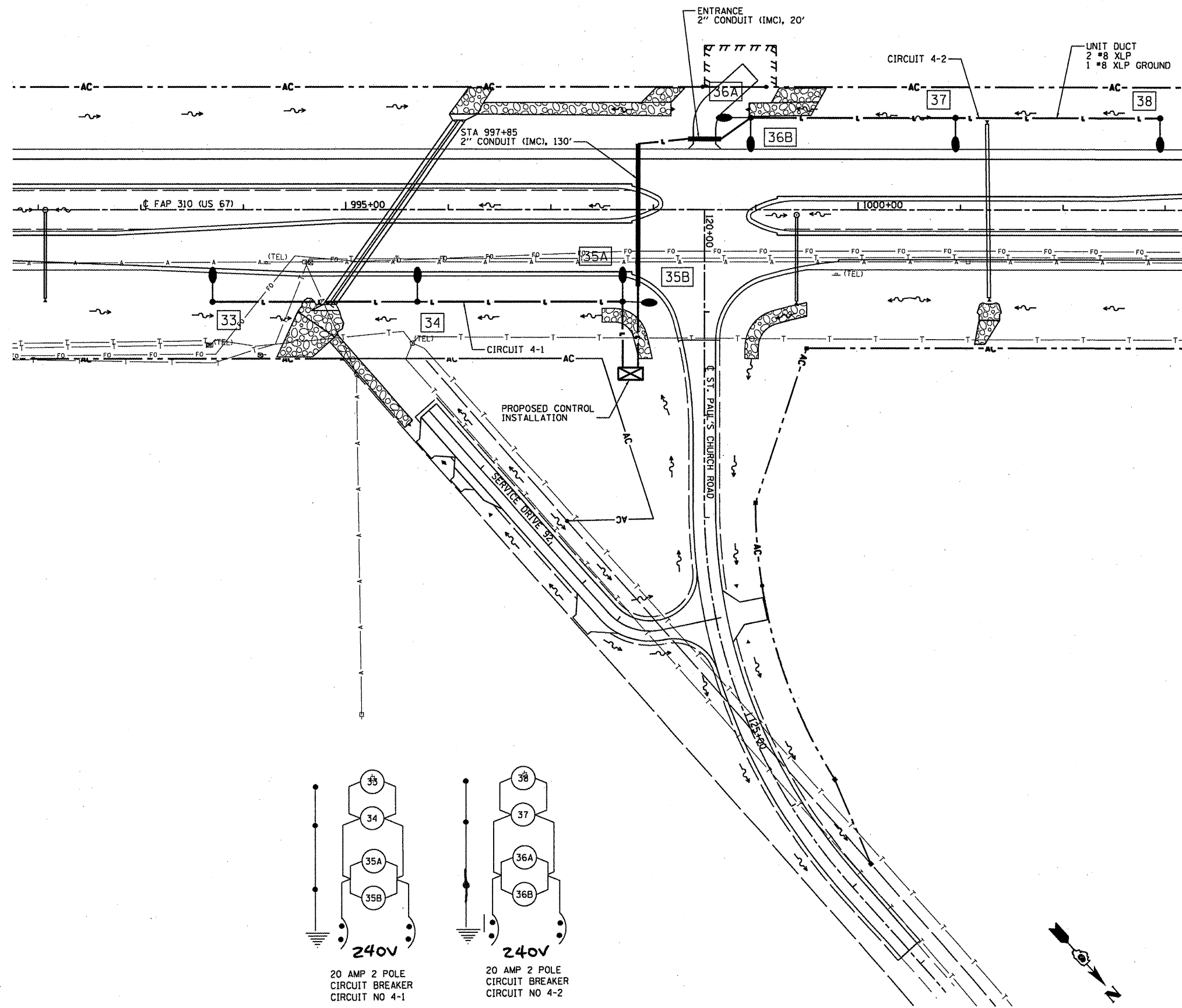

LIGHT POLE LOCATIONS

POLE	STATION	OFFSET
33	993+70	90' RT
34	995+70	90' RT
35A 35B	997+70	90' RT
36A 36B	998+95	80' LT
37	1000+95	80' LT
38	1002+95	80' LT

LEGEND

- Electric Service Installation, 120/240V Single Phase
- ⊗ Lighting Controller, Relay 30 amp., 240 Volt
- LIGHT POLE WEATHERING STEEL, 45 FT. MAH TENSION MOUNT w/ 250W HPS MULTI-MOUNT LUMINAIRE
- Unit Duct, 600 v. 2-1C no. 8 1/C No. 8 Ground, (XLP-Type use), 3/4" Polyethylene
- Conduit Length — XX' Type of Material Diameter — X"

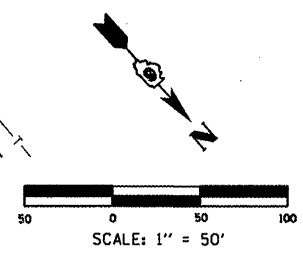
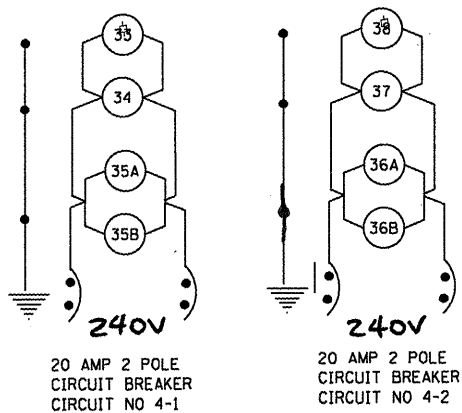

REVISIONS	
NAME	DATE

ILLINOIS DEPARTMENT OF TRANSPORTATION
LIGHTING DETAILS
 ST. PAUL'S CHURCH RD (CH 17)
 FAP 310 (US 67)

DATE 9/09
 DRAWN BY BGS
 CHECKED BY

SECTION 69-3(3HB)

MORGAN COUNTY

SHEET 7 OF 8