

F.A.P. RTE.	SECTION	COUNTY	TOTAL SHEETS	SHEET NO.
310	69-3(3HB)	MORGAN	793	356
STA.		TO STA.		
FED. ROAD DIST. NO.	ILLINOIS	FED. AID PROJECT		

9:40:47 AM  
Mar-30-2011 09:40:47 AM

612.23 100 YR. H.W.E.  
611.98 50 YR. H.W.E.

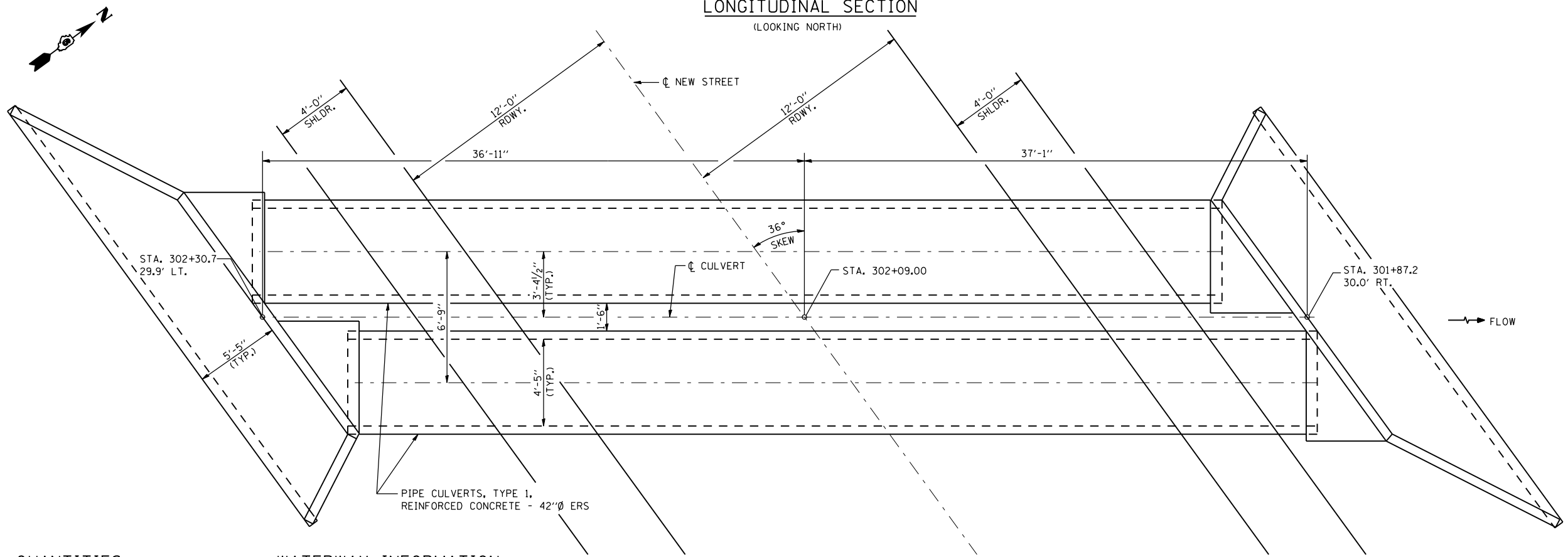
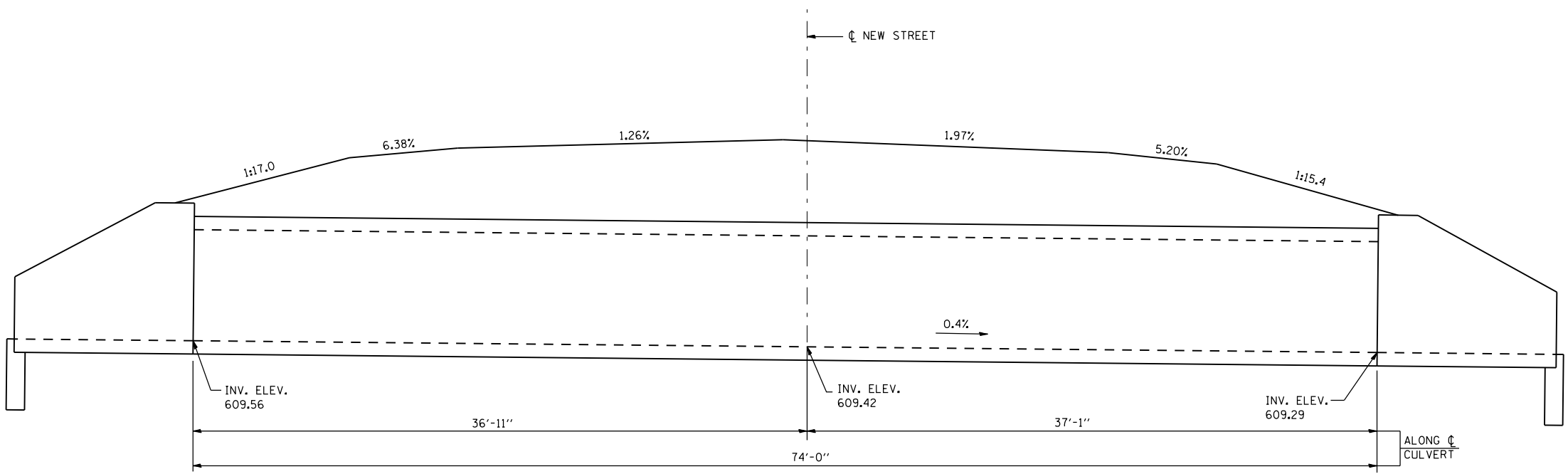

**QUANTITIES**

ITEM	UNIT	QTY.
PIPE CULVERTS, REINFORCED CONCRETE, TYPE 1, 42"Ø ERS	L.F.	148
CAST-IN-PLACE REINFORCED CONCRETE END SECTIONS	CU. YD.	17.4
REINFORCEMENT BARS	POUND	1110

**WATERWAY INFORMATION**

STATION 302+09  
 DRAINAGE AREA = 91.3 ACRES (0.143 SQ. MI.)  
 PROPOSED OPENING = 20.4 SQ. FT.  
 Q<sub>(50)</sub> = 80 CFS  
 Q<sub>(100)</sub> = 92 CFS  
 U.S.F.L. STA. 302+30.7, 29.9' LT., ELEV. 609.56  
 D.S.F.L. STA. 301+87.2, 30.0' RT., ELEV. 609.29

REVISIONS	
NAME	DATE

ILLINOIS DEPARTMENT OF TRANSPORTATION  
 GENERAL PLAN & ELEVATION  
 STATION 302+09.00  
 NEW STREET

DATE 10/07  
 DRAWN BY ADB  
 CHECKED BY MTH

\$FILE\$