

FARMERS STATE BANK & TRUST
 KRISTAINNE BECKER HOFFMAN
 ELIZABETH FRENCH BECKER

PAUL W. MILLER
 PAMELA S. MILLER

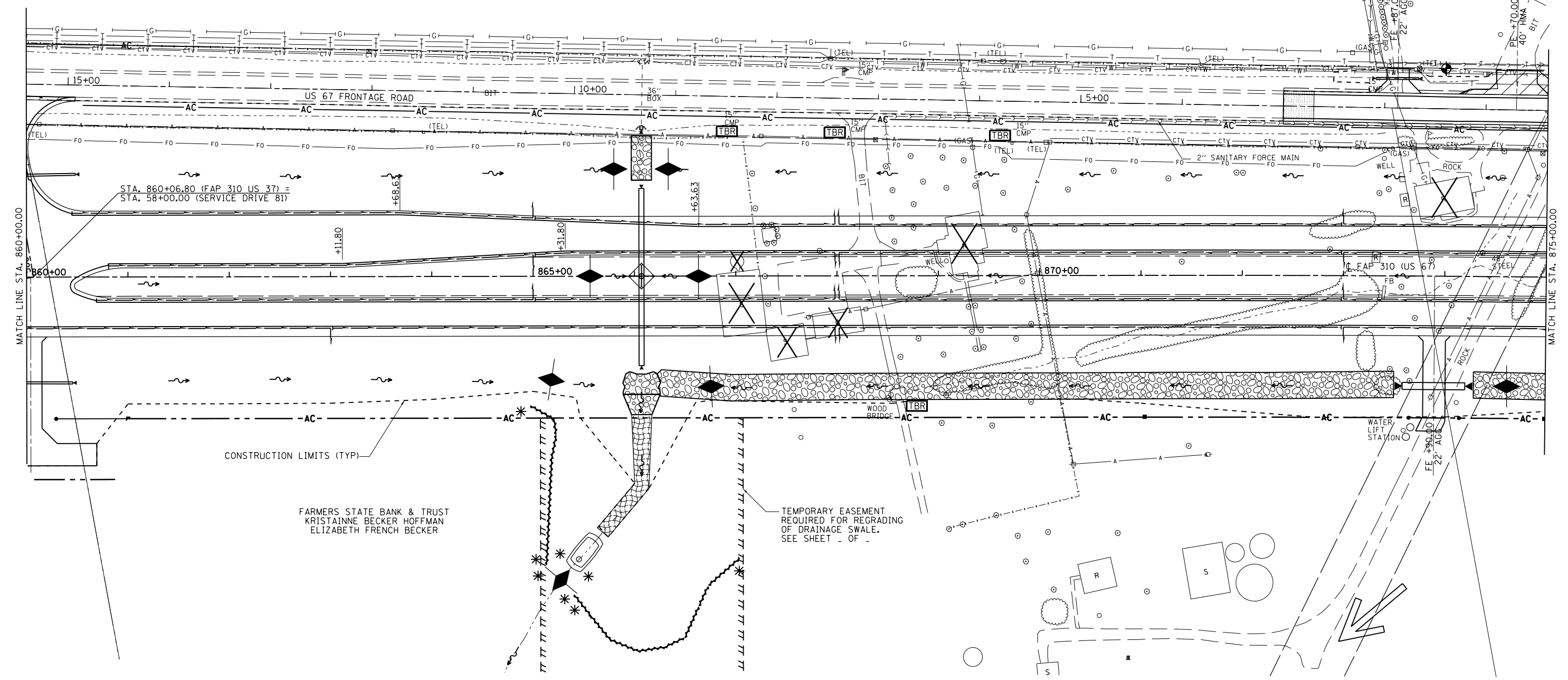
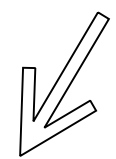

CONSTRUCTION LIMITS (TYP)

FARMERS STATE BANK & TRUST
 KRISTAINNE BECKER HOFFMAN
 ELIZABETH FRENCH BECKER

TEMPORARY EASEMENT
 REQUIRED FOR REGRADING
 OF DRAINAGE SWALE.
 SEE SHEET - OF -

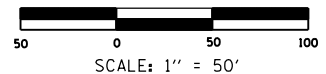

FILE NAME = e:\p\work\p\midot\sparksg\1d0264875\EC_Mainline1-14.dgn	USER NAME = Sparksgw	DESIGNED -	REVISED -	STATE OF ILLINOIS DEPARTMENT OF TRANSPORTATION	STORM WATER POLLUTION PREVENTION PLAN			F.A.P. RTE. 310	SECTION 69-3	COUNTY MORGAN	TOTAL SHEETS 793	SHEET NO. 383
PLOT SCALE = 100.0000' / in.	CHECKED -	REVISED -	REVISED -		SCALE:	SHEET NO.	OF SHEETS	STA. 860+00.00	TO STA. 875+00.00	CONTRACT NO. 72667		
PLOT DATE = Mar-30-2011 09:44:07AM	DATE -	REVISED -	REVISED -		FED. ROAD DIST. NO. ILLINOIS FED. AID PROJECT							