

NOTE:
PE AND CE ENTRANCE RETURNS HAVE
BEEN COMPLETED IN 2010 TOGETHER
WITH STORM SEWER PROJECT (C-96-108-08)
STA. 815+90.24 TO 824+00

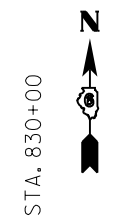

STA. 830+00

MATCH LINE 830+00

MATCH LINE 821+00



§ CURVE DATA
P.I. STA=845+30.3
Δ = 45°-00'-06"
D = 3°-58'-59"
R = 1,438.49'
T = 595.87'
L = 1,129.83
E = 118.53'
S.E. = 0.0596''
STA = 837+89 TO 839+87.4
STA = 850+11.3 TO 852+10.1
P.C. STA = 839+34.43
P.T. STA = 850+64.26

STA. 830+00

STA. 835+00

STA. 840+00

SECTION 26
T21 - R7W - 3rd PM

SECTION 26
T21 - R7W - 3rd PM

MATCH LINE 830+00

MATCH LINE 844+00

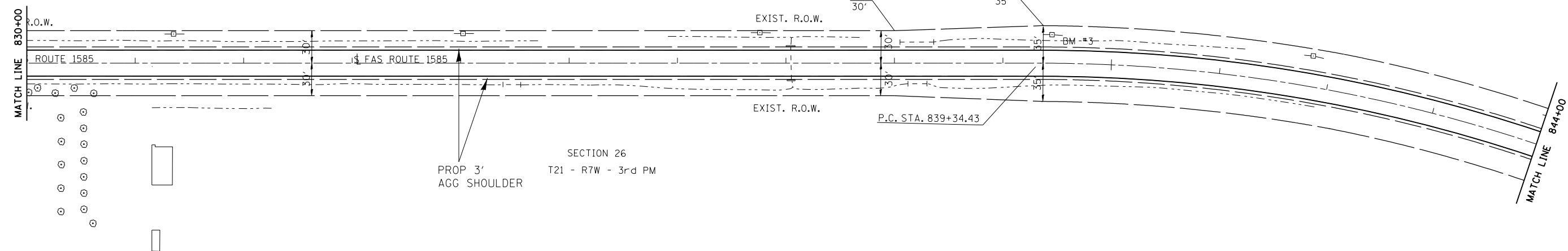

FILE NAME =	USER NAME = Sparksgw	DESIGNED -	REVISED -
ei:\pwork\pwork\sparksgw\10255669\06728\28-sht-plan sheets.dgn		DRAWN -	REVISED -
	PLOT SCALE = 100.0000' / in.	CHECKED -	REVISED -
	PLOT DATE = Mar-25-2011 10:16:35AM	DATE -	REVISED -

STATE OF ILLINOIS
DEPARTMENT OF TRANSPORTATION

PLAN SHEET

SCALE: SHEET NO. OF SHEETS STA. TO STA.

F.A.S. RTE.	SECTION	COUNTY	TOTAL SHEETS	SHEET NO.
1585	4R5-6	MASON	27	10
CONTRACT NO. 72E28				
ILLINOIS FED. AID PROJECT				