

F.A.I. RTE.	SECTION	COUNTY	TOTAL SHEETS	SHEET NO.
72	D7 BRIDGE REPAIRS 2011-2	MACON	25	1
ILLINOIS			CONTRACT NO. 74487	

STATE OF ILLINOIS
DEPARTMENT OF TRANSPORTATION
DIVISION OF HIGHWAYS

**PROPOSED
HIGHWAY PLANS**

FAI ROUTE 72 (I-72)
SECTION D7 BRIDGE REPAIRS 2011-2

BRIDGE DECK REPAIRS
MACON COUNTY

C-97-138-10

FOR INDEX OF SHEETS, SEE SHEET NO. 2

ADT = 11,300 (2010)

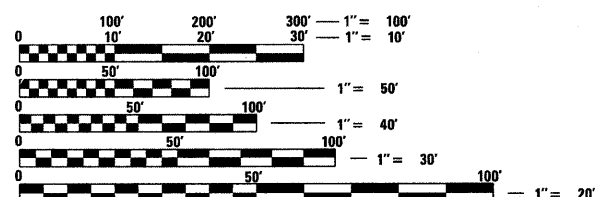
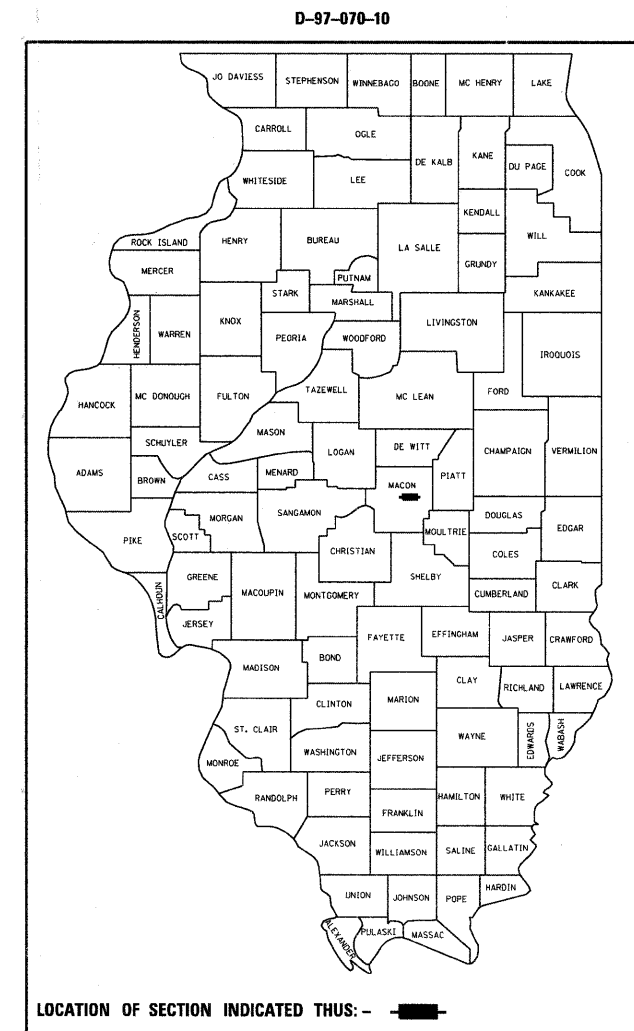

FULL SIZE PLANS HAVE BEEN PREPARED USING STANDARD ENGINEERING SCALES. REDUCED SIZED PLANS WILL NOT CONFORM TO STANDARD SCALES. IN MAKING MEASUREMENTS ON REDUCED PLANS, THE ABOVE SCALES MAY BE USED.

J.U.L.I.E.
JOINT UTILITY LOCATION INFORMATION FOR EXCAVATION
1-800-892-0123
OR 811

PROJECT ENGINEER: TOM RONAN
PROJECT MANAGER: JENNIFER WENTHE
PHONE: 217-342-8361
CONTRACT NO. 74487

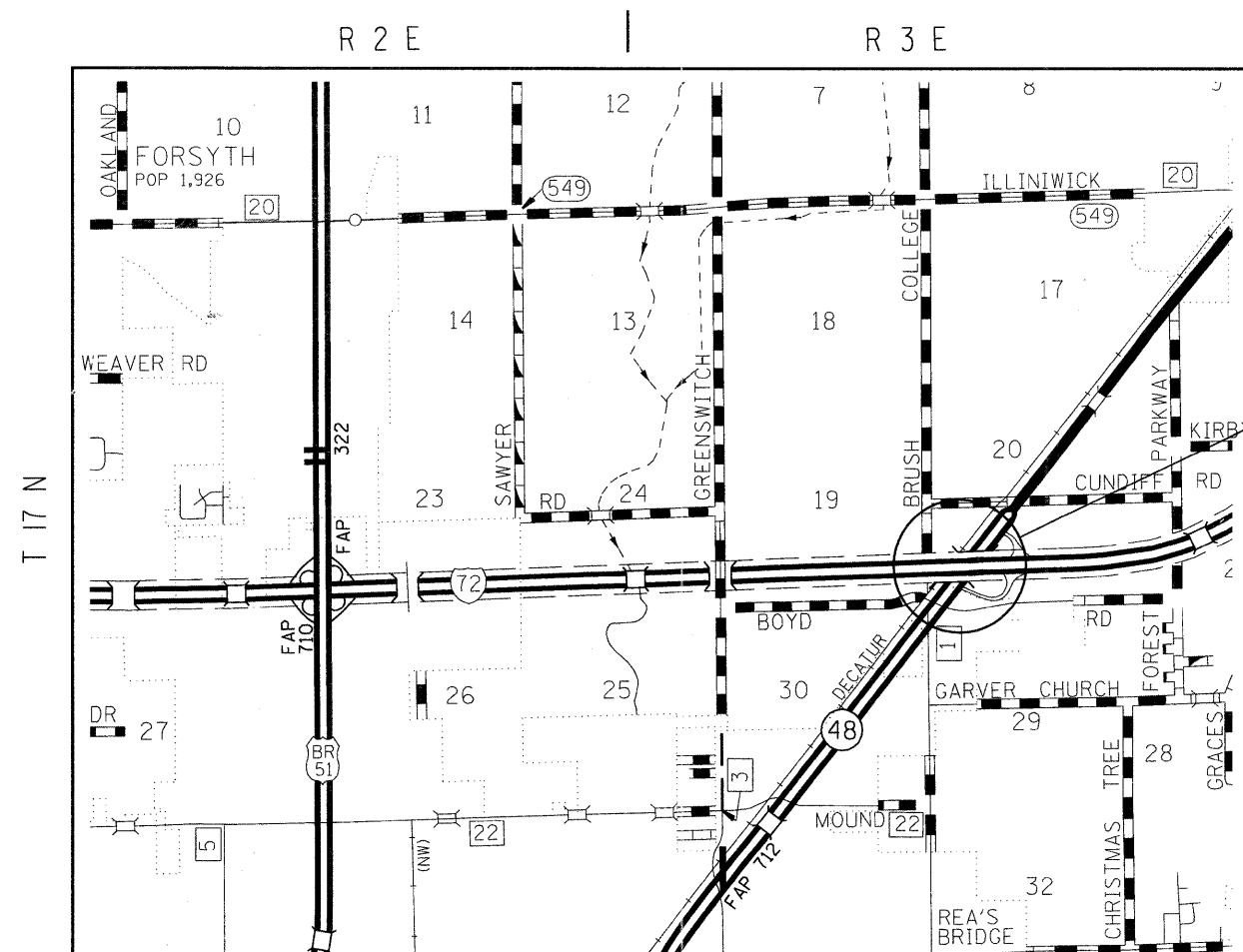

PROJECT LOCATION
SECTION D7 BRIDGE REPAIRS 2011-2
STRUCTURE #058-0084 & #058-0085

STATE OF ILLINOIS
DEPARTMENT OF TRANSPORTATION
DIVISION OF HIGHWAYS

SUBMITTED Feb 8 2011
Ryan J. Whickell
DEPUTY DIRECTOR OF HIGHWAYS, REGION ENGINEER

May 13 2011
Scott E. Stitt P.E. acting
ENGINEER OF DESIGN AND ENVIRONMENT

May 13 2011
Christine M. Roedel
DIRECTOR OF HIGHWAYS, CHIEF ENGINEER

PRINTED BY THE AUTHORITY
OF THE STATE OF ILLINOIS

GROSS LENGTH = 975 FT. = 0.18 MILE
NET LENGTH = 975 FT. = 0.18 MILE

INDEX OF SHEETS

SHEET NO.	ITEM
1	COVER SHEET
2	INDEX OF SHEETS AND GENERAL NOTES
3	SUMMARY OF QUANTITIES
4	TYPICAL SECTIONS
5	SCHEDULE OF QUANTITIES
6	PLAN DETAIL
7-9	STAGE I TRAFFIC CONTROL
10-12	STAGE II TRAFFIC CONTROL
13-14	PAVEMENT MARKING DETAILS
15-25	STRUCTURE REPAIR PLANS

THE FOLLOWING STANDARDS ARE A PART OF THESE PLANS AND ARE INCLUDED AFTER SHEET NO. 25:

STD. NO.	DESCRIPTION
000001-06	STANDARD SYMBOLS, ABBREVIATIONS AND PATTERNS
001001-02	AREAS OF REINFORCEMENT BARS
001006	DECIMAL OF AN INCH AND OF A FOOT
420701-02	PAVEMENT FABRIC
701101-02	OFF-ROAD OPERATIONS, MULTI-LANE, 15' TO 24" FROM PAVEMENT EDGE AWAY
701400-05	APPROACH TO LANE CLOSURE, FREEWAY/EXPRESSWAY
701401-06	LANE CLOSURE, FREEWAY/EXPRESSWAY
701402-08	LANE CLOSURE, FREEWAY/EXPRESSWAY, WITH BARRIER
701411-07	LANE CLOSURE, MULTI-LANE AT ENTRANCE OR EXIT RAMP, FOR SPEEDS >= 45 MPH
701426-04	LANE CLOSURE, MULTI-LANE, INTERMITTENT OR MOVING OPER., FOR SPEEDS >= 45 MPH
701601-07	URBAN LANE CLOSURE, MULTILANE, 1W OR 2W WITH NONTRAVERSABLE MEDIAN
701901-01	TRAFFIC CONTROL DEVICES
704001-06	TEMPORARY CONCRETE BARRIER
780001-02	TYPICAL PAVEMENT MARKINGS
781001-03	TYPICAL APPLICATIONS RAISED REFLECTIVE PAVEMENT MARKERS

GENERAL NOTES

THIS SECTION SHALL BE CONSTRUCTED IN ACCORDANCE WITH THE PLANS; THE "STANDARD SPECIFICATIONS FOR ROAD AND BRIDGE CONSTRUCTION" ADOPTED JANUARY 1, 2007; AND THE SPECIAL PROVISIONS INCLUDED IN THE PROPOSAL.

THIS PROJECT IS LOCATED ON FAI 72 IN MACON COUNTY, APPROXIMATELY 2.5 MILES EAST OF FORSYTH AT STRUCTURE NUMBERS 058-0084 AND 058-0085. THE WORK INCLUDED IN SECTION D7 BRIDGE REPAIRS 2011-2 CONSISTS OF PCC BASE COURSE WIDENING, TRAFFIC CONTROL, BRIDGE DECK REPAIRS, PAVEMENT MARKING, AND OTHER WORK NECESSARY TO COMPLETE THE SECTION.

PLAN DIMENSIONS AND DETAILS RELATIVE TO THE EXISTING STRUCTURES HAVE BEEN TAKEN FROM EXISTING PLANS AND ARE SUBJECT TO NOMINAL CONSTRUCTION VARIATIONS. IT SHALL BE THE CONTRACTORS RESPONSIBILITY TO VERIFY DIMENSIONS AND DETAILS IN THE FIELD AND MAKE NECESSARY APPROVED ADJUSTMENTS PRIOR TO CONSTRUCTION OR ORDERING OF MATERIAL. SUCH VARIATIONS SHALL NOT BE CAUSE FOR ADDITIONAL COMPENSATION FOR A CHANGE IN THE SCOPE OF THE WORK. THE CONTRACTOR WILL BE PAID FOR THE QUANTITY FURNISHED AT THE UNIT PRICE BID FOR THE WORK.

PAVEMENT MARKING SHALL BE APPLIED IN ACCORDANCE WITH SECTION 780 OF THE STANDARD SPECIFICATIONS.

THE TOTAL QUANTITY OF URETHANE PAVEMENT MARKING-LINE 4" CONSISTS OF 1,775 FEET OF WHITE AND 1,775 FEET OF YELLOW.

THE TOTAL QUANTITY OF URETHANE PAVEMENT MARKING-LINE 6" CONSISTS OF 444 FEET OF WHITE.

RAISED REFLECTIVE PAVEMENT MARKERS SHALL BE PLACED AS DOUBLE MARKERS AS SHOWN ON STANDARD 781001.

THE SAW CUT REQUIRED FOR THE PAVED SHOULDER REMOVAL SHALL BE INCLUDED IN THE COST OF PAVED SHOULDER REMOVAL AND NO ADDITIONAL COMPENSATION WILL BE ALLOWED. ANY EXCAVATION NECESSARY FOR CONSTRUCTION OF THE PCC BASE COURSE WIDENING, 10" SHALL BE INCLUDED IN THE COST OF THE PCC BASE COURSE WIDENING, 10" AND NO ADDITIONAL COMPENSATION SHALL BE ALLOWED.

IN ADDITIONAL TO THE REQUIREMENTS FOR PORTABLE CHANGEABLE MESSAGE SIGNS IN ARTICLE 701.15(I), A LAPTOP COMPUTER TO CONTROL THE MESSAGE SIGNS SHALL ALSO BE SUPPLIED BY THE CONTRACTOR.

THE FOLLOWING RATES OF APPLICATION HAVE BEEN USED IN THE CALCULATING PLAN QUANTITIES:

AGGREGATE SUBBASE 2.05 TONS/CU YD

FILE NAME =	USER NAME = #USER#	DESIGNED -	REVISED -	STATE OF ILLINOIS DEPARTMENT OF TRANSPORTATION	INDEX OF SHEETS AND GENERAL NOTES			F.A.I. RTE.	SECTION	COUNTY	TOTAL SHEETS	SHEET NO.
#FILE#		DRAWN -	REVISED -		72	D7 BRIDGE REPAIRS 2011-2	MACON	25	2			
	PLOT SCALE = #SCALE#	CHECKED -	REVISED -		CONTRACT NO. 74487							
	PLOT DATE = #DATE#	DATE -	REVISED -		SCALE: NA	SHEET NO. 1 OF 1 SHEETS	STA. TO STA.	ILLINOIS FED. AID PROJECT				

SUMMARY OF QUANTITIES			TOTAL QUANTITIES	CONSTRUCTION TYPE CODE 100% STATE 0014
CODE NO	ITEM	UNIT		
31101000	SUBBASE GRANULAR MATERIAL, TYPE B	TON	122	122
35400500	PORTLAND CEMENT CONCRETE BASE COURSE WIDENING 10"	SQ YD	1071	1071
42001200	PAVEMENT FABRIC	SQ YD	1071	1071
44004250	PAVED SHOULDER REMOVAL	SQ YD	972	972
50102400	CONCRETE REMOVAL	CU YD	5.6	5.6
50157300	PROTECTIVE SHIELD	SQ YD	1657	1657
50300100	FLOOR DRAINS	EACH	28	28
50300255	CONCRETE SUPERSTRUCTURE	CU YD	5.6	5.6
50300260	BRIDGE DECK GROOVING	SQ YD	2908	2908
50300300	PROTECTIVE COAT	SQ YD	502	502
50800205	REINFORCEMENT BARS, EPOXY COATED	POUND	840	840
67000500	ENGINEER'S FIELD OFFICE, TYPE B	CAL MO	4	4
67100100	MOBILIZATION	L SUM	1	1
70100207	TRAFFIC CONTROL AND PROTECTION, STANDARD 701402	EACH	1	1
70100420	TRAFFIC CONTROL AND PROTECTION, STANDARD 701411	EACH	2	2
70100800	TRAFFIC CONTROL AND PROTECTION, STANDARD 701401	L SUM	1	1
70102630	TRAFFIC CONTROL AND PROTECTION, STANDARD 701601	L SUM	1	1
70103815	TRAFFIC CONTROL SURVEILLANCE	CAL DA	5	5
70300100	SHORT TERM PAVEMENT MARKING	FOOT	320	320
70301000	WORK ZONE PAVEMENT MARKING REMOVAL	SQ FT	107	107
70400100	TEMPORARY CONCRETE BARRIER	FOOT	1175	1175
70400200	RELOCATE TEMPORARY CONCRETE BARRIER	FOOT	1175	1175
78100105	RAISED REFLECTIVE PAVEMENT MARKER (BRIDGE)	EACH	20	20
78300100	PAVEMENT MARKING REMOVAL	SQ FT	871	871
X7800610	URETHANE PAVEMENT MARKING - LINE 4"	FOOT	3550	3550
X7800630	URETHANE PAVEMENT MARKING - LINE 6"	FOOT	444	444
XZ191200	BRIDGE DECK MICROSILICA CONCRETE OVERLAY 2 1/2"	SQ YD	3062	3062
Z0004556	HOT-MIX ASPHALT SURFACE REMOVAL (DECK)	SQ YD	3062	3062
Z0012130	BRIDGE DECK SCARIFICATION (3/4 INCH)	SQ YD	3062	3062
Z0015802	PLUG EXISTING DECK DRAINS	EACH	28	28
Z0016001	DECK SLAB REPAIR (FULL DEPTH, TYPE I)	SQ YD	4	4
Z0016002	DECK SLAB REPAIR (FULL DEPTH, TYPE II)	SQ YD	335	335
Z0030250	IMPACT ATTENUATORS, TEMPORARY (NON- REDIRECTIVE), TEST LEVEL 3	EACH	2	2
Z0030350	IMPACT ATTENUATORS, RELOCATE (NON- REDIRECTIVE), TEST LEVEL 3	EACH	2	2
Z0048665	RAILROAD PROTECTIVE LIABILITY INSURANCE	L SUM	1	1

FILE NAME =	USER NAME = #USER#	DESIGNED -	REVISED -	STATE OF ILLINOIS DEPARTMENT OF TRANSPORTATION	SUMMARY OF QUANTITIES			F.A.I. RTE.	SECTION	COUNTY	TOTAL SHEETS	SHEET NO.
#FILE#		DRAWN -	REVISED -					72	D7 BRIDGE REPAIRS 2011-2	MACON	25	3
	PLOT SCALE = #SCALE#	CHECKED -	REVISED -		SCALE: NA	SHEET NO. 1 OF 1 SHEETS	STA.	TO STA.	CONTRACT NO. 74487			
	PLOT DATE = #DATE#	DATE -	REVISED -		ILLINOIS FED. AID PROJECT							

TYPICAL CROSS SECTION

STA. 318+75 TO STA. 327+50 (EB)
 STA. 321+00 TO STA. 328+50 (WB)
 SEE PLAN DETAIL FOR EXACT LOCATIONS
 (SHEET NO. 6)

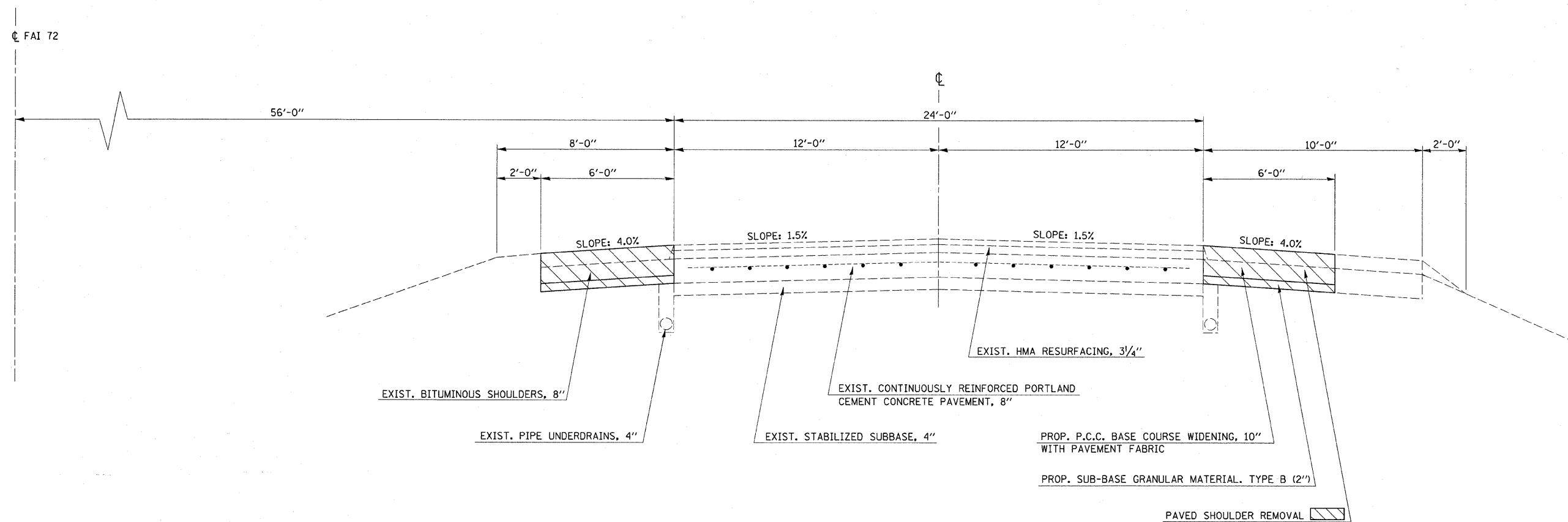

NOTE: NOT DRAWN TO SCALE

FILE NAME =	USER NAME = swartzw	DESIGNED -	REVISED -	STATE OF ILLINOIS DEPARTMENT OF TRANSPORTATION	TYPICAL CROSS SECTIONS			F.A.I. RTE.	SECTION	COUNTY	TOTAL SHEETS	SHEET NO.	
cr\pw_work\p\dot\swartzw\d8289408\d77	487-shr-typicals.dgn	DRAWN -	REVISED -		SCALE: NA	SHEET NO. 1 OF 1 SHEETS	STA.	TO STA.	72	07 BRIDGE REPAIRS 2011-2	MACON	25	4
	PLOT SCALE = 20.0000' / IN.	CHECKED -	REVISED -										
	PLOT DATE = 2/7/2011	DATE -	REVISED -										
ILLINOIS FED. AID PROJECT													

PAVEMENT MARKING SCHEDULE		URETHANE PAVEMENT MARKING - LINE 4"	URETHANE PAVEMENT MARKING - LINE 6"	PAVEMENT MARKING REMOVAL	SHORT TERM PAVEMENT MARKING	WORK ZONE PAVEMENT MARKING REMOVAL	RAISED REFLECTIVE PAVEMENT MARKER (BRIDGE)
STATION TO STATION		FOOT	FOOT	SQ FT	FOOT	SQ FT	EACH
EB							
318+75.00	TO 319+00.00	50.0	6.3	0.0	4.5	1.5	0.0
319+00.00	TO 321+42.00	484.0	60.5	136.0	43.6	14.5	0.0
321+42.00	TO 324+88.99	694.0	86.7	231.3	62.5	20.8	10.0
324+88.99	TO 329+00.00	822.0	102.8	125.0	74.0	24.7	0.0
WB							
321+00.00	TO 322+35.38	270.8	33.8	74.3	24.4	8.1	0.0
322+35.38	TO 325+82.37	694.0	86.7	231.3	62.5	20.8	10.0
325+82.37	TO 328+50.00	535.3	66.9	72.7	48.2	16.1	0.0
TOTALS		3550.0	444.0	871.0	320.0	107.0	20.0

TRAFFIC CONTROL DEVICES SCHEDULE		TEMPORARY CONCRETE BARRIER	RELOCATE TEMPORARY CONCRETE BARRIER	IMPACT ATTENUATORS, TEMPORARY (NON-REDIRECTIVE), TEST LEVEL 3	IMPACT ATTENUATORS, RELOCATE (NON-REDIRECTIVE), TEST LEVEL 3
STATION TO STATION		FOOT	FOOT	SQ FT	FOOT
STAGE I					
EB	319+26.00 TO 321+00.00	175.0	0.0	1.0	0.0
EB	321+00.00 TO 325+12.50	412.5	0.0	0.0	0.0
WB	322+12.50 TO 326+25.00	412.5	0.0	0.0	0.0
WB	326+25.00 TO 328+00.00	175.0	0.0	1.0	0.0
STAGE II					
EB	319+26.00 TO 321+00.00	0.0	175.0	0.0	1.0
EB	321+00.00 TO 325+12.50	0.0	412.5	0.0	0.0
WB	322+12.50 TO 326+25.00	0.0	412.5	0.0	0.0
WB	326+25.00 TO 328+00.00	0.0	175.0	0.0	1.0
TOTALS		1175.0	1175.0	2.0	2.0

WIDENING SCHEDULE		SUBBASE GRANULAR MATERIAL, TYPE B	PORTLAND CEMENT CONCRETE BASE COURSE WIDENING, 10"	PAVEMENT FABRIC	PAVED SHOULDER REMOVAL
STATION TO STATION		TON	SQ YD	SQ YD	SQ YD
EB					
318+75.00	TO 319+00.00	1.9	16.7	16.7	16.7
319+00.00	TO 321+42.00	36.7	322.7	322.7	322.7
321+42.00	TO 324+88.99	0.0	0.0	0.0	0.0
324+88.99	TO 329+00.00	41.5	364.7	364.7	265.7
WB					
321+00.00	TO 322+35.38	20.5	180.3	180.3	180.3
322+35.38	TO 325+82.37	0.0	0.0	0.0	0.0
325+82.37	TO 328+50.00	21.3	186.8	186.8	186.8
TOTALS		122.0	1071.0	1071.0	972.0

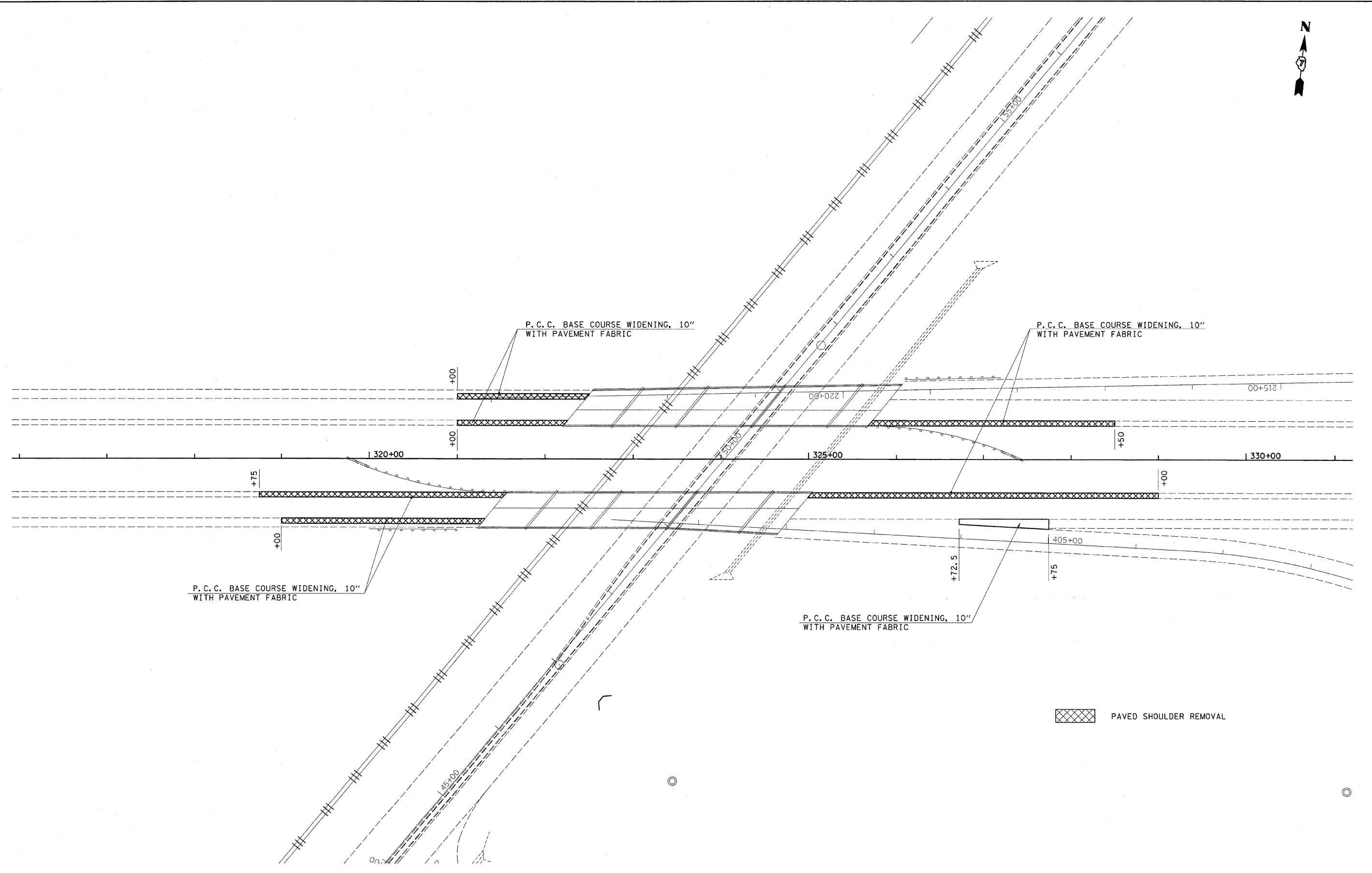

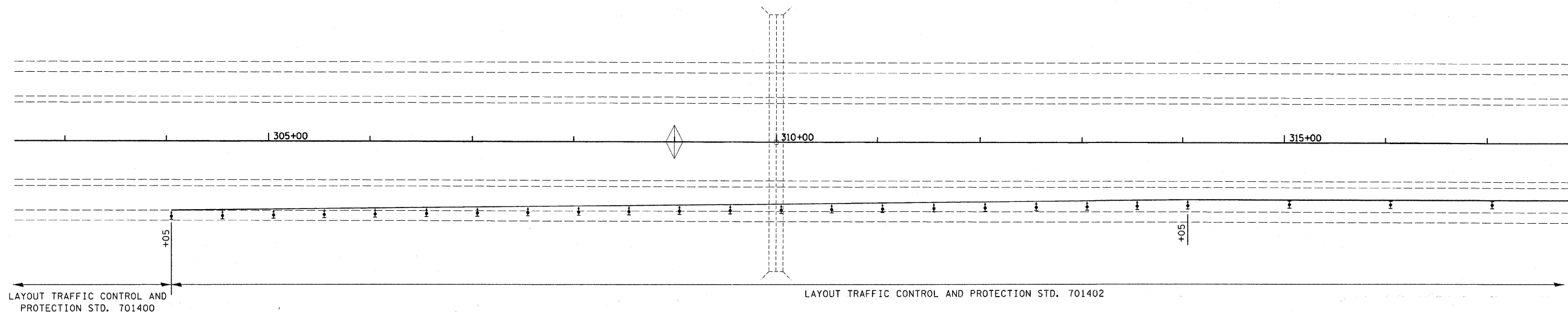

 PAVED SHOULDER REMOVAL

FILE NAME =	USER NAME = swartzw	DESIGNED -	REVISED -	STATE OF ILLINOIS DEPARTMENT OF TRANSPORTATION	PLAN DETAIL			F.A.I. RTE.	SECTION	COUNTY	TOTAL SHEETS	SHEET NO.	
c:\pw\work\pwidot\swartzw\d0209400\d77	487-sht-trafocontrol.dgn	DRAWN -	REVISED -		SCALE: 50	SHEET NO. 1 OF 1 SHEETS	STA. 316+00 TO STA. 331+00	72	07 BRIDGE REPAIRS 2011-2	MACON	25	6	
	PLOT SCALE = 50.0000' / IN.	CHECKED -	REVISED -										CONTRACT NO. 74487
	PLOT DATE = 2/7/2011	DATE -	REVISED -										ILLINOIS FED. AID PROJECT



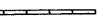

LEGEND

- 
 DIRECTIONAL INDICATOR BARRICADE
W/STEADY BURN MONODIRECTIONAL
LIGHT
- 
 TYPE II BARRICADE DRUM OR
VERTICAL BARRICADE W/STEADY
BURN MONODIRECTIONAL LIGHT
- 
 IMPACT ATTENUATORS, TEMPORARY
(NON-REDIRECTIVE) TEST LEVEL 3
- 
 TEMPORARY CONCRETE BARRIER

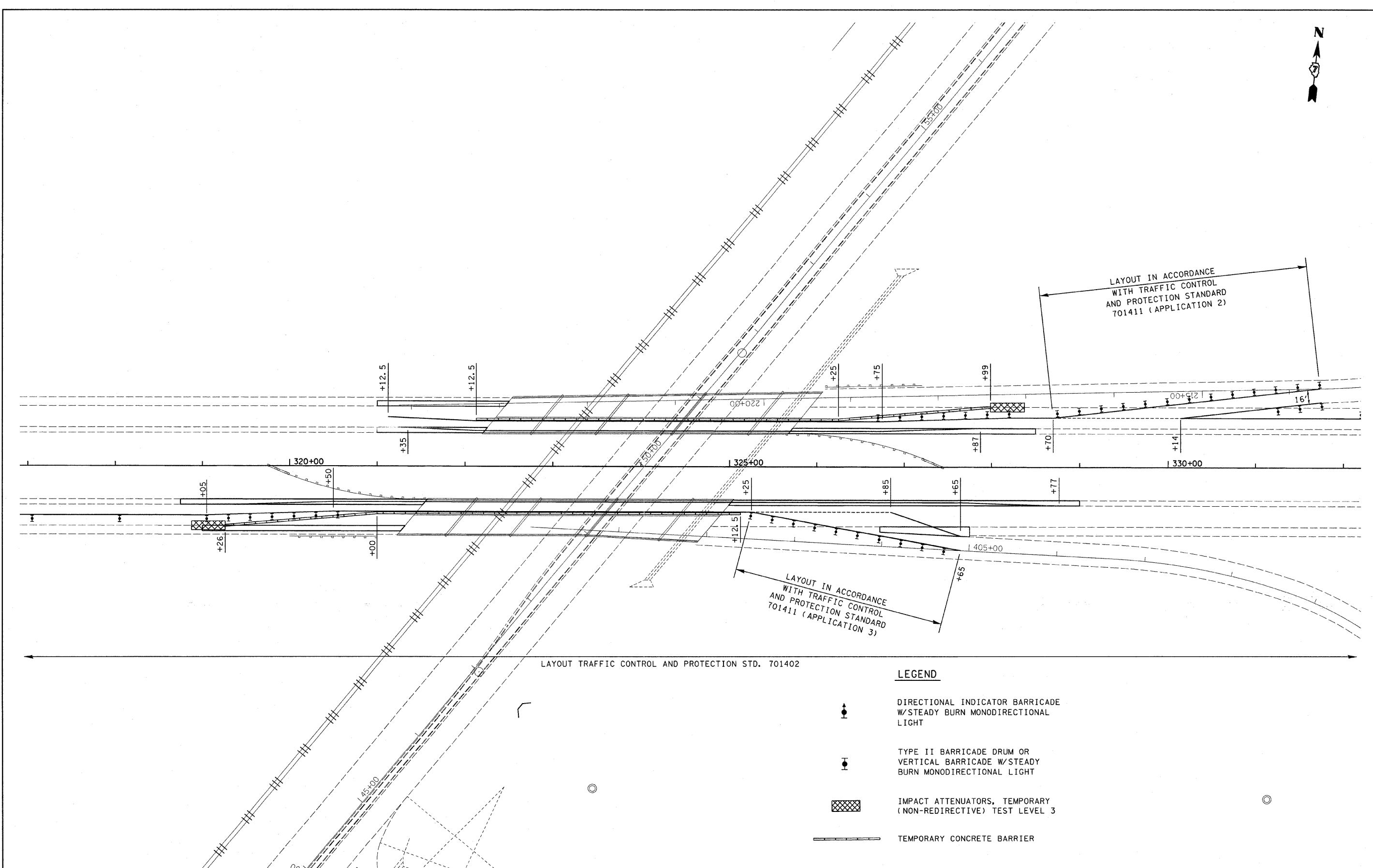
FILE NAME =	USER NAME = swartzw	DESIGNED -	REVISED -	STATE OF ILLINOIS DEPARTMENT OF TRANSPORTATION	STAGE 1 TRAFFIC CONTROL	F.A.I. RTE.	SECTION	COUNTY	TOTAL SHEETS	SHEET NO.	
ca:\pe_work\pwidot\swartzw\08289480\d77	487-shr-trafficcontrol.dgn	DRAWN -	REVISED -			72	07 BRIDGE REPAIRS 2011-2	MACON	25	7	
	PLOT SCALE = 50.0000' / IN.	CHECKED -	REVISED -			CONTRACT NO. 74487					
	PLOT DATE = 2/7/2011	DATE -	REVISED -			ILLINOIS FED. AID PROJECT					
				SCALE: 50	SHEET NO. 1 OF 3 SHEETS	STA. 303+00	TO STA. 317+00				

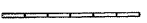

LEGEND

-  DIRECTIONAL INDICATOR BARRICADE W/STEADY BURN MONODIRECTIONAL LIGHT
-  TYPE II BARRICADE DRUM OR VERTICAL BARRICADE W/STEADY BURN MONODIRECTIONAL LIGHT
-  IMPACT ATTENUATORS, TEMPORARY (NON-REDIRECTIVE) TEST LEVEL 3
-  TEMPORARY CONCRETE BARRIER

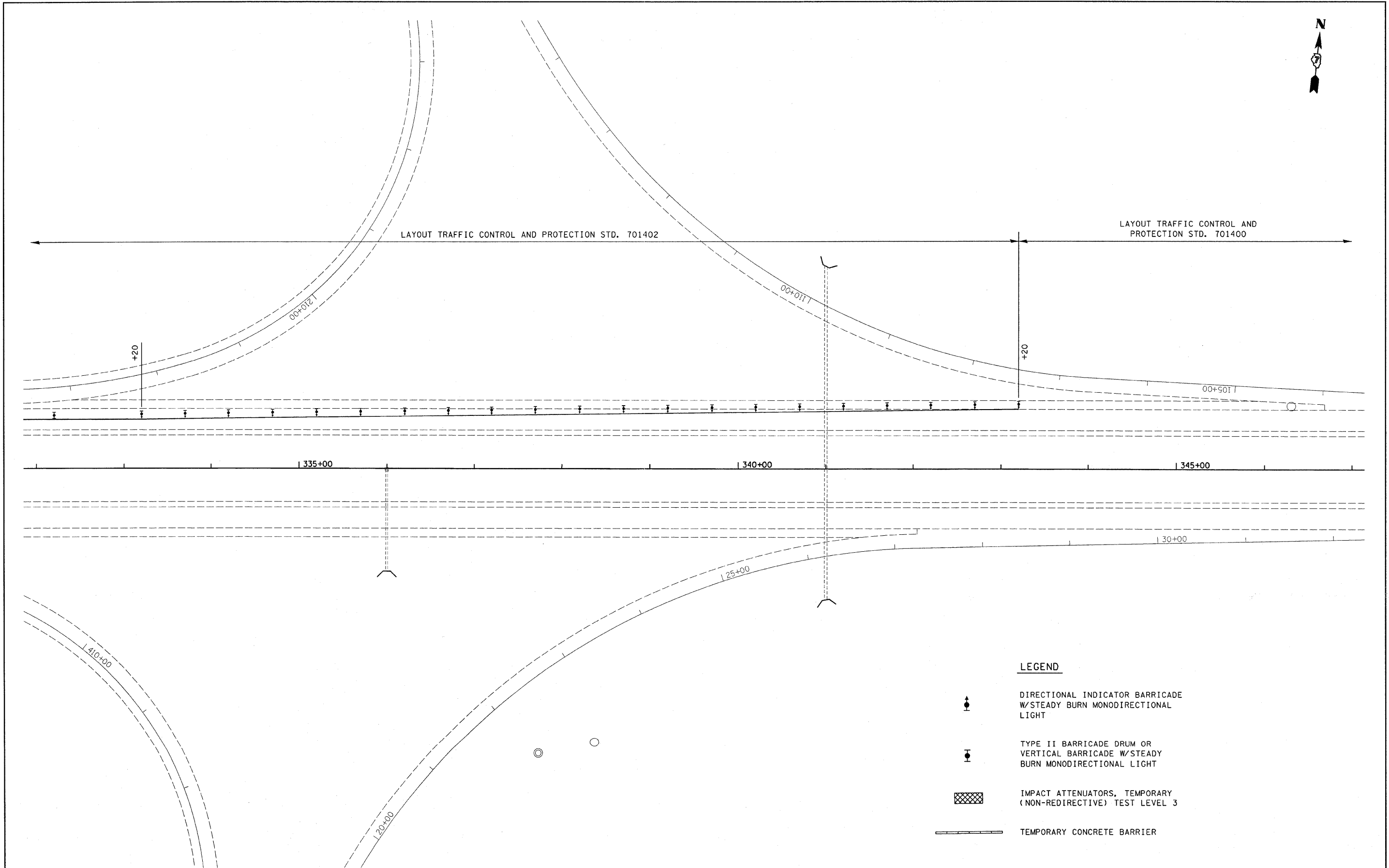

FILE NAME =	USER NAME = swartzw	DESIGNED -	REVISED -	STATE OF ILLINOIS DEPARTMENT OF TRANSPORTATION	STAGE 1 TRAFFIC CONTROL	F.A.I. RTE.	SECTION	COUNTY	TOTAL SHEETS	SHEET NO.
c:\pw\work\pw\dot\swartzw\d0209400\vd77	487-sh-t-trafficcontrol.dgn	DRAWN -	REVISED -			72	07 BRIDGE REPAIRS 2011-2	MACON	25	8
PLOT SCALE = 50.0000' / IN.	CHECKED -	REVISED -	REVISED -			CONTRACT NO. 74487				
PLOT DATE = 2/7/2011	DATE -	REVISED -	REVISED -			ILLINOIS FED. AID PROJECT				
					SCALE: 50	SHEET NO. 2 OF 3 SHEETS		STA. 317+00 TO STA. 332+00		

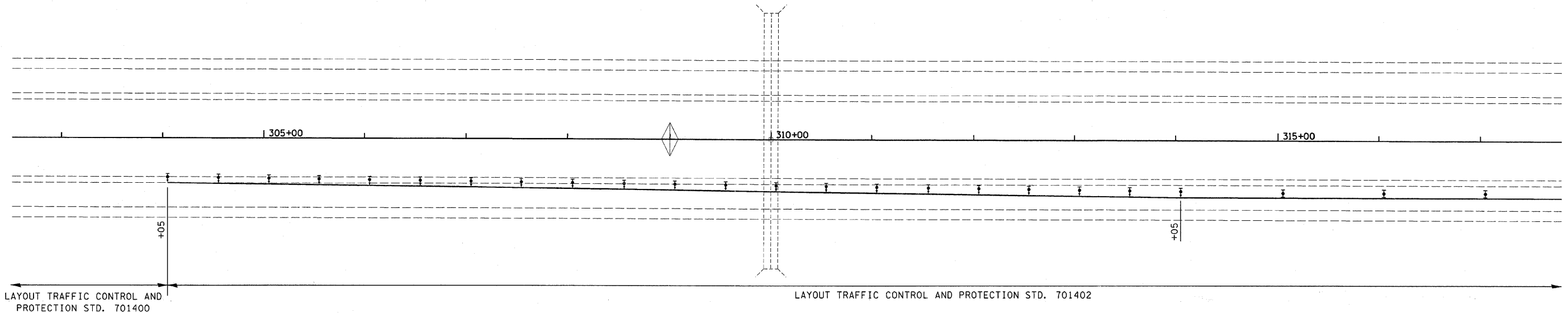

FILE NAME =	USER NAME = swartzw	DESIGNED -	REVISED -	STATE OF ILLINOIS DEPARTMENT OF TRANSPORTATION	STAGE 1 TRAFFIC CONTROL	F.A.I. RTE.	SECTION	COUNTY	TOTAL SHEETS	SHEET NO.
c:\pwwork\pwwork\swartzw\d8289400\d77	487-sh-t-rafcontrol.dgn	DRAWN -	REVISED -			72	D7 BRIDGE REPAIRS 2011-2	MACON	25	9
	PLOT SCALE = 50.0000' / IN.	CHECKED -	REVISED -			CONTRACT NO. 74487				
	PLOT DATE = 2/7/2011	DATE -	REVISED -			ILLINOIS FED. AID PROJECT				
					SCALE: 50	SHEET NO. 3 OF 3 SHEETS		STA. 332+00 TO STA. 347+00		



LEGEND

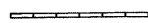

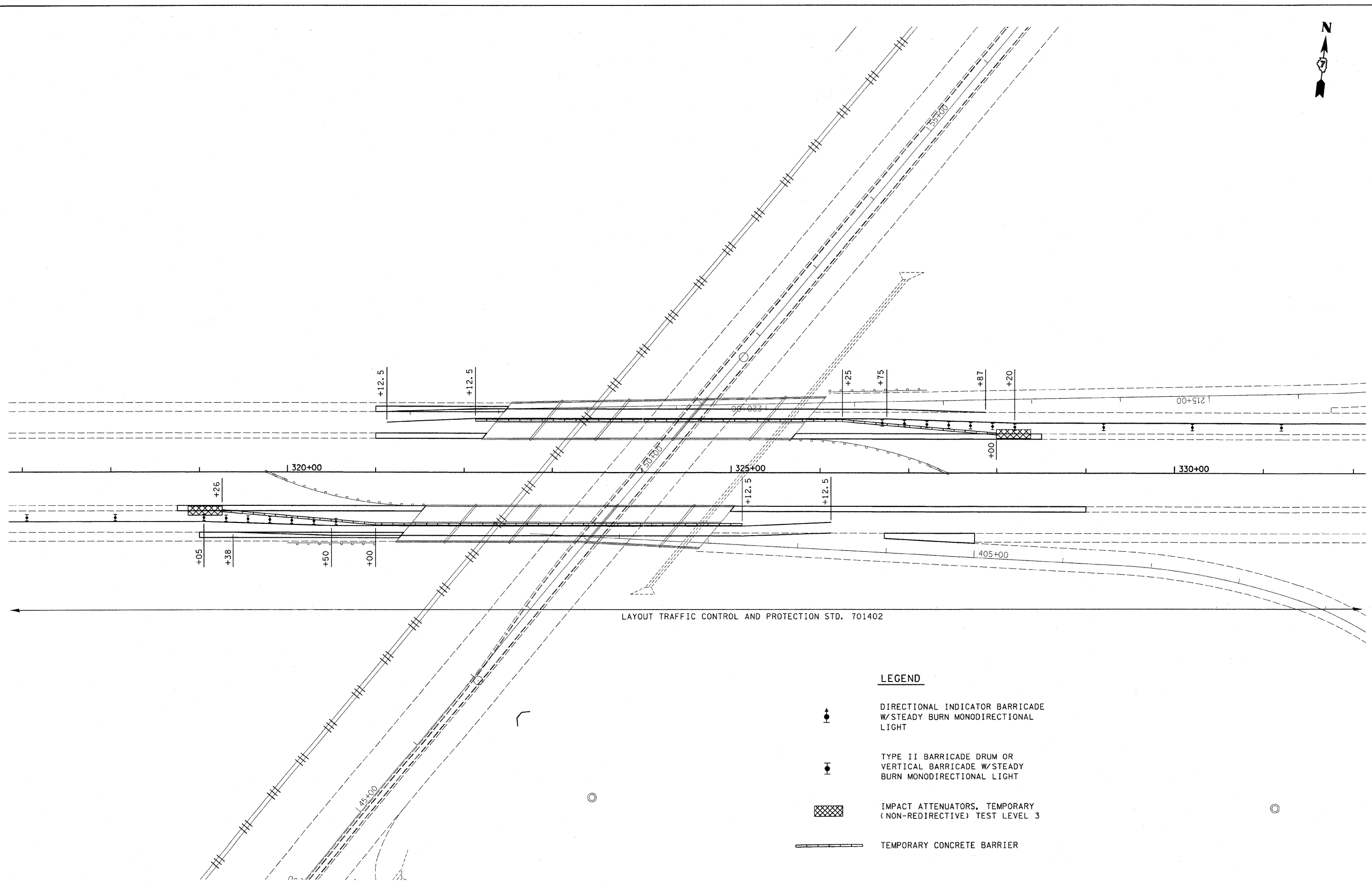

-  DIRECTIONAL INDICATOR BARRICADE W/STEADY BURN MONODIRECTIONAL LIGHT
-  TYPE II BARRICADE DRUM OR VERTICAL BARRICADE W/STEADY BURN MONODIRECTIONAL LIGHT
-  IMPACT ATTENUATORS, TEMPORARY (NON-REDIRECTIVE) TEST LEVEL 3
-  TEMPORARY CONCRETE BARRIER

FILE NAME =	USER NAME = swartzw	DESIGNED -	REVISED -	STATE OF ILLINOIS DEPARTMENT OF TRANSPORTATION	STAGE 2 TRAFFIC CONTROL		F.A.I. RTE.	SECTION	COUNTY	TOTAL SHEETS	SHEET NO.	
c:\pw_work\pwidot\swartzw\d8209400\d77487-shr-trafficcontrol.dgn		DRAWN -	REVISED -		SCALE: 50	SHEET NO. 1 OF 3 SHEETS	STA. 303+00 TO STA. 317+00	72	D7 BRIDGE REPAIRS 2011-2	MACON	25	10
	PLOT SCALE = 50.0000' / IN.	CHECKED -	REVISED -		CONTRACT NO. 74487							
	PLOT DATE = 2/7/2011	DATE -	REVISED -		ILLINOIS FED. AID PROJECT							



LAYOUT TRAFFIC CONTROL AND PROTECTION STD. 701402



LEGEND

-  DIRECTIONAL INDICATOR BARRICADE W/STEADY BURN MONODIRECTIONAL LIGHT
-  TYPE II BARRICADE DRUM OR VERTICAL BARRICADE W/STEADY BURN MONODIRECTIONAL LIGHT
-  IMPACT ATTENUATORS, TEMPORARY (NON-REDIRECTIVE) TEST LEVEL 3
-  TEMPORARY CONCRETE BARRIER

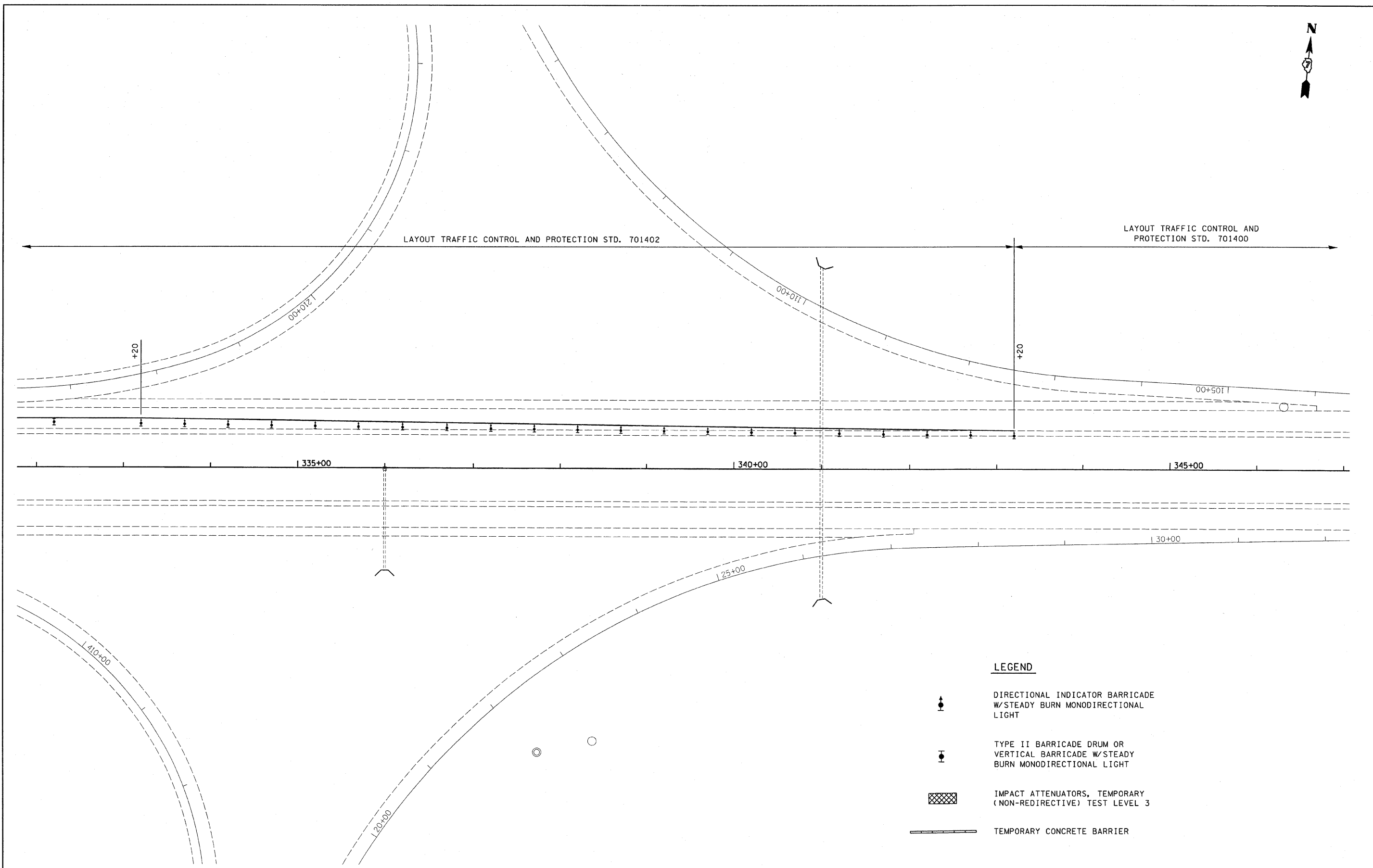
FILE NAME =	USER NAME = swartzw	DESIGNED -	REVISED -	STATE OF ILLINOIS DEPARTMENT OF TRANSPORTATION	STAGE 2 TRAFFIC CONTROL		F.A.I. RTE.	SECTION	COUNTY	TOTAL SHEETS	SHEET NO.	
c:\pw_work\pwsdot\swartzw\d0209400\d77	487-sht-trafficcontrol.dgn	DRAWN -	REVISED -		SCALE: 50	SHEET NO. 2 OF 3 SHEETS	STA. 317+00 TO STA. 332+00	72	D7 BRIDGE REPAIRS 2011-2	MACON	25	11
	PLOT SCALE = 50,0000 ' / IN.	CHECKED -	REVISED -		CONTRACT NO. 74487							
	PLOT DATE = 2/7/2011	DATE -	REVISED -		ILLINOIS FED. AID PROJECT							

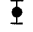

LEGEND

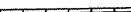
-  DIRECTIONAL INDICATOR BARRICADE W/STEADY BURN MONODIRECTIONAL LIGHT
-  TYPE II BARRICADE DRUM OR VERTICAL BARRICADE W/STEADY BURN MONODIRECTIONAL LIGHT
-  IMPACT ATTENUATORS, TEMPORARY (NON-REDIRECTIVE) TEST LEVEL 3
-  TEMPORARY CONCRETE BARRIER

FILE NAME =	USER NAME = swartzw	DESIGNED -	REVISED -	STATE OF ILLINOIS DEPARTMENT OF TRANSPORTATION	STAGE 2 TRAFFIC CONTROL	F.A.I. RTE.	SECTION	COUNTY	TOTAL SHEETS	SHEET NO.
at\p\work\p\dot\swartzw\48289420\477	487-shr-trafficcontrol.dgn	DRAWN -	REVISED -			72	07 BRIDGE REPAIRS 2011-2	MACON	25	12
	PLOT SCALE = 50.0000" / IN.	CHECKED -	REVISED -			CONTRACT NO. 74487				
	PLOT DATE = 2/7/2011	DATE -	REVISED -			ILLINOIS FED. AID PROJECT				
					SCALE: 50	SHEET NO. 3 OF 3 SHEETS		STA. 332+00 TO STA. 347+00		

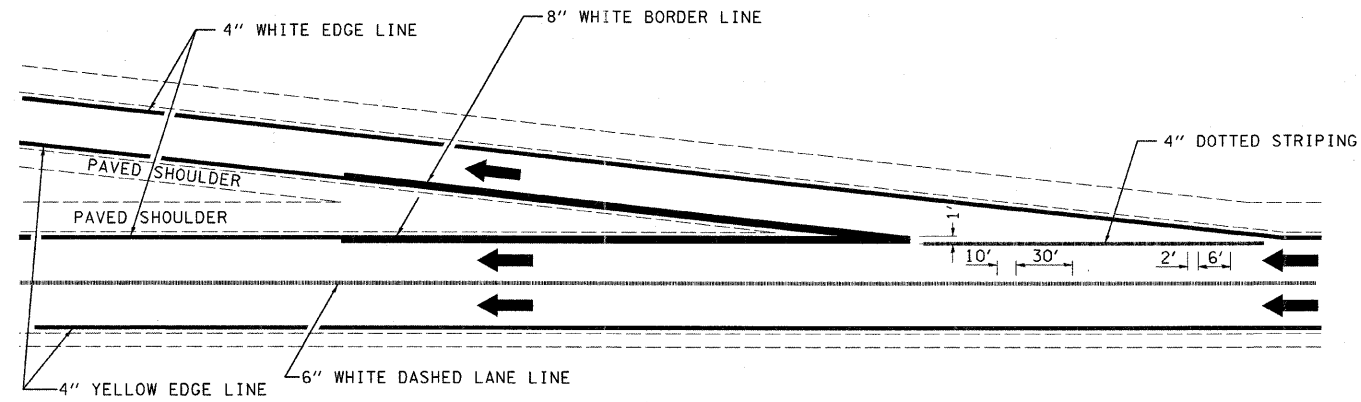

TYPICAL EXIT RAMP MARKING

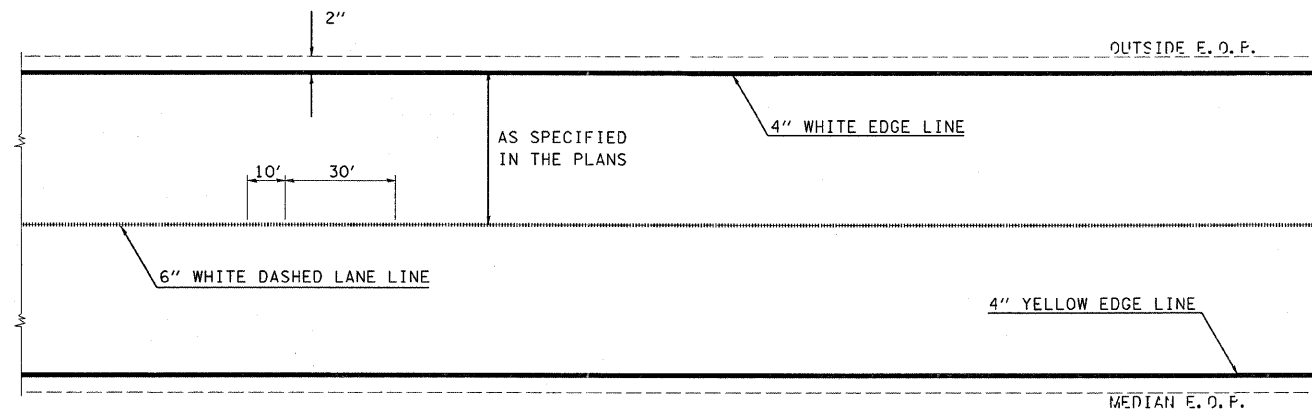

TYPICAL CENTERLINE & EDGELINE MARKINGS

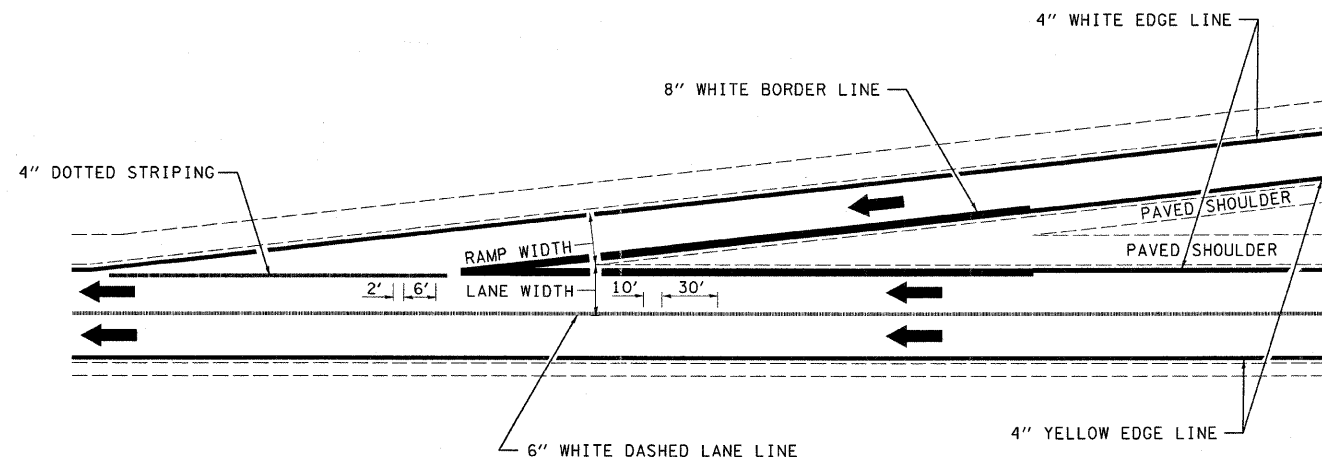

TYPICAL ENTRANCE RAMP MARKING

NOT TO SCALE

FILE NAME =	USER NAME = swartzrw	DESIGNED -	REVISOR - DRM 08-04
c:\pw\work\pwr\dot\swartzrw\d8289488\d77	487-ahd-details.dgn	DRAWN -	REVISOR - MKS 04-08
	PLOT SCALE = 50.0000 ' / IN.	CHECKED -	REVISOR - DRM 01-09
	PLOT DATE = 2/7/2011	DATE -	REVISOR - DRM 12-10

STATE OF ILLINOIS
DEPARTMENT OF TRANSPORTATION

TYPICAL APPLICATIONS OF INTERSTATE PAVEMENT MARKING

SCALE: NA SHEET NO. 1 OF 2 SHEETS STA. TO STA.

DISTRICT 7 DETAIL NO. 78000002

F.A.I. RTE.	SECTION	COUNTY	TOTAL SHEETS	SHEET NO.
72	D7 BRIDGE REPAIRS 2011-2	MACON	25	13
FED. ROAD DIST. NO. ILLINOIS FED. AID PROJECT			CONTRACT NO. 74487	

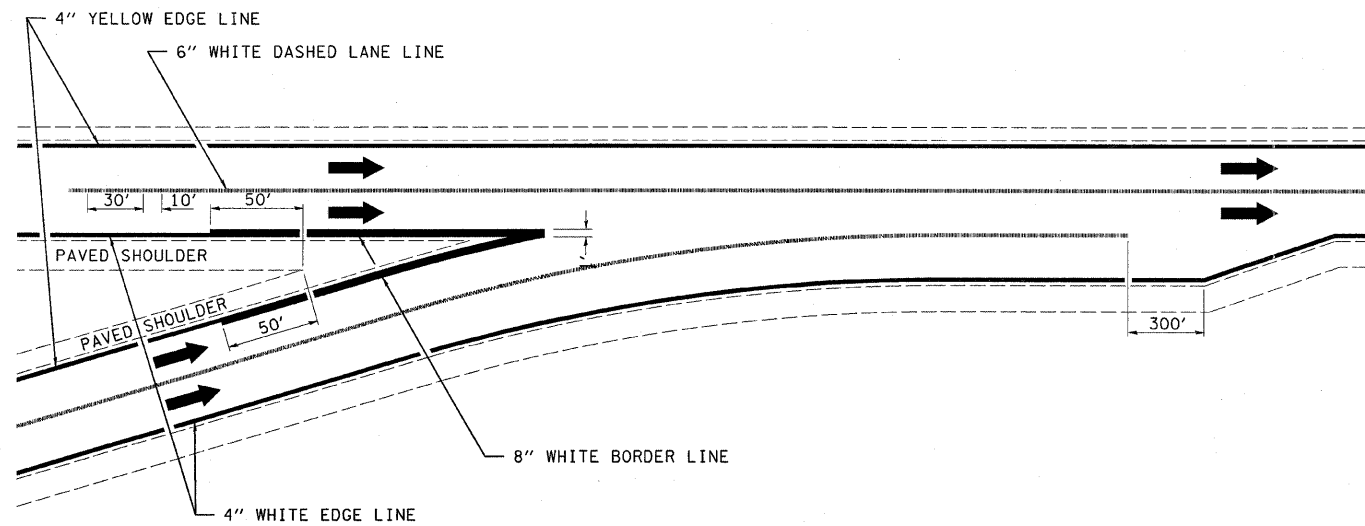

TYPICAL CONVERGENCE MARKING

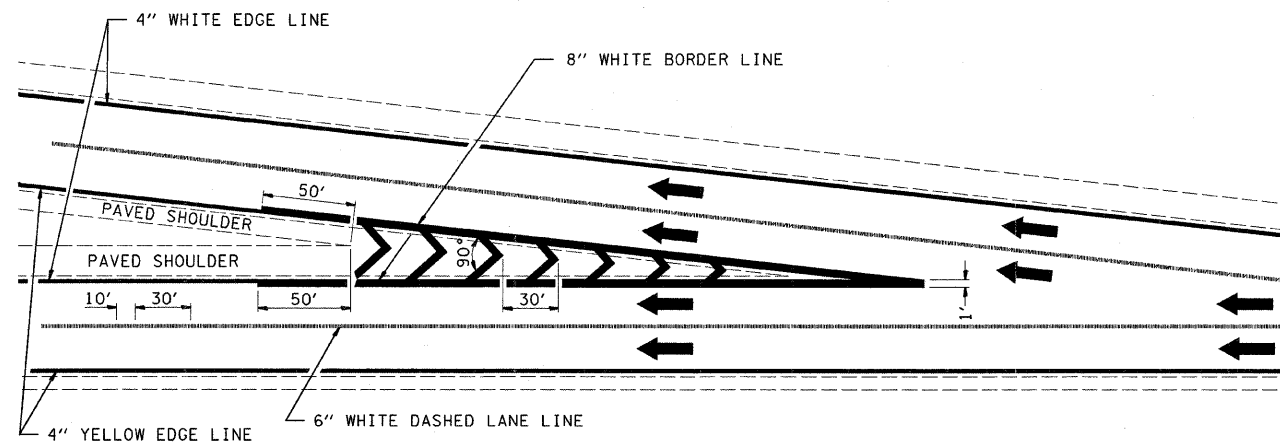

TYPICAL DIVERGENCE MARKING

AERIAL SPEED CHECK ZONES

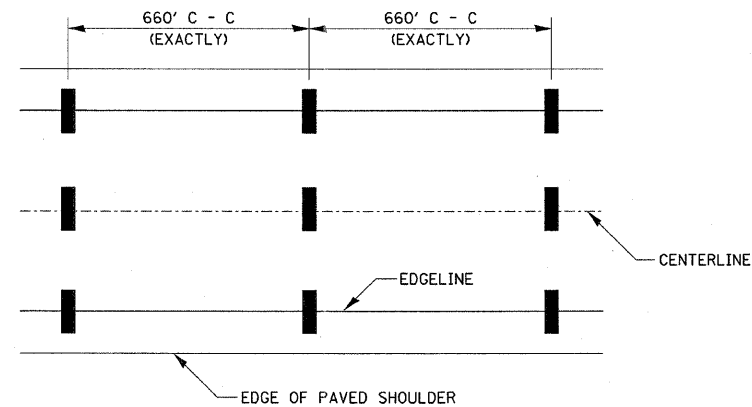

IT WILL BE NECESSARY TO HAVE A REPRESENTATIVE OF THE STATE POLICE PRESENT SO THAT THE ACCURACY OF MEASUREMENT CAN BE ATTESTED TO IN COURT.

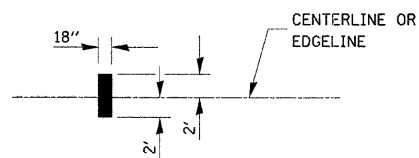

NOT TO SCALE

FILE NAME =	USER NAME = swartzrw	DESIGNED -	REVISED - MMO 12-99
c:\pwork\pedit\swartzrw\d0289402\d77	487-shit-detail.dgn	DRAWN -	REVISED - DRM 08-04
	PLOT SCALE = 50.0000' / IN.	CHECKED -	REVISED - MKS 04-08
	PLOT DATE = 2/7/2011	DATE -	REVISED - DRM 01-09

STATE OF ILLINOIS
DEPARTMENT OF TRANSPORTATION

TYPICAL APPLICATIONS OF INTERSTATE PAVEMENT MARKING

SCALE: NA SHEET NO. 2 OF 2 SHEETS STA. TO STA.

DISTRICT 7 DETAIL NO. 7800002

F.A.I. RTE.	SECTION	COUNTY	TOTAL SHEETS	SHEET NO.
72	D7 BRIDGE REPAIRS 2011-2	MACON	25	14
FED. ROAD DIST. NO. ILLINOIS FED. AID PROJECT			CONTRACT NO. 74487	

The existing five span multi-beam structures were constructed in 1974 as section 58-64-1HVB at Sta. 324+03.81. SN. 058-0084 carries FAI-72 eastbound and SN. 058-0085 carries FAI-72 westbound over IL 48. The proposed project consists of full depth deck repair, a new micorsilica overlay, and new floor drains.

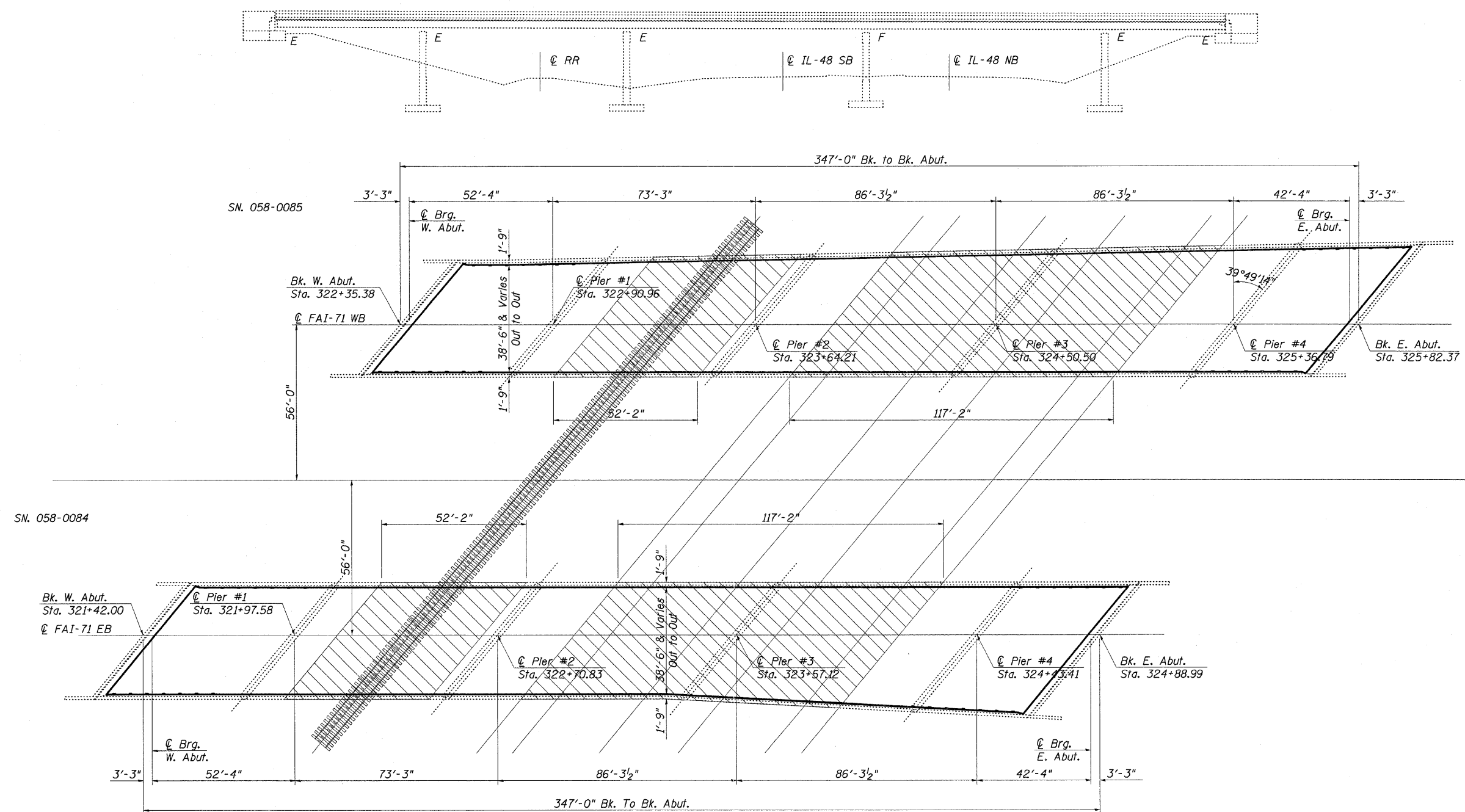

PROTECTIVE SHIELD



David Carl Pluzey 5/5/11
Expires 11/30/2012

FILE NAME =	USER NAME = swartzw	DESIGNED - KLB	REVISED -	STATE OF ILLINOIS DEPARTMENT OF TRANSPORTATION	GENERAL PLAN & ELEVATION SN. 058-0084 & 85		F.A.I. RTE. = 72	SECTION = *	COUNTY = Macon	TOTAL SHEETS = 25	SHEET NO. = 15	
c:\pwork\pwork\swartzw\0229460\077487-sht-brplnprf-84885.dgn	487-sht-brplnprf-84885.dgn	DRAWN - KLB	REVISED -		SCALE: NA	SHEET NO. 1 OF 11 SHEETS	STA. TO STA.	ILLINOIS FED. AID PROJECT				
PLOT SCALE = 20.0000 ' / IN.		CHECKED - MEA	REVISED -		CONTRACT NO. 74487							
PLOT DATE = 2/7/2011		DATE - 11/29/2010	REVISED -		*07 Bridge Repairs 2011-2							

GENERAL NOTES

Plan dimensions and details relative to the existing structure have been taken from existing plans and are subject to nominal construction variations. It shall be the contractor's responsibility to verify dimensions and details in the field, and to make necessary approved adjustments prior to construction or material acquisition. Such variations shall not be cause for additional compensation or change in the scope of work. The contractor will be paid for the quantity actually furnished at the unit bid price for the work.

Reinforcement bars shall conform to the requirements of ASTM A 706 GRADE 60. See Special Provisions.

Reinforcement bars designated (E) shall be epoxy coated.

Existing reinforcement bars extending into the removal area shall be cleaned, straightened and incorporated into the new construction. Any reinforcement bars that are damaged during concrete removal operations shall be replaced using an approved bar splicer or anchorage system. Cost included in CONCRETE REMOVAL.

Areas of deck repairs shown are estimated. The Engineer shall show actual locations of deck repairs on as-built plans.

The existing hot-mix asphalt wearing surface is not known to contain asbestos.

All structural steel shall conform to AASHTO Classification M-270 Gr. 36 unless otherwise noted.

TOTAL BILL OF MATERIALS

ITEM	UNIT	058-0084	058-0085	TOTAL
Concrete Removal	Cu Yd	2.8	2.8	5.6
Concrete Superstructure	Cu Yd	2.8	2.8	5.6
Reinforcement Bars, Epoxy Coated	Pound	420	420	840
HMA Surface Removal (Deck)	Sq Yd	1492	1570	3062
Bridge Deck Scarification, 3/4"	Sq Yd	1492	1570	3062
Bridge Deck Microsilica Concrete Overlay, 2 1/2"	Sq Yd	1492	1570	3062
Bridge Deck Grooving	Sq Yd	1419	1489	2908
* Protective Coat	Sq Yd	251	251	502
Deck Slab Repair (Full Depth, Type I)	Sq Yd	1	3	4
Deck Slab Repair (Full Depth, Type II)	Sq Yd	250	85	335
Floor Drains	Each	14	14	28
Plug Existing Deck Drains	Each	14	14	28
Protective Shield	Sq Yd	803	854	1657

* Protective coat to be applied to the face and top of parapet only.

FILE NAME =	USER NAME = swartzw	DESIGNED - KLB	REVISED -	STATE OF ILLINOIS DEPARTMENT OF TRANSPORTATION	BRIDGE GENERAL NOTES & BILL OF MATERIALS SN. 058-0084 & 0085	F.A.I. RTE.	SECTION	COUNTY	TOTAL SHEETS	SHEET NO.	
c:\pw\work\p\dot\swartzw\0209402\077	487-sht-brgennote-84&85.dgn	DRAWN - KLB	REVISED -			72	*	Macon	25	16	
PLOT SCALE = 20,0000 ' / IN.	CHECKED - MEA	REVISED -				CONTRACT NO. 74487					
PLOT DATE = 2/7/2011	DATE - 11/29/2010	REVISED -				ILLINOIS FED. AID PROJECT					

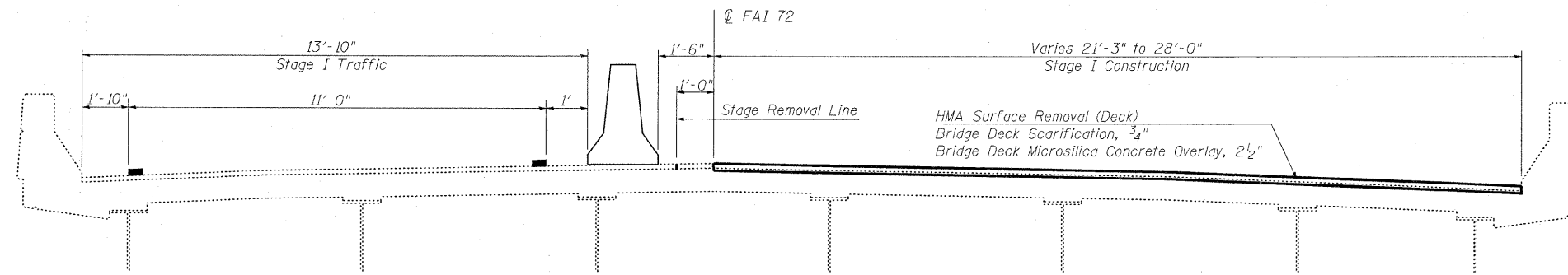

SN. 058-0084
STAGE I LOOKING EAST

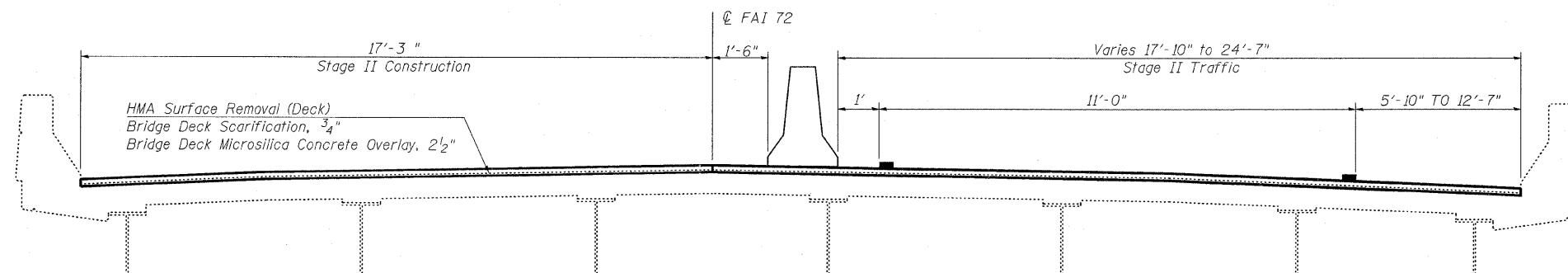

SN. 058-0084
STAGE II LOOKING EAST

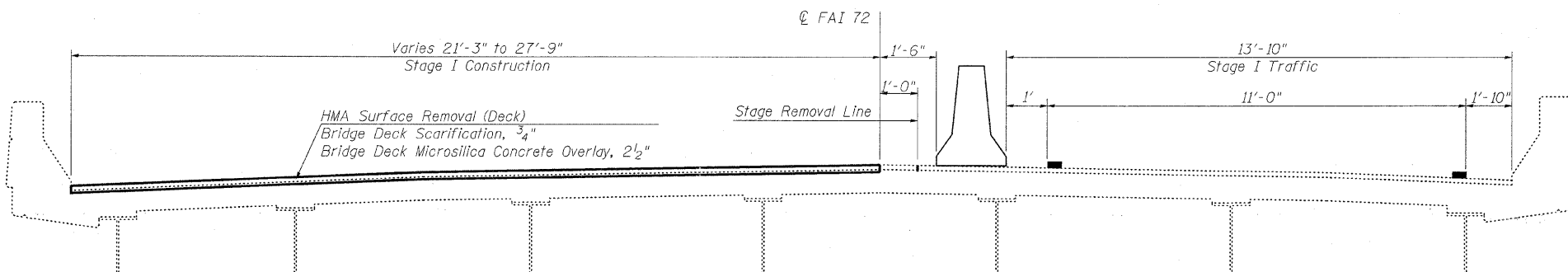

SN. 058-0085
STAGE I LOOKING EAST

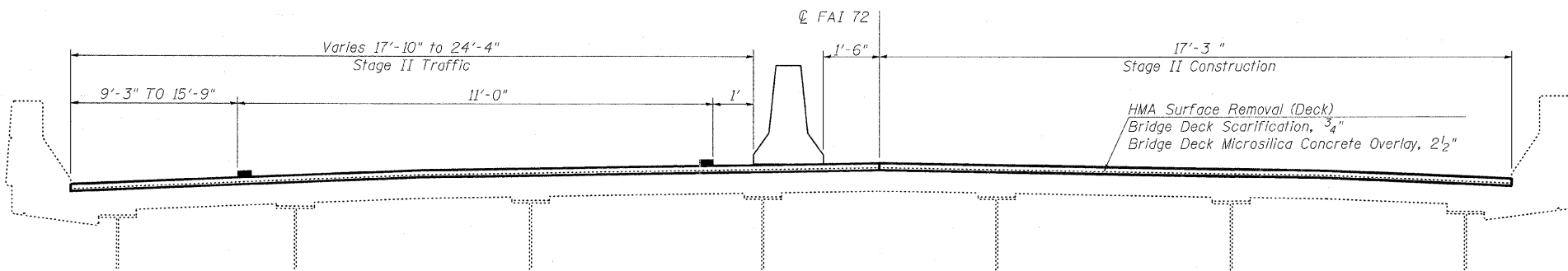

SN. 058-0085
STAGE II LOOKING EAST

FILE NAME =	USER NAME = swartzrw	DESIGNED - KLB	REVISED -	STATE OF ILLINOIS DEPARTMENT OF TRANSPORTATION	CONSTRUCTION STAGING SN. 058-0084 & 0085			F.A.I. RTE.	SECTION	COUNTY	TOTAL SHEETS	SHEET NO.
or:\pw_work\pwidot\swartzrw\ad209400\077487-sh1-brgenote-84885.dgn	DRAWN - KLB	REVISED -	72						Macon	25	17	
PLOT SCALE = 20.0000' / IN.	CHECKED - MEA	REVISED -	CONTRACT NO. 74487									
PLOT DATE = 2/7/2011	DATE - 11/29/2010	REVISED -	SCALE: NA					SHEET NO. 3 OF 11 SHEETS	STA.	TO STA.	ILLINOIS FED. AID PROJECT	

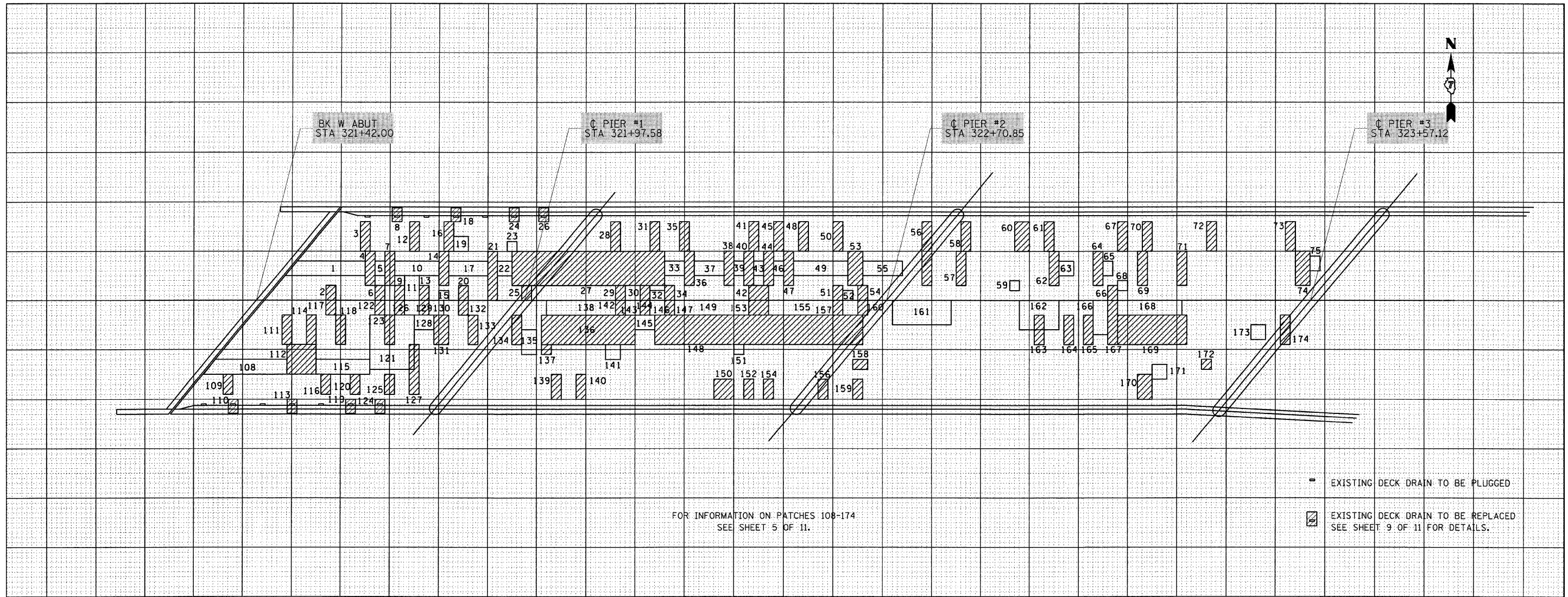

FOR INFORMATION ON PATCHES 108-174
SEE SHEET 5 OF 11.

- ▣ EXISTING DECK DRAIN TO BE PLUGGED
- ▨ EXISTING DECK DRAIN TO BE REPLACED
SEE SHEET 9 OF 11 FOR DETAILS.

PATCH NO.	SIZE	DECK SLAB REPAIR (PART DEPTH)		
		SO FT	SO FT	SO FT
1	15.7 x 3.0	47.1		
2	2.0 x 3.0			6.0
3	2.0 x 6.0			12.0
4	2.0 x 7.0			14.0
5	2.0 x 3.0	6.0		
6	2.0 x 3.0			6.0
7	2.0 x 7.0			14.0
8	2.0 x 2.8			5.6
9	2.0 x 3.0			6.0
10	9.0 x 3.0	27.0		
11	3.0 x 5.0	15.0		
12	2.0 x 6.0			12.0
13	2.0 x 3.0			6.0
14	2.0 x 7.0			14.0
15	2.0 x 2.0	4.0		
16	2.0 x 6.0			12.0
17	8.0 x 3.0	24.0		
18	2.0 x 2.8			5.6
19	3.0 x 3.0	9.0		
20	2.0 x 3.0			6.0
21	2.0 x 10.0			20.0
22	3.0 x 3.0	9.0		
23	2.0 x 2.0	4.0		
24	2.0 x 2.8			5.6
25	2.0 x 3.0			6.0
26	2.0 x 2.8			5.6
27	31.0 x 7.0			217.0
28	2.0 x 6.0			12.0
29	2.0 x 3.0			6.0
30	2.0 x 3.0			6.0
31	2.0 x 6.0			12.0
32	3.0 x 2.0			6.0
33	4.0 x 3.0	12.0		
34	2.0 x 3.0			6.0
35	2.0 x 6.0			12.0
36	2.0 x 7.0			14.0
37	6.0 x 3.0	18.0		
38	2.0 x 7.0			14.0
39	2.0 x 3.0	6.0		
40	2.0 x 7.0			14.0
41	2.0 x 6.0			12.0
42	4.0 x 3.0			12.0
43	2.0 x 3.0	6.0		
44	2.0 x 7.0			14.0
45	2.0 x 6.0			12.0
46	2.0 x 3.0	6.0		
47	2.0 x 7.0			14.0
48	2.0 x 6.0			12.0
49	11.0 x 3.0	33.0		
50	2.0 x 6.0			12.0
51	2.0 x 3.0			6.0
52	2.0 x 2.0	4.0		
53	3.0 x 7.0			21.0
54	2.0 x 3.0			6.0
55	8.0 x 3.0	24.0		
56	2.0 x 13.0			26.0
57	2.0 x 7.0			14.0
58	2.0 x 6.0			12.0
59	2.0 x 2.0	4.0		
60	3.0 x 6.0			18.0
61	2.0 x 6.0			12.0
62	2.0 x 7.0			14.0
63	3.0 x 3.0	9.0		
64	2.0 x 7.0			14.0
65	2.0 x 3.0	6.0		
66	2.0 x 3.0			6.0
67	2.0 x 6.0			12.0
68	2.0 x 2.0	4.0		
69	2.0 x 7.0			14.0
70	2.0 x 6.0			12.0
71	2.0 x 7.0			14.0
72	2.0 x 6.0			12.0
73	2.0 x 6.0			12.0
74	3.0 x 7.0			21.0
75	2.0 x 3.0	6.0		

THE LOCATIONS AND SIZES SHOWN GRAPHICALLY ABOVE ARE APPROXIMATE. SEE THIS TABLE FOR ACTUAL SIZES.

PATCHING LEGEND

- ▣ PARTIAL DEPTH (FOR INFORMATION ONLY)
- ▨ FULL DEPTH

DATE OF SURVEY: 10-29-10
SURVEY BY: MEA, ESS, KLB
METHOD OF SURVEY: VISUAL

BRIDGE DECK PATCHING
MACON COUNTY
LOCATION

SN 058-0084

084

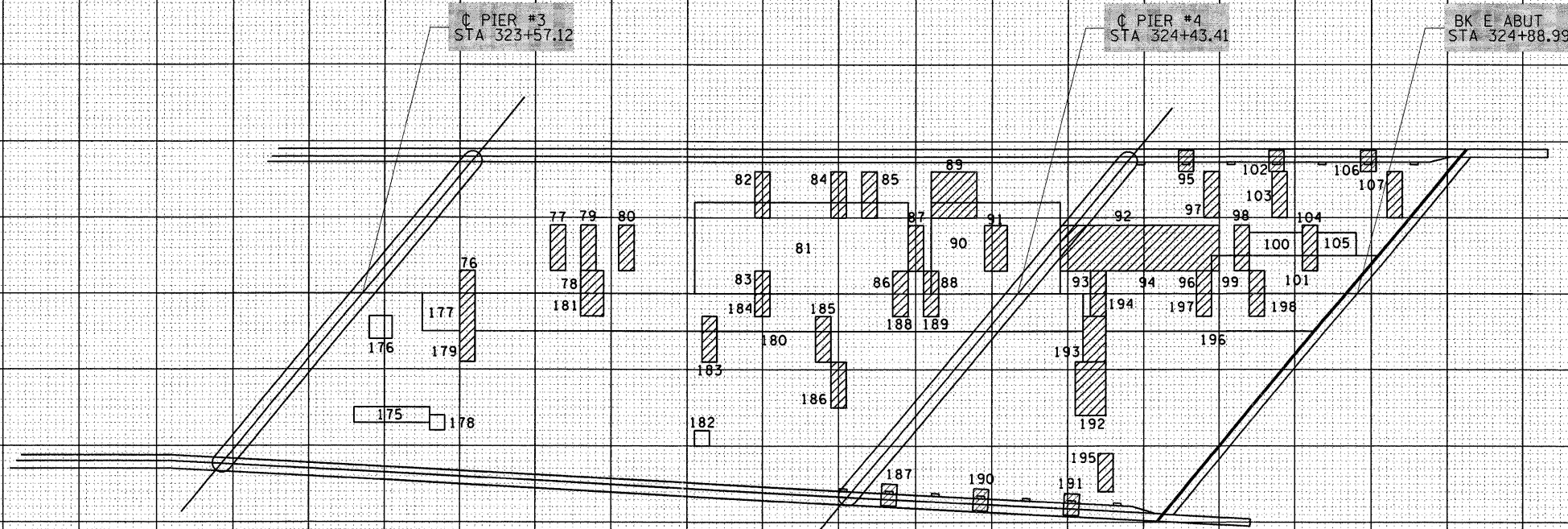

EXISTING DECK DRAIN TO BE PLUGGED
 EXISTING DECK DRAIN TO BE REPLACED SEE SHEET 9 OF 11 FOR DETAILS.

PATCH NO.	SIZE	DECK SLAB REPAIR (PART DEPTH)		
		SQ FT	SQ FT	SQ FT
76	2.0 x 3.0			6.0
77	2.0 x 6.0			12.0
78	3.0 x 3.0			9.0
79	2.0 x 6.0			12.0
80	2.0 x 6.0			12.0
81	28.0 x 12.0	336.0		
82	2.0 x 6.0			12.0
83	2.0 x 3.0			6.0
84	2.0 x 6.0			12.0
85	2.0 x 6.0			12.0
86	2.0 x 3.0			6.0
87	2.0 x 6.0			12.0
88	2.0 x 3.0			6.0
89	6.0 x 6.0			36.0
90	17.0 x 12.0	204.0		
91	3.0 x 6.0			18.0
92	21.0 x 6.0			126.0
93	2.0 x 3.0			6.0

PATCH NO.	SIZE	DECK SLAB REPAIR (PART DEPTH)		
		SQ FT	SQ FT	SQ FT
94	12.0 x 3.0	36.0		
95	2.0 x 2.8			5.6
96	2.0 x 3.0			6.0
97	2.0 x 6.0			12.0
98	2.0 x 6.0			12.0
99	2.0 x 3.0			6.0
100	7.0 x 3.0	21.0		
101	19.7 x 5.0	98.5		
102	2.0 x 2.8			5.6
103	2.0 x 6.0			12.0
104	2.0 x 6.0			12.0
105	5.0 x 3.0	15.0		
106	2.0 x 2.8			5.6
107	2.0 x 6.0			12.0

PATCH NO.	SIZE	DECK SLAB REPAIR (PART DEPTH)		
		SQ FT	SQ FT	SQ FT
175	10.0 x 2.0	20.0		
176	3.0 x 3.0	9.0		
177	5.0 x 5.0	25.0		
178	2.0 x 2.0	4.0		
179	2.0 x 9.0			18.0
180	80.0 x 5.0	400.0		
181	3.0 x 3.0			9.0
182	2.0 x 2.0	4.0		
183	2.0 x 6.0			12.0
184	2.0 x 3.0			6.0
185	2.0 x 6.0			12.0
186	2.0 x 6.0			12.0
187	2.0 x 2.8			5.6
188	2.0 x 3.0			6.0
189	2.0 x 3.0			6.0
190	2.0 x 2.8			5.6
191	2.0 x 2.8			5.6
192	4.0 x 7.0			28.0

PATCH NO.	SIZE	DECK SLAB REPAIR (PART DEPTH)		
		SQ FT	SQ FT	SQ FT
193	3.0 x 6.0			18.0
194	2.0 x 3.0			6.0
195	2.0 x 5.0			10.0
196	29.5 x 5.0	147.5		
197	2.0 x 3.0			6.0
198	2.0 x 3.0			6.0
TOTAL		2163	8	2250

PATCH NO.	SIZE	DECK SLAB REPAIR (PART DEPTH)		
		SQ FT	SQ FT	SQ FT
PARTIAL DEPTH (FOR INFORMATION ONLY)				
2163	/ 9 =	240.3		
	USE	240	50	YD
FULL DEPTH, TYPE 1				
8	/ 9 =	0.9		
	USE	1	50	YD
FULL DEPTH, TYPE 2				
2250	/ 9 =	250.0		
	USE	250	50	YD

THE LOCATIONS AND SIZES SHOWN GRAPHICALLY ABOVE ARE APPROXIMATE. SEE THIS TABLE FOR ACTUAL SIZES.

PATCHING LEGEND

PARTIAL DEPTH (FOR INFORMATION ONLY)
 FULL DEPTH

DATE OF SURVEY: 10-29-10
 SURVEY BY: MEA, ESS, KLB
 METHOD OF SURVEY: VISUAL

BRIDGE DECK PATCHING
 MACON COUNTY
 LOCATION
 SN 058-0084

084

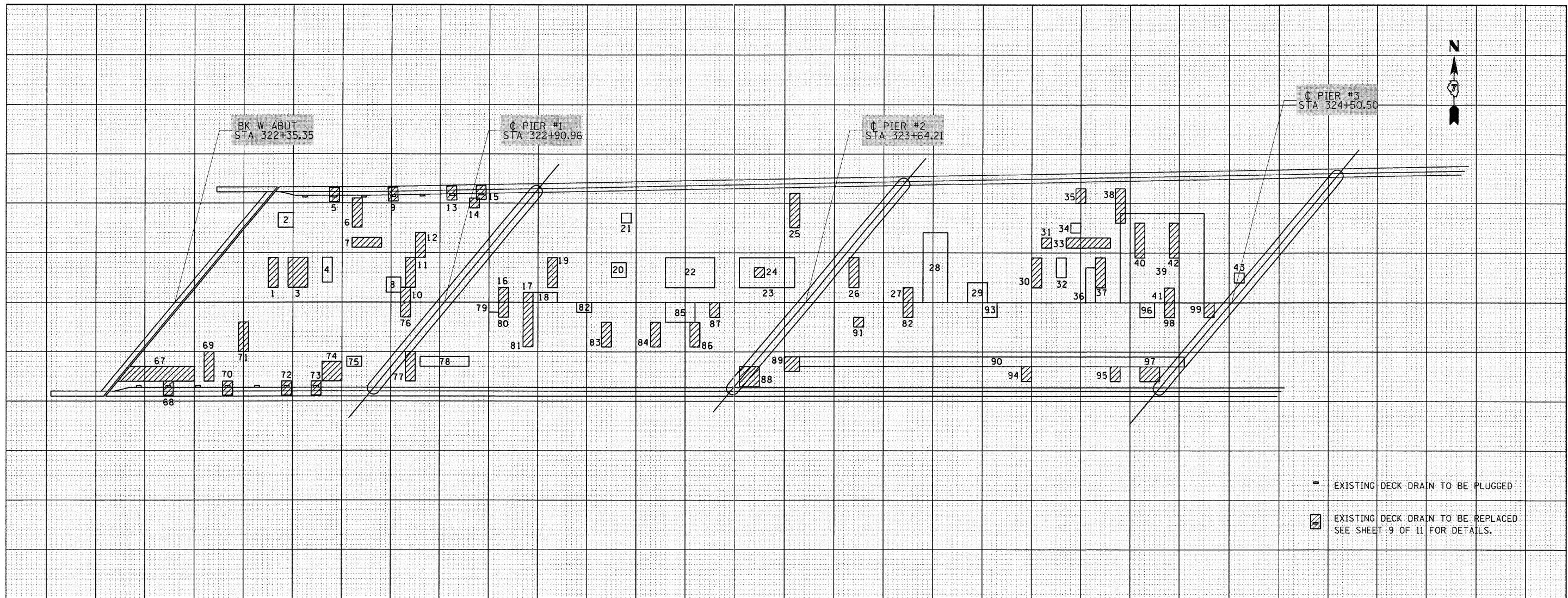

■ EXISTING DECK DRAIN TO BE PLUGGED
 ▨ EXISTING DECK DRAIN TO BE REPLACED
 SEE SHEET 9 OF 11 FOR DETAILS.

PATCH NO.	SIZE	DECK SLAB REPAIR (PART DEPTH)		
		SO FT	SO FT	SO FT
1	2.0 x 6.0			12.0
2	3.0 x 3.0	9.0		
3	4.0 x 6.0			24.0
4	2.0 x 5.0	10.0		
5	2.0 x 2.8			5.6
6	2.0 x 6.0			12.0
7	6.0 x 2.0			12.0
8	3.0 x 3.0	9.0		
9	2.0 x 2.8			5.6
10	2.0 x 3.0			6.0
11	2.0 x 6.0			12.0
12	2.0 x 5.0			10.0
13	2.0 x 2.8			5.6
14	2.0 x 2.0		4.0	
15	2.0 x 2.8			5.6
16	2.0 x 3.0			6.0
17	2.0 x 2.0		4.0	
18	5.0 x 2.0	10.0		

PATCH NO.	SIZE	DECK SLAB REPAIR (PART DEPTH)		
		SO FT	SO FT	SO FT
19	2.0 x 6.0			12.0
20	3.0 x 3.0	9.0		
21	2.0 x 2.0	4.0		
22	10.0 x 6.0	60.0		
23	11.0 x 6.0	66.0		
24	2.0 x 2.0		4.0	
25	2.0 x 7.0			14.0
26	2.0 x 6.0			12.0
27	2.0 x 3.0			6.0
28	5.0 x 14.0	70.0		
29	4.0 x 4.0	16.0		
30	2.0 x 6.0			12.0
31	2.0 x 2.0		4.0	
32	2.0 x 4.0	8.0		
33	9.0 x 2.0			18.0
34	2.0 x 2.0	4.0		
35	2.0 x 3.0			6.0
36	2.0 x 7.0	14.0		

PATCH NO.	SIZE	DECK SLAB REPAIR (PART DEPTH)		
		SO FT	SO FT	SO FT
37	2.0 x 6.0			12.0
38	2.0 x 7.0			14.0
39	17.0 x 18.0	306.0		
40	2.0 x 7.0			14.0
41	2.0 x 3.0			6.0
42	2.0 x 7.0			14.0
43	2.0 x 2.0	4.0		

PATCH NO.	SIZE	DECK SLAB REPAIR (PART DEPTH)		
		SO FT	SO FT	SO FT
67	14.3 x 3.0			42.9
68	2.0 x 2.8			5.6
69	2.0 x 6.0			12.0
70	2.0 x 2.8			5.6
71	2.0 x 6.0			12.0
72	2.0 x 2.8			5.6
73	2.0 x 2.8			5.6
74	4.0 x 4.0			16.0
75	3.0 x 2.0	6.0		
76	2.0 x 3.0			6.0
77	2.0 x 6.0			12.0
78	10.0 x 2.0	20.0		
79	2.0 x 2.0	4.0		
80	2.0 x 3.0			6.0
81	2.0 x 9.0			18.0
82	3.0 x 2.0	6.0		
83	2.0 x 5.0			10.0
84	2.0 x 5.0			10.0

PATCH NO.	SIZE	DECK SLAB REPAIR (PART DEPTH)		
		SO FT	SO FT	SO FT
85	6.0 x 4.0	24.0		
86	2.0 x 5.0			10.0
87	2.0 x 3.0			6.0
88	4.0 x 4.0			16.0
89	3.0 x 3.0			9.0
90	78.0 x 2.0	156.0		
91	2.0 x 2.0		4.0	
92	2.0 x 3.0			6.0
93	3.0 x 3.0	9.0		
94	2.0 x 3.0			6.0
95	2.0 x 3.0			6.0
96	3.0 x 3.0	9.0		
97	4.0 x 3.0			12.0
98	2.0 x 3.0			6.0
99	2.0 x 3.0			6.0

THE LOCATIONS AND SIZES SHOWN GRAPHICALLY ABOVE ARE APPROXIMATE. SEE THIS TABLE FOR ACTUAL SIZES.

PATCHING LEGEND

	PARTIAL DEPTH (FOR INFORMATION ONLY)
	FULL DEPTH

DATE OF SURVEY: 10-29-10
 SURVEY BY: MEA, ESS, KLB
 METHOD OF SURVEY: VISUAL

BRIDGE DECK PATCHING
 MACON COUNTY
 LOCATION
 SN 058-0085

FILE NAME =
 USER NAME = swartzw
 PLOT SCALE = 58.0000' / IN.
 PLOT DATE = 2/7/2011

DESIGNED - KLB
 DRAWN - KLB
 CHECKED - MEA
 DATE - 11/29/2010

REVISED -
 REVISED -
 REVISED -
 REVISED -

STATE OF ILLINOIS
 DEPARTMENT OF TRANSPORTATION

BRIDGE DECK PATCHING
 SN. 058-0085

SCALE: 50 SHEET NO. 7 OF 11 SHEETS STA. TO STA.

F.A.I. RTE. 72	SECTION	COUNTY Macon	TOTAL SHEETS 25	SHEET NO. 21
FED. ROAD DIST. NO.		ILLINOIS FED. AID PROJECT		CONTRACT NO. 74487

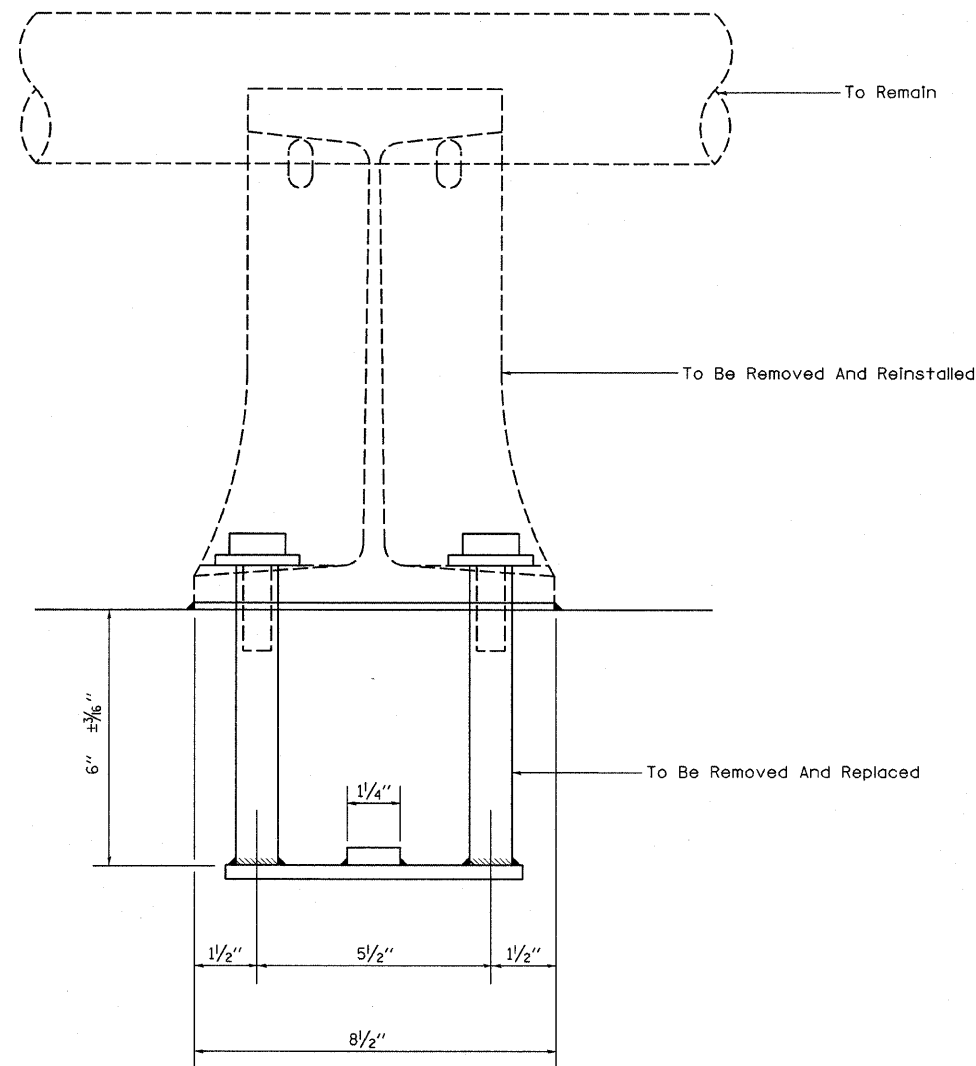

2 - 1/2" ϕ x 1 3/4" hex. hd. cap screws
Std. flat washers. (stnl. stl.)

2 - 3/4" ϕ x 2" hex. hd. cap screws
Std. flat washers. (stnl. stl.)

Base of post shall be sealed with two component non-staining gray sealing compound with polysulfide liquid polymers-gun grade with primer.

1/8" Fabric Bearing Pad

2 - 3/4" ϕ welded studs drilled and tapped for 1/2"-13. AASHTO M 169 (1015, 1018, 1020)

Inside face of parapet

2 - 1" ϕ welded studs drilled and tapped for 3/4"-10. AASHTO M 169 (1015, 1018, 1020)

3/8" x 1/4" x 7"

1/2" x 1/2" x 7"

Note: New Rail Post anchorage devices will be required at each location where posts are connected to new construction. Cost shall be included with Concrete Superstructure.
(±16 locations. Engineer to verify in the field.)

FILE NAME =	USER NAME = swartzrw	DESIGNED - KLB	REVISED -
c:\pw_work\pwwork\swartzrw\d8289400\077467-sht-brdetails-0580284885.dgn		DRAWN - KLB	REVISED -
PLOT SCALE = 20.0000" / IN.		CHECKED - MEA	REVISED -
PLOT DATE = 2/7/2011		DATE - 11/29/2010	REVISED -

STATE OF ILLINOIS
DEPARTMENT OF TRANSPORTATION

RAIL SUPPORT ANCHOR DETAILS
SN. 058-0084 & 85

F.A.I. RTE.	SECTION	COUNTY	TOTAL SHEETS	SHEET NO.
72	*	Macon	25	24
CONTRACT NO. 74487			ILLINOIS FED. AID PROJECT	

SCALE: NA SHEET NO. 10 OF 11 SHEETS STA. TO STA.

*D7 Bridge Repairs 2011-2

When "A" is 3'-6" or less, the temporary concrete barrier shall be anchored to the new slab according to Detail I or Detail II. No anchorage is required when "A" is greater than 3'-6".

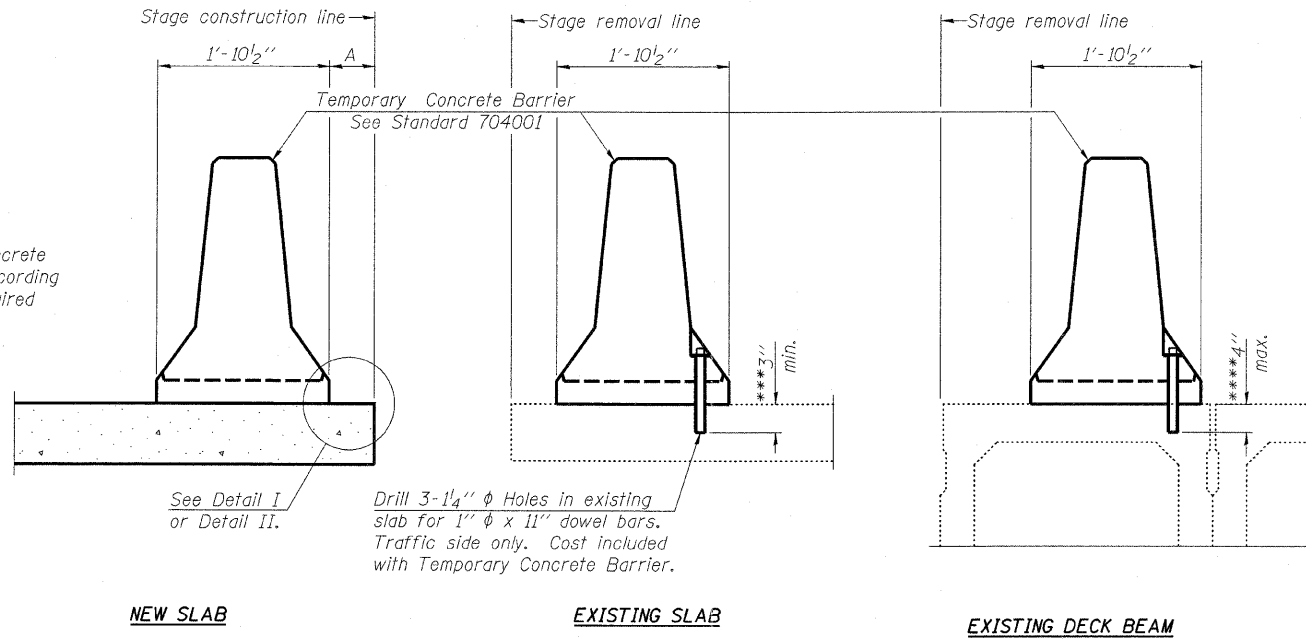

SECTIONS THRU SLAB OR DECK BEAM

NOTES

Detail I - With Bar Splicer or Couplers:
Connect one (1) 1" x 7" x "W" steel \bar{P} to the top layer of couplers with 2-5/8" ϕ bolts screwed to coupler at approximate \bar{C} of each barrier panel.

Detail II - With Extended Reinforcement Bars:
Connect one (1) 1" x 7" x "W" steel \bar{P} to the concrete slab or concrete wearing surface with 2-5/8" ϕ Expansion Anchors or cast in place inserts spaced between the top layer of reinforcement at approximate \bar{C} of each barrier panel.

Cost of anchorage is included with Temporary Concrete Barrier. The 1" x 7" x "W" plate shall not be removed until stage II construction forms and all reinforcement bars are in place and the concrete is ready to be placed.

*** Dimension shown is minimum required embedment into concrete. If hot-mix asphalt wearing surface is present, minimum embedment shall be in addition to wearing surface depth.

**** If existing deck beam is to remain in place after stage construction, embedment shall only be into wearing surface and not into existing deck beam concrete.

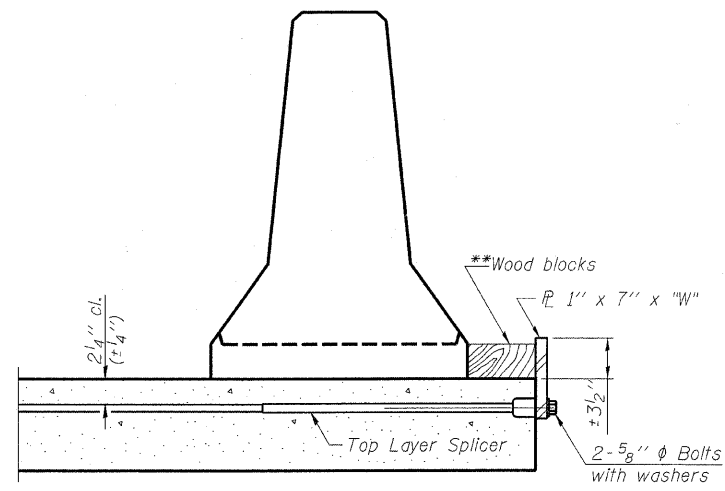

DETAIL I

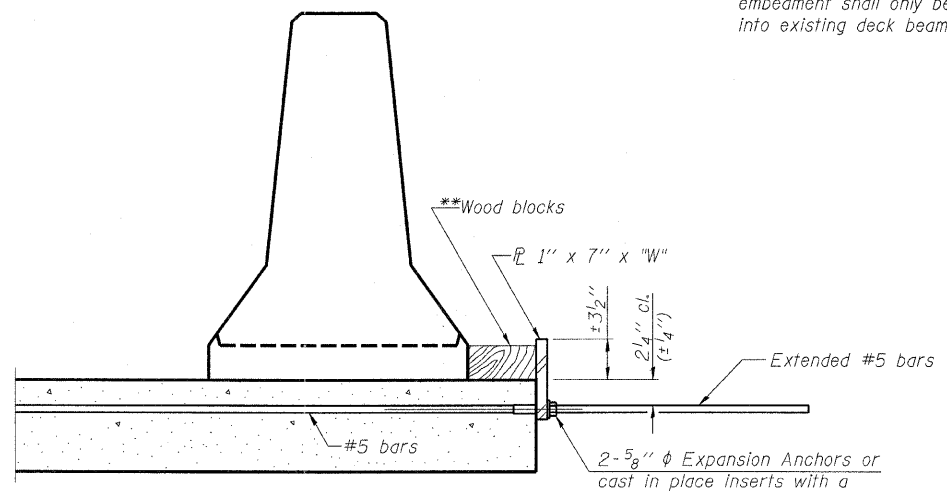

DETAIL II

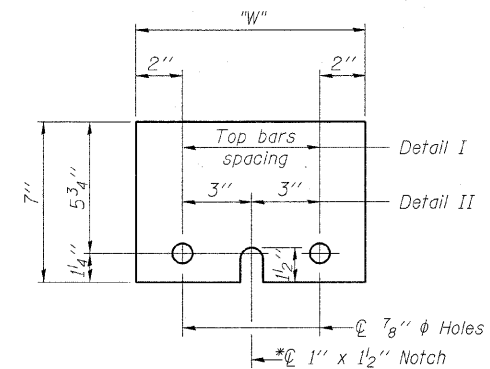

STEEL RETAINER \bar{P} 1" x 7" x "W"

* Required only with Detail II

** Wood blocks may be omitted when required to provide minimum stage traffic lane width. When the wood blocks are omitted, the concrete barrier shall be in direct contact with the steel retainer plate.

"W" = Top bars spacing + 4"

R-27

7-1-10

FILE NAME =	USER NAME = swartzw	DESIGNED - KLB	REVISED -	STATE OF ILLINOIS DEPARTMENT OF TRANSPORTATION	TEMPORARY CONCRETE BARRIER FOR STAGE CONSTRUCTION STRUCTURE NO. 058-0084 & 85			F.A.I. RTE. 72	SECTION	COUNTY Macon	TOTAL SHEETS 25	SHEET NO. 25
cd:\pw_work\pwsdot\swartzw\d0209400\077	487-shl-brdetails-0580084&85.dgn	DRAWN - KLB	REVISED -		SCALE: NA	SHEET NO. 11 OF 11 SHEETS	STA.	TO STA.	CONTRACT NO. 74487			
PLOT SCALE = 20,0000 ' / IN.		CHECKED - MEA	REVISED -		ILLINOIS FED. AID PROJECT							
PLOT DATE = 2/7/2011		DATE - 11/29/2010	REVISED -		07 Bridge Repairs 2011-2							