

PROP. CURVE PR-WR-3
 PI STA. = 1417+93.73
 $\Delta = 11^\circ 21' 44''$ (RT)
 D = 11' 37"
 R = 4,800.00'
 T = 477.51'
 L = 951.89'
 E = 23.69'
 $e =$
 T.R. =
 S.E. RUN =
 P.C. STA. = 1413+16.22
 P.T. STA. = 1422+68.11
 DESIGN SPEED = 20 MPH

PROP. CURVE PR-270-1
 PI STA. = 1173+56.70
 $\Delta = 30^\circ 01' 30''$ (RT)
 D = 1' 14' 44"
 R = 4,600.00'
 T = 1,233.64'
 L = 2,410.56'
 E = 162.55'
 $e = 3.24\%$
 T.R. = SEE SE TABLE
 S.E. RUN = SEE SE TABLE
 P.C. STA. = 1161+23.06
 P.T. STA. = 1185+33.62
 DESIGN SPEED = 60 MPH

PROP. CURVE PR-270W-1
 PI STA. = 3173+45.41
 $\Delta = 29^\circ 45' 41''$ (RT)
 D = 1' 14' 39"
 R = 4,605.50'
 T = 1,223.76'
 L = 2,392.25'
 E = 159.81'
 $e = 3.24\%$
 T.R. = SEE SE TABLE
 S.E. RUN = SEE SE TABLE
 P.C. STA. = 3161+21.65
 P.T. STA. = 3185+13.90

PROP. CURVE PR-270E-1
 PI STA. = 2173+90.56
 $\Delta = 29^\circ 48' 43''$ (RT)
 D = 1' 14' 49"
 R = 4,594.50'
 T = 1,223.02'
 L = 2,390.60'
 E = 159.99'
 $e = 3.24\%$
 T.R. = SEE SE TABLE
 S.E. RUN = SEE SE TABLE
 P.C. STA. = 2161+67.54
 P.T. STA. = 2185+56.14

- PROPOSED ROADWAY LEGEND**
- (A) CONT REINF PCC PVT 12
 - (B) HMA SC "D" N50
 - (C) HMA BC IL-12.5 N50
 - (D) STABILIZED SUBBASE 4"
 - (E) BIT SURF TREAT CL A-3
 - (F) AGG BASE CSE A 8
 - (G) SUB GRAN MAT A 12
 - (H) PCC SHOULDERS 12
 - (I) PCC SHOULDERS 12 SPL
 - (J) HMA SHOULDERS 10 1/2
 - (K) SHLDR STABILIZATION (NOTE 1)
 - (L) AGGREGATE SHLDS A 6
 - (M) TOPSOIL EXC & PLAC
 - (N) CONC BAR 2F 42HT
 - (O) CONC BAR 1F 42HT SPL
 - (P) MECH ST EARTH RET WL
 - (R) SPBGR TY A 6FT POSTS
 - (S) PCC PVT 12 JOINTED
 - (T) HMA PAVT FD 13
 - (U) PROCESS MOD SOIL 12 AND LIME
 - (W) SUB GRAN MAT C
 - (X) WOV W FENCE 4
 - (Y) SPBGR TY A 9FT POST
 - (AA) SHOULDER RUMBLE STRIP
- NOTE 1: (K) PAID FOR AS (H) OR (J) TO MATCH ADJACENT SHOULDER
 NOTE 2: SEE PLAT OF HIGHWAY FOR FULL EXTENT OF GENERAL PURPOSE LICENSE. (GPL)

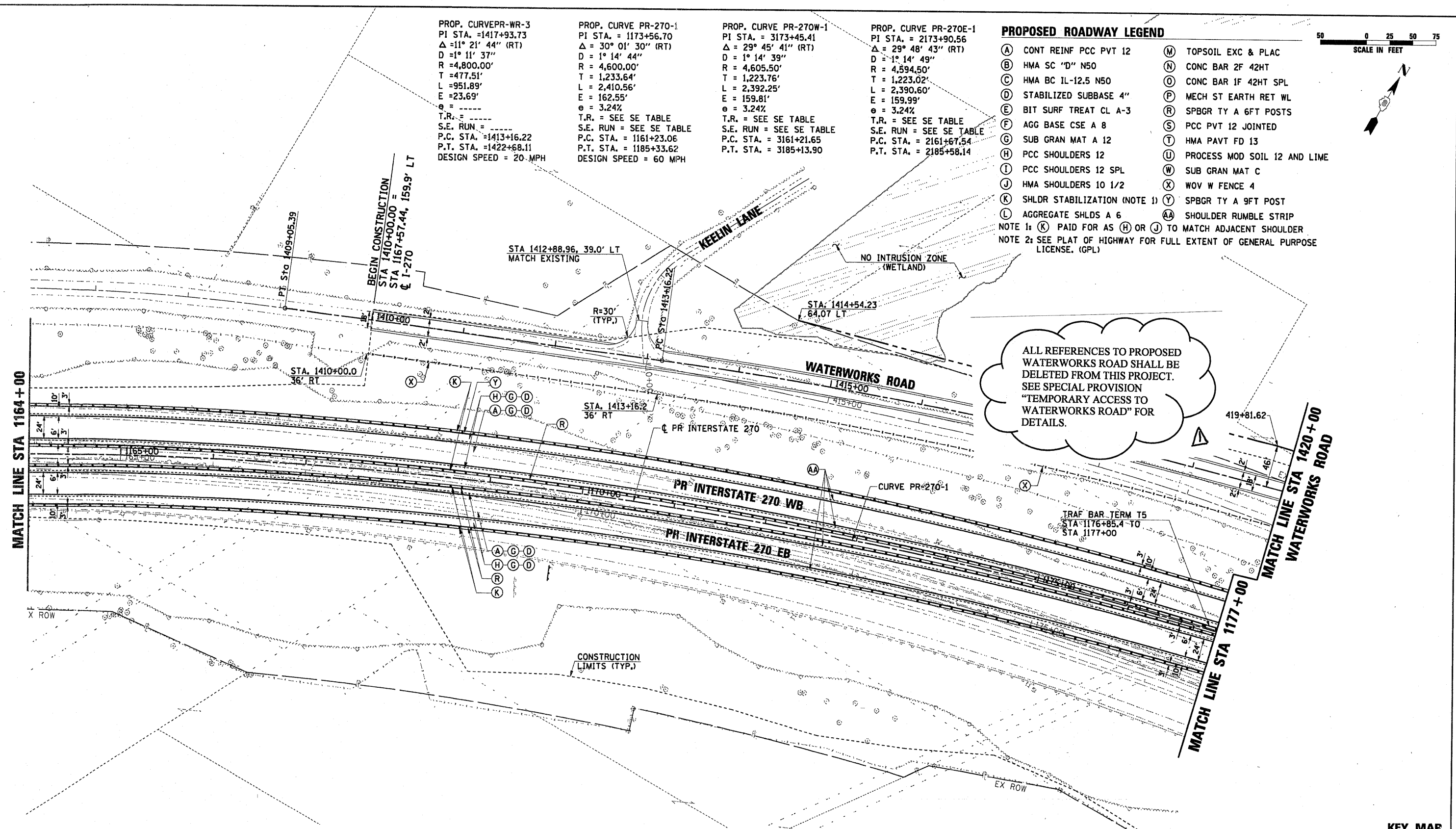
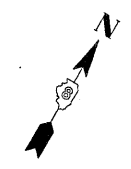
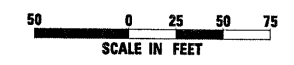

ALL REFERENCES TO PROPOSED WATERWORKS ROAD SHALL BE DELETED FROM THIS PROJECT. SEE SPECIAL PROVISION "TEMPORARY ACCESS TO WATERWORKS ROAD" FOR DETAILS.

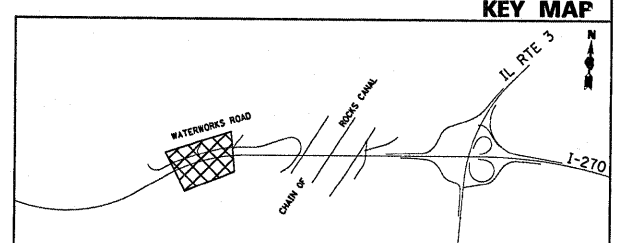

FILE NAME = 0876A91-Sht-Plan02.dgn	USER NAME = malopez	DESIGNED - SJM	REVISED - 01-04-11	STATE OF ILLINOIS DEPARTMENT OF TRANSPORTATION	PROPOSED PLAN INTERSTATE 270	F.A.I. RTE. = 270	SECTION = 60-1B-1	COUNTY = MADISON	TOTAL SHEETS = 712	SHEET NO. = 51		
	PLOT SCALE = #SCALE#	DRAWN - BAH	REVISED - 6/7/11 ADDENDUM			SCALE: 1" = 50'	SHEET NO. 2 OF 12 SHEETS	STA. 1164+00	TO STA. 1177+00	CONTRACT NO. 76A91		
	PLOT DATE = 3/17/2011	CHECKED - SJM	REVISED -			ILLINOIS FED. AID PROJECT						
		DATE - 06-30-10	REVISED -									