

**RAMP P4 DETOUR ROUTE**

1. I-270 EASTBOUND TO IL RTE 203 EXIT 4.
2. IL RTE 203 NORTHBOUND TO I-270 WESTBOUND RAMP.
3. I-270 WESTBOUND TO IL RTE 3 EXIT RAMP.

**NOTES:**

1. RAMP P-4 SHORT TERM DETOUR SHALL BE IN PLACE ONLY FOR THE PLACEMENT OF TEMPORARY HMA PAVEMENT BETWEEN PROPOSED EASTBOUND I-270 PAVEMENT AND PROPOSED RAMP P-4 PAVEMENT.
2. CONTRACTOR SHALL SUPPLY ALL DETOUR SIGNS.
3. DETOUR SIGNS SHALL BE IN ACCORDANCE WITH STANDARD SPECIFICATIONS SECTION 1106.
4. CONTRACTOR SHALL FURNISH THE POSTS/SKIDS AND ERECT THE SIGNS AT THE LOCATIONS SHOWN ON THIS SHEET, OR AS DIRECTED BY THE RESIDENT ENGINEER.
5. TWO (2) CHANGEABLE MESSAGE SIGNS SHALL BE INCLUDED IN THE DETOUR SIGNING.
6. UPON COMPLETION OF THE CLOSURE, THE CONTRACTOR SHALL REMOVE THE SIGNS AND POSTS WHICH WILL REMAIN THE PROPERTY OF THE CONTRACTOR.
7. THE SHORT TERM RAMP DETOUR WORK SHALL BE INCLUDED IN THE CONTRACT UNIT PRICE, LUMP SUM, FOR DETOUR SIGNING. NO OTHER COMPENSATION WILL BE ALLOWED.

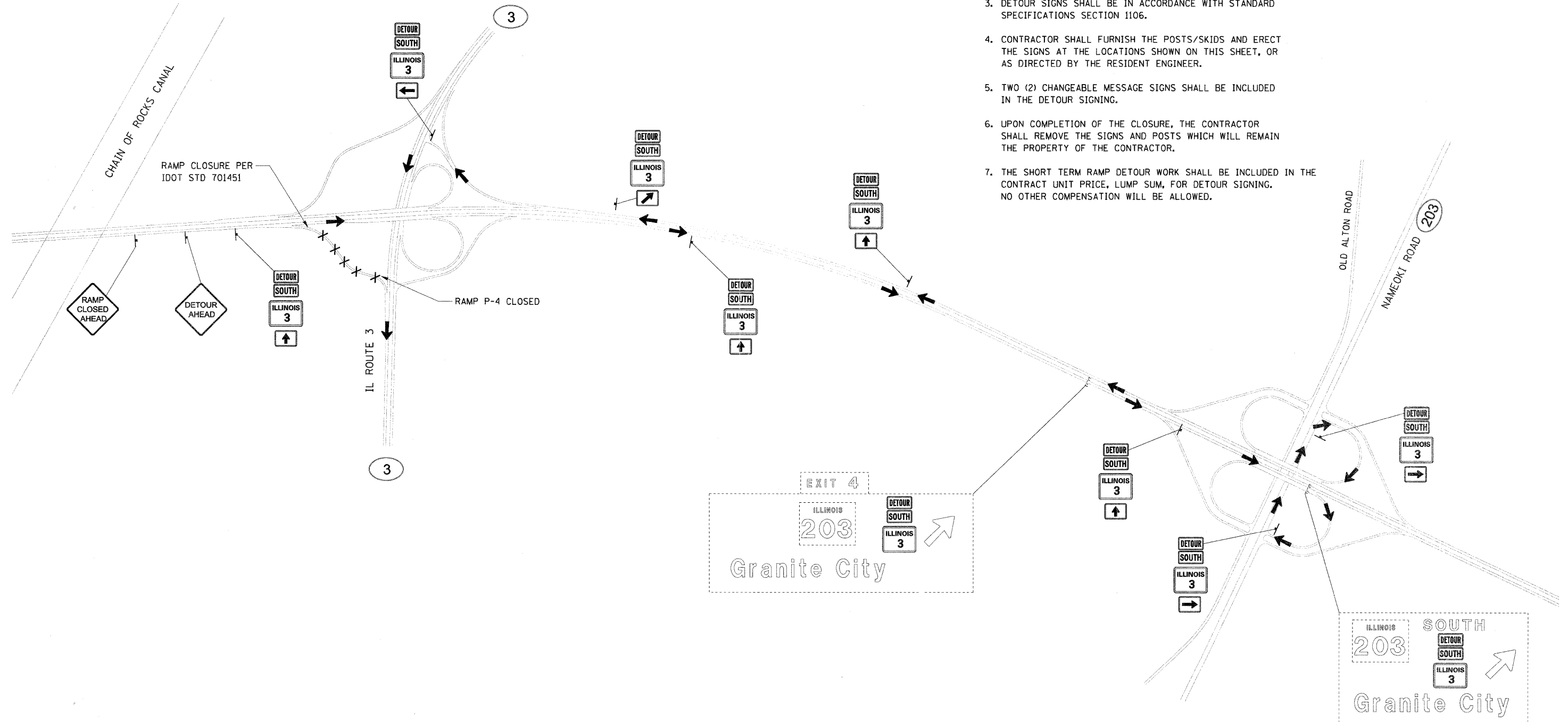
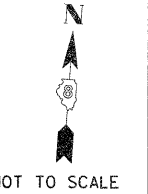

FILE NAME = DB76A91-Sh1MOT04A-07A.dgn  
 USER NAME = ab1iven  
 PLOT SCALE = #SCALE#  
 PLOT DATE = 6/26/2011

DESIGNED - JC  
 DRAWN - BH  
 CHECKED -  
 DATE -

REVISED - NEW SHEET  
 REVISED - 6/7/11 ADDENDUM  
 REVISED -  
 REVISED -

STATE OF ILLINOIS  
 DEPARTMENT OF TRANSPORTATION

**SUGGESTED MAINTENANCE OF TRAFFIC STAGE 4A  
 SHORT TERM RAMP P-4 DETOUR**

SCALE: 1" = 500'  
 SHEET NO. 1 OF 1 SHEETS  
 STA. TO STA.

F.A.I. RTE. 270	SECTION 60-1B-1	COUNTY MADISON	TOTAL SHEETS 712	SHEET NO. 176A
CONTRACT NO. 76A91				
ILLINOIS FED. AID PROJECT				