







REMOVAL LEGEND

-  PAVEMENT REM
-  PAVED SHLD REMOVAL
-  PAVED DITCH REMOVAL
-  REMOVAL LINEAR ITEMS (SEE CALLOUTS BELOW)
-  GUARDRAIL REMOV
-  CABLE ROAD GD REM
-  WOV W FENCE REMOV

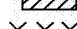
NOTES:

1. SEE DRAINAGE PLANS FOR DRAINAGE REMOVALS.
2. SEE LIGHTING PLANS FOR LIGHTING REMOVALS.
3. SEE PLAT OF HIGHWAYS FOR FULL EXTENT OF USACE GENERAL PURPOSE LICENSE (GPL).
4. SEE SCHEDULE OF QUANTITIES FOR SIGN REMOVAL PAY ITEMS AND QUANTITIES.

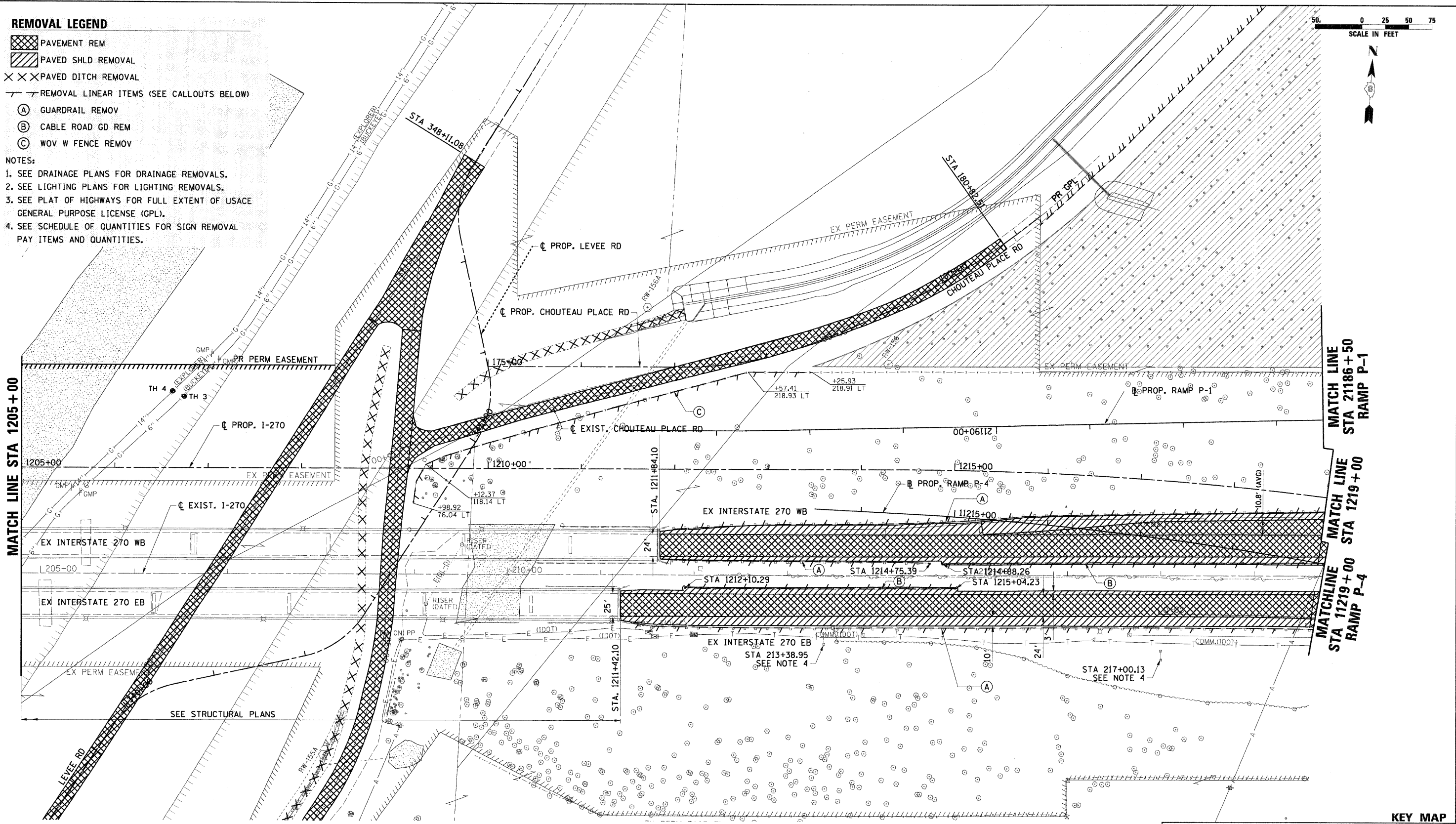
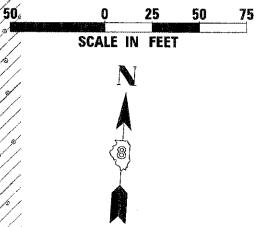

MATCH LINE
 STA 21186+50
 RAMP P-1
MATCH LINE
 STA 1219+00
 RAMP P-4
MATCH LINE
 STA 11219+00
 RAMP P-1

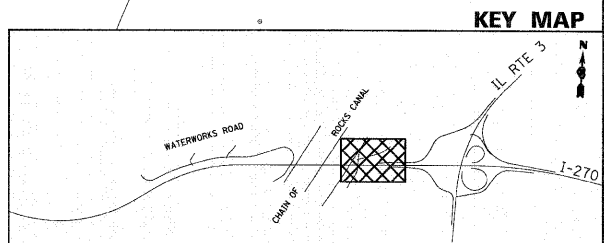

FILE NAME = 0876491-Sht-Rem05.dgn	USER NAME = malopez	DESIGNED - SJM	REVISED - 01-04-11	STATE OF ILLINOIS DEPARTMENT OF TRANSPORTATION	REMOVAL PLANS INTERSTATE 270	F.A.I. RTE. 270	SECTION 60-1B-1	COUNTY MADISON	TOTAL SHEETS 712	SHEET NO. 42		
PLOT SCALE = #SCALE#	CHECKED - SJM	REVISED -	REVISED -			SCALE: 1" = 50'	SHEET NO. 5 OF 12 SHEETS	STA. 1205+00 TO STA. 1219+00	CONTRACT NO. 76A91			
PLOT DATE = 3/16/2011	DATE - 06-30-10	REVISED -	REVISED -			ILLINOIS FED. AID PROJECT						