

PROP. CURVE PR-WR-3  
 PI STA. = 1417+93.73  
 $\Delta = 11^\circ 21' 44''$  (RT)  
 $D = 1^\circ 11' 37''$   
 $R = 4,800.00'$   
 $T = 477.51'$   
 $L = 951.89'$   
 $E = 23.69'$   
 $e = \dots$   
 $T.R. = \dots$   
 $S.E. RUN = \dots$   
 P.C. STA. = 1413+16.22  
 P.T. STA. = 1422+68.11  
 DESIGN SPEED = 20 MPH

PROP. CURVE PR-270-1  
 PI STA. = 1173+56.70  
 $\Delta = 30^\circ 01' 30''$  (RT)  
 $D = 1^\circ 14' 44''$   
 $R = 4,600.00'$   
 $T = 1,233.64'$   
 $L = 2,410.56'$   
 $E = 162.55'$   
 $e = 3.24\%$   
 $T.R. = \text{SEE SE TABLE}$   
 $S.E. RUN = \text{SEE SE TABLE}$   
 P.C. STA. = 1161+23.06  
 P.T. STA. = 1185+33.62  
 DESIGN SPEED = 60 MPH

PROP. CURVE PR-270W-1  
 PI STA. = 3173+45.41  
 $\Delta = 29^\circ 45' 41''$  (RT)  
 $D = 1^\circ 14' 39''$   
 $R = 4,605.50'$   
 $T = 1,223.76'$   
 $L = 2,392.25'$   
 $E = 159.81'$   
 $e = 3.24\%$   
 $T.R. = \text{SEE SE TABLE}$   
 $S.E. RUN = \text{SEE SE TABLE}$   
 P.C. STA. = 3161+21.65  
 P.T. STA. = 3185+13.90

PROP. CURVE PR-270E-1  
 PI STA. = 2173+90.56  
 $\Delta = 29^\circ 48' 43''$  (RT)  
 $D = 1^\circ 14' 49''$   
 $R = 4,594.50'$   
 $T = 1,223.02'$   
 $L = 2,390.60'$   
 $E = 159.99'$   
 $e = 3.24\%$   
 $T.R. = \text{SEE SE TABLE}$   
 $S.E. RUN = \text{SEE SE TABLE}$   
 P.C. STA. = 2161+67.54  
 P.T. STA. = 2185+58.14

**PROPOSED ROADWAY LEGEND**

- (A) CONT REINF PCC PVT 12
  - (B) HMA SC "D" N50
  - (C) HMA BC IL-12.5 N50
  - (D) STABILIZED SUBBASE 4"
  - (E) BIT SURF TREAT CL A-3
  - (F) AGG BASE CSE A 8
  - (G) SUB GRAN MAT A 12
  - (H) PCC SHOULDERS 12
  - (I) PCC SHOULDERS 12 SPL
  - (J) HMA SHOULDERS 10 1/2
  - (K) SHLDR STABILIZATION (NOTE 1)
  - (L) AGGREGATE SHLDS A 6
  - (M) TOPSOIL EXC & PLAC
  - (N) CONC BAR 2F 42HT
  - (O) CONC BAR 1F 42HT SPL
  - (P) MECH ST EARTH RET WL
  - (R) SPBGR TY A 6FT POSTS
  - (S) PCC PVT 12 JOINTED
  - (T) HMA PAVT FD 13
  - (U) PROCESS MOD SOIL 12 AND LIME
  - (W) SUB GRAN MAT C
  - (X) WOV W FENCE 4
  - (Y) SPBGR TY A 9FT POST
  - (AA) SHOULDER RUMBLE STRIP
- NOTE 1: (K) PAID FOR AS (H) OR (J) TO MATCH ADJACENT SHOULDER  
 NOTE 2: SEE PLAT OF HIGHWAY FOR FULL EXTENT OF GENERAL PURPOSE LICENSE. (GPL)

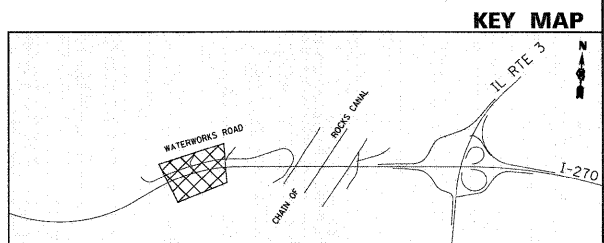
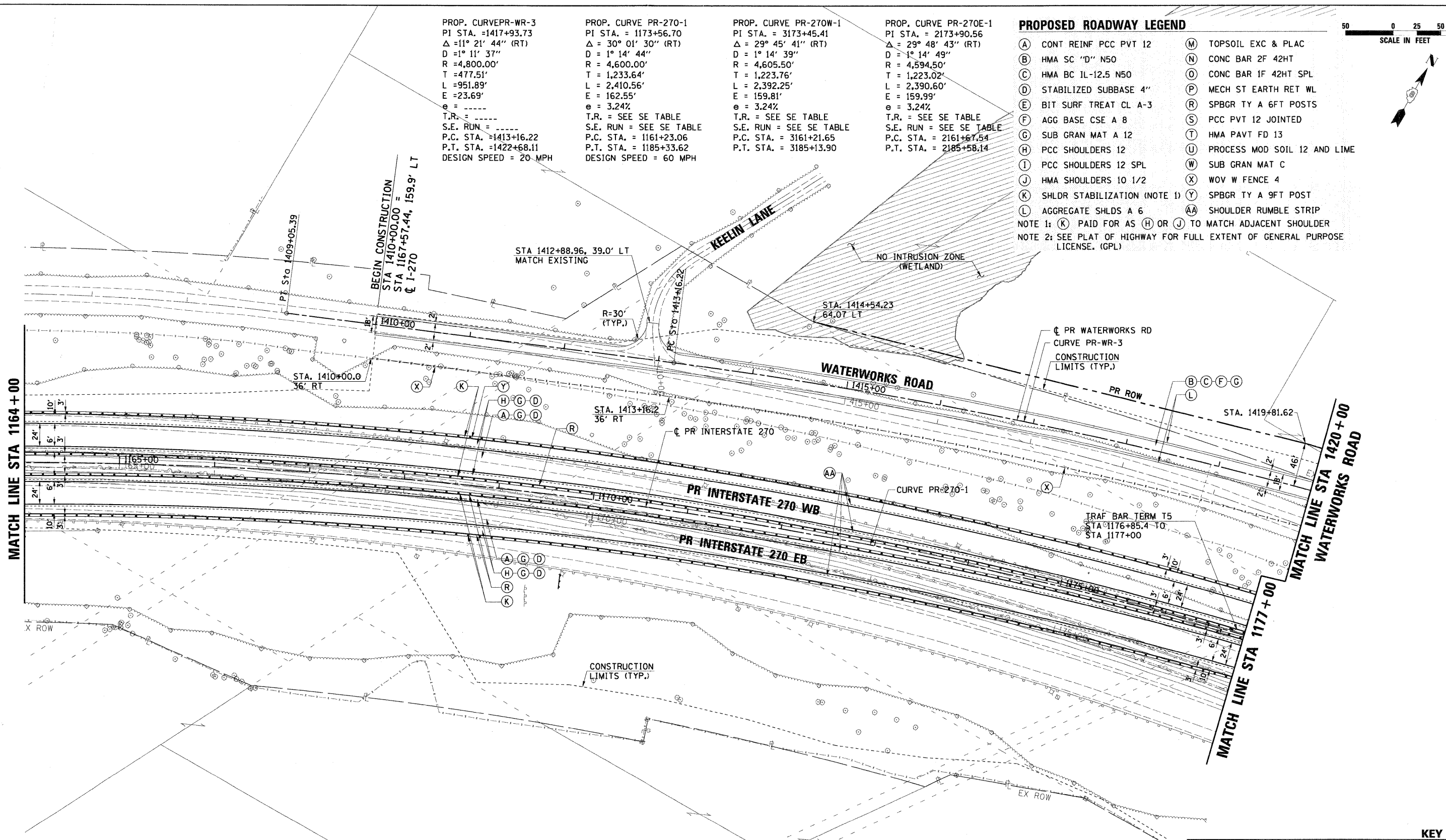
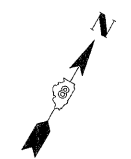

FILE NAME = DB76A91-Sht-Plan02.dgn	USER NAME = malopez	DESIGNED - SJM	REVISED - 01-04-11	<b>STATE OF ILLINOIS DEPARTMENT OF TRANSPORTATION</b>	<b>PROPOSED PLAN INTERSTATE 270</b>	F.A.I. RTE. 270	SECTION 60-1B-1	COUNTY MADISON	TOTAL SHEETS 712	SHEET NO. 51
PLOT SCALE = #SCALE#		DRAWN - BAH		SCALE: 1" = 50'		SHEET NO. 2 OF 12 SHEETS		STA. 1164+00 TO STA. 1177+00		
PLOT DATE = 3/17/2011		CHECKED - SJM		ILLINOIS FED. AID PROJECT		CONTRACT NO. 76A91				
DATE = 06-30-10		REVISED -								