

CHAIN OF ROCKS CANAL

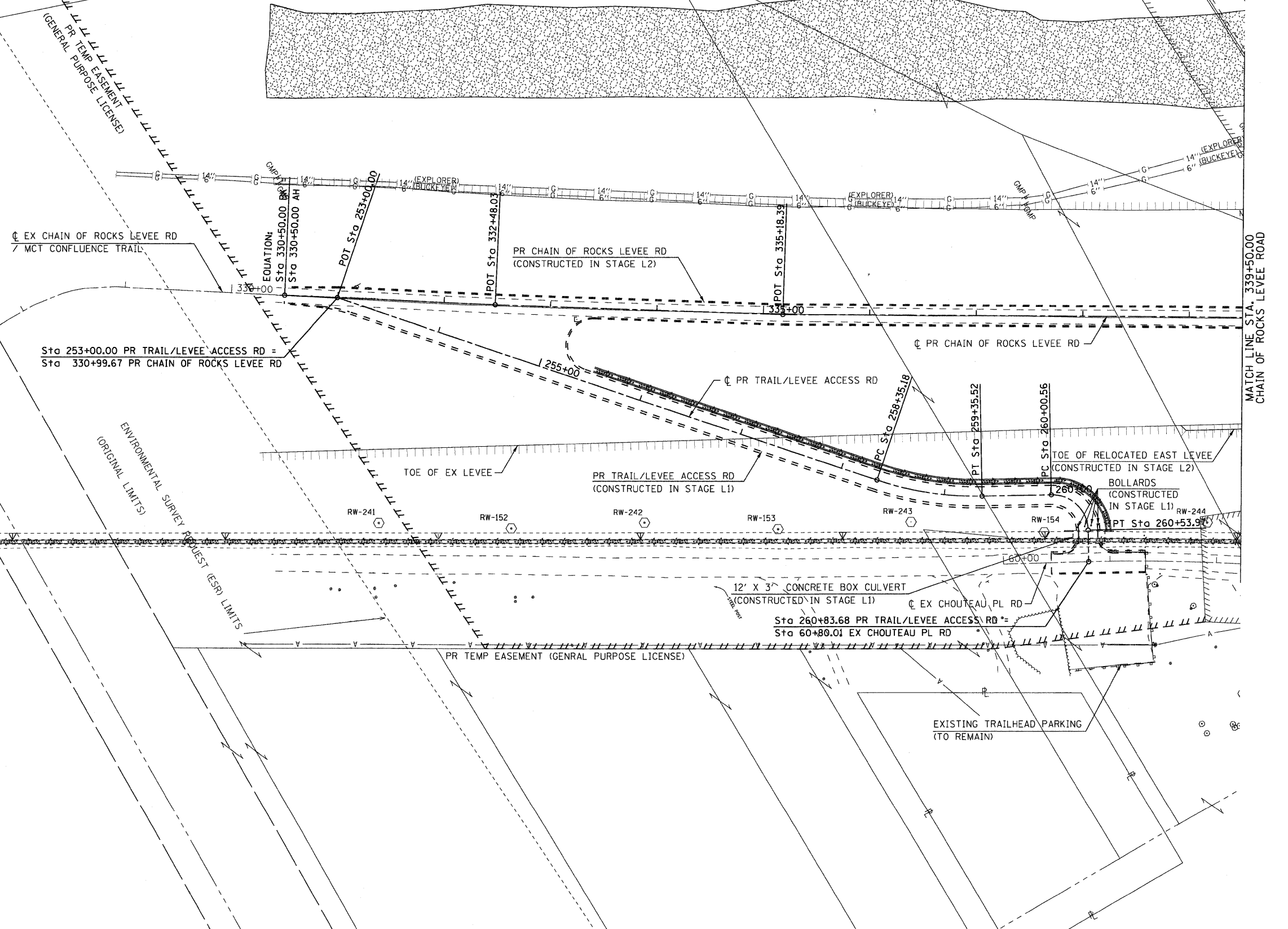
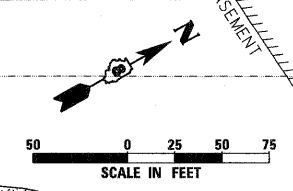

EX CHAIN OF ROCKS LEVEE RD
MCT CONFLUENCE TRAIL

Sta 253+00.00 PR TRAIL/LEVEE ACCESS RD =
Sta 330+99.67 PR CHAIN OF ROCKS LEVEE RD

PR CHAIN OF ROCKS LEVEE RD
(CONSTRUCTED IN STAGE L2)

PR CHAIN OF ROCKS LEVEE RD

PR TRAIL/LEVEE ACCESS RD

PR TRAIL/LEVEE ACCESS RD
(CONSTRUCTED IN STAGE L1)

TOE OF RELOCATED EAST LEVEE
(CONSTRUCTED IN STAGE L2)

BOLLARDS
(CONSTRUCTED IN STAGE L1)

12' X 3' CONCRETE BOX CULVERT
(CONSTRUCTED IN STAGE L1)

Sta 260+83.68 PR TRAIL/LEVEE ACCESS RD =
Sta 60+80.01 EX CHOUTEAU PL RD

EXISTING TRAILHEAD PARKING
(TO REMAIN)

NOTE: RELIEF WELL RW155A TO BE REMOVED.
ALL OTHER RELIEF WELLS ARE TO BE PROTECTED
FROM DAMAGE.

FILE NAME = D876A91-Shr-Levee03-Plan01.dgn 	USER NAME = mmconechie	DESIGNED - CLS DRAWN - MAM	REVISED - REVISED - REVISED - REVISED -	STATE OF ILLINOIS DEPARTMENT OF TRANSPORTATION	PROPOSED RELOCATED LEVEE PLAN STAGE L3	F.A.I. RTE. = 270	SECTION = 60-IB-1	COUNTY = MADISON	TOTAL SHEETS = 712	SHEET NO. = 83
	PLOT SCALE = 50.0000' / IN. PLOT DATE = 3/16/2011	CHECKED - CLS DATE = 3/18/2011	SCALE: 1" = 50' SHEET NO. 6 OF 7 SHEETS STA. 330+50.00 TO STA. 339+50.00			CONTRACT NO. 76A91 [ILLINOIS] FED. AID PROJECT				