

THE I-270 WEST ST. CHARLES SIGN WILL BE COVERED DURING THIS STAGE.

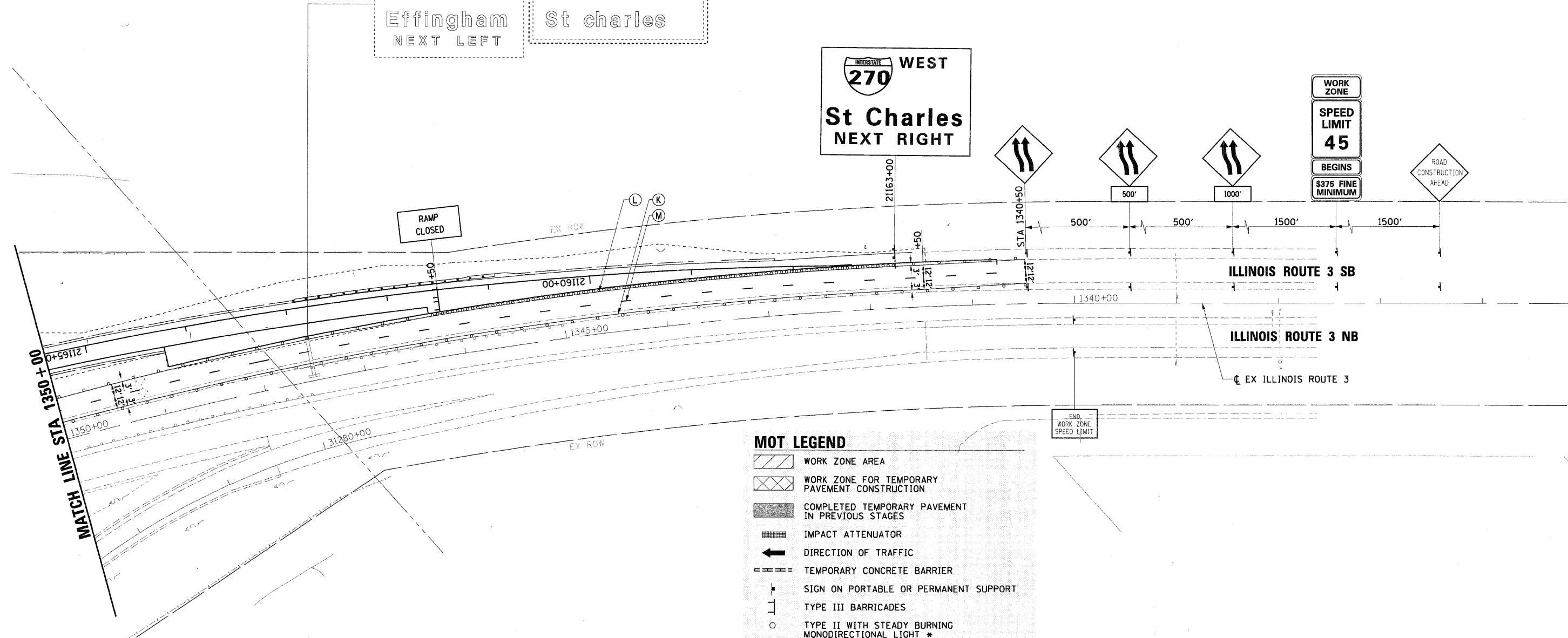
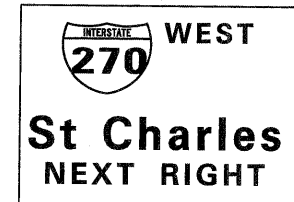
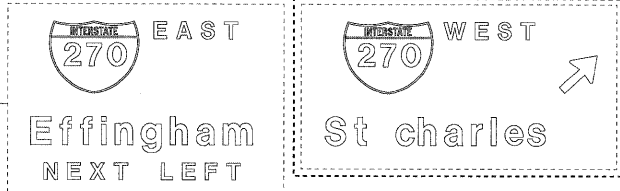

**MOT LEGEND**

- WORK ZONE AREA
- WORK ZONE FOR TEMPORARY PAVEMENT CONSTRUCTION
- COMPLETED TEMPORARY PAVEMENT IN PREVIOUS STAGES
- IMPACT ATTENUATOR
- DIRECTION OF TRAFFIC
- TEMPORARY CONCRETE BARRIER
- SIGN ON PORTABLE OR PERMANENT SUPPORT
- TYPE III BARRICADES
- TYPE II WITH STEADY BURNING MONODIRECTIONAL LIGHT \*
- MESSAGE BOARD

\* DRUM OR BARRICADE SPACING:  
 50' C-C ON TANGENTS  
 25' C-C ON TAPERS OR LANE SHIFTS  
 12' C-C ON RADII'S OR RAMP  
 5' C-C FOR RAMP OR ROAD CLOSURES

**MOT PAVEMENT MARKING LEGEND**

- |   |   |
|---|---|
| (A) TEMP PVT MK LINE 4 (SOLID YELLOW)                         | (I) EPOXY PVT MK LINE 4 (SKIP-DASH, WHITE, 10' DASH, 30' SKIP)              |
| (B) TEMP PVT MK LINE 4 (SOLID WHITE)                          | (J) NOT USED  |
| (C) TEMP PVT MK LINE 4 (SKIP-DASH, WHITE, 10' DASH, 30' SKIP) | (K) WET PAVT TAPE T3 4 (SOLID YELLOW)                                       |
| (D) NOT USED  | (L) WET PAVT TAPE T3 4 (SOLID WHITE)  |
| (E) TEMP PVT MK LINE 24 (SOLID WHITE)                         | (M) WET PAVT TAPE T3 4 (SOLID WHITE) (SKIP-DASH, WHITE, 10' DASH, 30' SKIP) |
| (F) TEMP PVT MK LTR & SYM (SOLID WHITE)                       | (N) WET PAVT TAPE T3 6 (SOLID WHITE)  |
| (G) EPOXY PVT MK LINE 4 (SOLID YELLOW)                        | (O) WET PAVT TAPE T3 24 (SOLID WHITE)                                       |
| (H) EPOXY PVT MK LINE 4 (SOLID WHITE)                         |   |

NOTE:  
 EXISTING PAVEMENT MARKINGS ON ILLINOIS ROUTE 3 THAT CONFLICT WITH TEMPORARY PAVEMENT MARKINGS SHALL BE COVERED WITH BLACK WET REFLECTIVE PAVEMENT MARKING TAPE.

**KEY MAP**

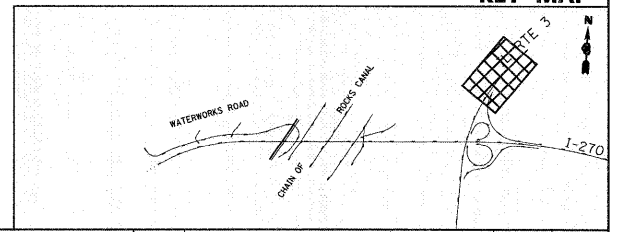

FILE NAME = DB76A91-Sht-MDT04-11.dgn	USER NAME = malopez	DESIGNED - JC	REVISED - 1-01-11
		DRAWN - BH	REVISED -
		CHECKED -	REVISED -
		DATE -	REVISED -

STATE OF ILLINOIS  
 DEPARTMENT OF TRANSPORTATION

SUGGESTED MAINTENANCE OF TRAFFIC STAGE 4  
 ILLINOIS ROUTE 3

SCALE: 1" = 50' SHEET NO. 11 OF 11 SHEETS STA. TO STA.

F.A.I. RTE.	SECTION	COUNTY	TOTAL SHEETS	SHEET NO.
270	60-1B-1	MADISON	712	169
				CONTRACT NO. 76A91
ILLINOIS FED. AID PROJECT				