

THE I-270 WEST ST. CHARLES SIGN WILL BE COVERED DURING THIS STAGE.

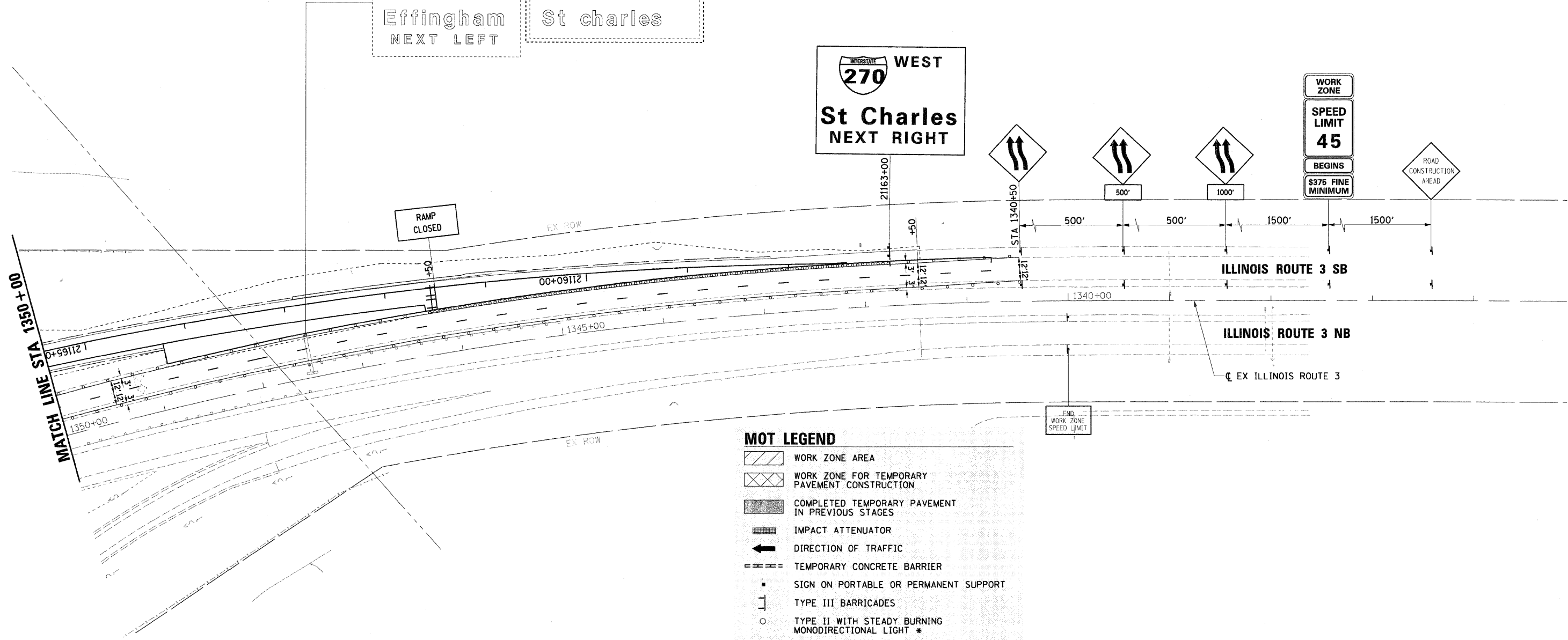
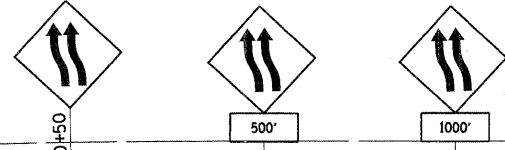
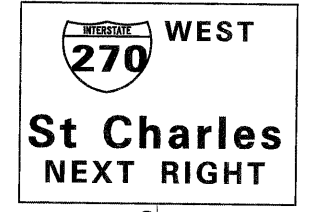
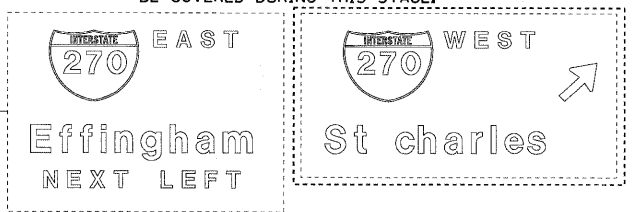

MOT LEGEND

- WORK ZONE AREA
- WORK ZONE FOR TEMPORARY PAVEMENT CONSTRUCTION
- COMPLETED TEMPORARY PAVEMENT IN PREVIOUS STAGES
- IMPACT ATTENUATOR
- DIRECTION OF TRAFFIC
- TEMPORARY CONCRETE BARRIER
- SIGN ON PORTABLE OR PERMANENT SUPPORT
- TYPE III BARRICADES
- TYPE II WITH STEADY BURNING MONODIRECTIONAL LIGHT *
- MESSAGE BOARD

* DRUM OR BARRICADE SPACING:
 50' C-C ON TANGENTS
 25' C-C ON TAPERS OR LANE SHIFTS
 12' C-C ON RADII'S OR RAMPS
 5' C-C FOR RAMP OR ROAD CLOSURES

MOT PAVEMENT MARKING LEGEND

- (A) TEMP PVT MK LINE 4 (SOLID YELLOW)
- (B) TEMP PVT MK LINE 4 (SOLID WHITE)
- (C) TEMP PVT MK LINE 4 (SKIP-DASH, WHITE, 10' DASH, 30' SKIP)
- (D) NOT USED
- (E) TEMP PVT MK LINE 24 (SOLID WHITE)
- (F) TEMP PVT MK LTR & SYM (SOLID WHITE)
- (G) EPOXY PVT MK LINE 4 (SOLID YELLOW)
- (H) EPOXY PVT MK LINE 4 (SOLID WHITE)
- (I) EPOXY PVT MK LINE 4 (SKIP-DASH, WHITE, 10' DASH, 30' SKIP)
- (J) NOT USED
- (K) WET PAVT TAPE T3 4 (SOLID YELLOW)
- (L) WET PAVT TAPE T3 4 (SOLID WHITE)
- (M) WET PAVT TAPE T3 4 (SOLID WHITE) (SKIP-DASH, WHITE, 10' DASH, 30' SKIP)
- (N) WET PAVT TAPE T3 6 (SOLID WHITE)
- (O) WET PAVT TAPE T3 24 (SOLID WHITE)

NOTE:
 EXISTING PAVEMENT MARKINGS ON ILLINOIS ROUTE 3 THAT CONFLICT WITH TEMPORARY PAVEMENT MARKINGS SHALL BE COVERED WITH BLACK WET REFLECTIVE PAVEMENT MARKING TAPE.

KEY MAP

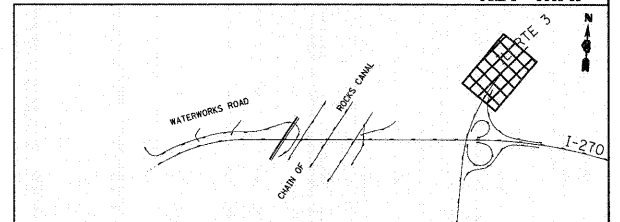

FILE NAME = D676491-Sh1-MOT24A-11.dgn	USER NAME = melopez	DESIGNED - JC	REVISED - 1-01-11
		DRAWN - BH	REVISED -
	PLOT SCALE = \$SCALE\$	CHECKED -	REVISED -
	PLOT DATE = 3/16/2011	DATE -	REVISED -

**STATE OF ILLINOIS
 DEPARTMENT OF TRANSPORTATION**

**SUGGESTED MAINTENANCE OF TRAFFIC STAGE 4A
 ILLINOIS ROUTE 3**

SCALE: 1" = 50' SHEET NO. 11 OF 11 SHEETS STA. TO STA.

F.A.I. RTE.	SECTION	COUNTY	TOTAL SHEETS	SHEET NO.
270	60-1B-1	MADISON	712	180
CONTRACT NO. 76A91				
ILLINOIS FED. AID PROJECT				