

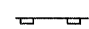





**LEGEND**

-  PERIMETER EROSION BARRIER
-  INLET AND PIPE PROTECTION
-  CLASS 2A SEEDING  
(WITH MULCH METHOD 2)
-  TEMPORARY DITCH CHECKS
-  CLASS 3A SEEDING  
(WITH EROSION CONTROL BLANKET)
-  SEEDING, SPECIAL
-  SEEDING, SPECIAL  
(WITH EROSION CONTROL BLANKET)

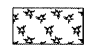
NOTE:  
 FINAL SEEDING AREAS ARE SHOWN BY STAGE AND TYPE.  
 - SEEDING CLASS 2A SHALL BE USED WITH MULCH METHOD 2 ON SIDE SLOPES FLATTER THAN 1:3 (V:H).  
 - SEEDING CLASS 3A SHALL BE USED WITH EROSION CONTROL BLANKET ON 1:3 (V:H) OR STEEPER SLOPES.  
 - SEEDING, SPECIAL SHALL BE USED ON LEVEE AREAS AS SHOWN.  
 TWO APPLICATIONS OF TEMPORARY SEEDING WITH MULCH METHOD 2 IS ALSO QUANTIFIED AND INCLUDED IN THE SEEDING SCHEDULE FOR ALL AREAS.

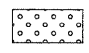

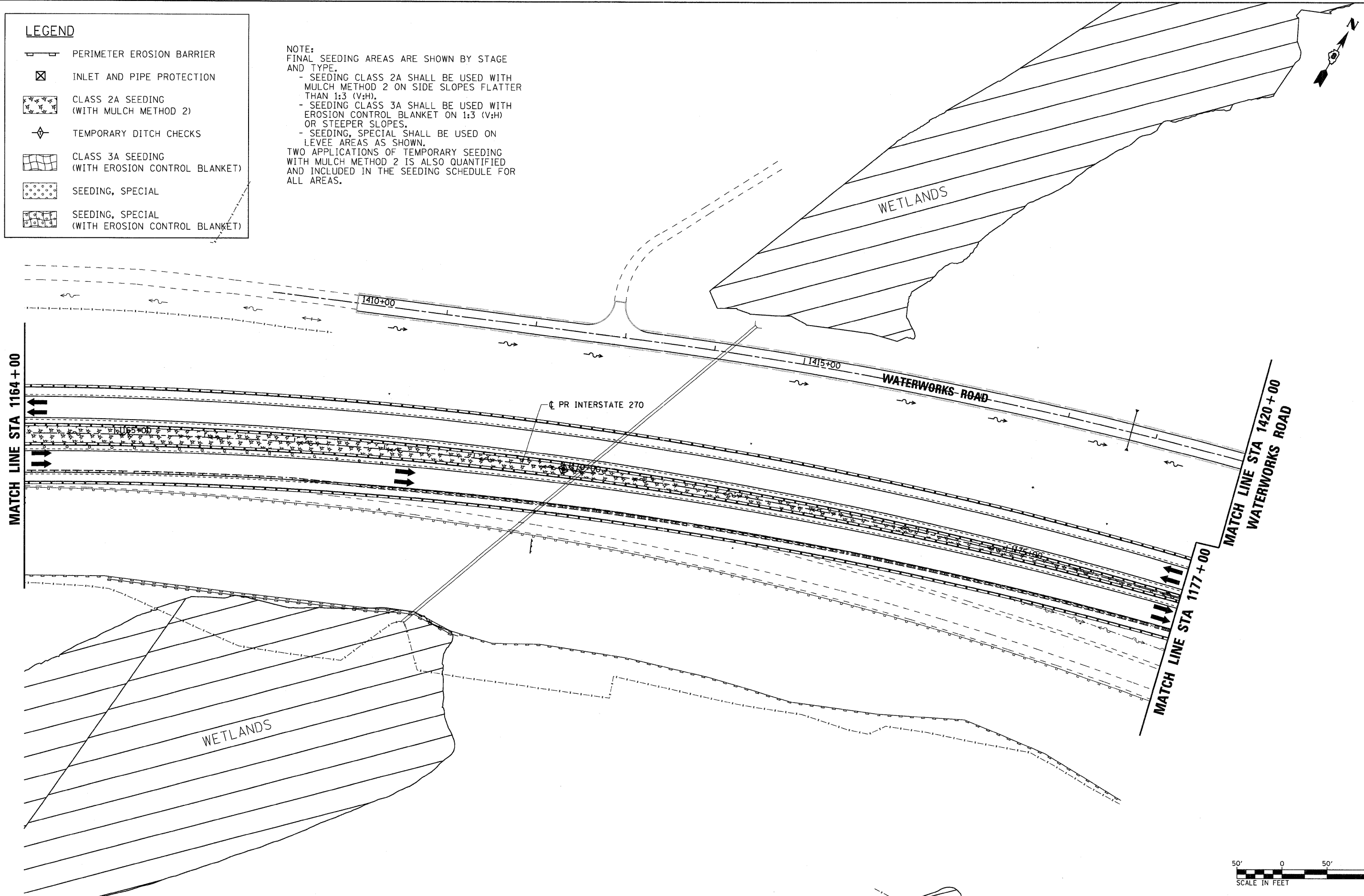
FILE NAME = D876A91-Sht-Eros-04-02.dgn  
**VOLKERT**

USER NAME = untitled	DESIGNED - MPW	REVISED -
PLOT SCALE = 50.0000' / IN.	DRAWN - CJS	REVISED -
PLOT DATE = 3/15/2011	CHECKED - PMK	REVISED -
	DATE - 3/18/2011	REVISED -

**STATE OF ILLINOIS  
 DEPARTMENT OF TRANSPORTATION**

**EROSION CONTROL PLAN - STAGE 4**

SCALE: 1" = 50' SHEET NO. 24 OF 38 SHEETS STA. 1164+00 TO STA. 1177+00

F.A.I. RTE.	SECTION	COUNTY	TOTAL SHEETS	SHEET NO.
270	60-1B-1	MADISON	712	235
				CONTRACT NO. 76A91
ILLINOIS FED. AID PROJECT				