

SEE EXISTING DRAINAGE AND UTILITY LEGENDS ON SHEET NO. 1 OF 11

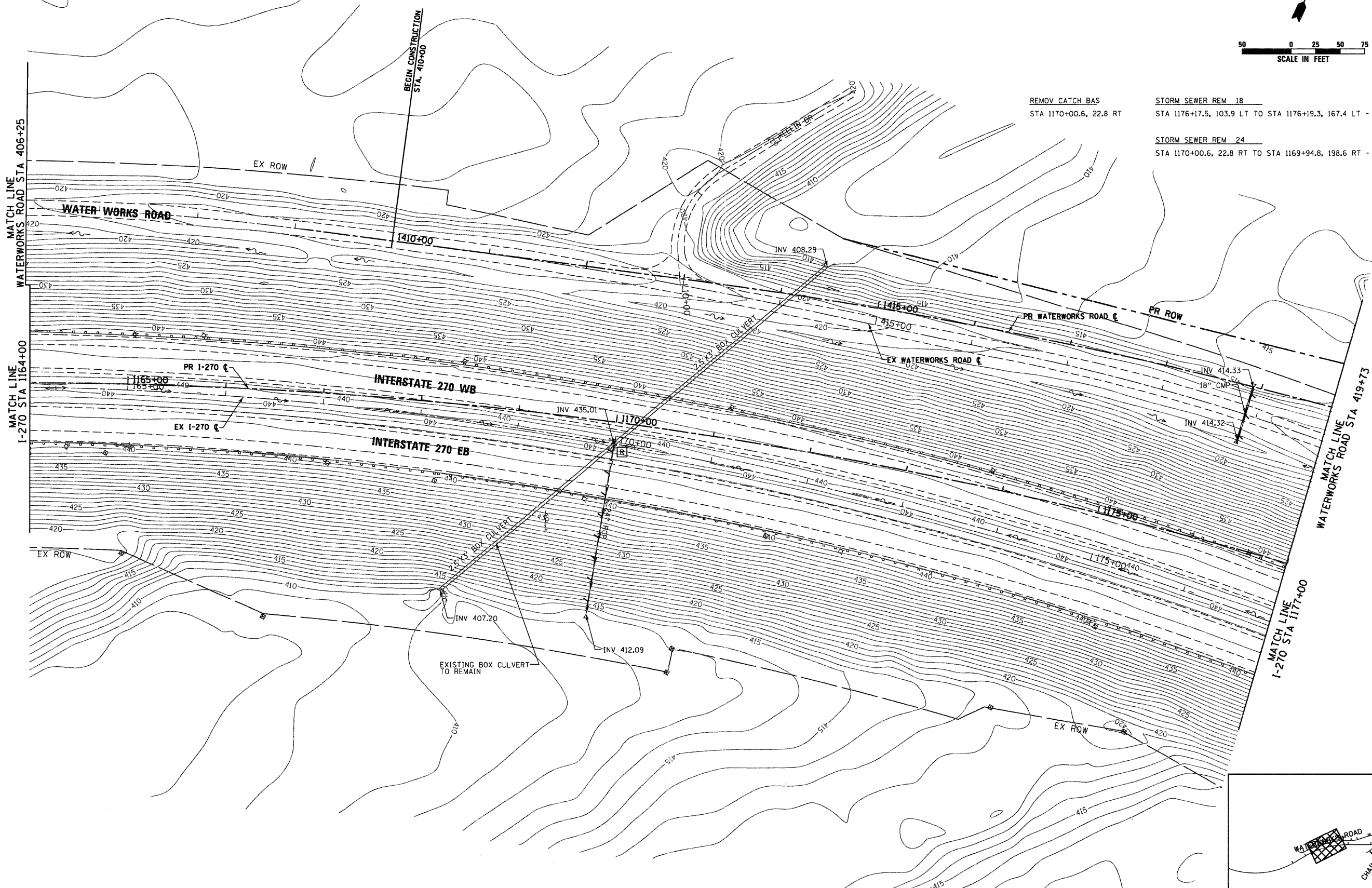
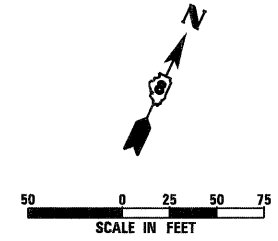

REMOV CATCH BAS
STA 1170+00.6, 22.8 RT

STORM SEWER REM 18
STA 1176+17.5, 103.9 LT TO STA 1176+19.3, 167.4 LT - 63.5'

STORM SEWER REM 24
STA 1170+00.6, 22.8 RT TO STA 1169+94.8, 198.6 RT - 175.9'

KEY MAP

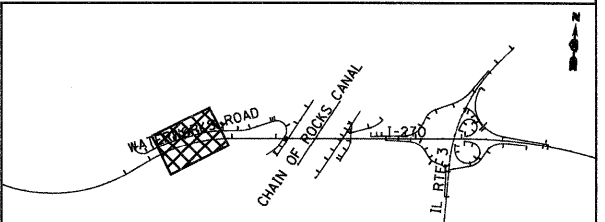

FILE NAME =
0876A91-Sht-ExD-rin02.dgn

USER NAME = EDean
PLOT SCALE = 1:50
PLOT DATE = 3/18/11

DESIGNED - JWM
DRAWN - JWM
CHECKED - MBL
DATE - 3/18/11

REVISED -
REVISED -
REVISED -
REVISED -

STATE OF ILLINOIS
DEPARTMENT OF TRANSPORTATION

EXISTING DRAINAGE & UTILITIES
INTERSTATE 270

SCALE: 1" = 50' SHEET NO. 2 OF 11 SHEETS STA. 1164+00 TO STA. 1177+00

F.A.I. RTE.	SECTION	COUNTY	TOTAL SHEETS	SHEET NO.
270	60-1B-1	MADISON	712	251
				CONTRACT NO. 76A91
ILLINOIS FED. AID PROJECT				