

LEFT SIDE LIGHTS		
POLE NO.	STATION	OFFSET
P13	1165+05	55.59'
P15	1167+00	54.58'
P17	1168+95	53.54'
P19	1170+90	52.50'
P21	1172+85	51.43'
P23	1174+80	50.36'
P25	1176+75	49.28'

RIGHT SIDE LIGHTS		
POLE NO.	STATION	OFFSET
P12	1164+07.5	58.70'
P14	1166+02.5	57.49'
P16	1167+97.5	56.26'
P18	1169+92.5	55.00'
P20	1171+87.5	53.73'
P22	1173+82.5	52.44'
P24	1175+77.5	51.14'

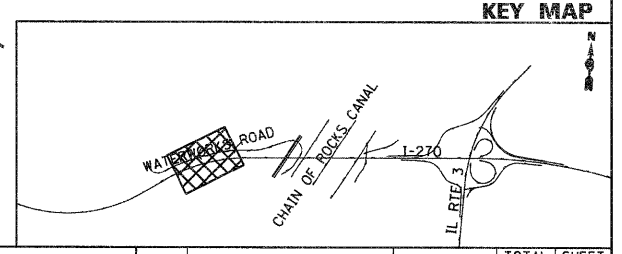
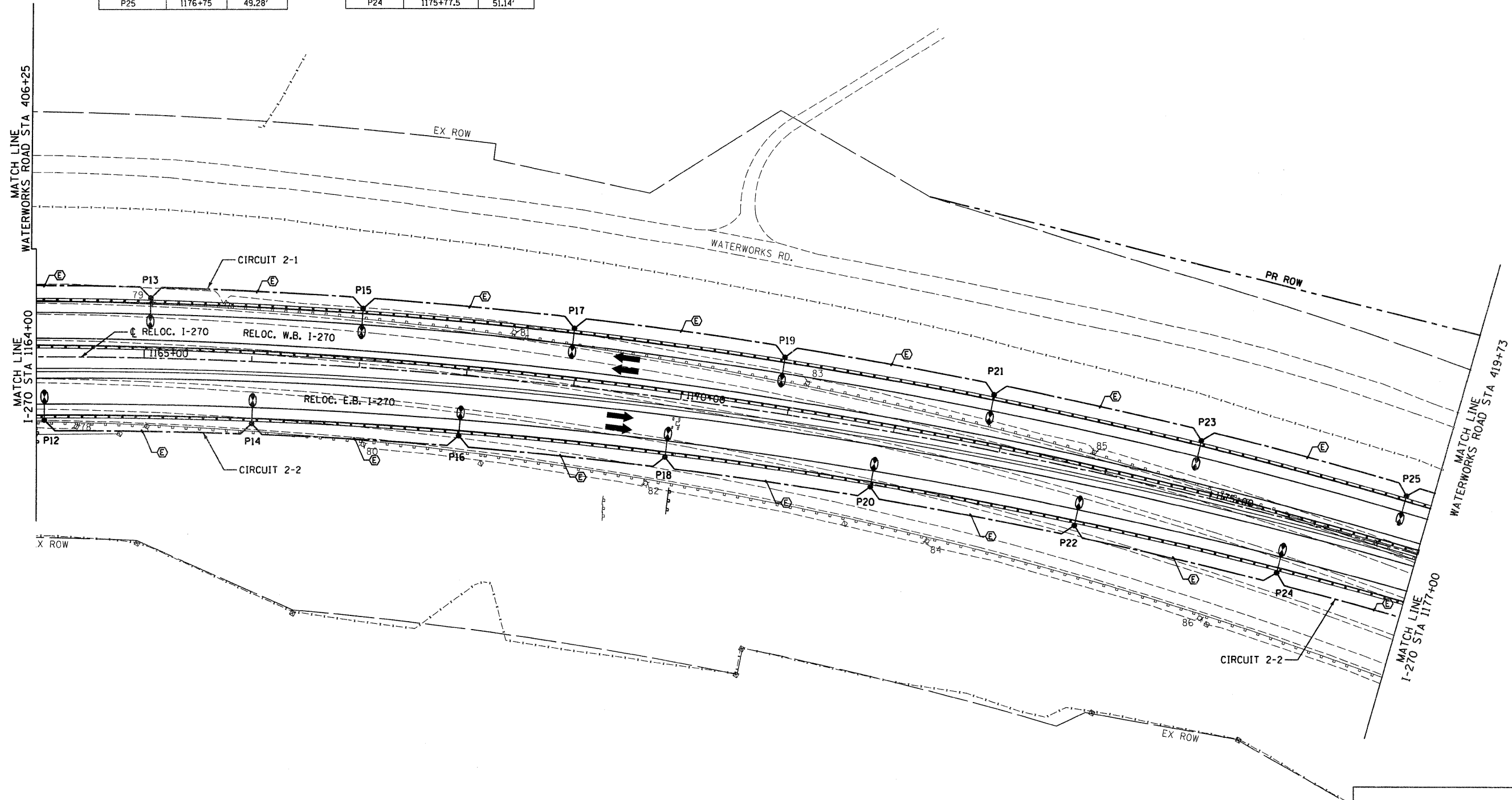
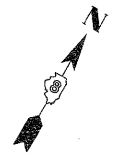
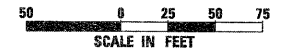

FILE NAME = #FILE#	USER NAME = #USER#	DESIGNED FSM	REVISED -	<b>STATE OF ILLINOIS DEPARTMENT OF TRANSPORTATION</b>	<b>HIGHWAY LIGHTING PLANS INTERSTATE 270</b>		FAI	SECTION	COUNTY	TOTAL SHEETS	SHEET NO.	
	PLOT SCALE = #SCALE#	DRAWN SCR	REVISED -		SCALE: 1" = 50'	SHEET NO. 3 OF 10 SHEETS	STA. 1164+00 TO STA. 1177+00	270	60-1B-1	MADISON	712	331
	PLOT DATE = #DATE#	CHECKED AAB	REVISED -								CONTRACT NO. 76A91	
		DATE 3/18/11	REVISED -	ILLINOIS FED. AID PROJECT								